

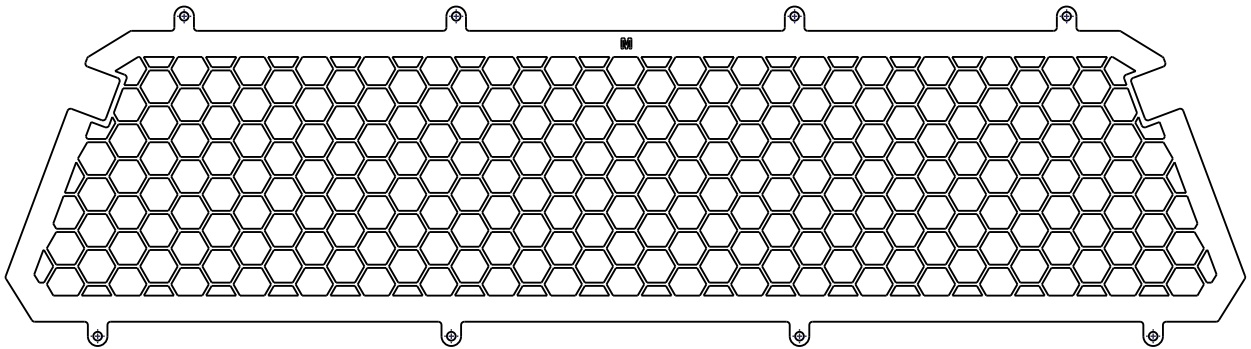

Security Screen Installation Guide



FOLLOW INSTRUCTIONS CAREFULLY TO AVOID ANY DAMAGE TO YOUR SMARTCAP PRODUCT OR YOUR VEHICLE

IF YOU HAVE QUESTIONS OR CONCERNS, PLEASE DO NOT HESITATE TO CONTACT US AT:

SUPPORT.NA@RSISMARTCAP.COM - NORTH AMERICA

SUPPORT.SA@SMARTCAP.COM - INTERNATIONAL/SOUTH AFRICA



FITMENT KIT CONTENTS

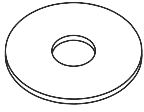

8X M6 X 20
FENDER WASHER

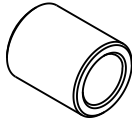

8X M6
SPACER

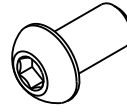

8X M6 X 25 BUTTON
HEAD SCREW

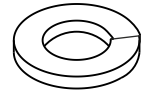

8X M6
SPRING WASHER

REQUIRED TOOLS

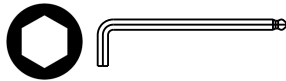

1X ALLEN KEY
SET

WARNING



- USE ONLY THE TOOLS RECOMMENDED IN THIS GUIDE
- USE ONLY THE HARDWARE THAT HAS BEEN PROVIDED
- HANDLE ALL COMPONENTS WITH CARE
- NEVER USE ACETONE ON THE PAINTWORK
- AVOID PINCHING/SQUASHING HANDS

FITMENT OF THE ACCESSORY

STEP ONE

1. PICK UP THE SMARTCAP AND ALIGN WITH MOUNTING HOLES IN THE REAR DOOR OF THE SMARTCAP. (SEE FIGURE 1 AND 2)

ALIGN SMARTSCREEN WITH REAR DOOR (TO BE FITTED INTERNALLY)

FIGURE 1

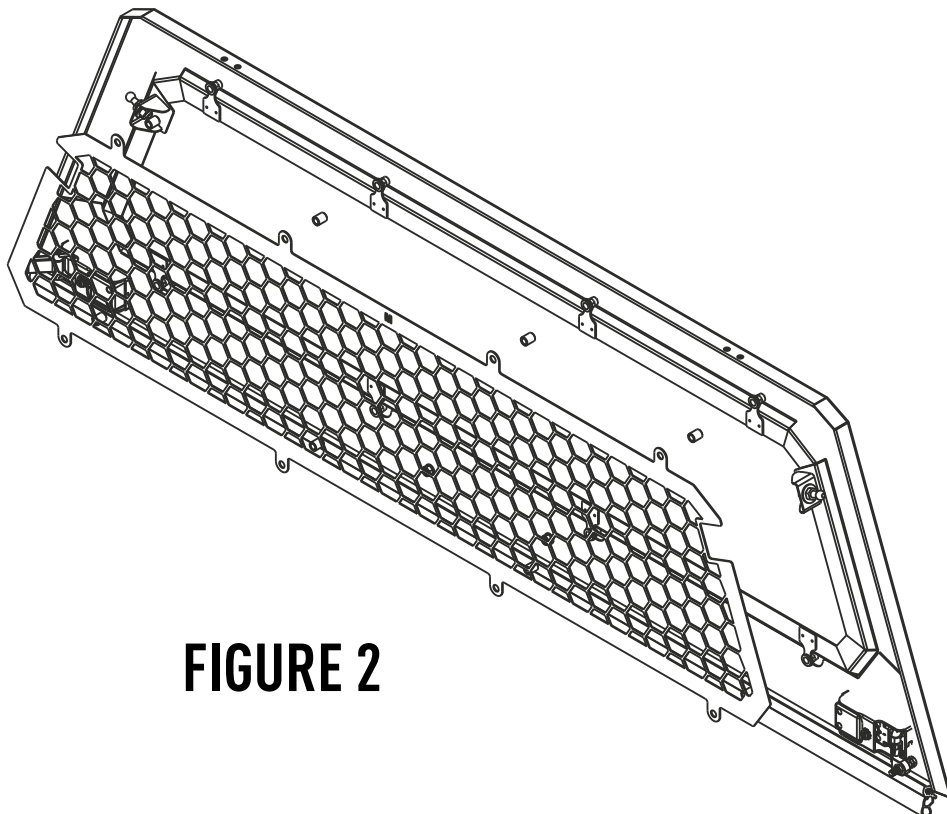
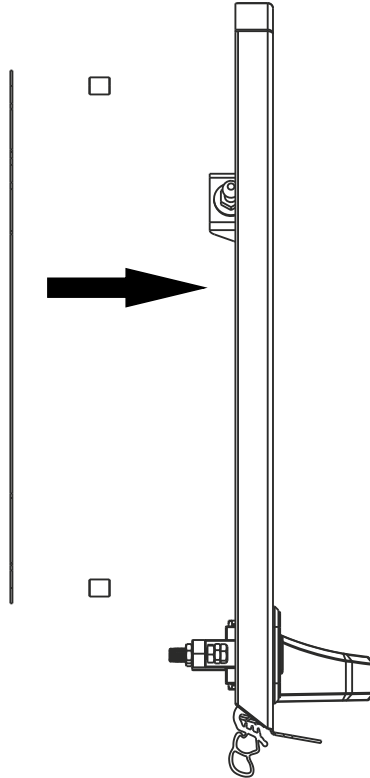

FIGURE 2

FITMENT OF THE ACCESSORY

STEP TWO

1. FASTEN THE SMARTCAP SECURITY SCREEN USING THE HARDWARE SHOWN IN FIGURE 3
2. FASTEN ALL FASTENERS TO 9FT-LB.

FIGURE 3

