

INSTRUCTION GUIDE

FORD RANGER EDITION

2019-2022

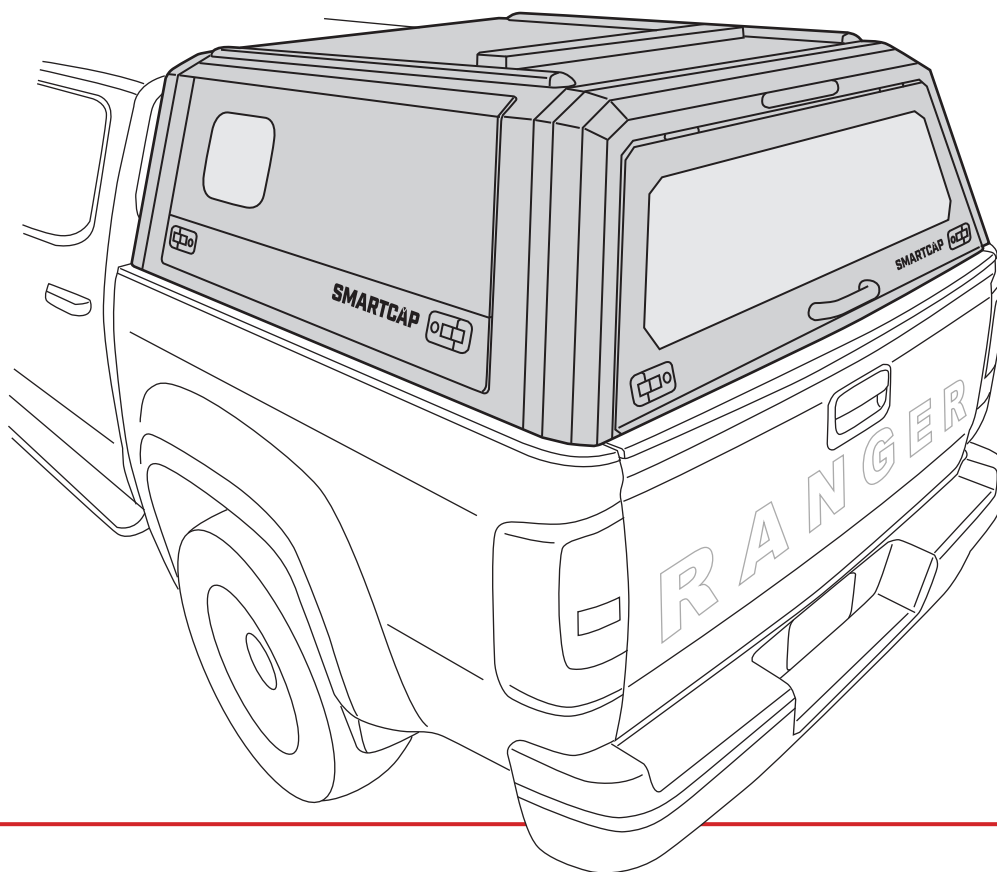

- TO ENSURE YOU ARE USING THE MOST RECENT VERSION, DOWNLOAD THIS INSTRUCTION GUIDE AT SMARTCAP.COM/ASSEMBLY-FITMENT.
- READ THROUGH THE ENTIRE INSTRUCTION GUIDE BEFORE STARTING THIS PROCEDURE AND FOLLOW THE STEPS CAREFULLY TO AVOID ANY DAMAGE TO THE COMPONENTS OR THE VEHICLE.

SMARTCAP.COM - SUPPORT.SA@SMARTCAP.COM - SOUTH AFRICA



TOOLS REQUIRED

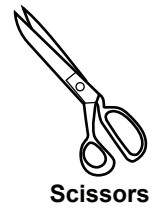
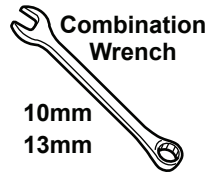
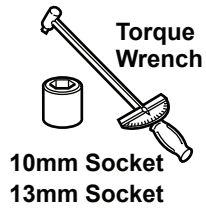
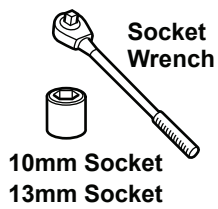

IMPORTANT

- USE ONLY THE TOOLS RECOMMENDED ABOVE.
- USE ONLY THE HARDWARE PROVIDED IN THIS KIT.
- ASSISTANCE WILL BE NEEDED FOR THIS INSTALLATION. FOUR PEOPLE ARE RECOMMENDED TO LIFT THE SMARTCAP ONTO THE VEHICLE.
- AVOID PINCHING OR CRUSHING HANDS AND FINGERS.
- INSPECT ALL KIT COMPONENTS FOR DAMAGE BEFORE ASSEMBLY.
- NEVER USE ACETONE OR THINNERS ON PAINTED PARTS.

COMPONENTS

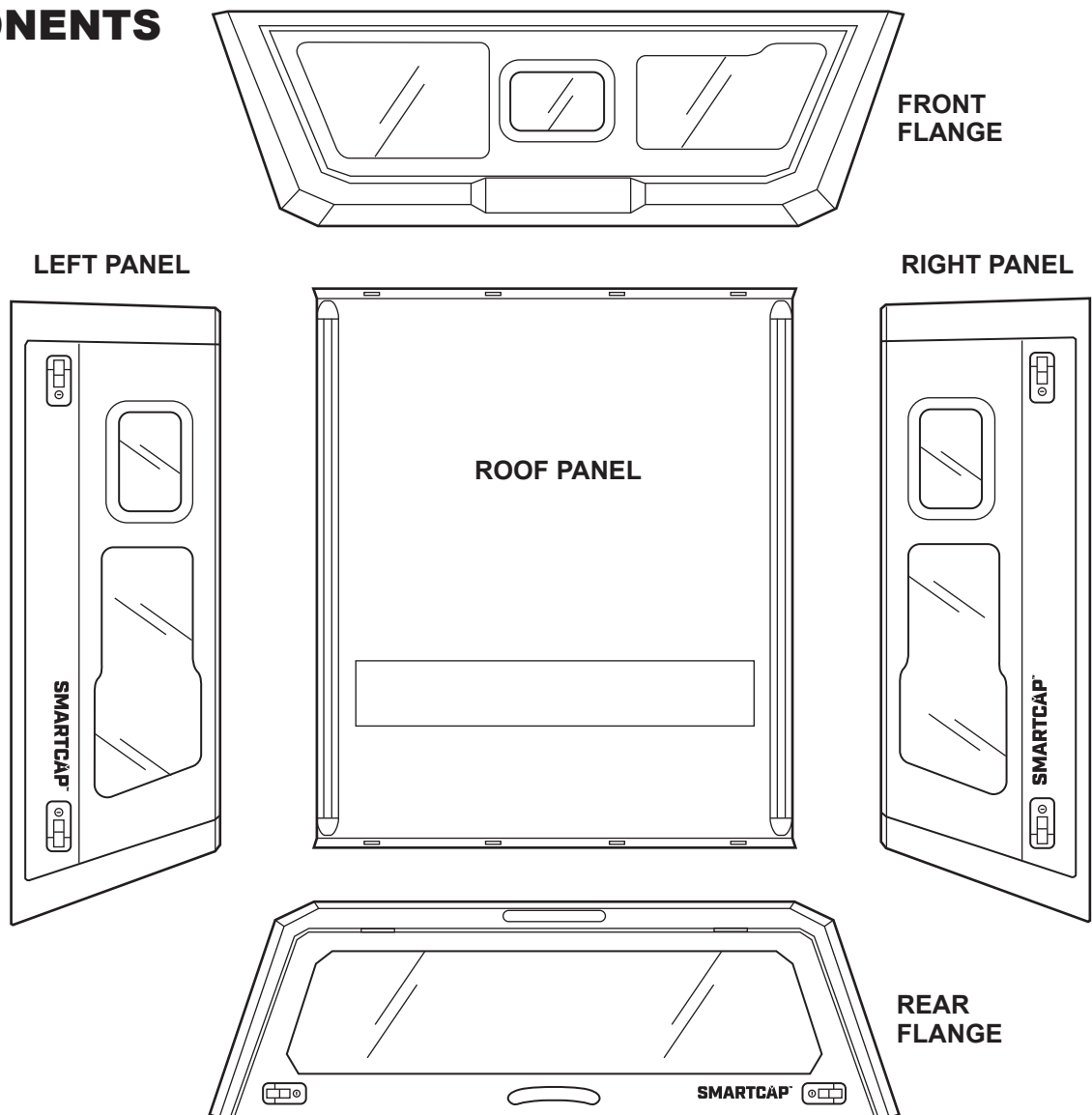

ASSEMBLY HARDWARE

(HAND FASTENED TO FLANGES)



M6 BOLT
28X

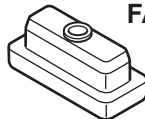

FASTENER
BLOCK
28X

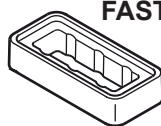

FASTENER BLOCK
CLAMP
28X



FASTENER BLOCK
LOADSPREADER
28X



M6 LOCK
WASHER
28X



M6 LOCK
NUT

10X

SHORT BED

12X

STANDARD BED



M6 FENDER
WASHER

10X

SHORT BED

12X

STANDARD BED

SPARE HARDWARE



M6 BOLT
1X



M6 FENDER
WASHER
1X



NUT CAP
4X



HEX CAP
4X

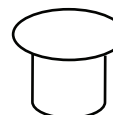

BARREL
PLUG
4X

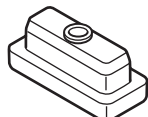

1X

FASTENER
BLOCK



FASTENER BLOCK
CLAMP

1X



FASTENER BLOCK
LOADSPREADER

1X

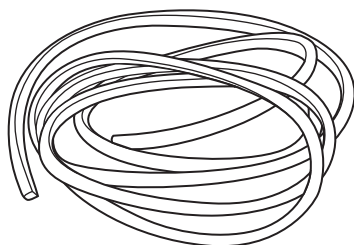

D - RUBBER



IMPORTANT

- BE SURE TO REMOVE ALL FIVE PANELS FROM THEIR PACKAGING AND INSPECT THE PAINTED SURFACES PRIOR TO ASSEMBLY, AS SMARTCAP WILL NOT ACCEPT PAINT DAMAGE WARRANTY CLAIMS AFTER ASSEMBLY IS COMPLETED. IF MANUFACTURING IMPERFECTIONS OR SHIPPING DAMAGES ARE FOUND DO NOT CONTINUE WITH THE ASSEMBLY PROCESS AND CONTACT SUPPORT.SA@SMARTCAP.COM

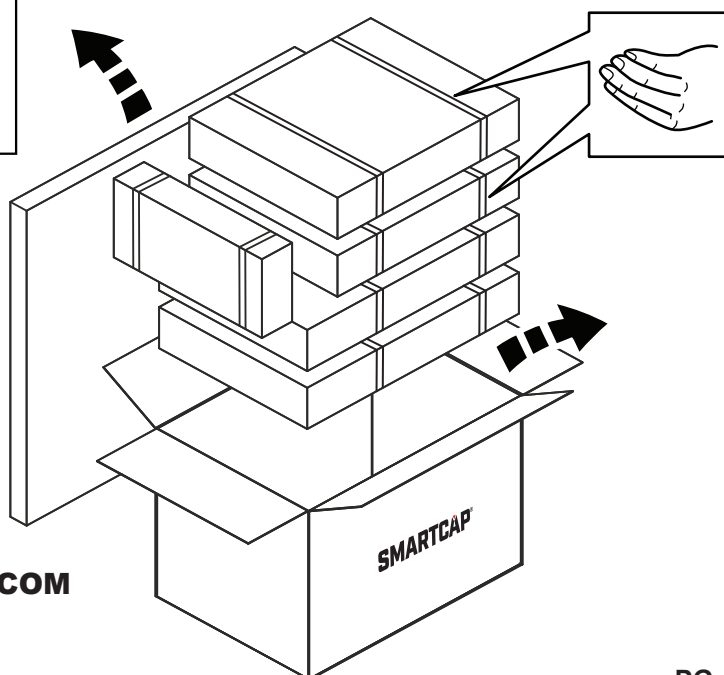
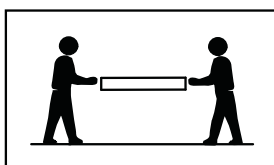

STEP 1

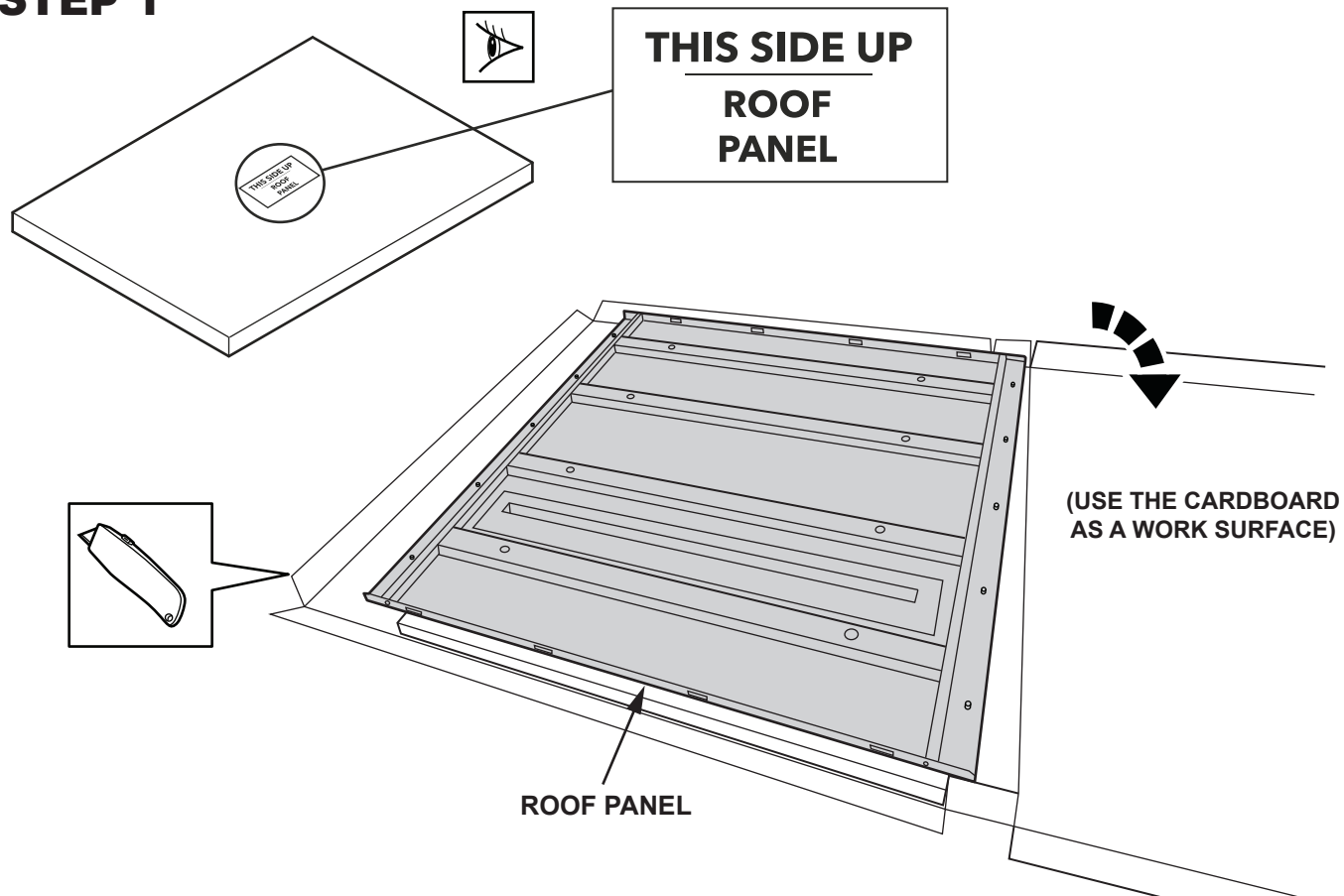

STEP 2

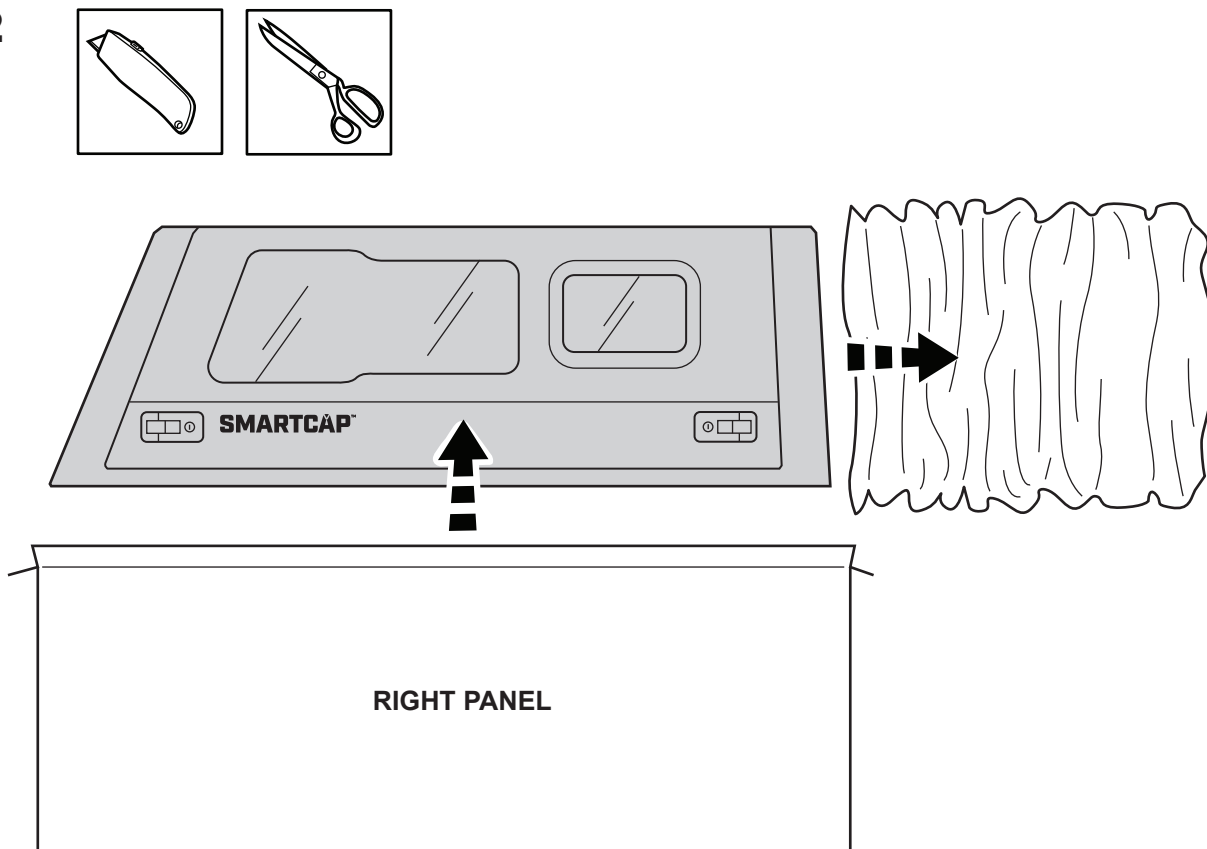

STEP 3

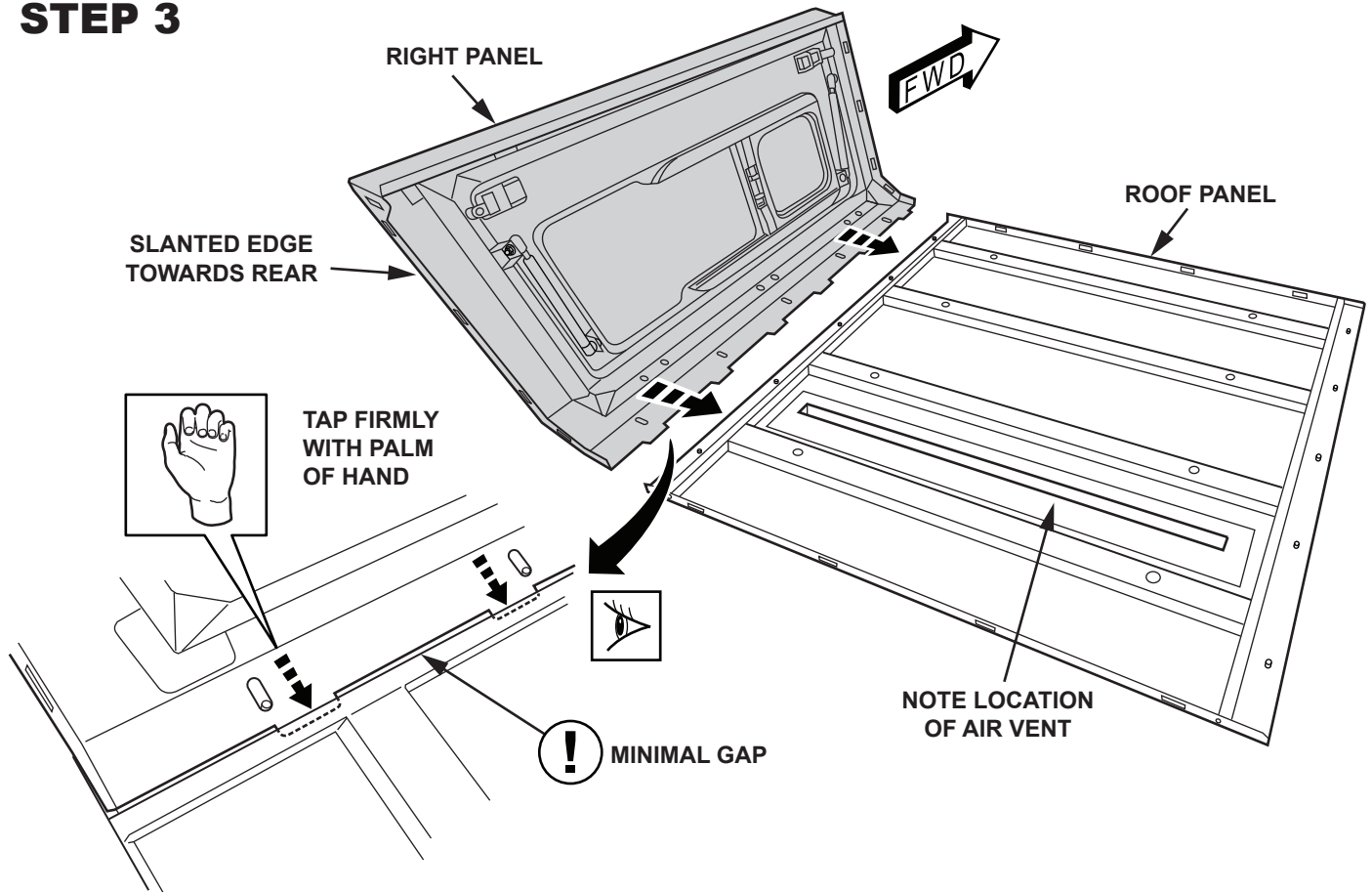

STEP 4

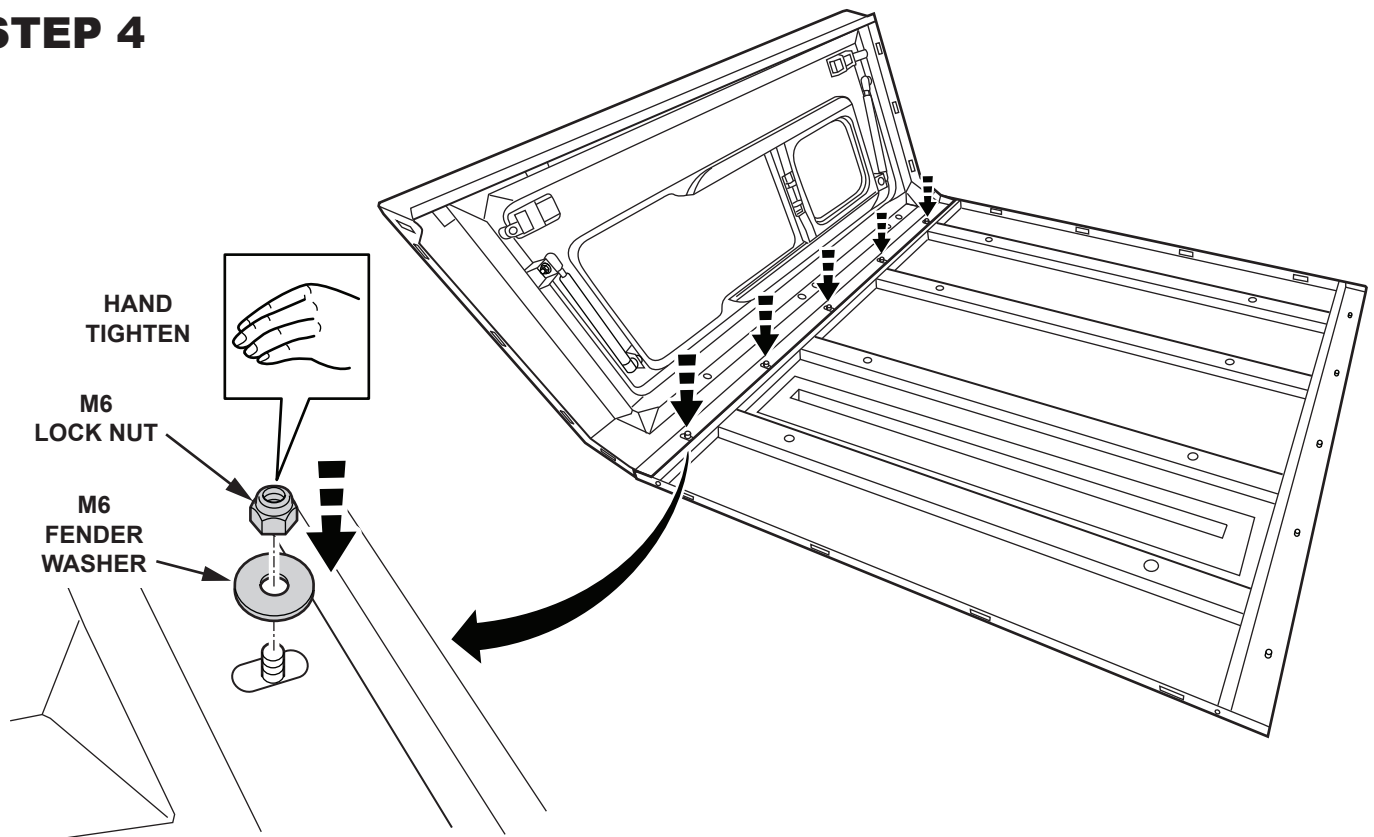

STEP 5

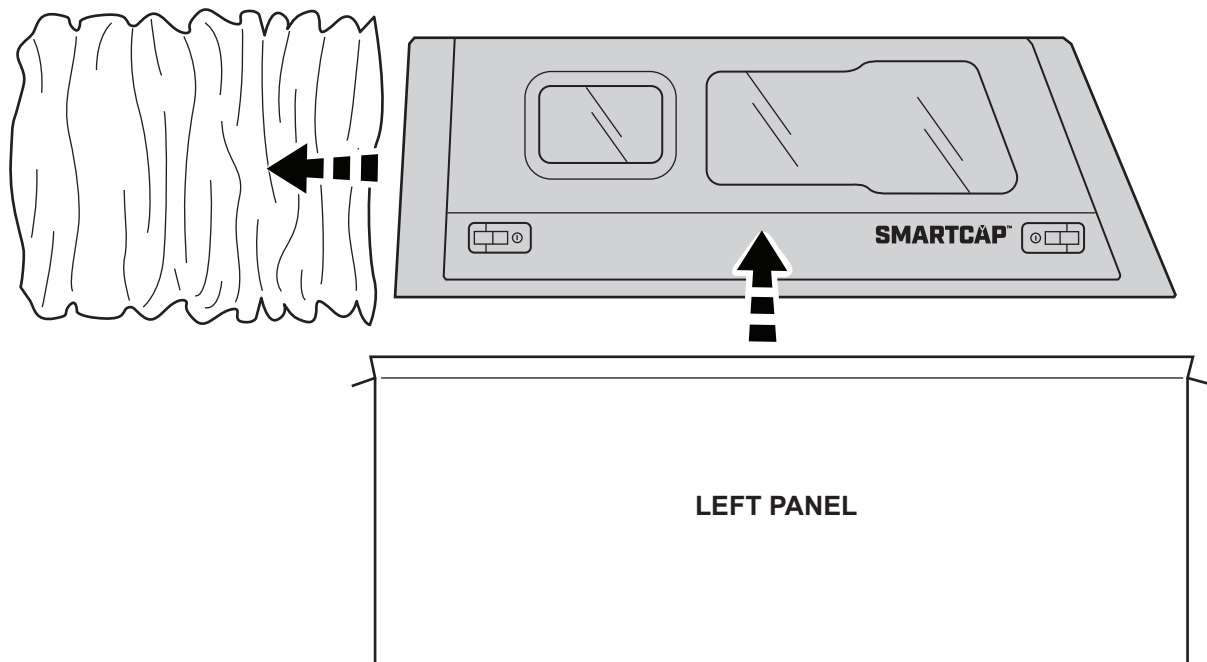
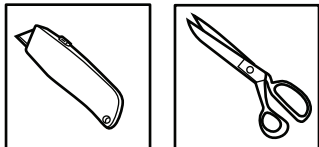

STEP 6

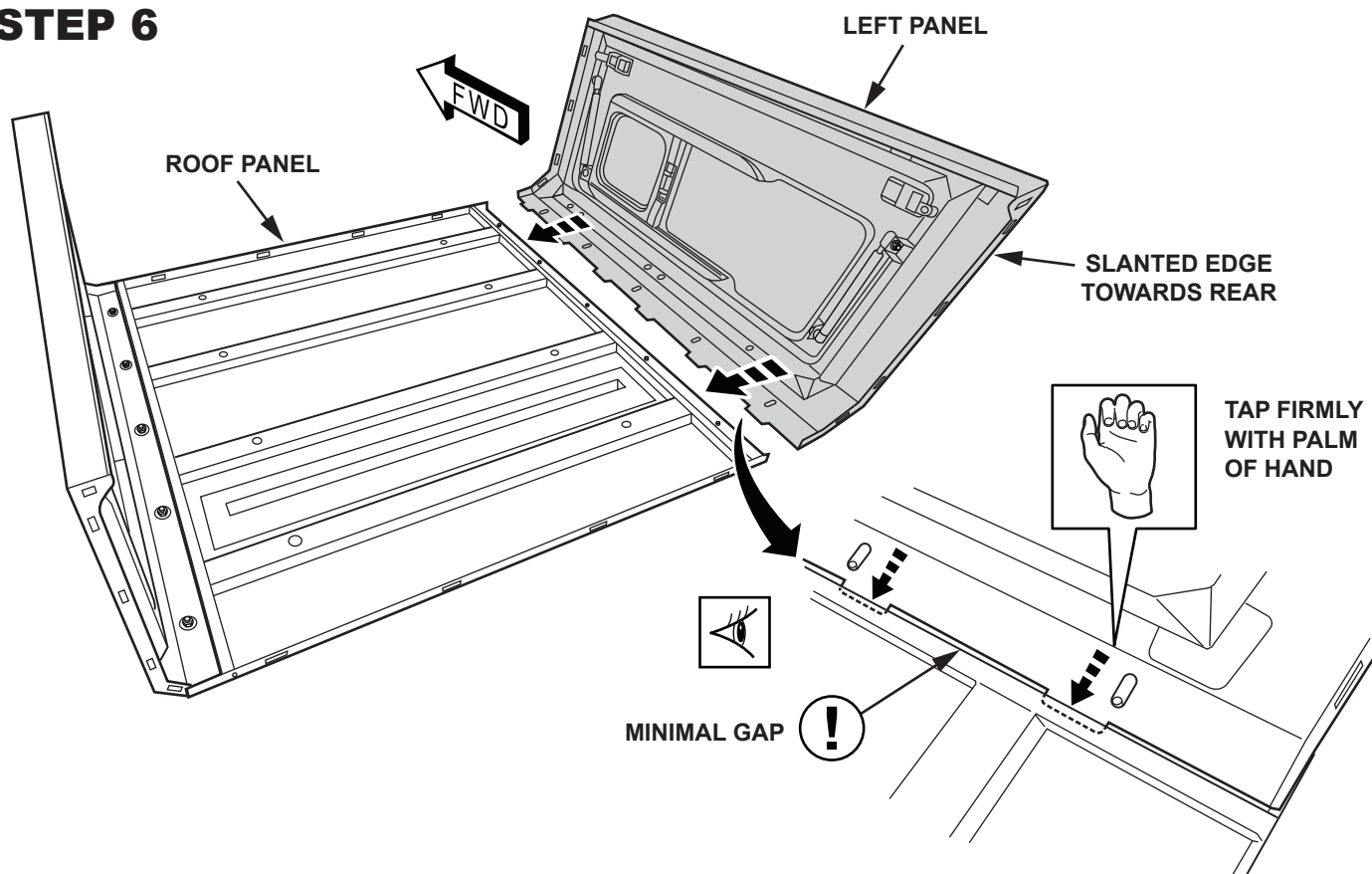

STEP 7

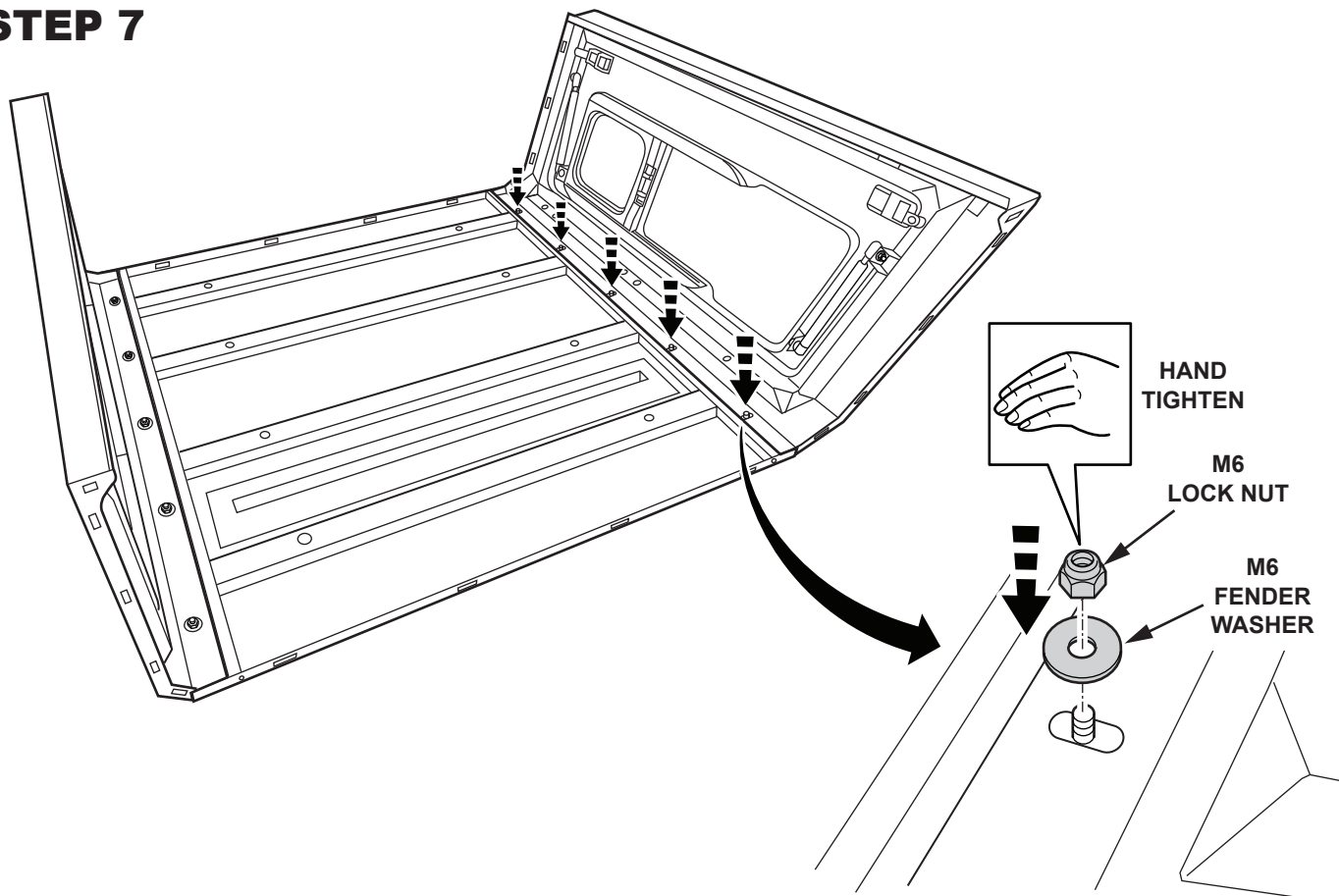

STEP 8

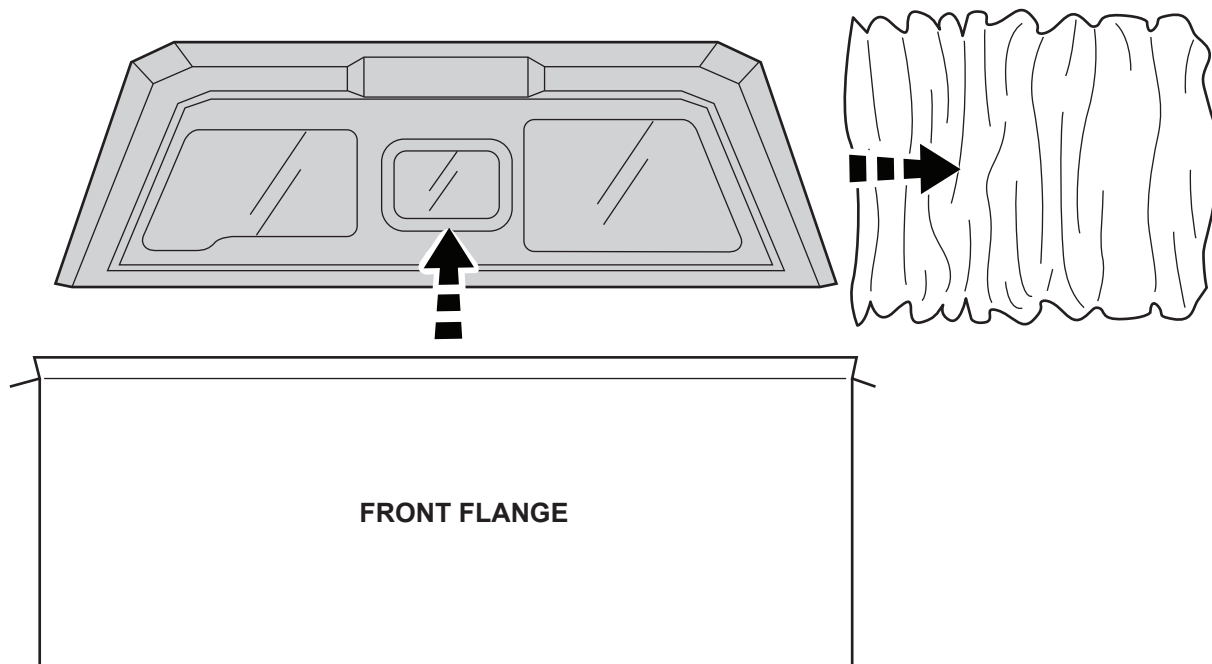
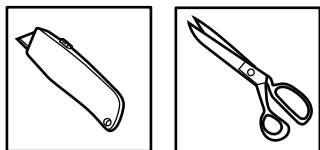

STEP 9

REMOVE ALL HARDWARE
FROM FRONT FLANGE

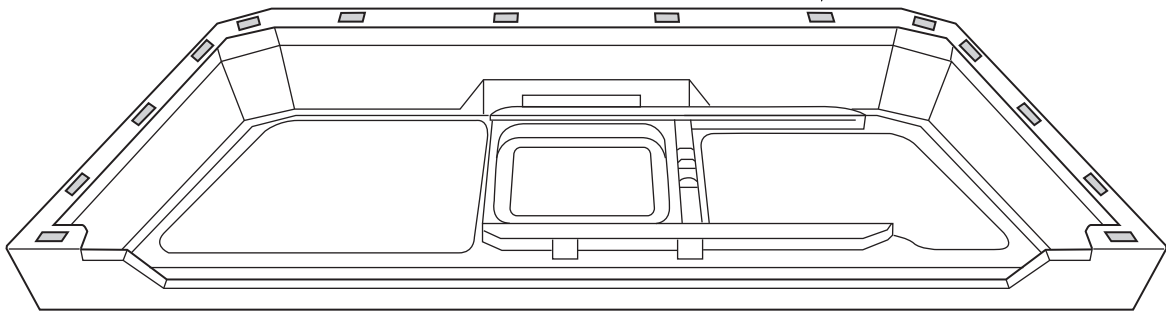
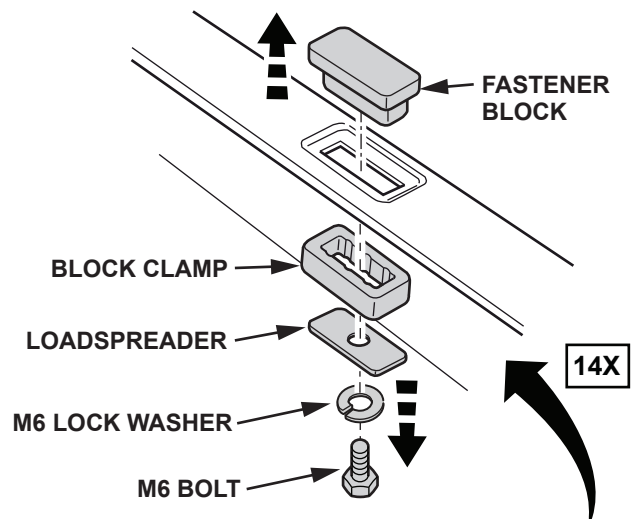
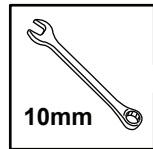

STEP 10

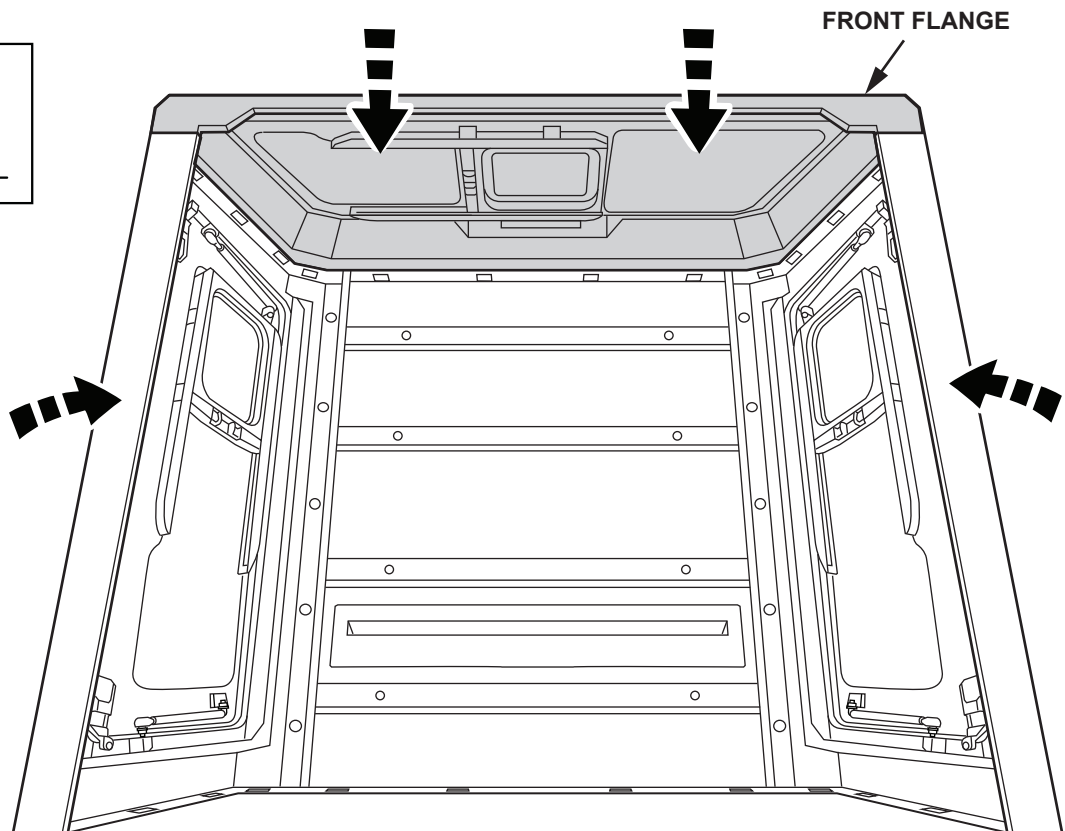
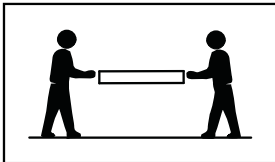

STEP 11

INSTALL HARDWARE
ALONG FRONT FLANGE
WITH BOLT ON INSIDE

HAND TIGHTEN IN THE
SEQUENCE SHOWN

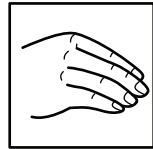

14X



BE SURE PANELS ARE FLUSH

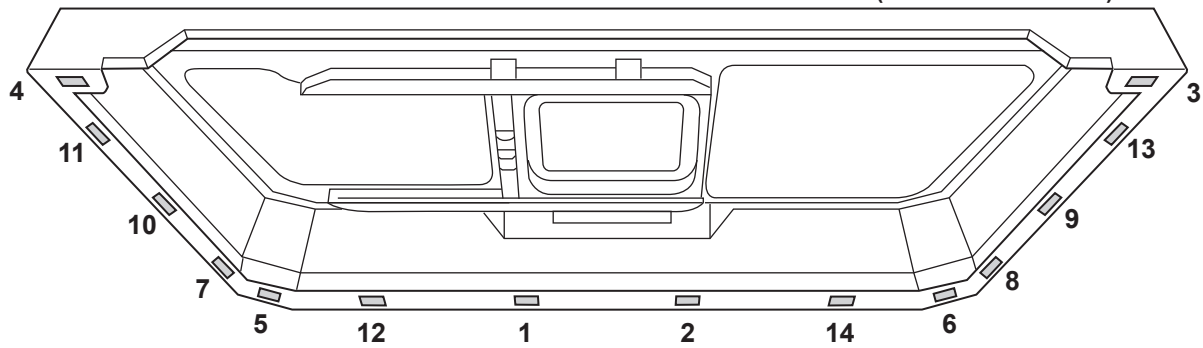
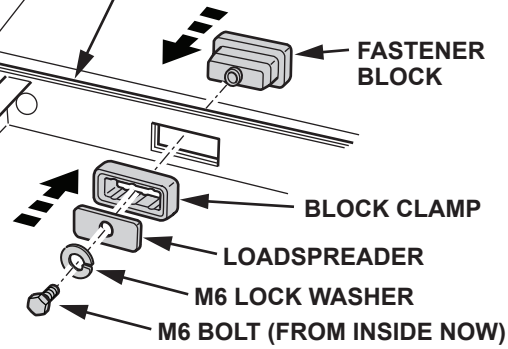

STEP 12

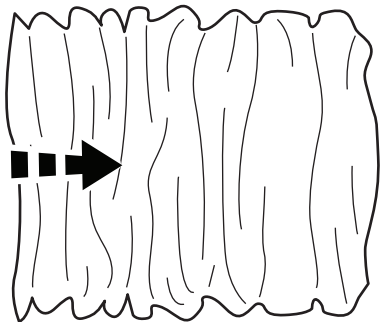
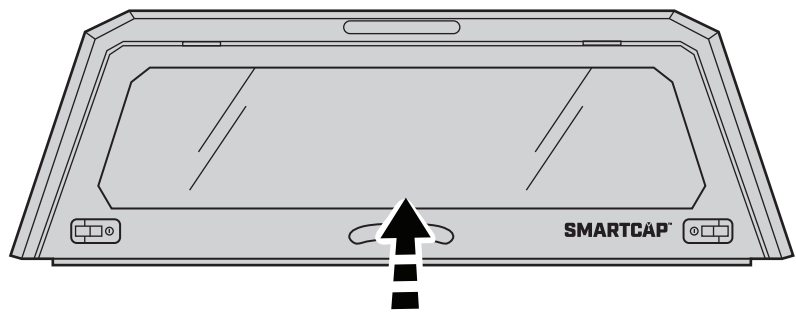
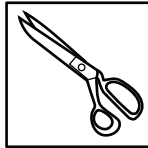
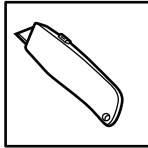

REAR FLANGE

STEP 13

REMOVE ALL HARDWARE
FROM REAR FLANGE

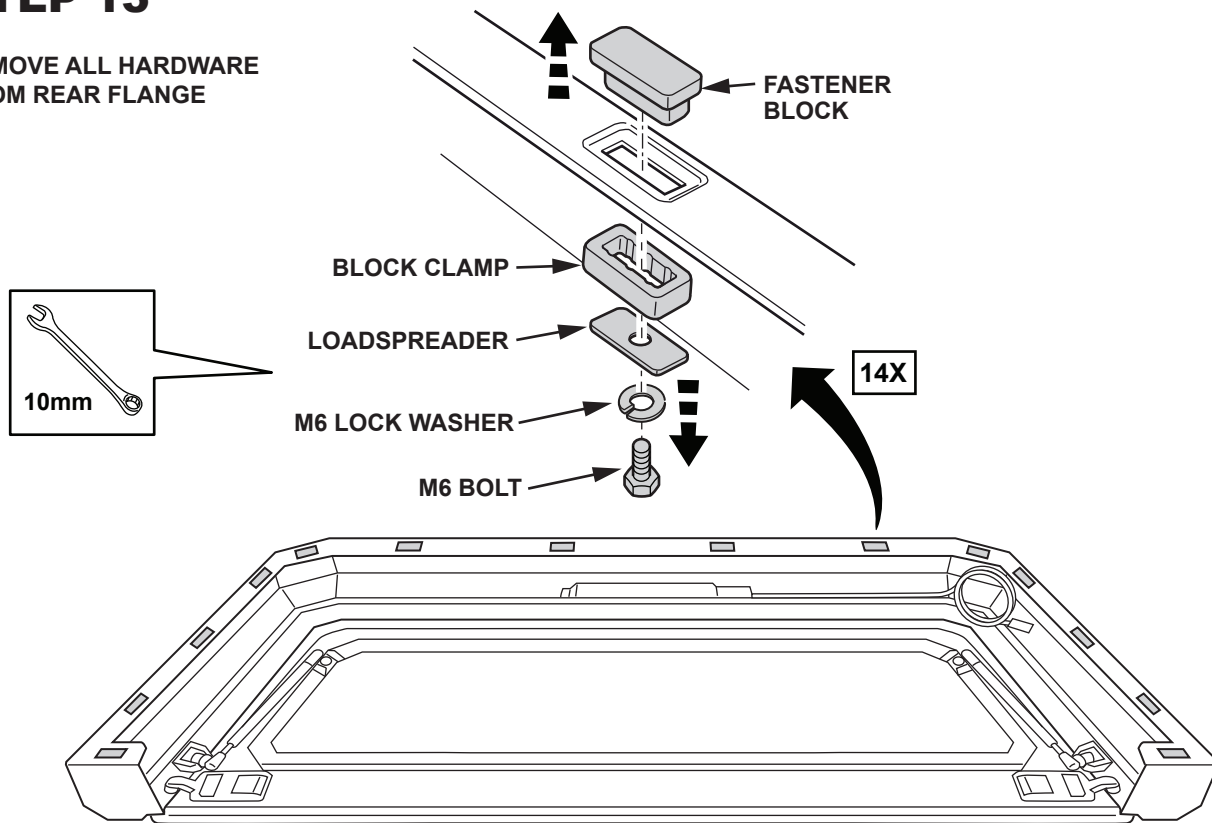

STEP 14

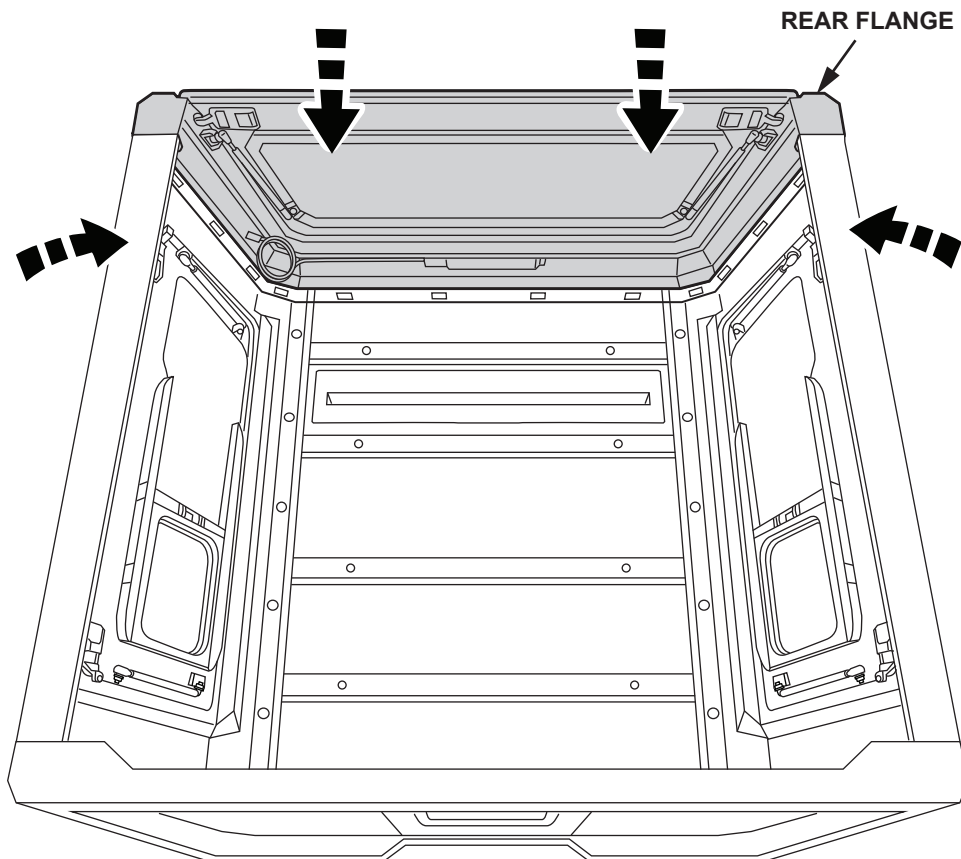
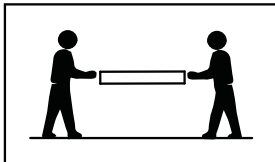

STEP 15

INSTALL HARDWARE
ALONG REAR FLANGE
WITH BOLT ON INSIDE

HAND TIGHTEN IN THE
SEQUENCE SHOWN

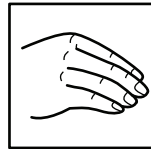

14X



BE SURE PANELS ARE FLUSH

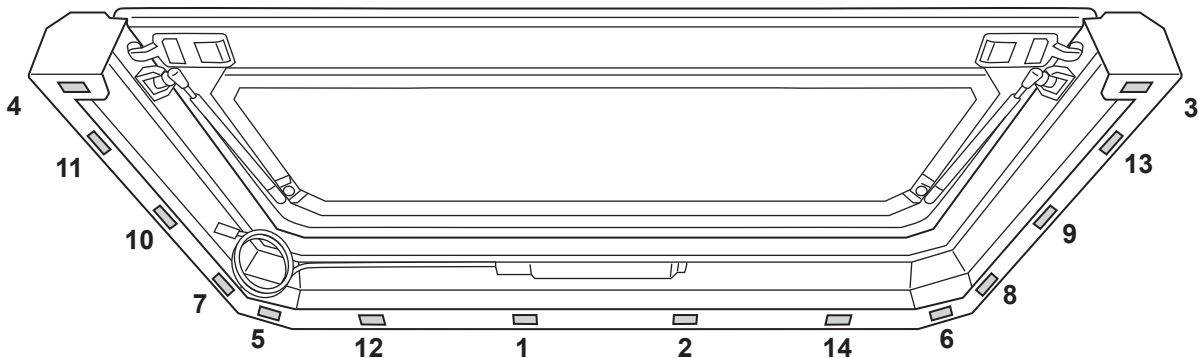
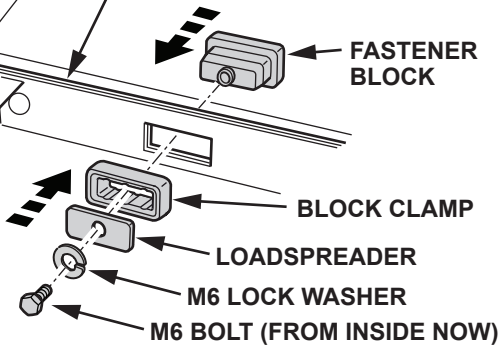

STEP 16

TIGHTEN ALL HARDWARE
WITH TORQUE WRENCH
AND 10mm SOCKET

14X

Min 6 N m
Max 12 N m
(4.4 lbs. ft.)

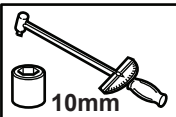

10mm

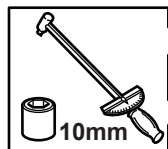

10mm

5X

Min 6 N m
Max 12 N m
(4.4 lbs. ft.)

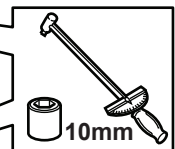

10mm

5X

Min 6 N m
Max 12 N m
(4.4 lbs. ft.)

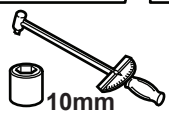
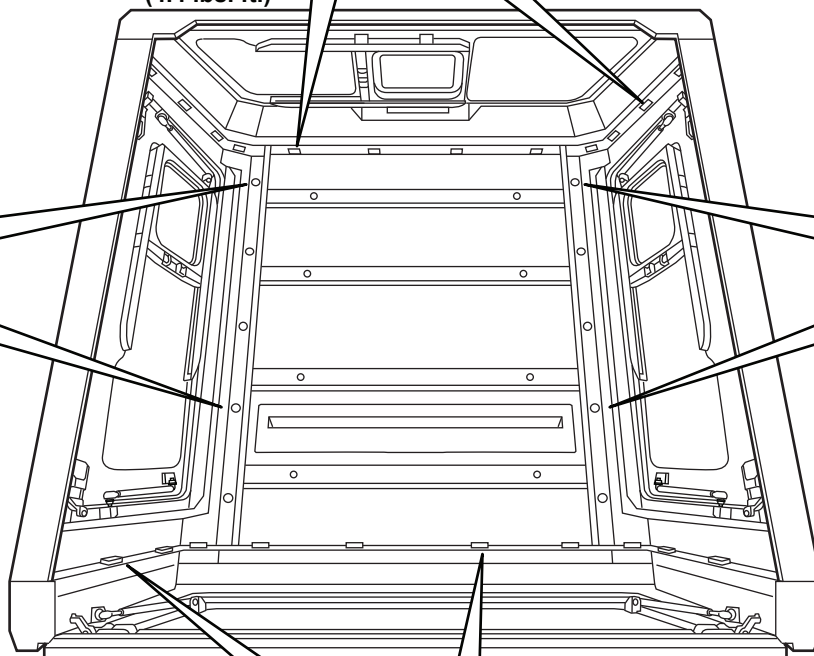

10mm

14X

Min 6 N m
Max 12 N m
(4.4 lbs. ft.)

STEP 17

APPLY D - RUBBER
TO BOTTOM OF SMARTCAP

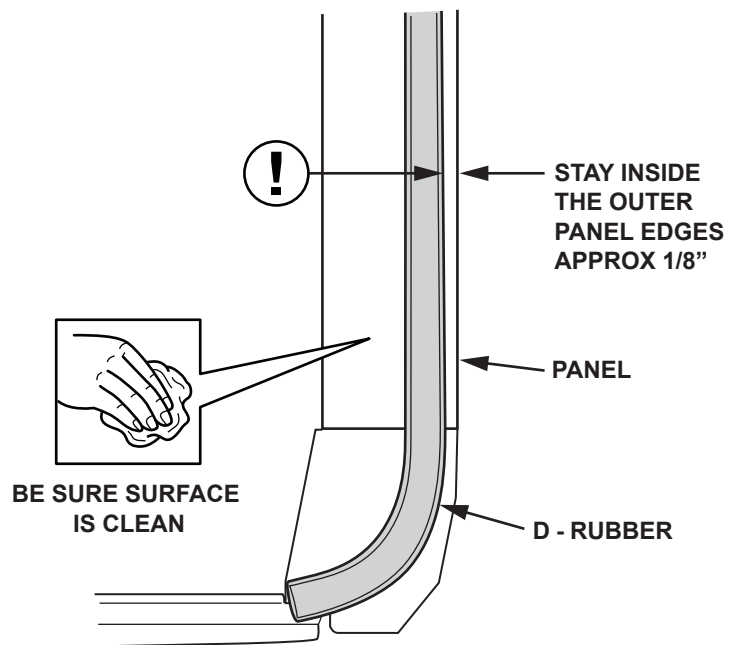
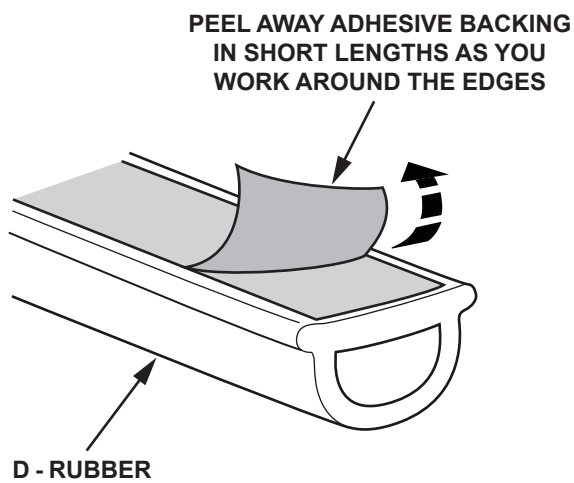

STEP 18

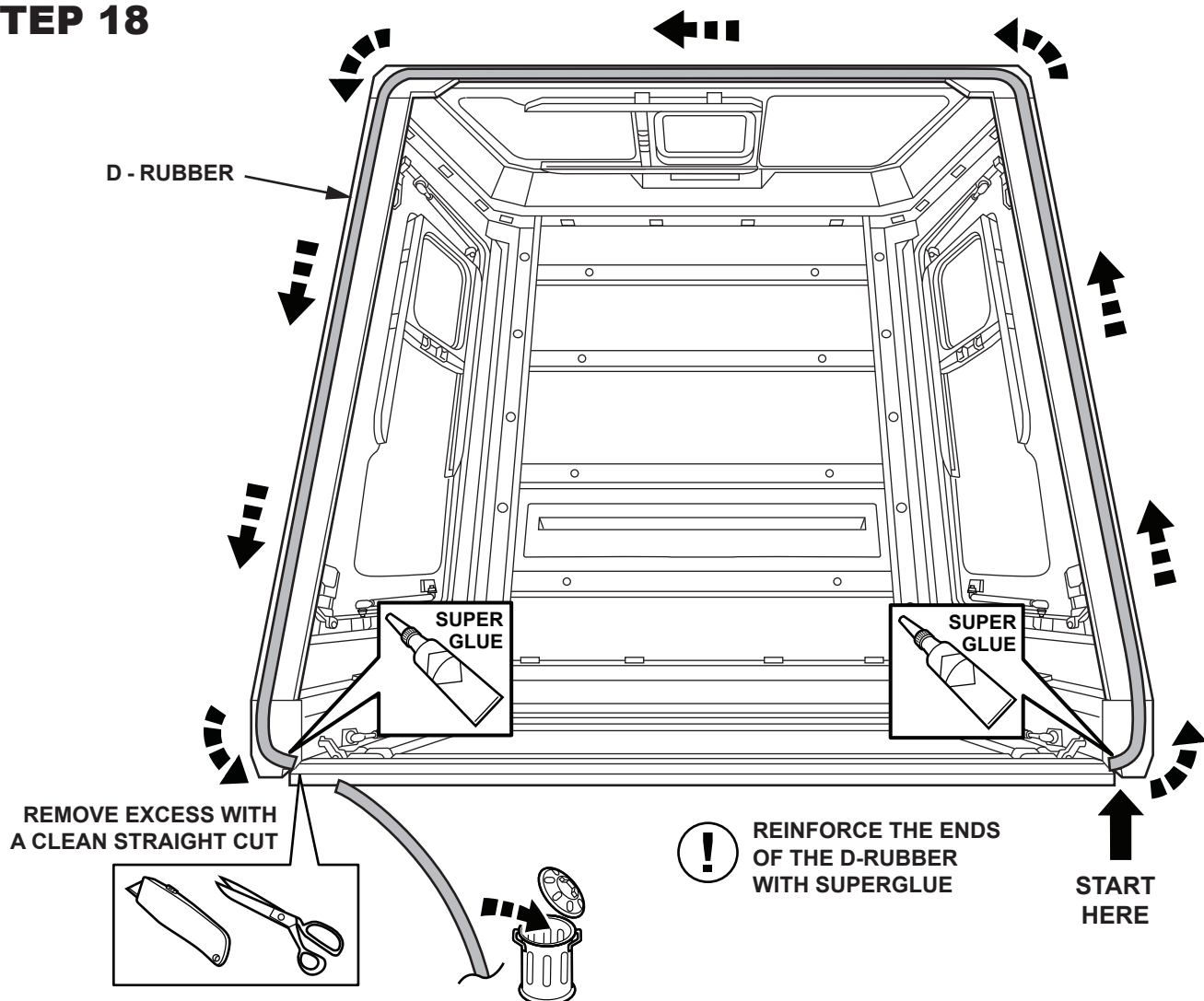

VEHICLE INSTALLATION

ASSEMBLY HARDWARE

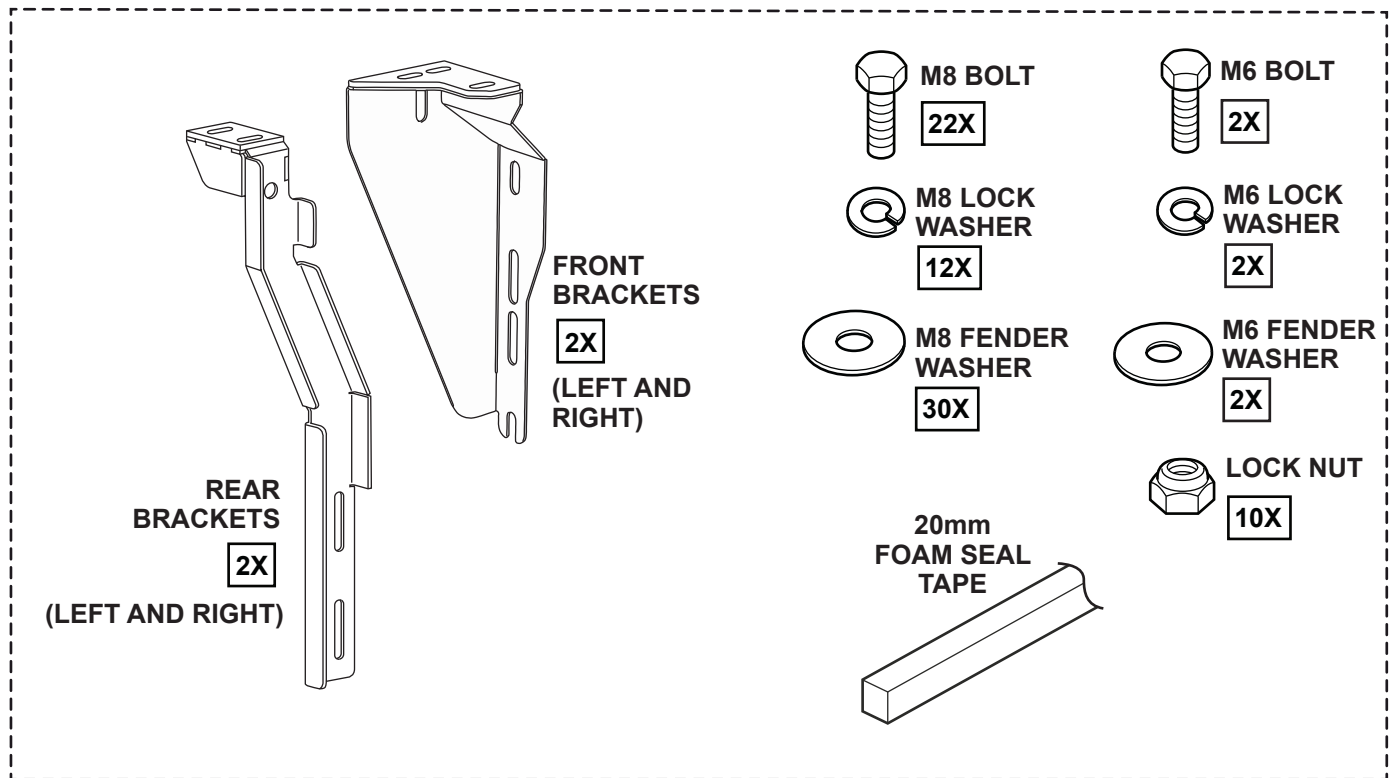

IMPORTANT

- ASSISTANCE WILL BE NEEDED FOR THIS INSTALLATION. FOUR PEOPLE ARE RECOMMENDED TO LIFT THE SMARTCAP ONTO THE VEHICLE.
- AVOID PINCHING OR CRUSHING HANDS AND FINGERS.

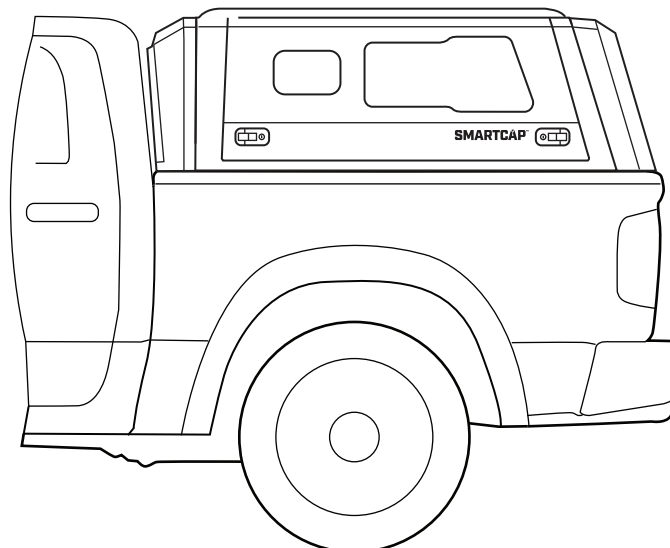

STEP 19

INSPECT THE TRUCK BED. IF FRONT EDGE IS LOWER THAN THE SIDES, ADD FOAM SEAL TAPE TO THE FRONT EDGE OF THE BED.

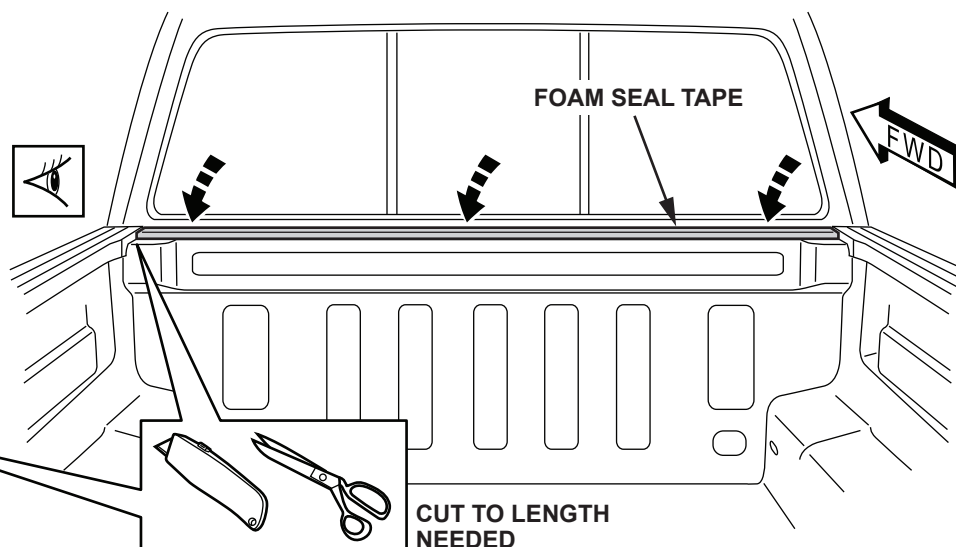
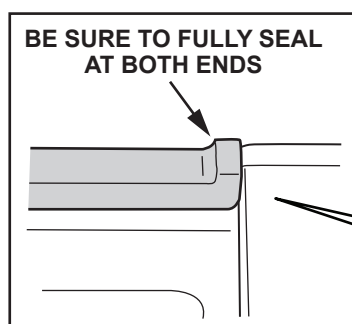
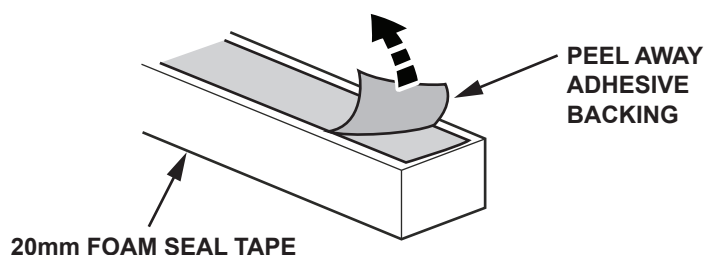

STEP 20

REMOVE THE FRONT TIE DOWN HOOK FROM THE INNER WALL OF THE TRUCK BED.

POSITION THE RIGHT SIDE FRONT MOUNTING BRACKET IN THE FRONT CORNER OF THE TRUCK BED AS SHOWN.

SECURE THE BRACKET WITH THE FASTENERS AS INDICATED, HAND TIGHTEN ONLY.

REPEAT ON THE OPPOSITE SIDE OF THE VEHICLE WITH THE LEFT FRONT MOUNTING BRACKET.

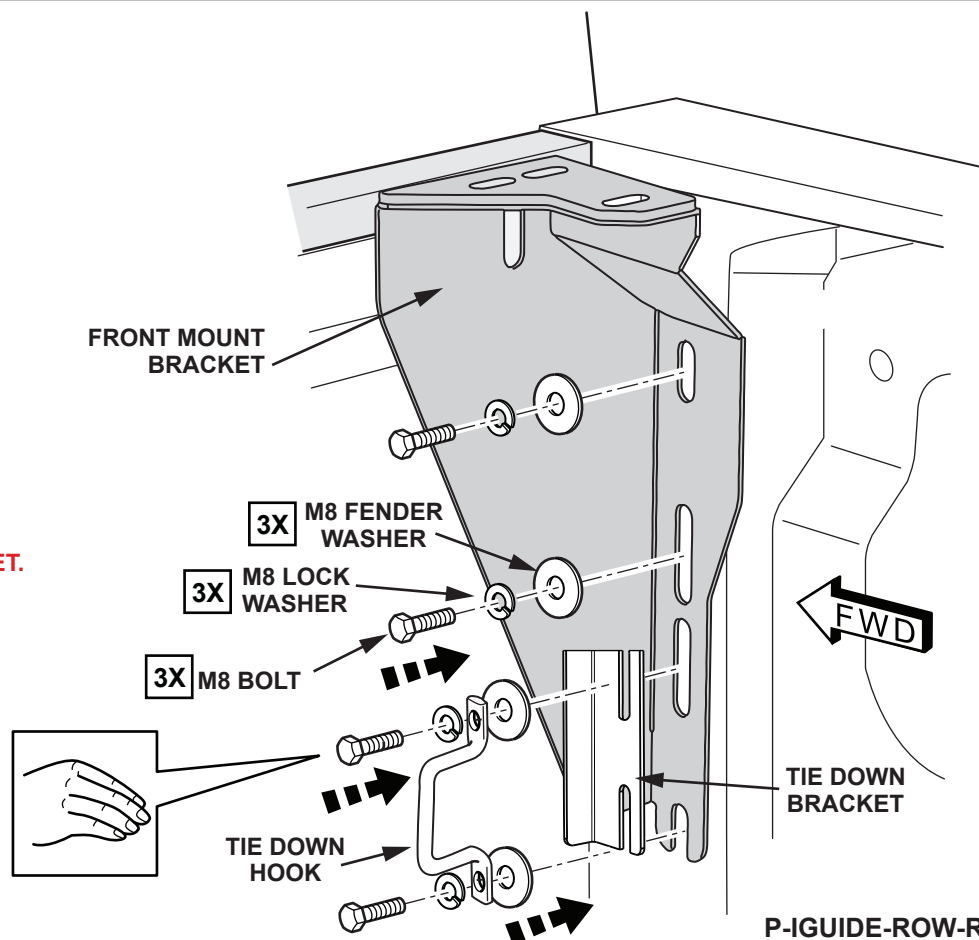

STEP 21

WITH THE REMAINING BOLT LOCATION, SECURE THE BRACKET WITH THE FASTENERS AS INDICATED, HAND TIGHTEN ONLY.

REPEAT ON THE OPPOSITE SIDE OF THE VEHICLE WITH THE LEFT FRONT MOUNTING BRACKET.

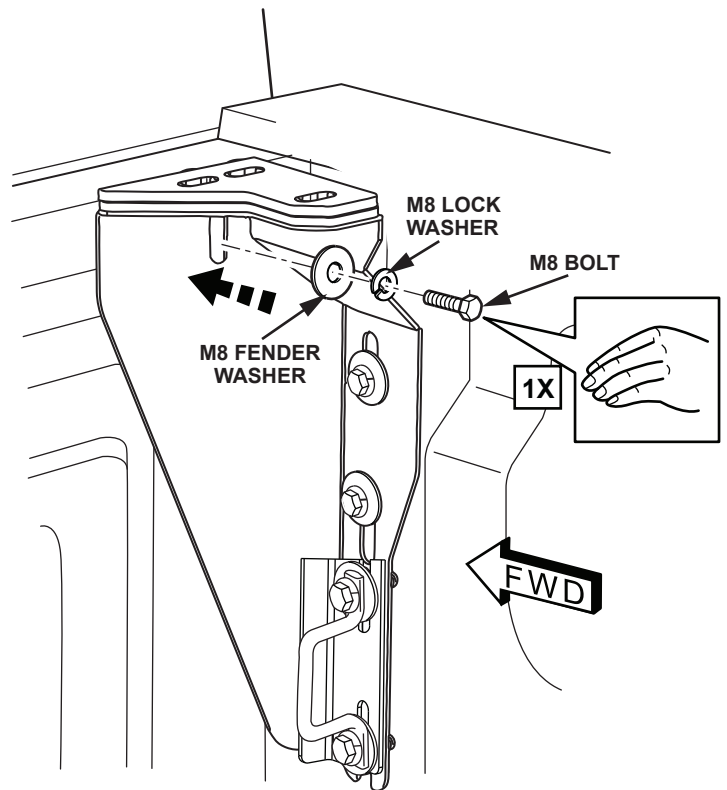

STEP 22

REMOVE THE REAR TIE DOWN HOOK FROM THE INNER WALL OF THE TRUCK BED.

POSITION THE RIGHT SIDE REAR MOUNTING BRACKET IN THE BACK CORNER OF THE TRUCK BED AS SHOWN.

SECURE THE BRACKET WITH THE FASTENERS AS INDICATED, HAND TIGHTEN ONLY.

REPEAT ON THE OPPOSITE SIDE OF THE VEHICLE WITH THE LEFT REAR MOUNTING BRACKET.

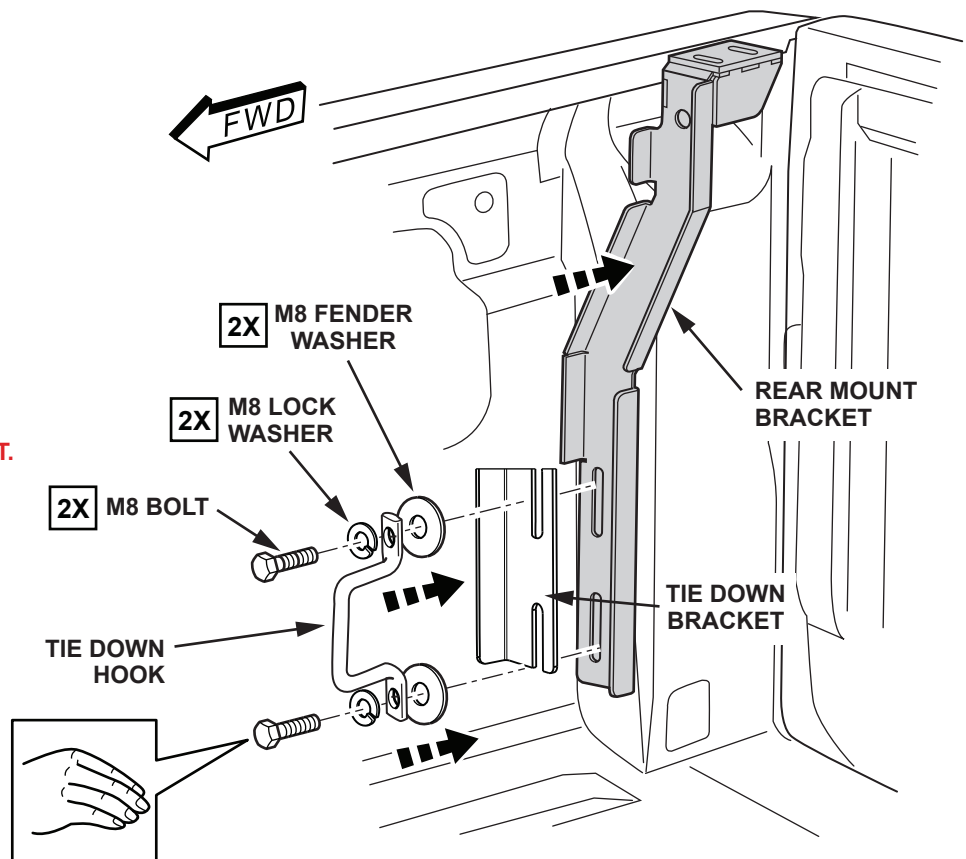

STEP 23

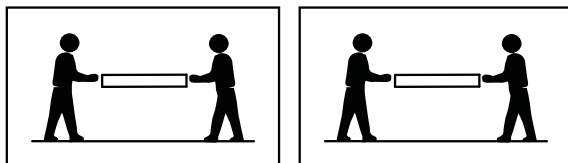

LIFT THE ASSEMBLED SMARTCAP ONTO THE TRUCK BED

! BE SURE NOT TO SCRAPE OR
DAMAGE THE D-RUBBER

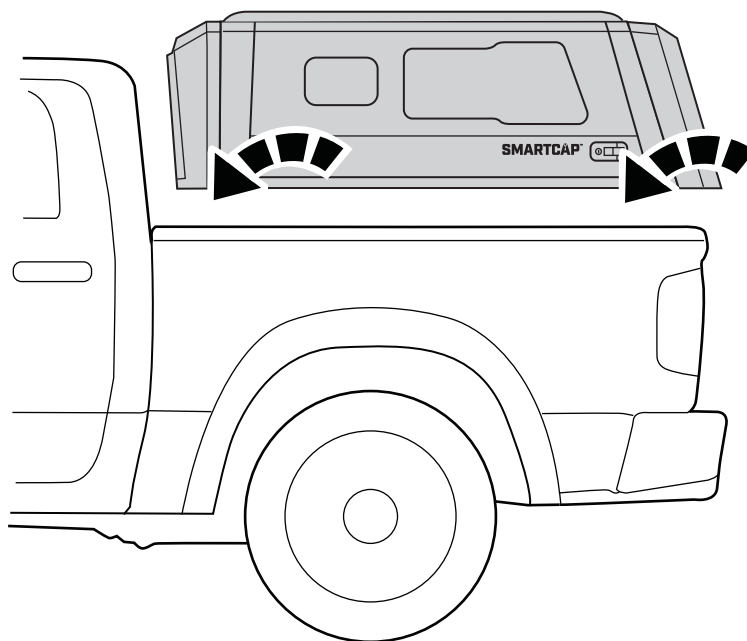

CHECK THAT THE SMARTCAP IS
PROPERLY POSITIONED AND
CENTERED ON THE TRUCK BED

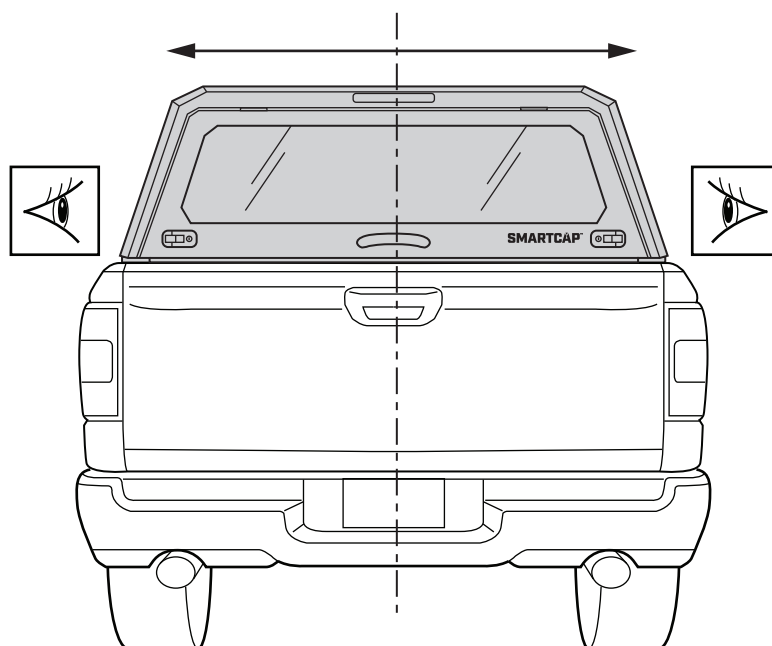

STEP 24

SECURE THE SMARTCAP TO THE RIGHT FRONT MOUNTING BRACKET WITH THE FASTENERS AS INDICATED, HAND TIGHTEN ONLY.

REPEAT ON THE OPPOSITE SIDE OF THE VEHICLE WITH THE LEFT FRONT MOUNTING BRACKET.

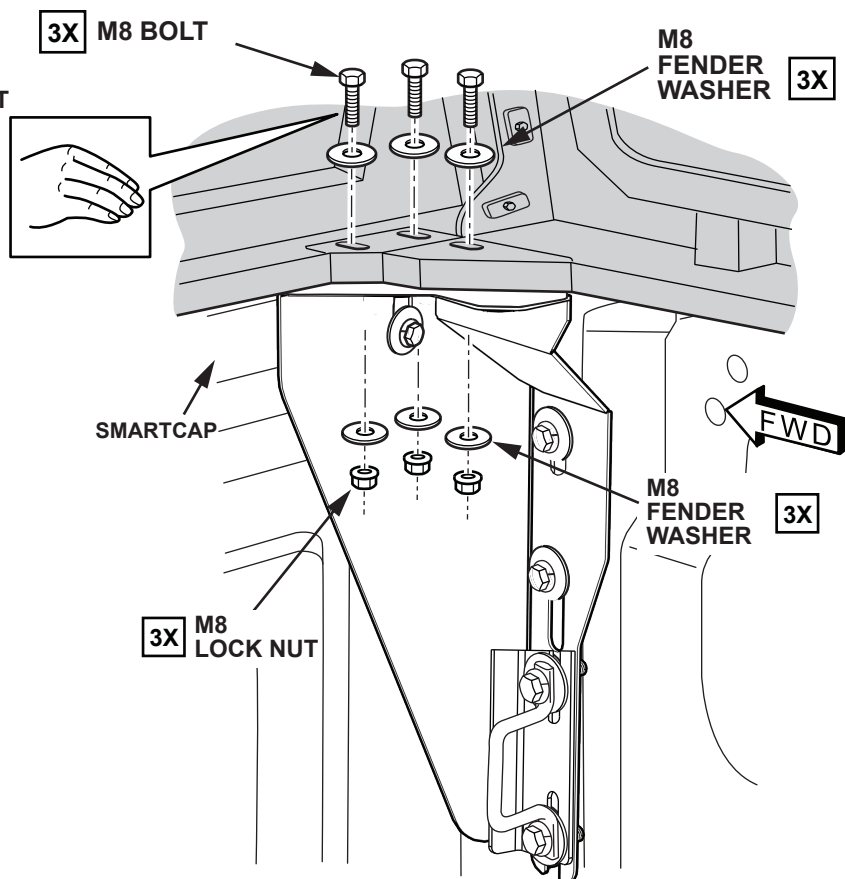

STEP 25

SECURE THE SMARTCAP TO THE RIGHT REAR MOUNTING BRACKET WITH THE FASTENERS AS INDICATED, HAND TIGHTEN ONLY.

REPEAT ON THE OPPOSITE SIDE OF THE VEHICLE WITH THE LEFT REAR MOUNTING BRACKET.

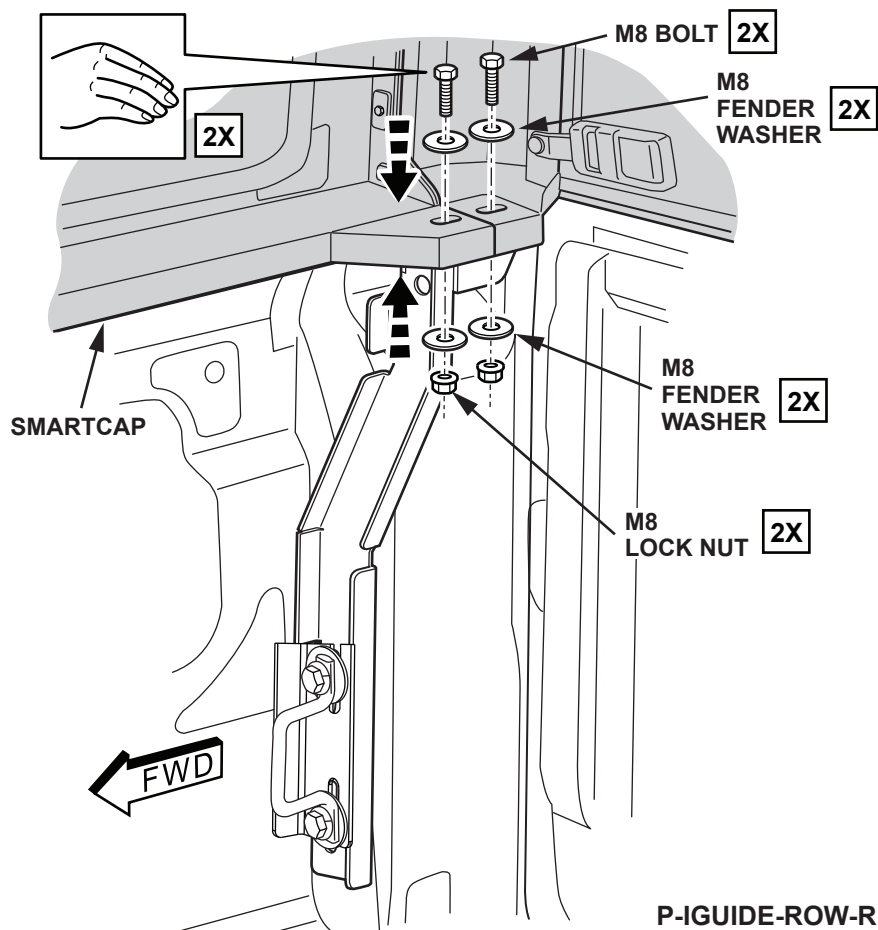

STEP 26

ONCE ALL THE SMARTCAP FASTENERS ARE INSTALLED, TIGHTEN WITH TORQUE WRENCH AS INDICATED.

TIGHTEN FASTENERS ON ALL FOUR CORNERS OF THE VEHICLE

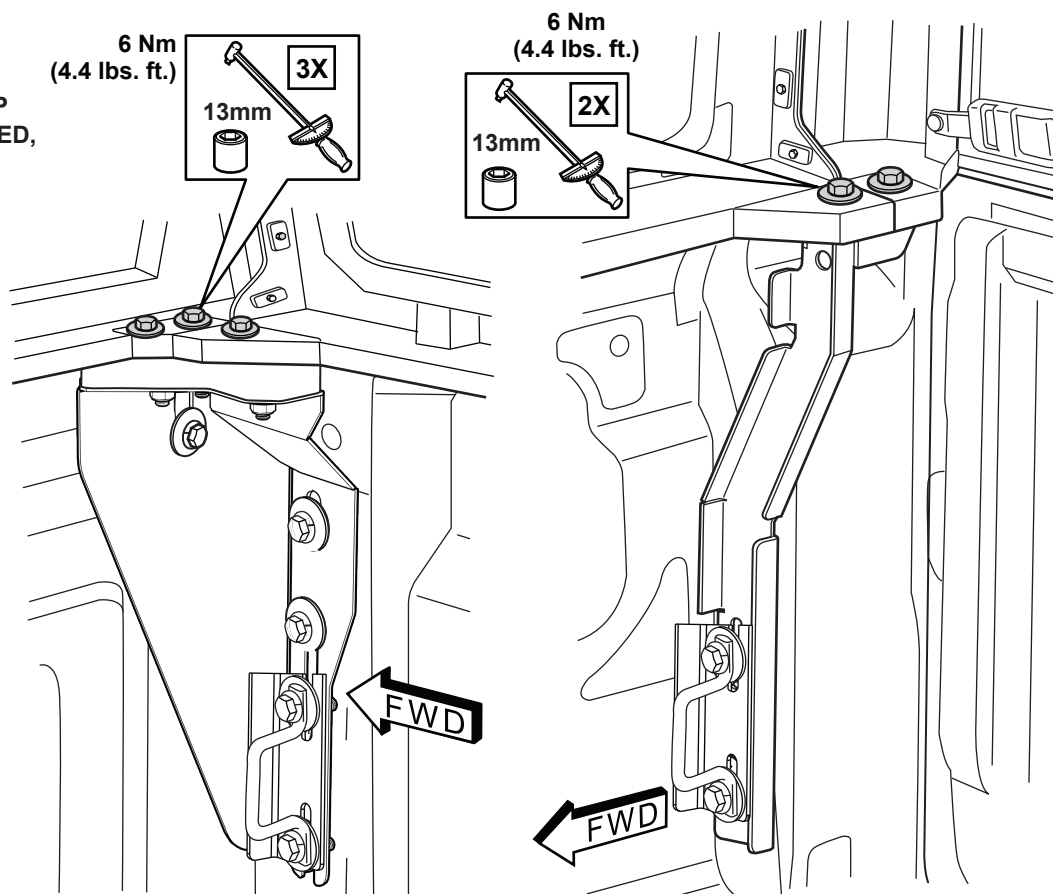

STEP 27

PRESS DOWN ON SMARTCAP TO ACHIEVE 2mm - 3mm COMPRESSION ON THE D-RUBBER AND TIGHTEN BRACKET FASTENERS WITH TORQUE WRENCH AS INDICATED.

TIGHTEN FASTENERS ON ALL FOUR CORNERS OF THE VEHICLE

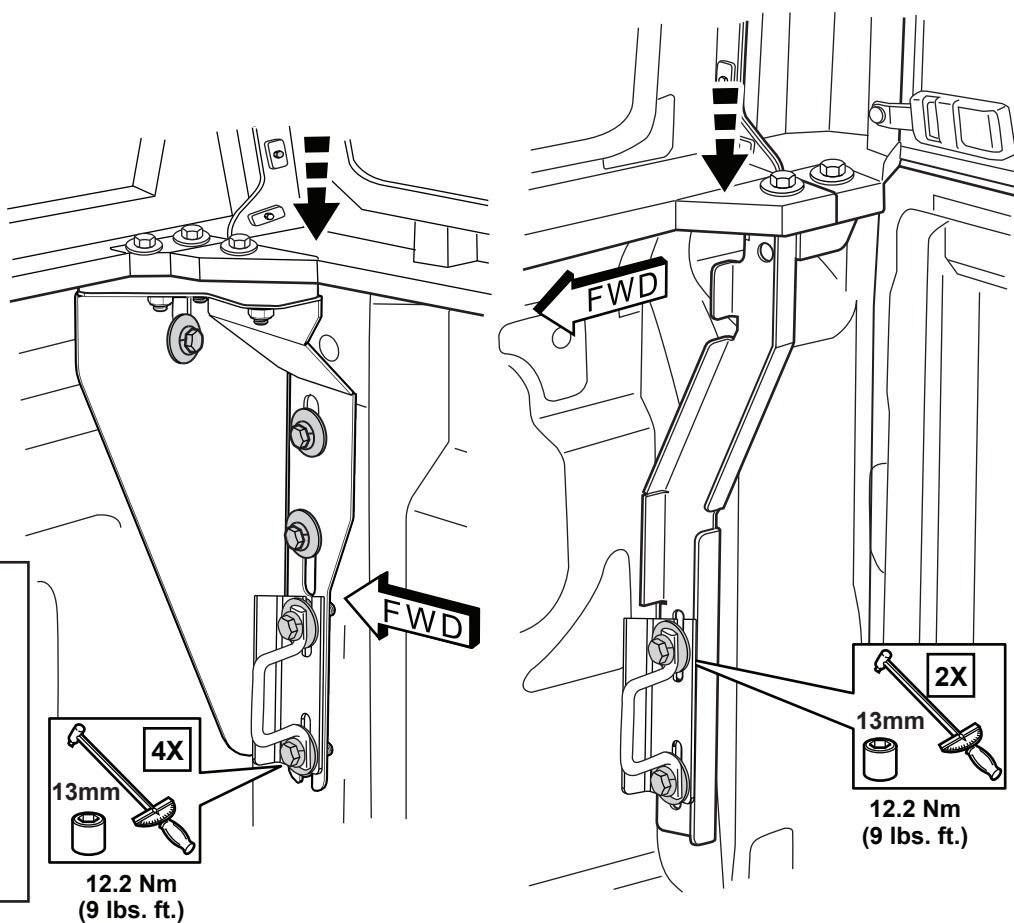
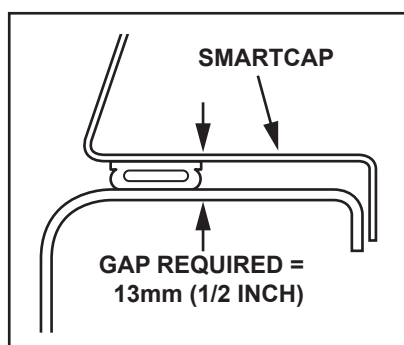

THIRD BRAKE LIGHT CONNECTOR INSTALLATION

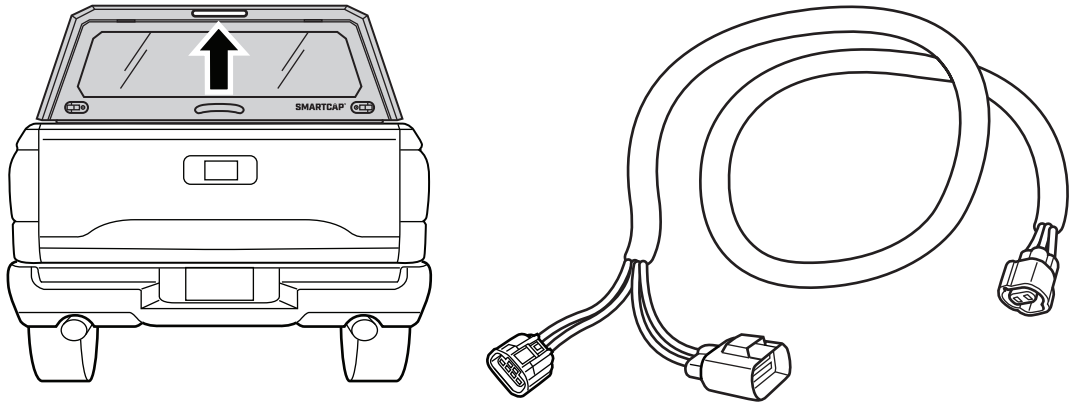

IMPORTANT

- BE SURE THE VEHICLE IS TURNED OFF FOR THIS INSTALLATION.
- READ THROUGH THE ENTIRE PROCEDURE BEFORE STARTING AND FOLLOW THE STEPS CAREFULLY TO ENSURE THE THIRD BRAKE LIGHT AND TRAILER PLUG WILL FUNCTION PROPERLY.
- USE A TEST LIGHT TO CHECK FOR SUCCESSFUL INSTALLATION.

STEP 1

REMOVE THE LEFT SIDE
TAIL LIGHT ASSEMBLY.

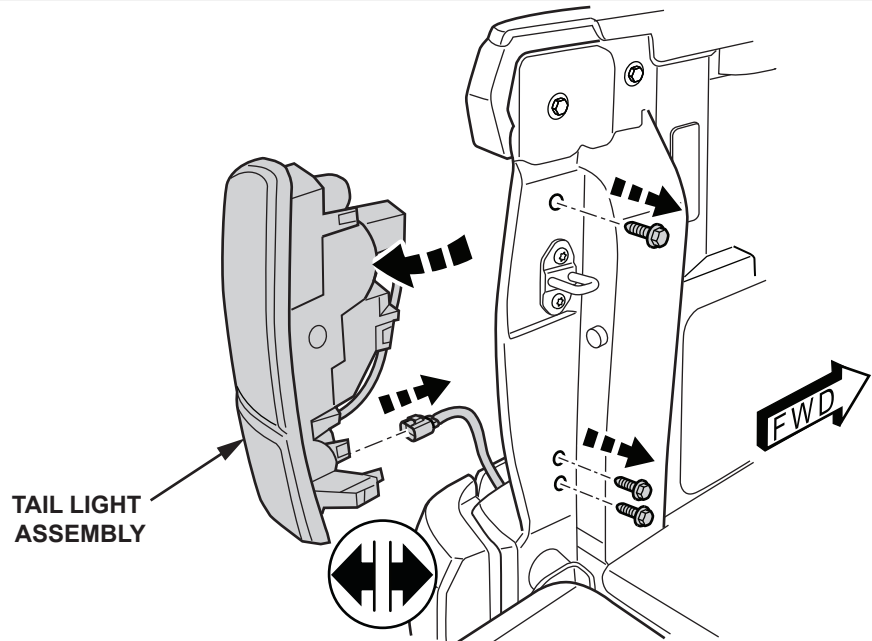

STEP 2

LOCATE THE THIRD BRAKE LIGHT 2-PIN
PLUG INSIDE THE BACK LEFT CORNER
OF THE SMARTCAP.

CONNECT THE NEW T-HARNESS
TO THE 2-PIN PLUG.

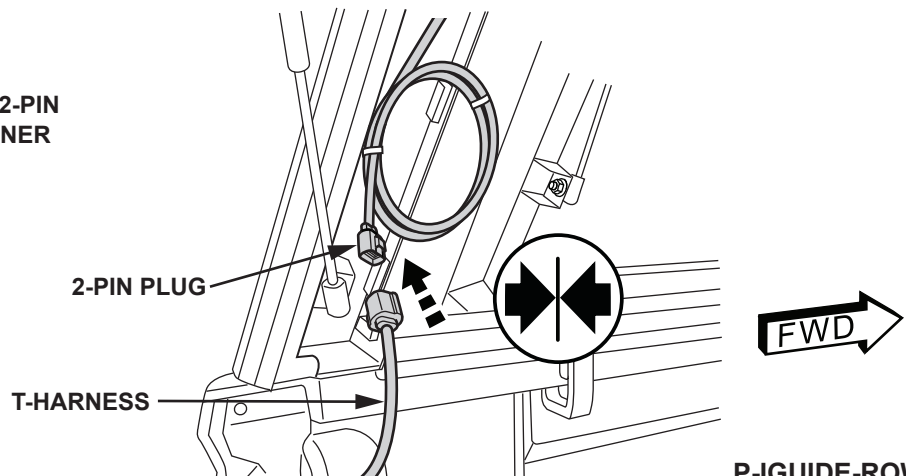

STEP 3

REMOVE THE GROMMET COVER AT THE TRUCK BED WALL.

ROUTE THE T-HARNESS IN THROUGH THE GROMMET PANEL OPENING AND OUT THROUGH THE TAIL LAMP OPENING.

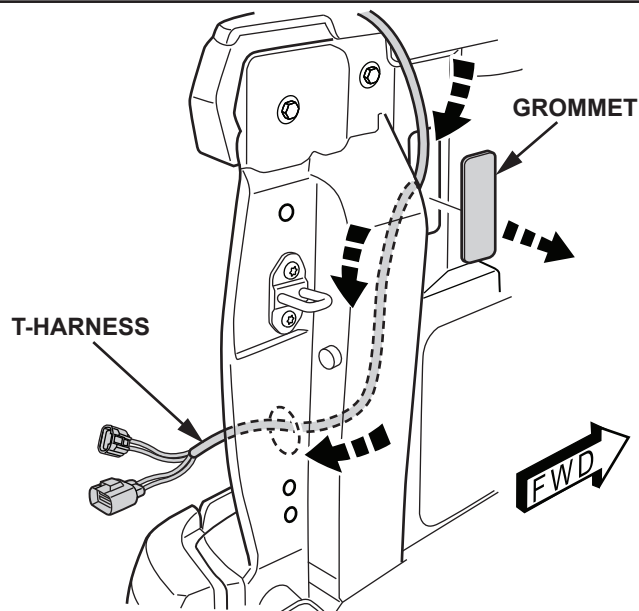

STEP 4

CONNECT THE BRAKE LIGHT PLUG INTO THE FEMALE PLUG FROM THE T-HARNESS.

CONNECT THE MALE PLUG FROM THE T-HARNESS INTO THE TAIL LIGHT BRAKE LIGHT SOCKET.

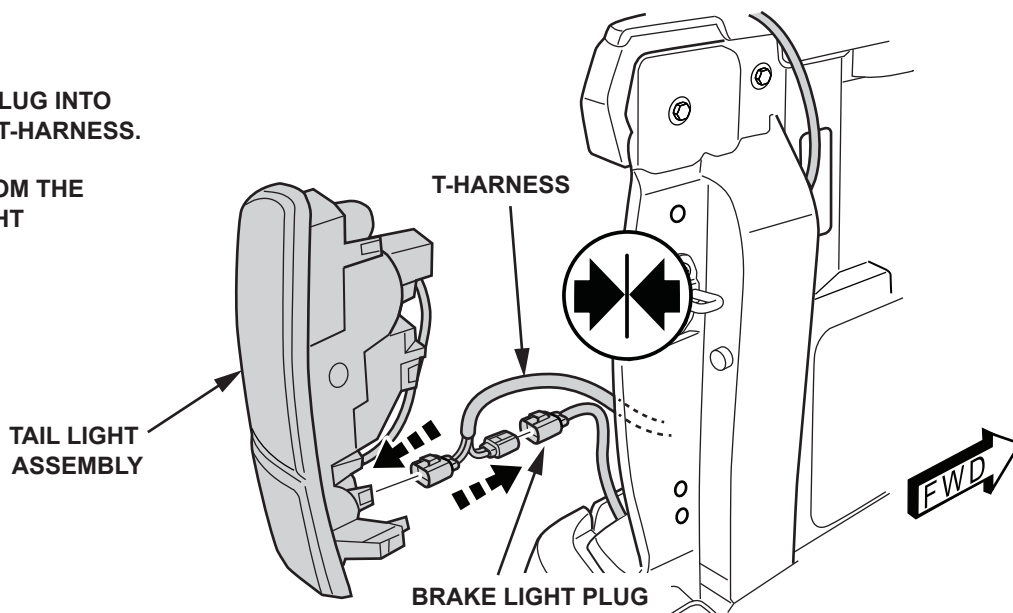

STEP 5

TEST THE BRAKE LIGHTS AND TURN SIGNALS TO BE SURE THEY ARE FUNCTIONING PROPERLY.

REINSTALL THE TAIL LIGHT ASSEMBLY.

REINSTALL THE TRUCK BED GROMMET.

BUNDLE EXTRA T-HARNESS LENGTH IN THE TAIL LIGHT CAVITY AND SECURE WITH A CABLE TIE.

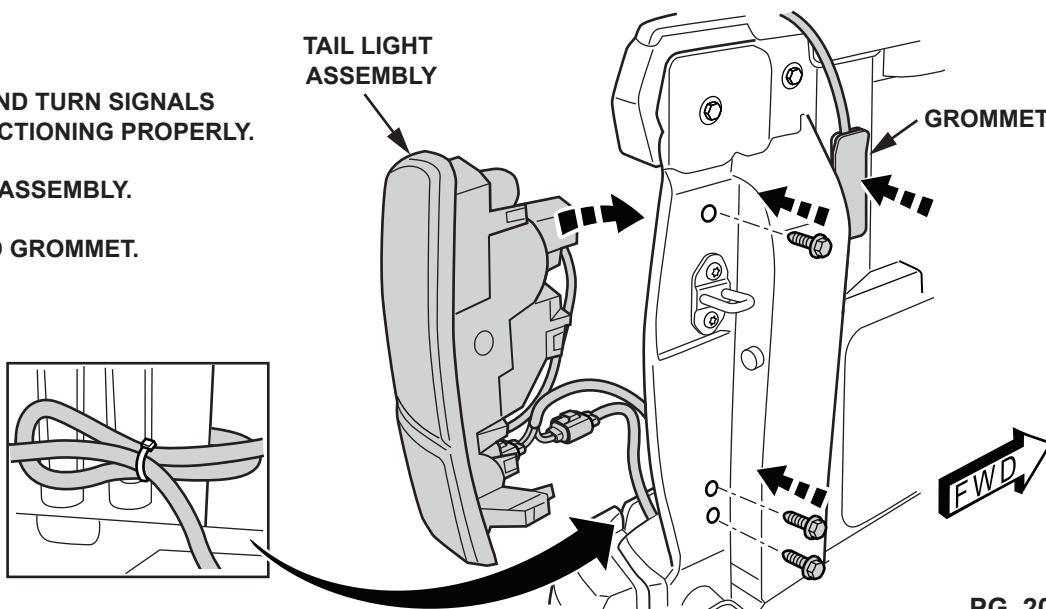

STEP 6

START THE TRUCK. NOTE THAT ON SOME MODELS, IT MAY TAKE UP TO 30 SECONDS FOR THE VEHICLE TO DETECT THE NEW CONNECTION. CHECK THE BRAKE LIGHTS AND TURN SIGNALS TO BE SURE THEY ARE FUNCTIONING PROPERLY.

ONCE YOU HAVE CONFIRMED THAT THE LIGHTS ARE WORKING CORRECTLY, SECURE THE HARNESS WITH CABLE TIES. **BE SURE NOT TO INTERFERE WITH ANY MOVING PARTS ON THE VEHICLE.**



THANKS FOR YOUR PURCHASE.
PLEASE LET US KNOW IF YOU HAVE ANY QUESTIONS.

SMARTCAP.COM - SUPPORT.SA@SMARTCAP.COM - SOUTH AFRICA

