

SMARTCAP®

INSTRUCTION GUIDE

FORD RANGER EDITION

2023

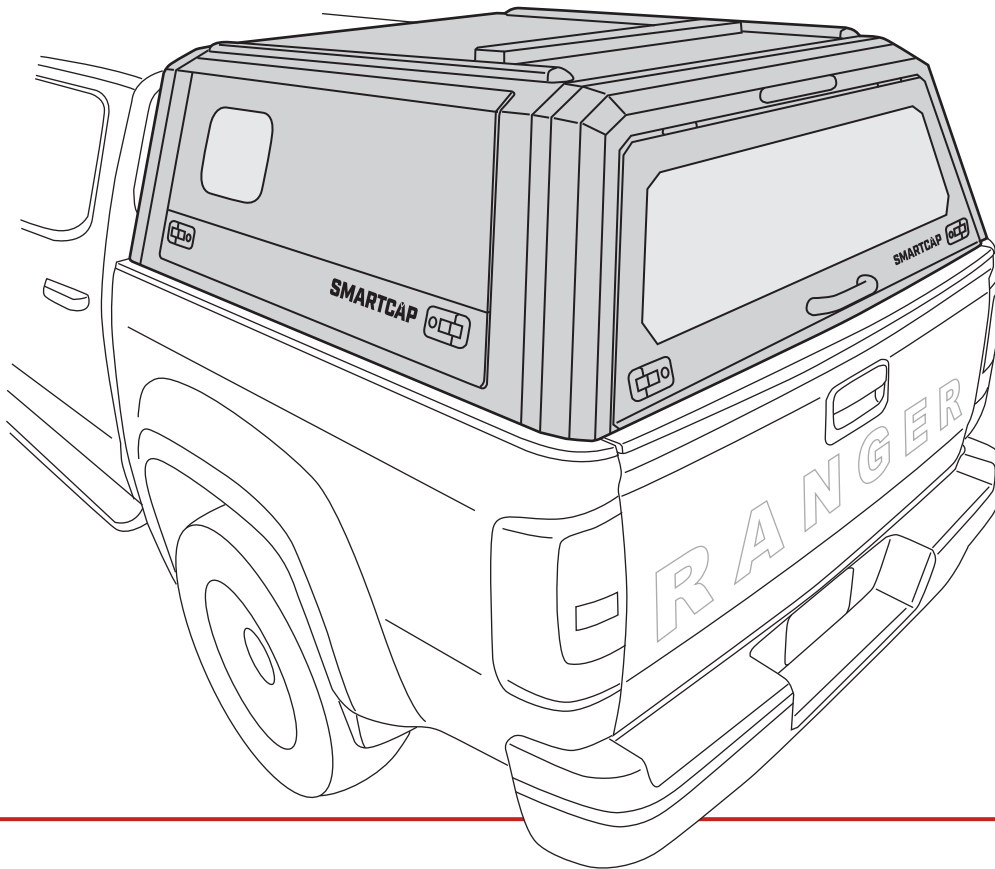

- ▼ **READ THROUGH THE ENTIRE INSTRUCTION GUIDE BEFORE STARTING THIS PROCEDURE AND FOLLOW THE STEPS CAREFULLY TO AVOID ANY DAMAGE TO THE COMPONENTS OR THE VEHICLE.**

SMARTCAP.COM - SUPPORT.SA@SMARTCAP.COM - SOUTH AFRICA



P-IGUIDE-ROW-R2

TOOLS REQUIRED

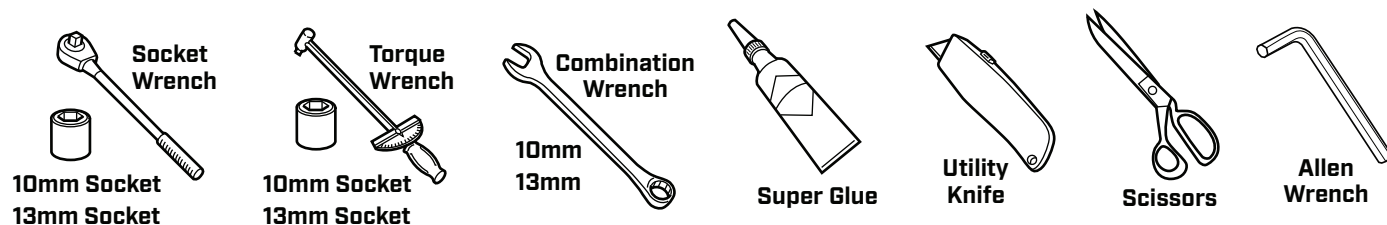

IMPORTANT

- ▼ USE ONLY THE TOOLS RECOMMENDED ABOVE.
- ▼ USE ONLY THE HARDWARE PROVIDED IN THIS KIT.
- ▼ ASSISTANCE WILL BE NEEDED FOR THIS INSTALLATION. FOUR PEOPLE ARE RECOMMENDED TO LIFT THE SMARTCAP ONTO THE VEHICLE.
- ▼ AVOID PINCHING OR CRUSHING HANDS AND FINGERS.
- ▼ INSPECT ALL KIT COMPONENTS FOR DAMAGE BEFORE ASSEMBLY.
- ▼ NEVER USE ACETONE OR THINNERS ON PAINTED PARTS.

COMPONENTS

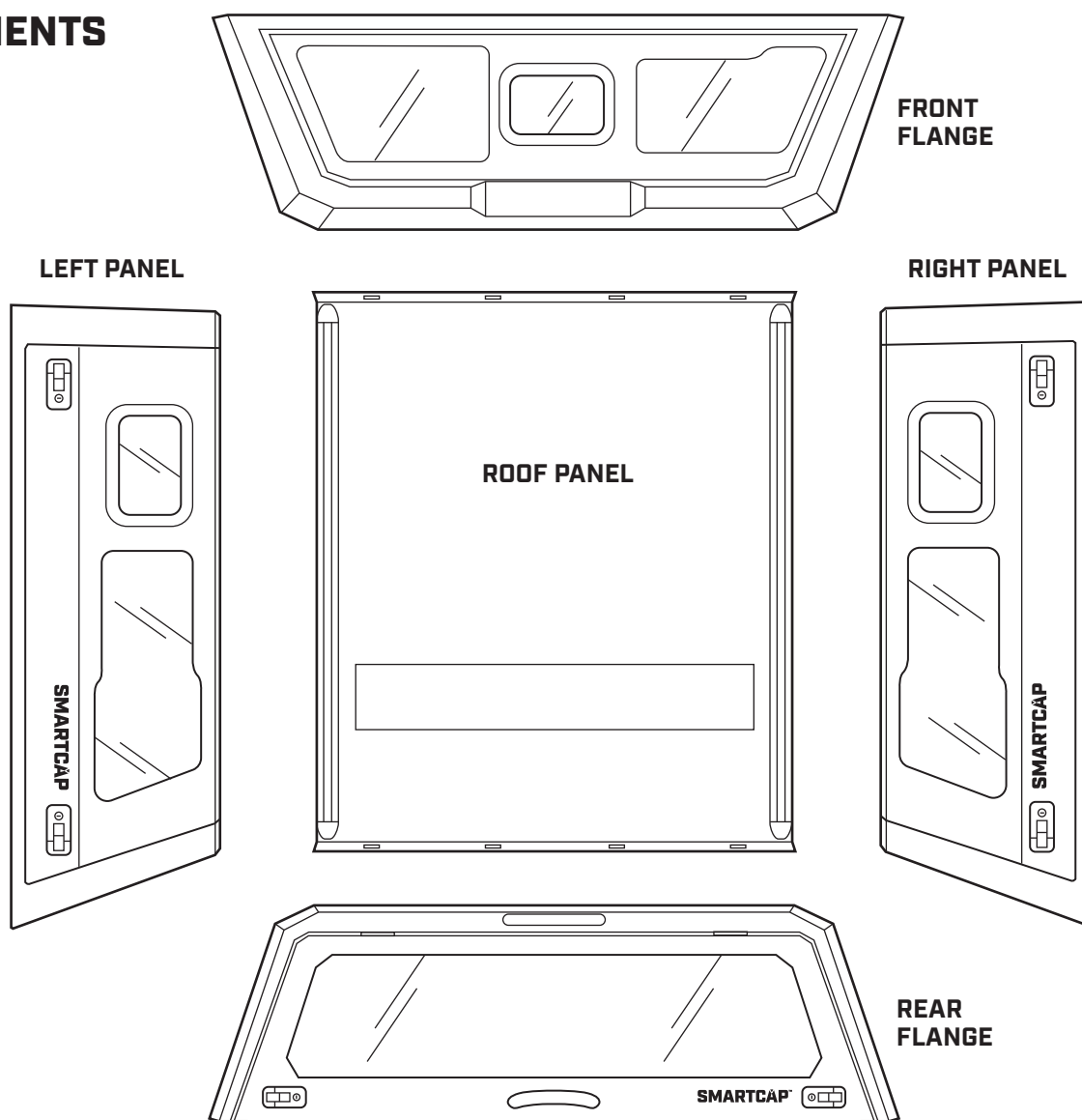

ASSEMBLY HARDWARE

[PRE-FASTENED TO FLANGES]

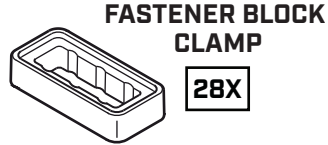
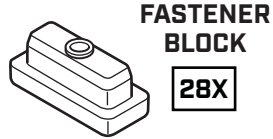
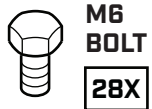

[PRE-FASTENED TO ROOF PANEL]



10X SHORT BED

12X STANDARD BED



10X SHORT BED

12X STANDARD BED

SPARE HARDWARE 1X

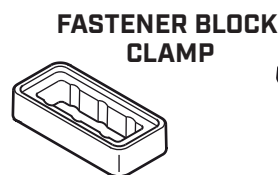
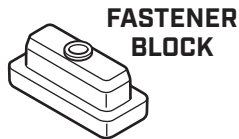
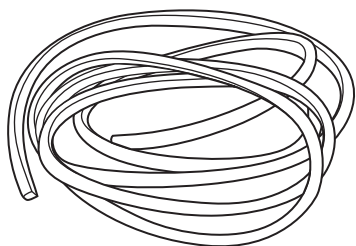

STEP 1

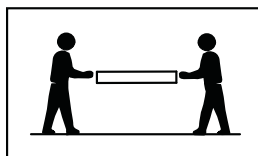

IMPORTANT

- ▼ BE SURE TO REMOVE ALL FIVE PANELS FROM THEIR PACKAGING AND INSPECT THE PAINTED SURFACES PRIOR TO ASSEMBLY, AS SMARTCAP WILL NOT ACCEPT PAINT DAMAGE WARRANTY CLAIMS AFTER ASSEMBLY IS COMPLETED. IF MANUFACTURING IMPERFECTIONS OR SHIPPING DAMAGES ARE FOUND DO NOT CONTINUE WITH THE ASSEMBLY PROCESS AND CONTACT SUPPORT.SA@SMARTCAP.COM.

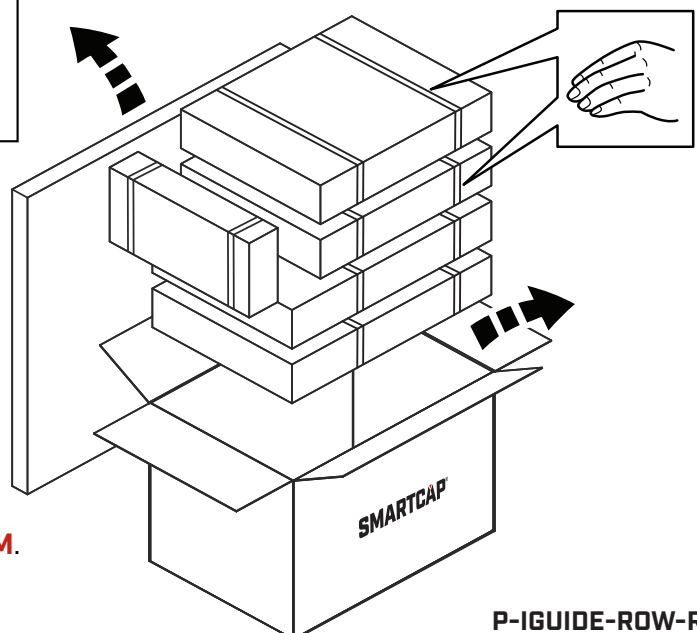

STEP 2

REMOVE ALL HARDWARE
FROM ROOF PANEL



THIS SIDE UP
ROOF
PANEL

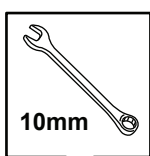
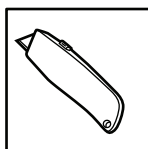
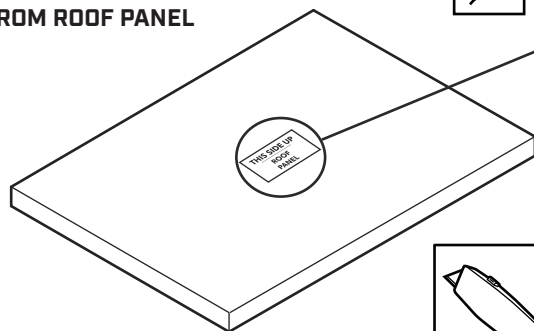

10mm

M6
LOCK NUT

M6
FENDER
WASHER

10X SHORT BED
12X STANDARD BED

ROOF PANEL

[USE THE CARDBOARD
AS A WORK SURFACE]

STEP 3

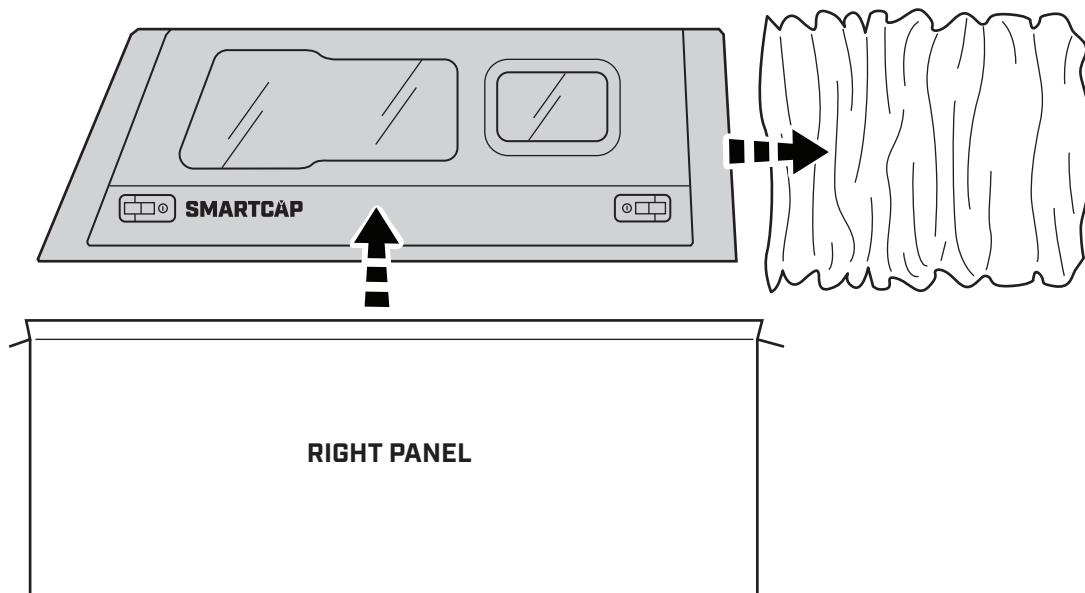

RIGHT PANEL

STEP 4

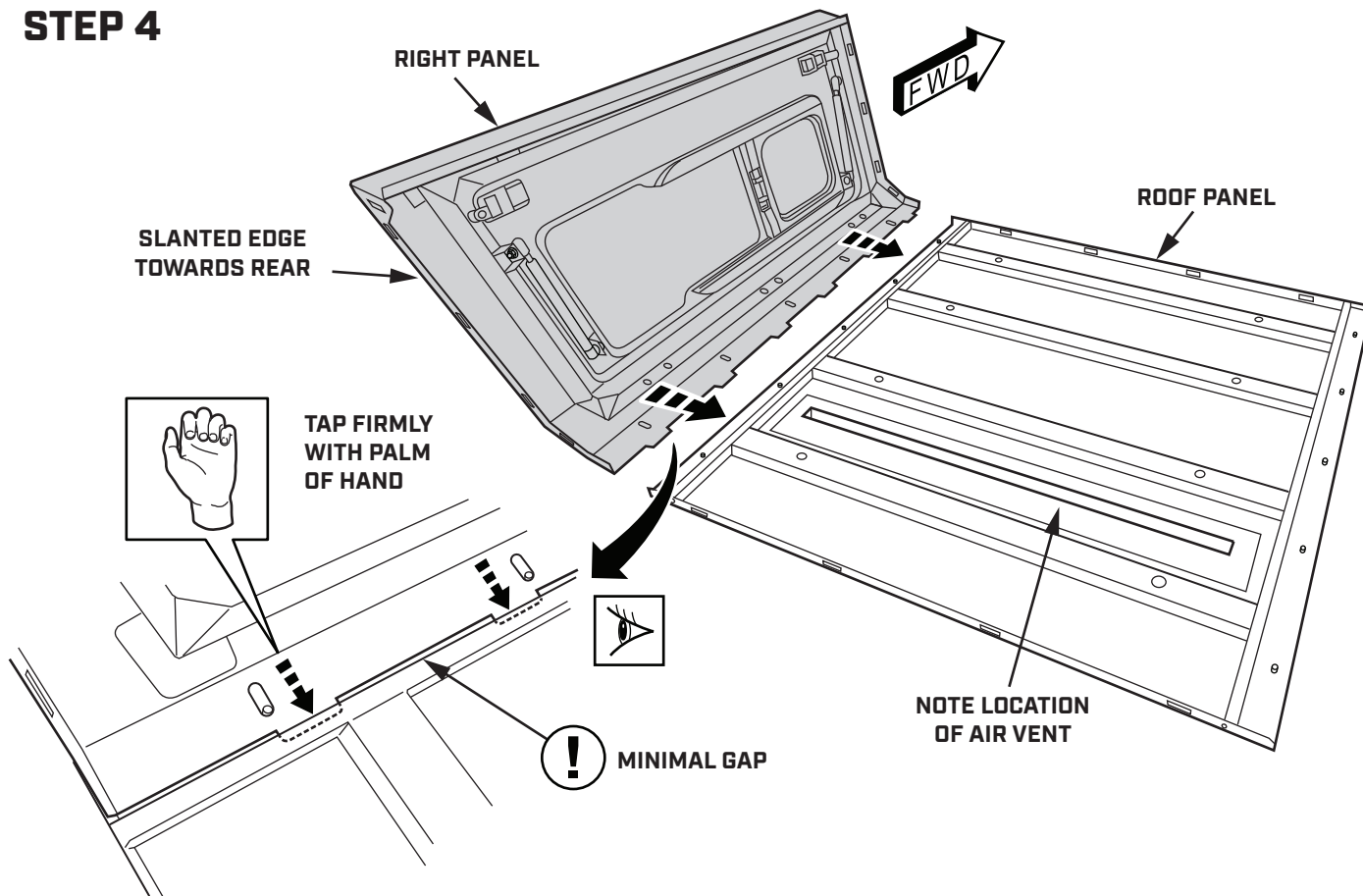

STEP 5

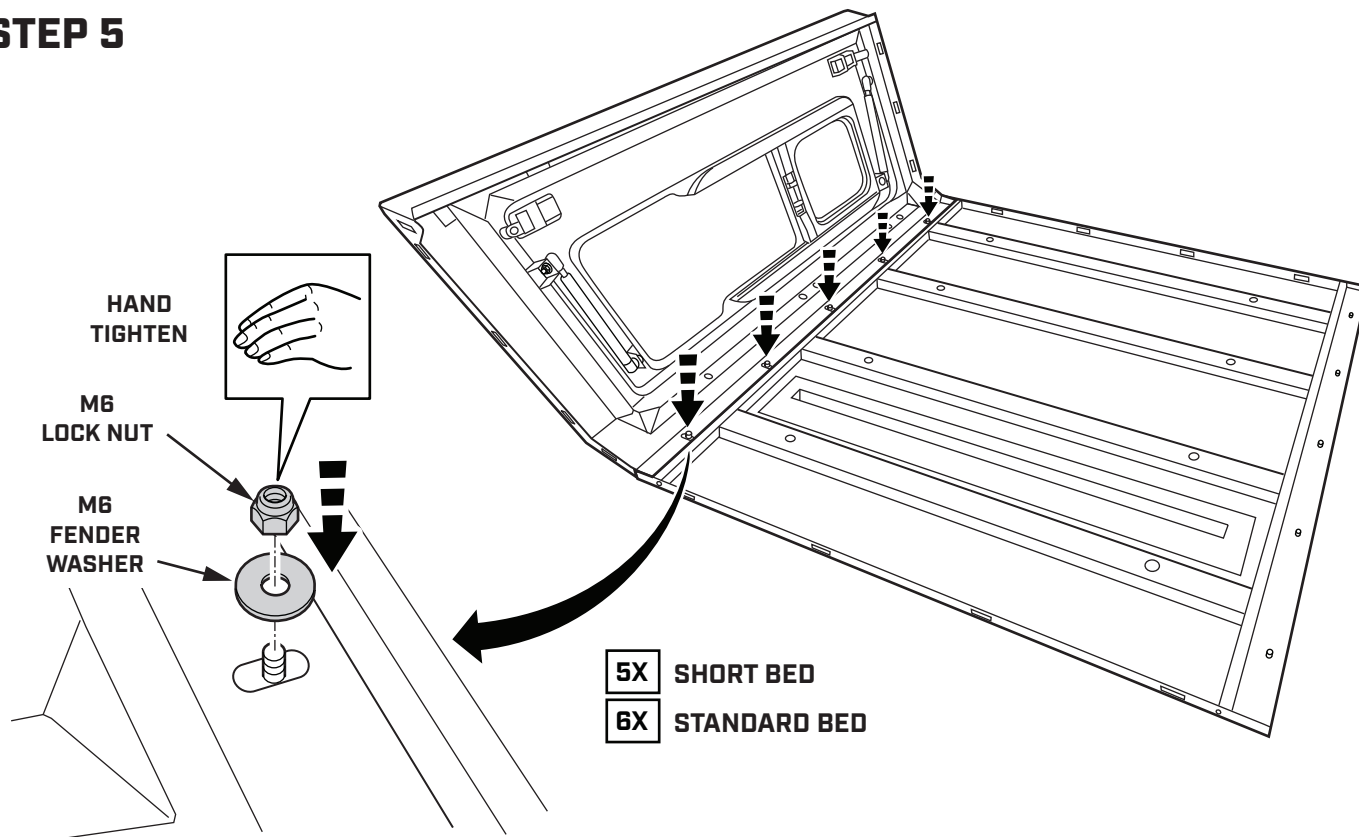

STEP 6

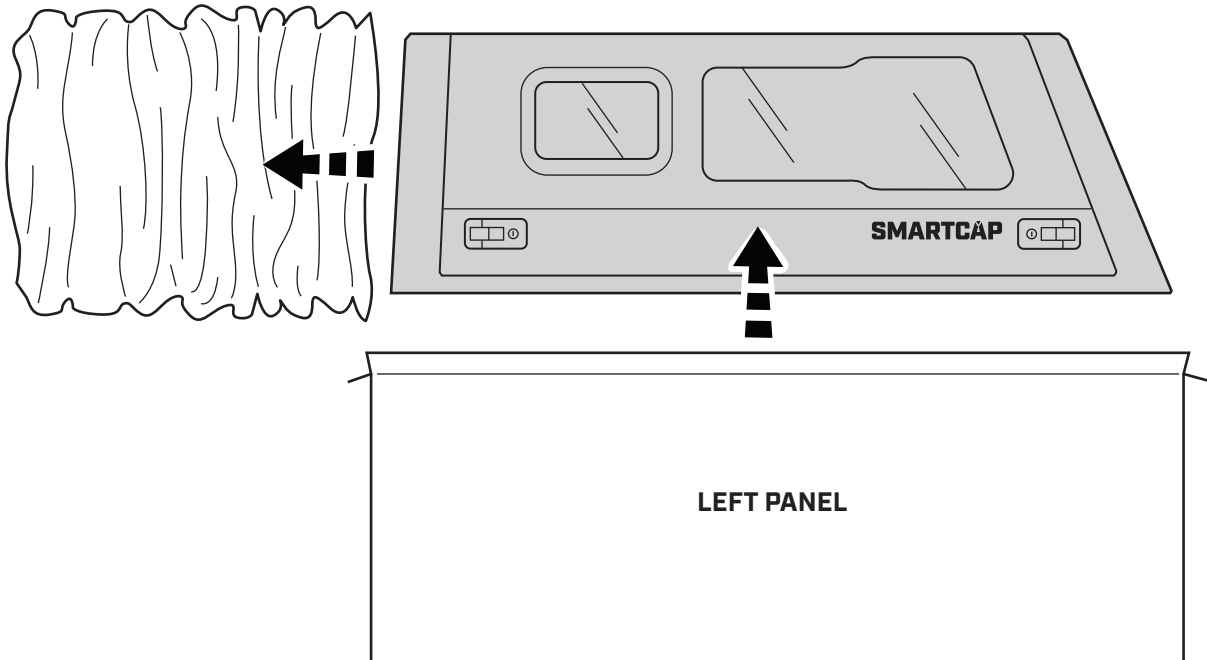
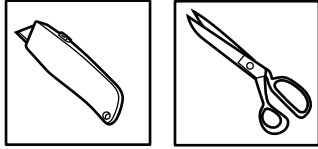

STEP 7

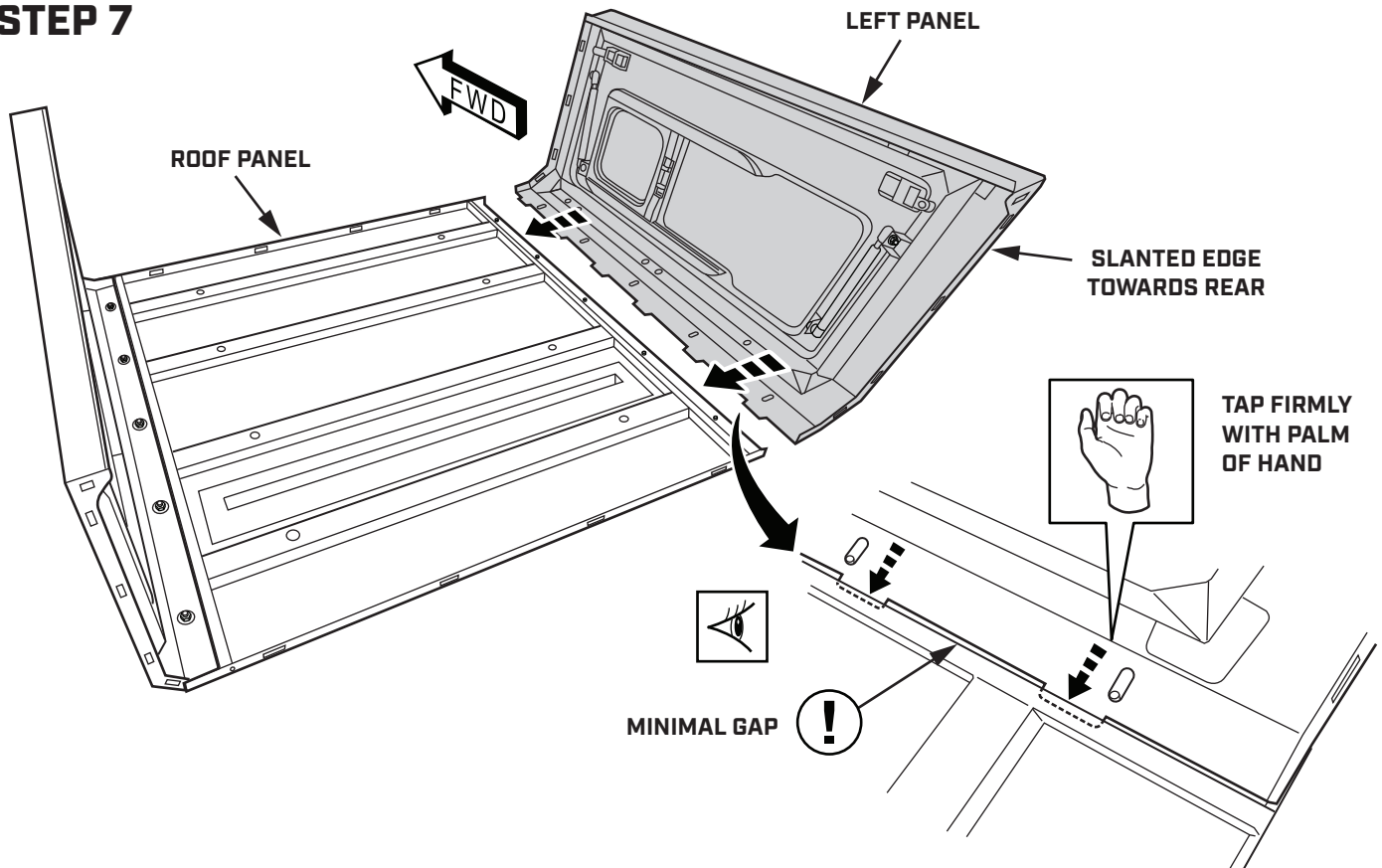

STEP 8

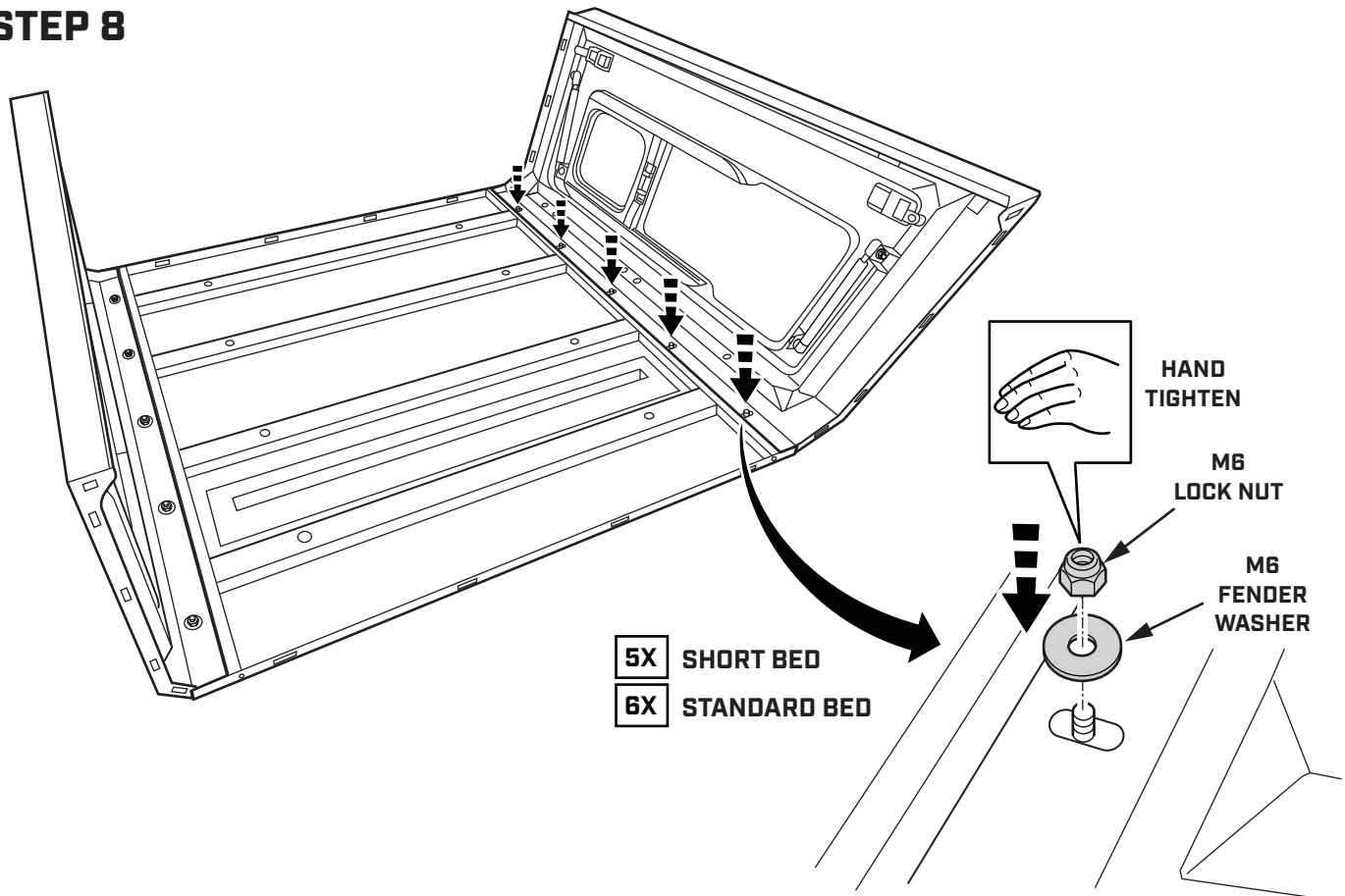

STEP 9

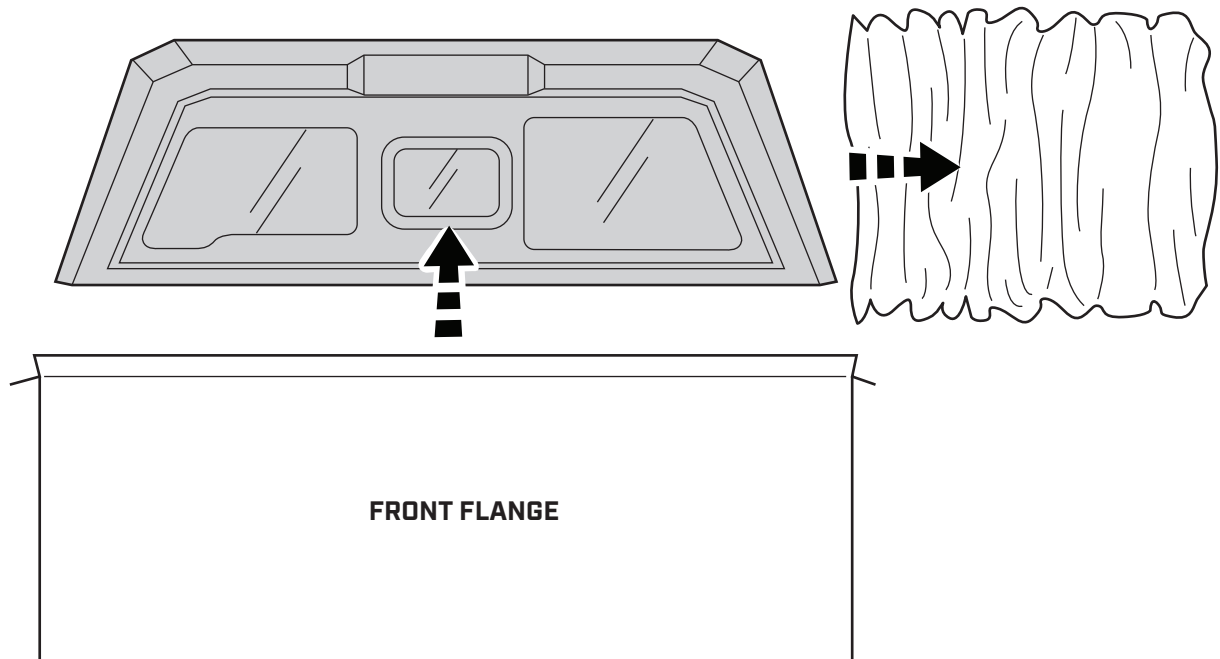
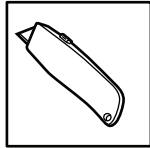

STEP 10

REMOVE ALL HARDWARE
FROM FRONT FLANGE

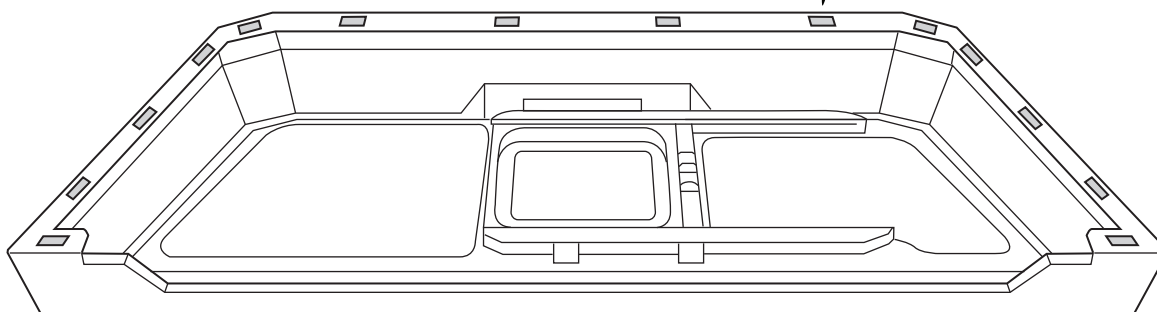
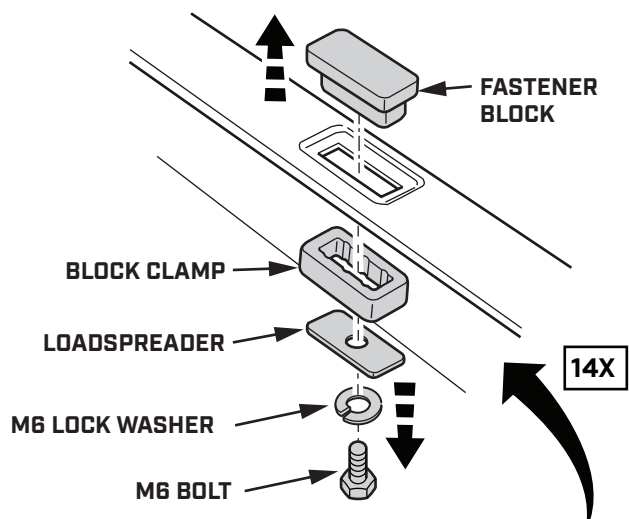
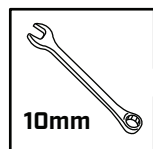

STEP 11

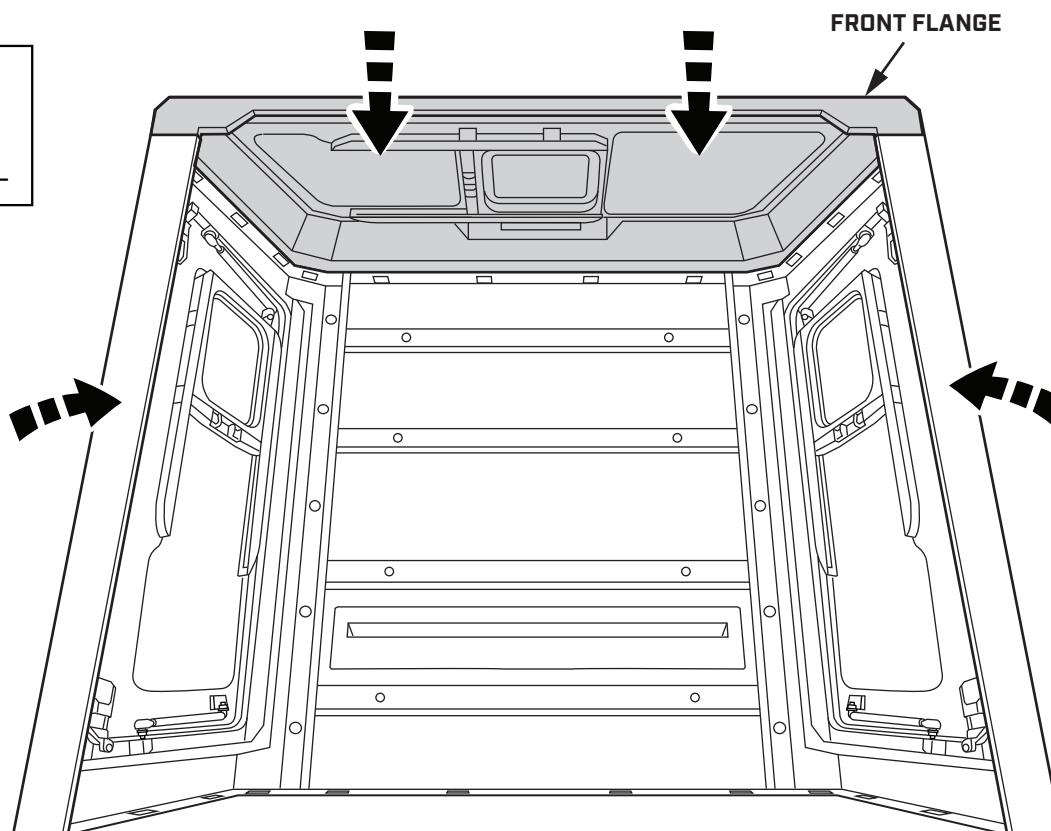
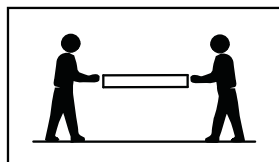

STEP 12

INSTALL HARDWARE
ALONG FRONT FLANGE
WITH BOLT ON INSIDE

HAND TIGHTEN IN THE
SEQUENCE SHOWN

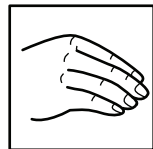

14X



BE SURE PANELS ARE FLUSH

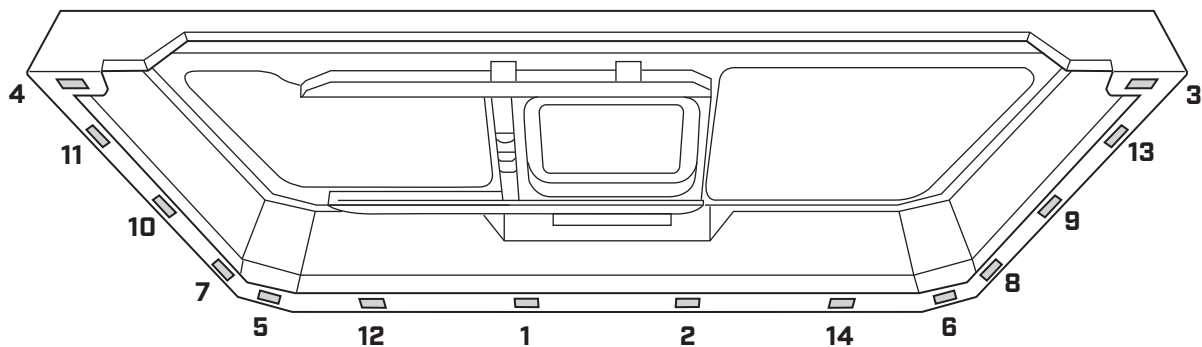
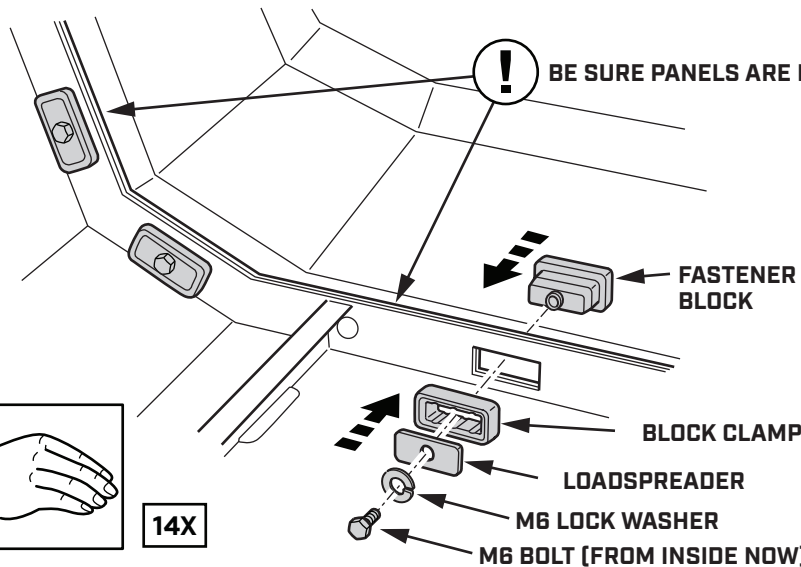

STEP 13

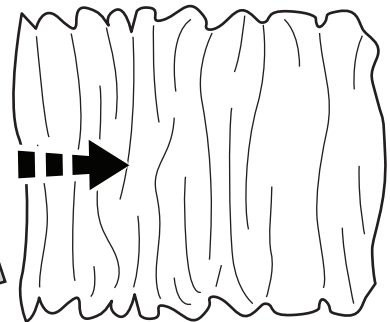
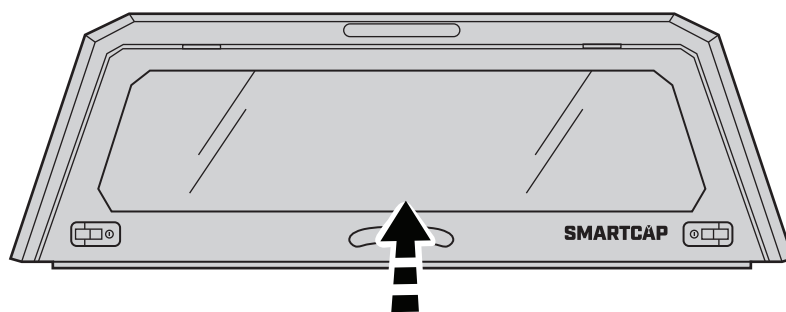
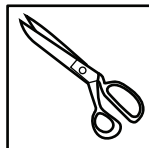
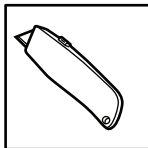

STEP 14

REMOVE ALL HARDWARE FROM REAR FLANGE

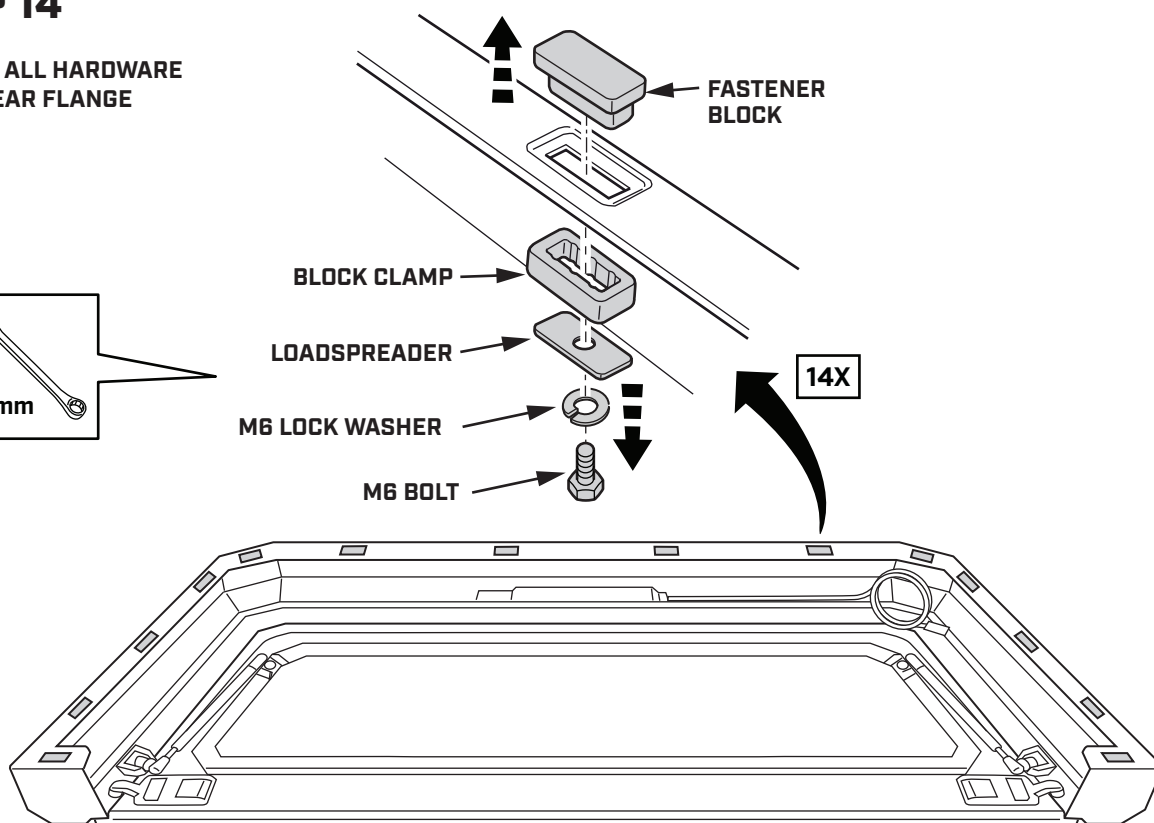
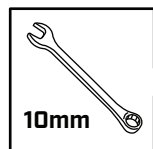

STEP 15

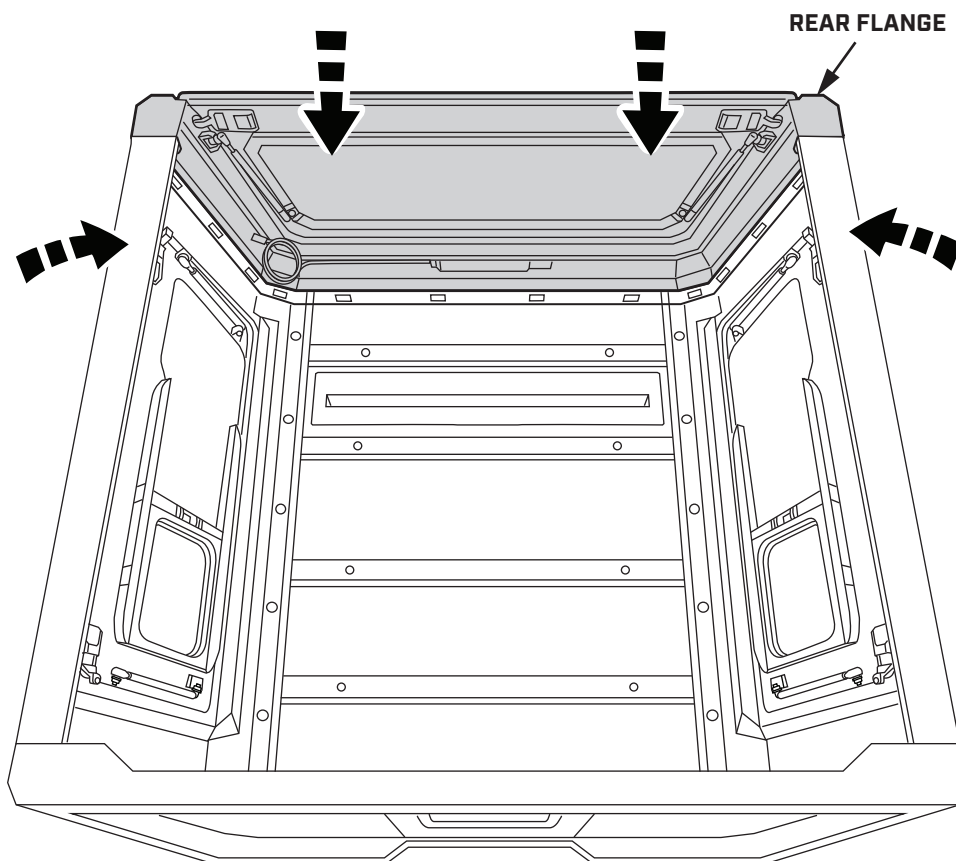
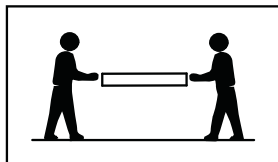

STEP 16

INSTALL HARDWARE
ALONG REAR FLANGE
WITH BOLT ON INSIDE

HAND TIGHTEN IN THE
SEQUENCE SHOWN



14X



BE SURE PANELS ARE FLUSH

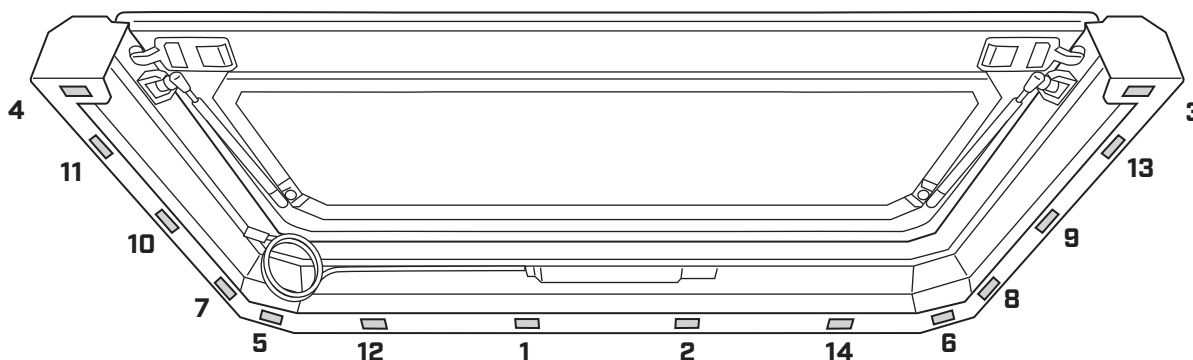
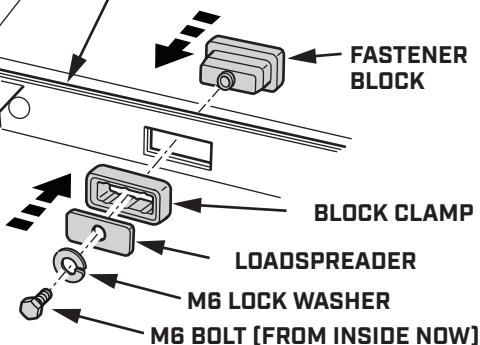

STEP 17

TIGHTEN ALL HARDWARE
WITH TORQUE WRENCH
AND 10mm SOCKET

14X

Min 6 N m
Max 12 N m
[4.4 lbs. ft.]

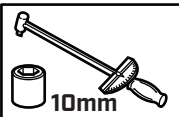

10mm

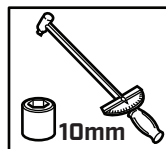

5X

Min 6 N m
Max 12 N m
[4.4 lbs. ft.]

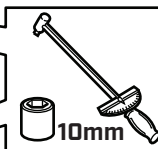

5X

Min 6 N m
Max 12 N m
[4.4 lbs. ft.]

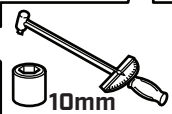
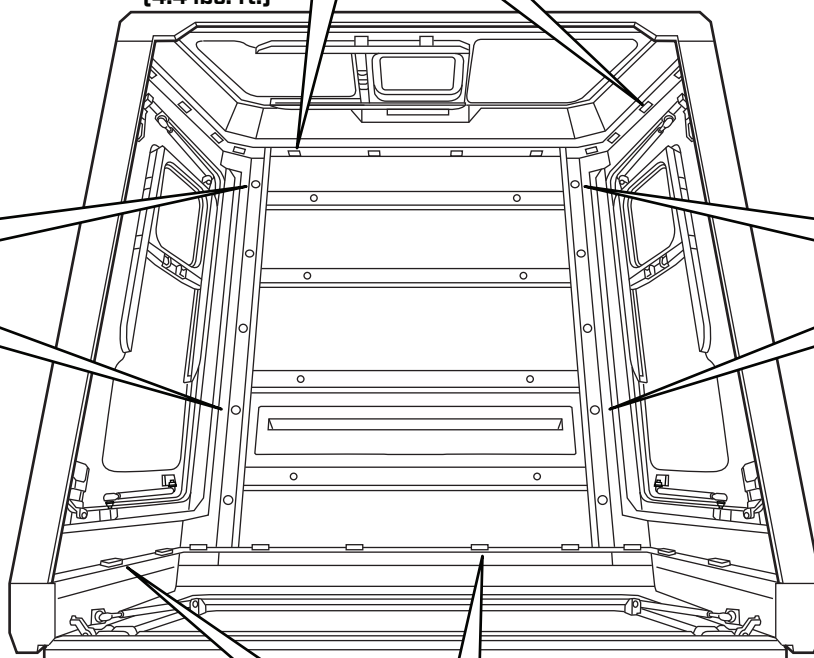

14X

Min 6 N m
Max 12 N m
[4.4 lbs. ft.]

STEP 18

APPLY D - RUBBER
TO BOTTOM OF SMARTCAP

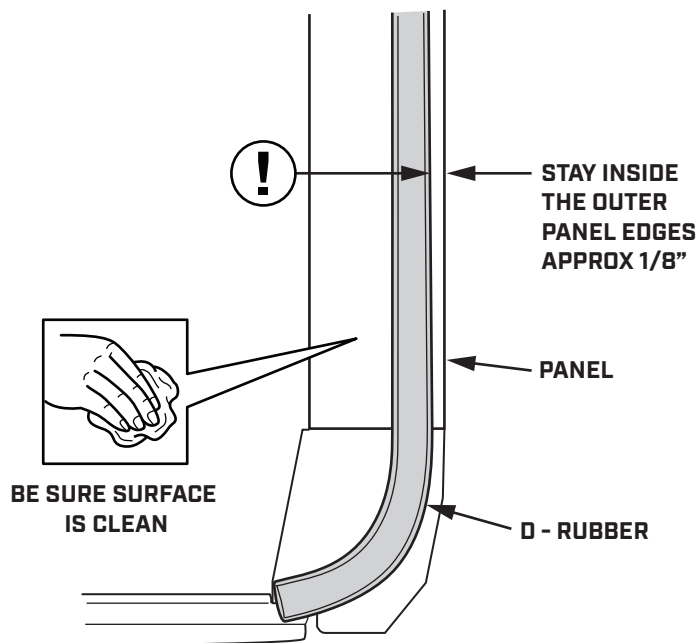
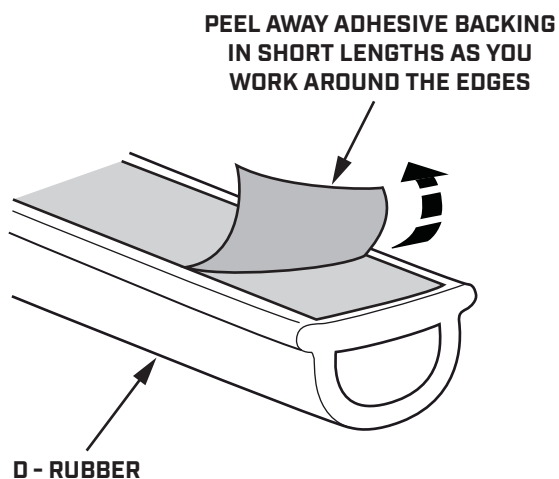

STEP 19

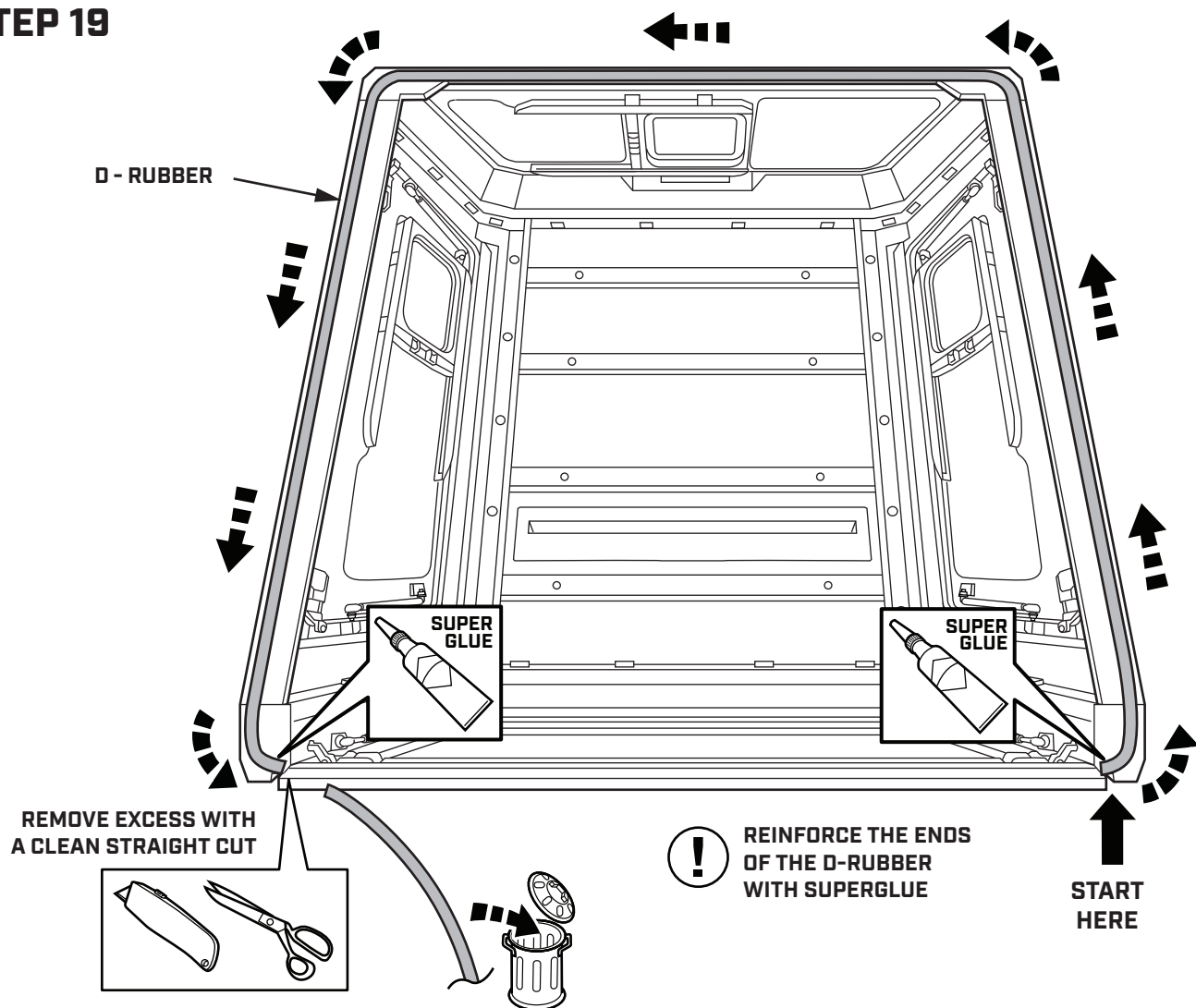

VEHICLE INSTALLATION

ASSEMBLY HARDWARE

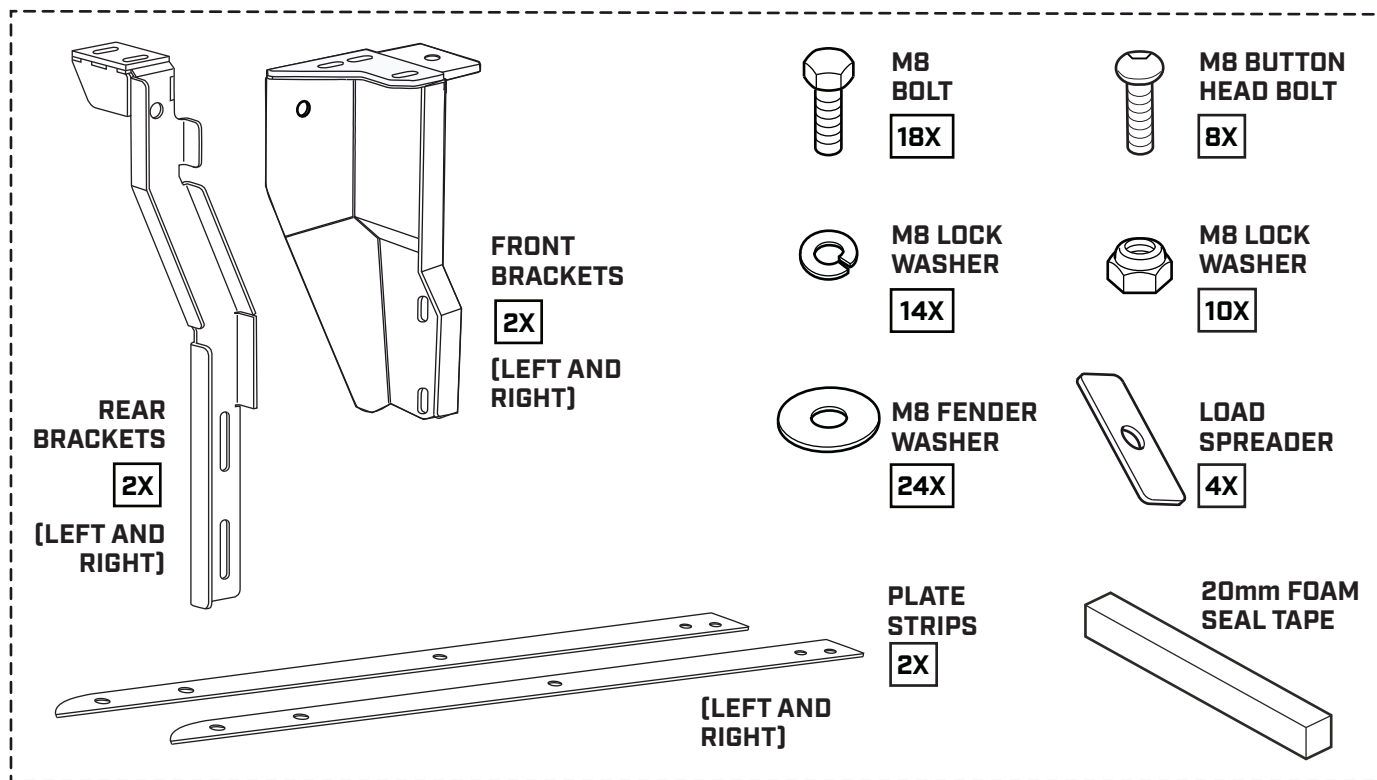

IMPORTANT

- ▼ ASSISTANTS WILL BE NEEDED FOR THIS INSTALLATION. FOUR PEOPLE ARE RECOMMENDED TO LIFT THE SMARTCAP ONTO THE VEHICLE.
- ▼ AVOID PINCHING OR CRUSHING HANDS AND FINGERS.

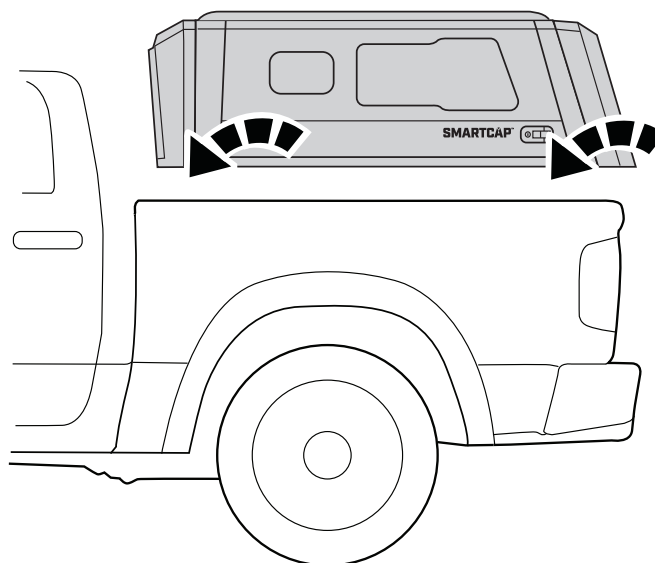

STEP 20

REMOVE SILLS FROM RIGHT SIDE OF TRUCK BED BY ACCESSING THE HARDWARE UNDER EACH TAB.

REPEAT ON THE OPPOSITE SIDE OF THE VEHICLE.

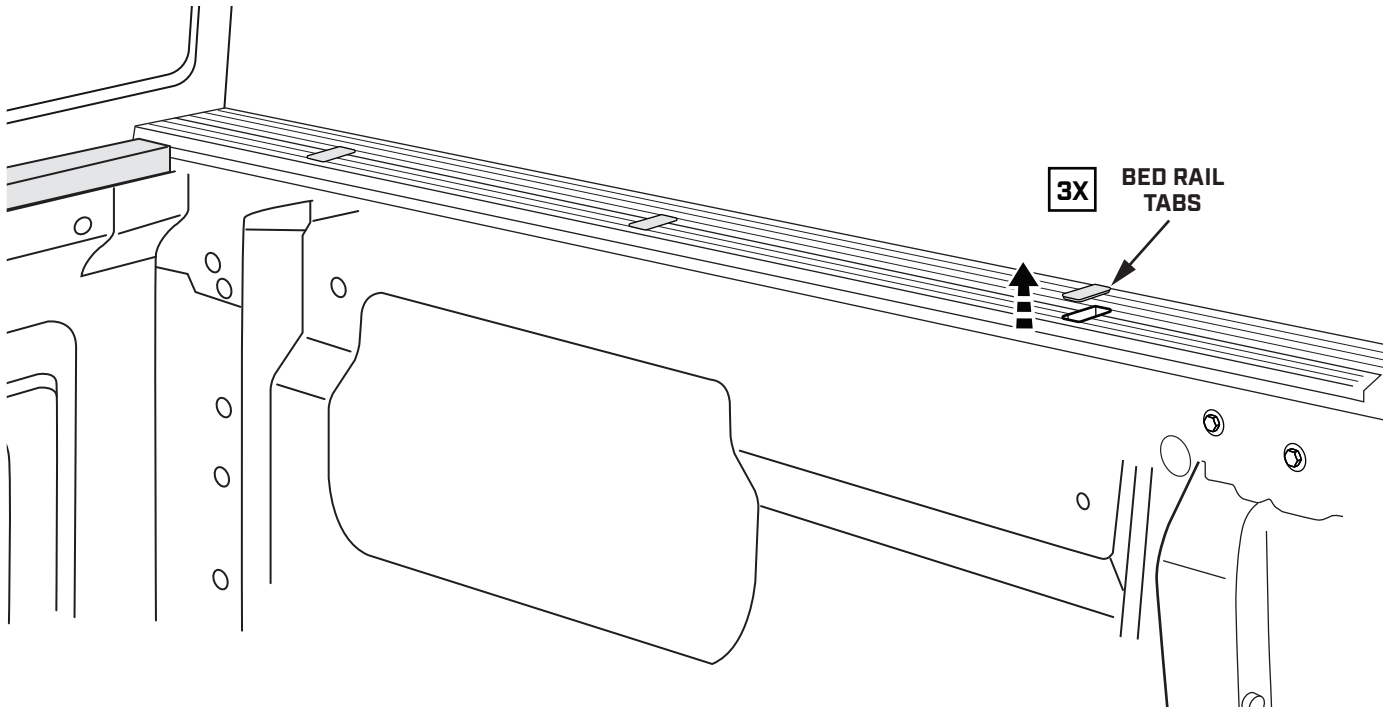

STEP 21

REMOVE THE ADHESIVE BACKING FROM PLATE STRIP.

APPLY PLATE STRIP ON EITHER SIDE OF THE TRUCK BED, ALIGNING THE FRONT OF THE STRIP TO THE FRONT OF THE BED.

REPEAT ON THE OPPOSITE SIDE OF THE VEHICLE.

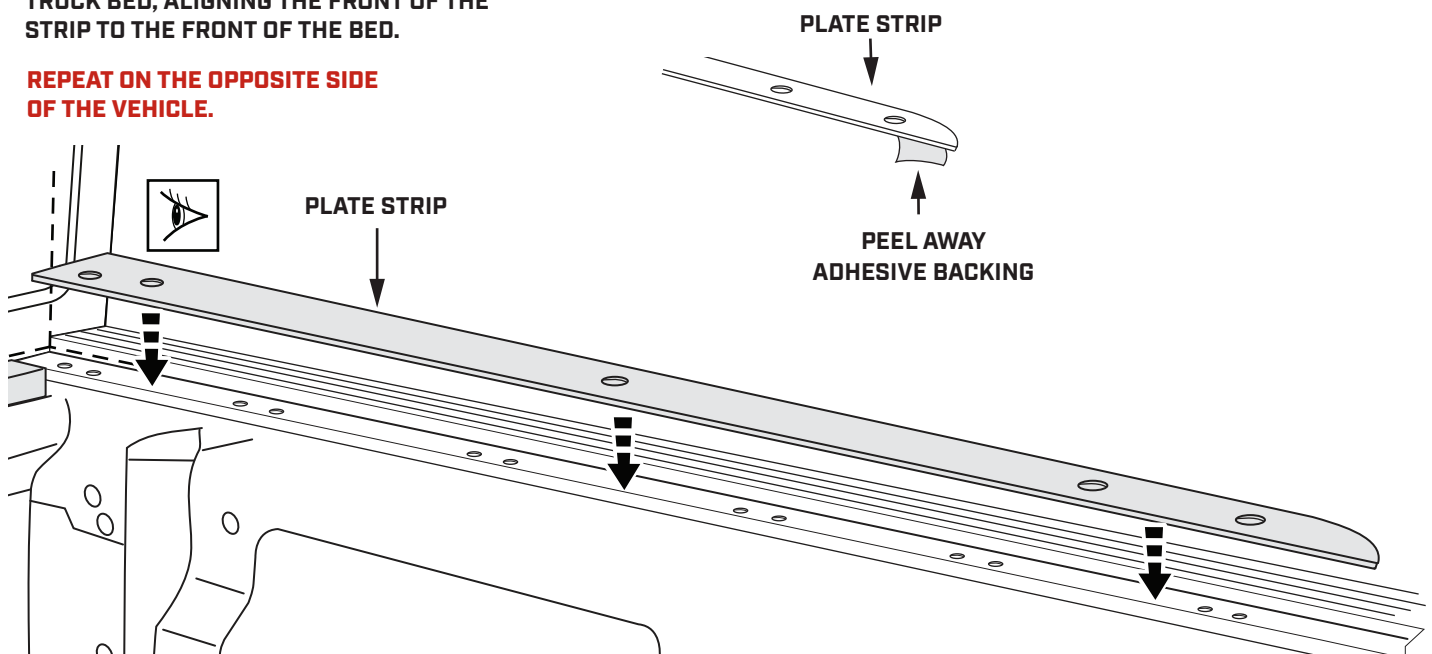

STEP 22

INSPECT THE TRUCK BED. IF FRONT EDGE IS LOWER THAN THE SIDES, ADD FOAM SEAL TAPE TO THE FRONT EDGE OF THE BED.

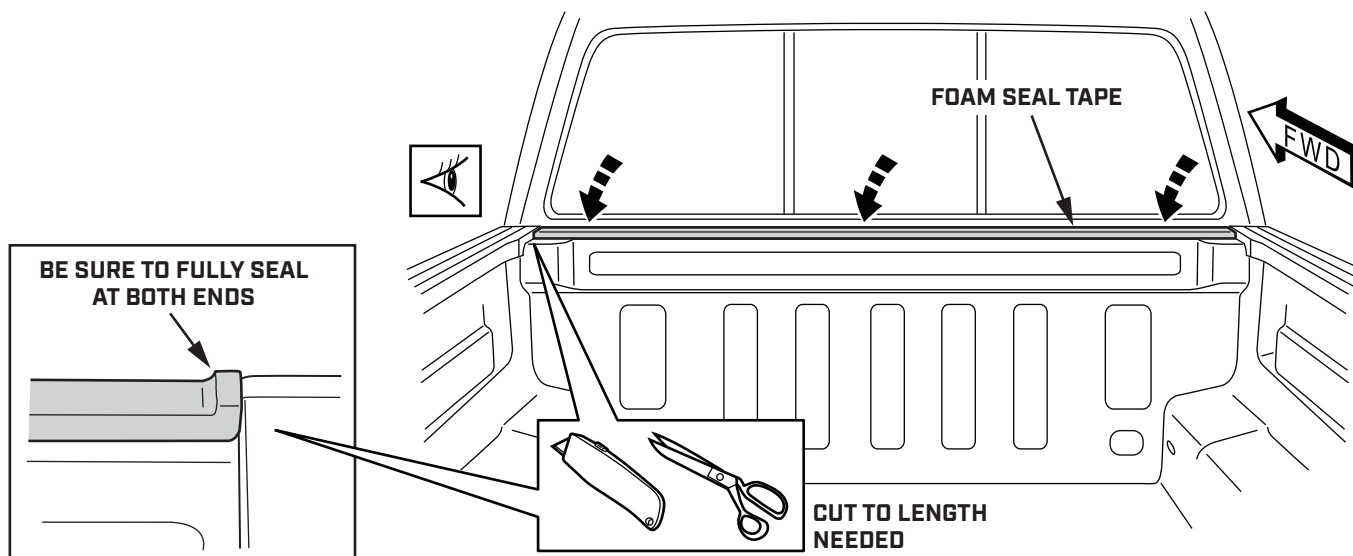
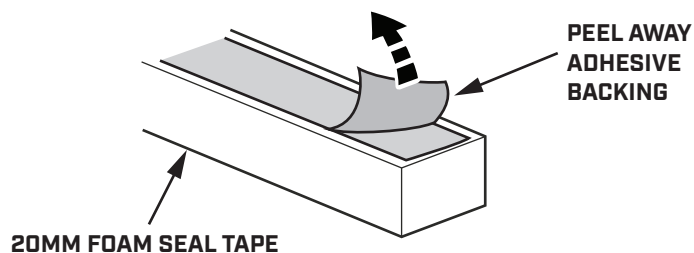

STEP 23

REMOVE THE FRONT TIE DOWN HOOK FROM THE INNER WALL OF THE TRUCK BED.

POSITION THE RIGHT SIDE FRONT MOUNTING BRACKET IN THE FRONT CORNER OF THE TRUCK BED AS SHOWN.

SECURE THE BRACKET WITH THE FASTENERS AS INDICATED, HAND TIGHTEN ONLY.

REPEAT ON THE OPPOSITE SIDE OF THE VEHICLE WITH THE LEFT FRONT MOUNTING BRACKET.

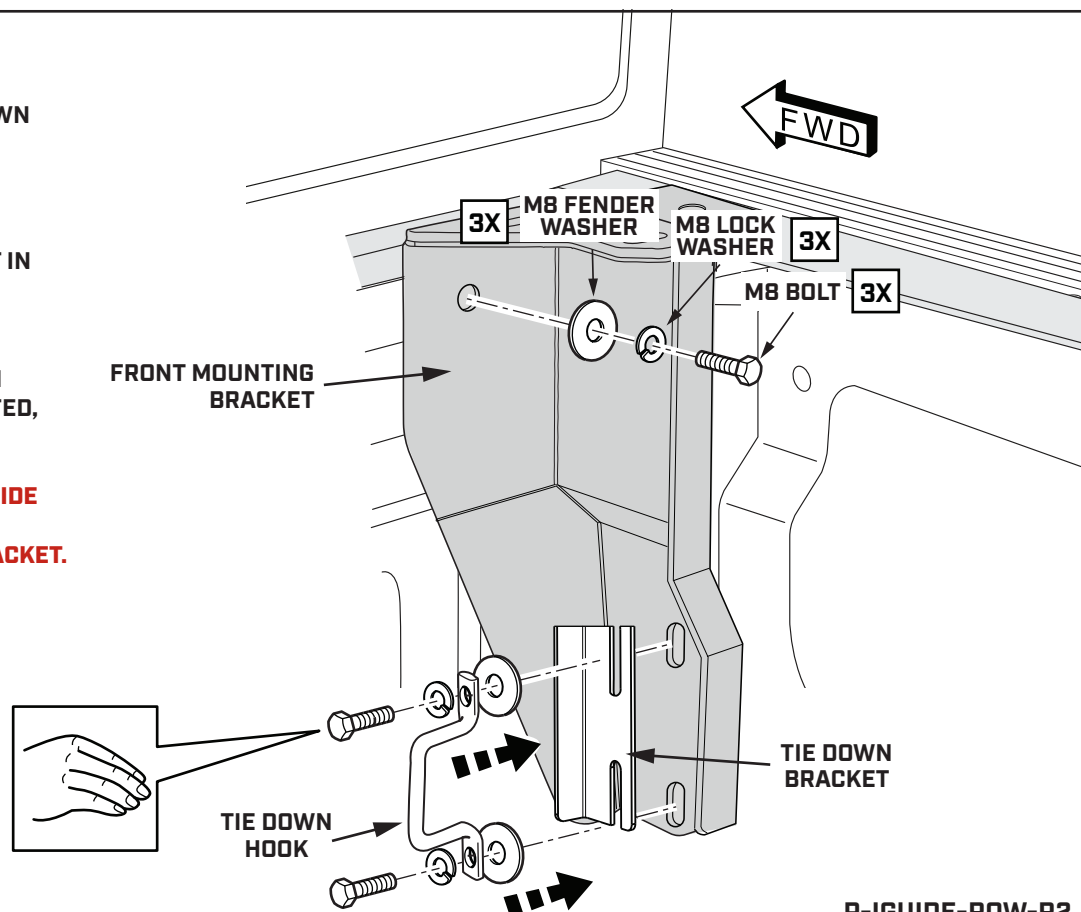

STEP 24

USE AN ALLEN WRENCH TO FASTEN THE FRONT RIGHT MOUNTING BRACKET TO THE TOP OF THE TRUCK BED.

SECURE THE BRACKET WITH THE FASTENERS AS INDICATED.

REPEAT ON THE OPPOSITE SIDE OF THE VEHICLE WITH THE LEFT FRONT MOUNTING BRACKET.

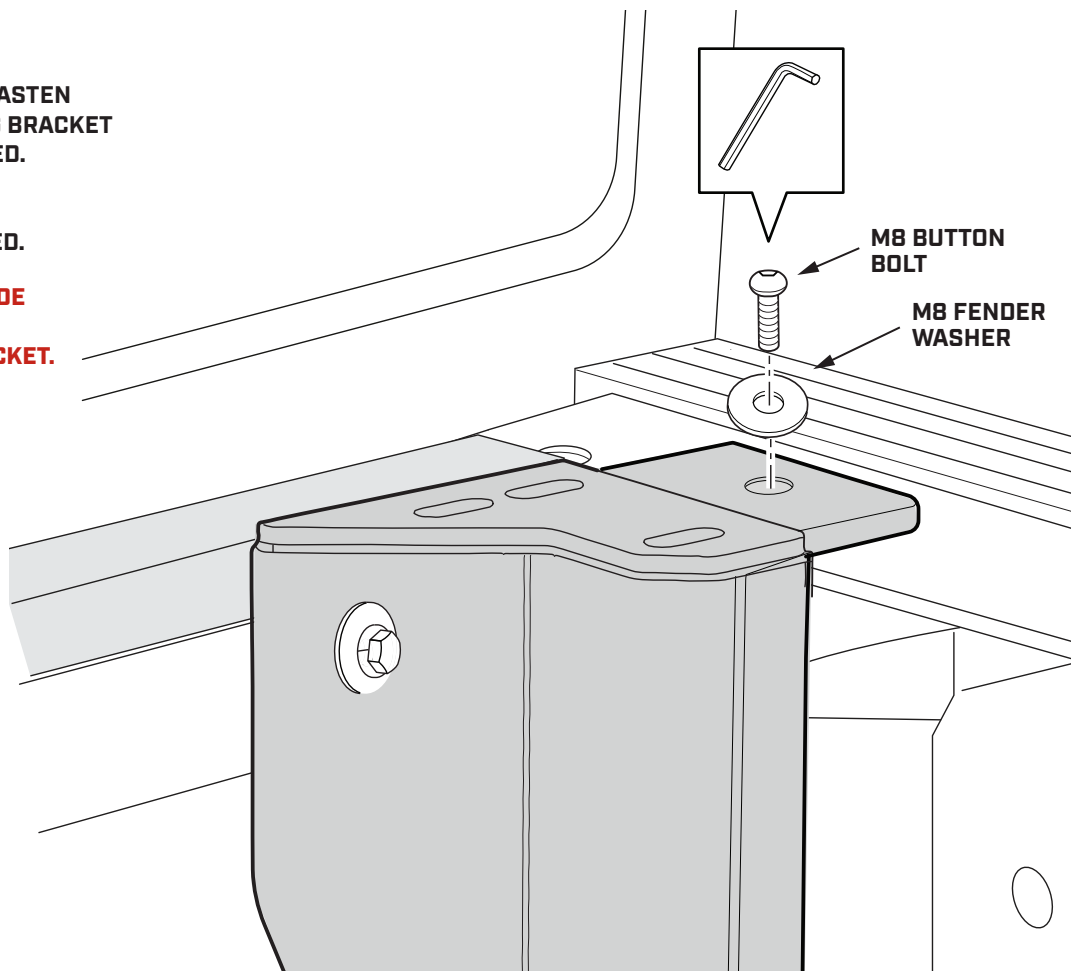

STEP 25

REMOVE THE REAR TIE DOWN HOOK FROM THE INNER WALL OF THE TRUCK BED.

POSITION THE RIGHT SIDE REAR MOUNTING BRACKET IN THE BACK CORNER OF THE TRUCK BED AS SHOWN.

SECURE THE BRACKET WITH THE FASTENERS AS INDICATED, HAND TIGHTEN ONLY.

REPEAT ON THE OPPOSITE SIDE OF THE VEHICLE WITH THE LEFT REAR MOUNTING BRACKET.

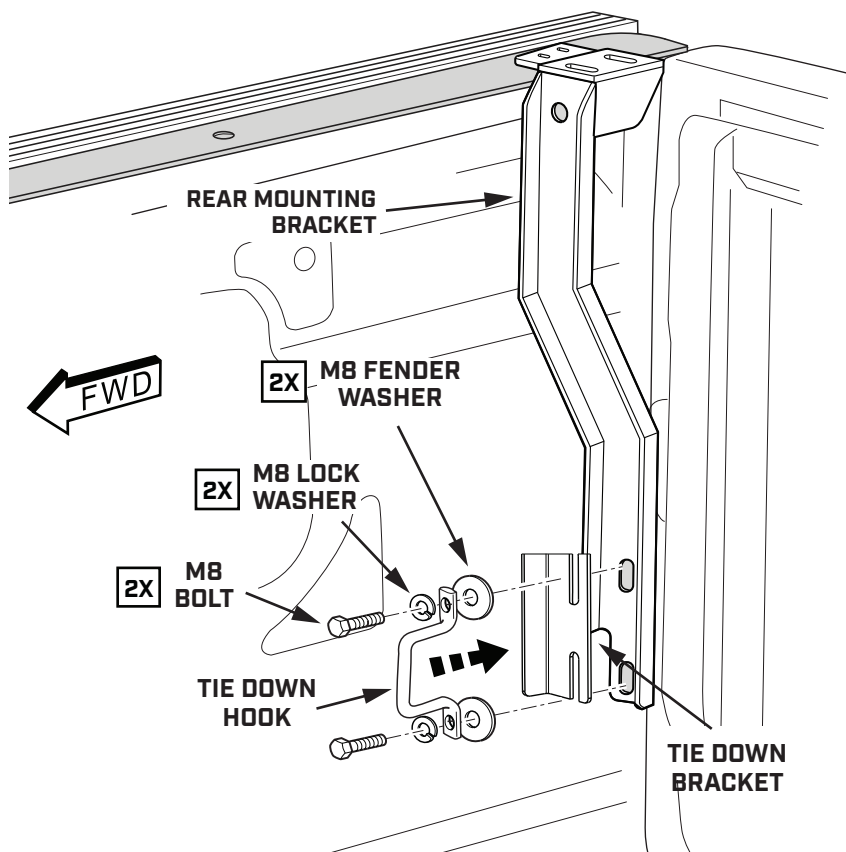

STEP 26

USE AN ALLEN WRENCH TO FASTEN THE REAR RIGHT MOUNTING BRACKET TO THE TOP OF THE TRUCK BED.

SECURE THE BRACKET WITH THE FASTENERS AS INDICATED.

REPEAT ON THE OPPOSITE SIDE OF THE VEHICLE WITH THE LEFT FRONT MOUNTING BRACKET.

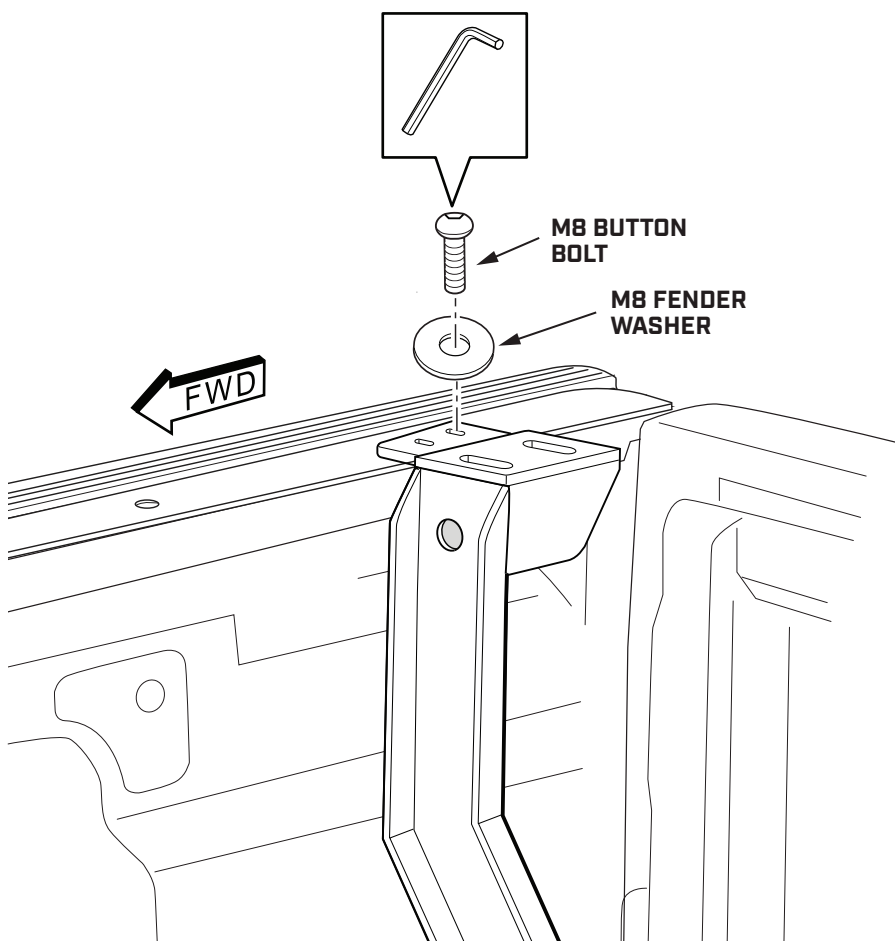

STEP 27

REMOVE THE ADHESIVE BACKING FROM LOAD SPREADER

APPLY LOAD SPREADERS TO THE TOP OF PLATE STRIP. USE THE SLOTS TO ALIGN

REPEAT ON THE OPPOSITE SIDE OF THE VEHICLE.

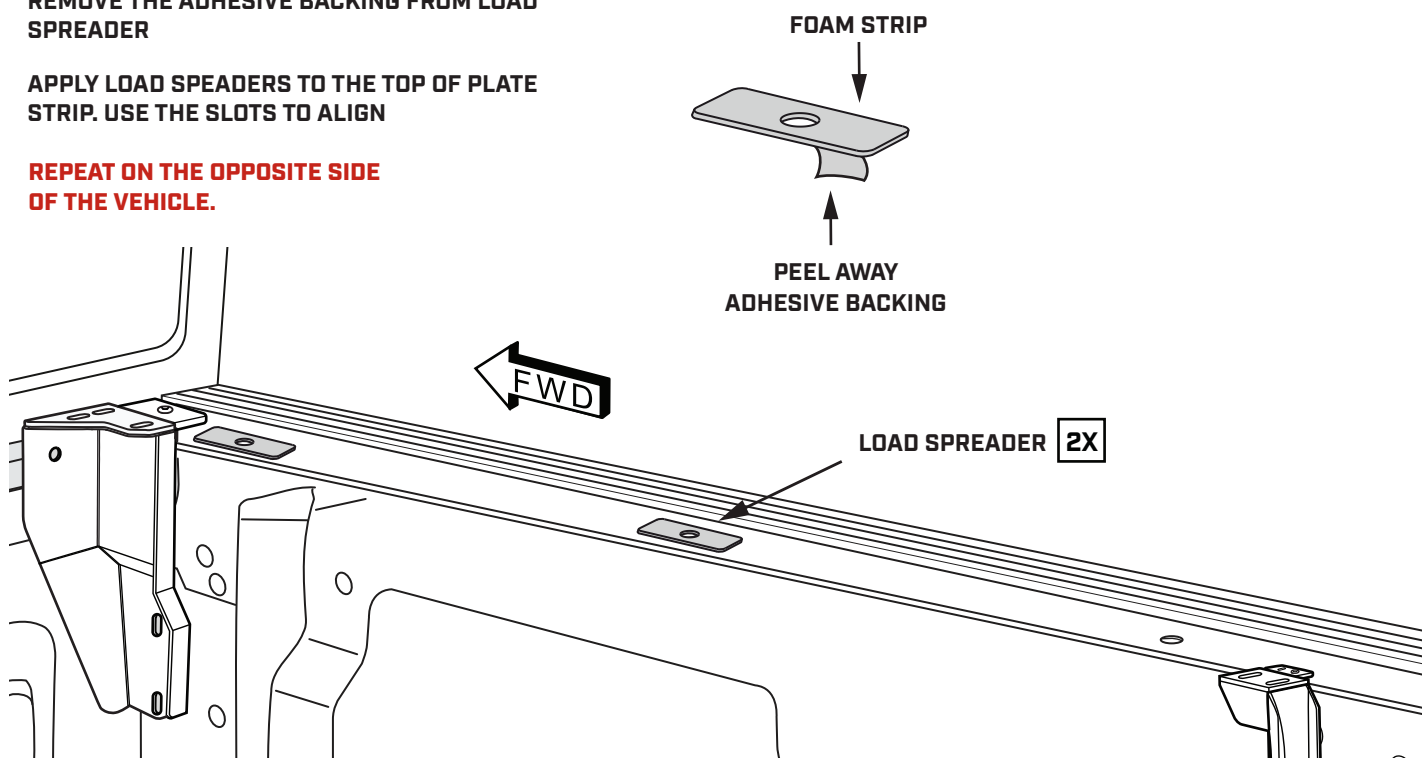

STEP 28

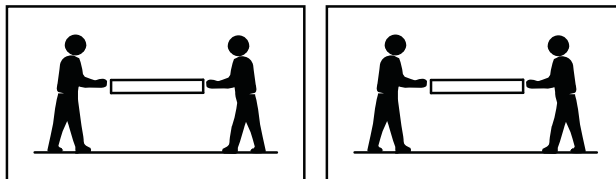

LIFT THE ASSEMBLED SMARTCAP ONTO THE TRUCK BED



**BE SURE NOT TO SCRAPE OR
DAMAGE THE D-RUBBER**

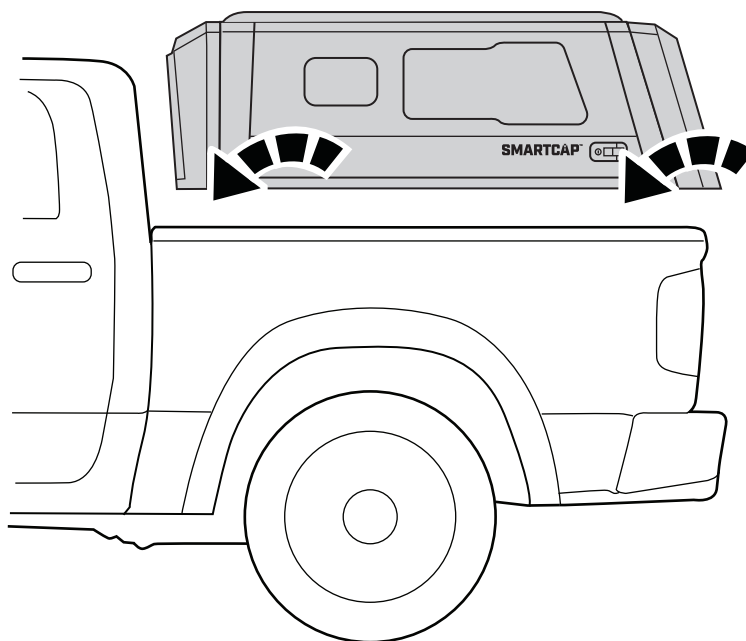

CHECK THAT THE SMARTCAP IS
PROPERLY POSITIONED AND
CENTERED ON THE TRUCK BED

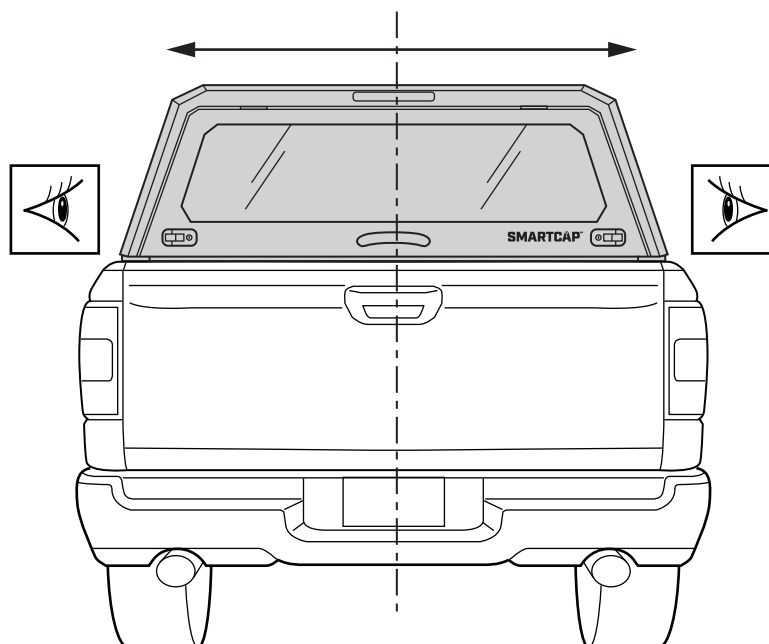

STEP 29

WITH AN ALLEN WRENCH, SECURE THE SMARTCAP RIGHT SIDE PANEL TO THE TOP OF THE TRUCK BED USING THE FASTENERS INDICATED.

REPEAT ON THE OPPOSITE SIDE OF THE VEHICLE.

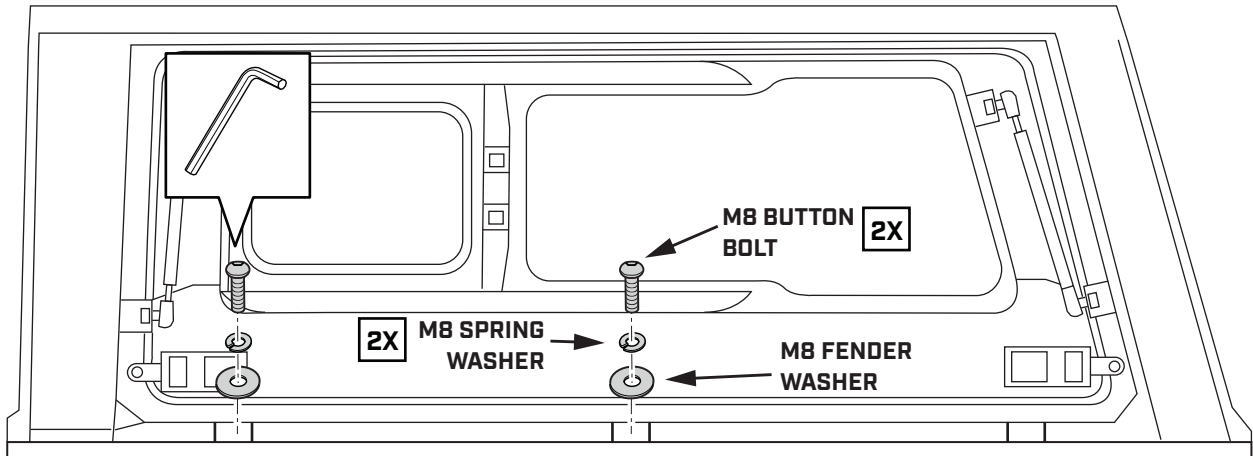

STEP 30

SECURE THE SMARTCAP TO THE RIGHT REAR MOUNTING BRACKET WITH THE FASTENERS AS INDICATED, HAND TIGHTEN ONLY.

REPEAT ON THE OPPOSITE SIDE OF THE VEHICLE WITH THE LEFT REAR MOUNTING BRACKET.

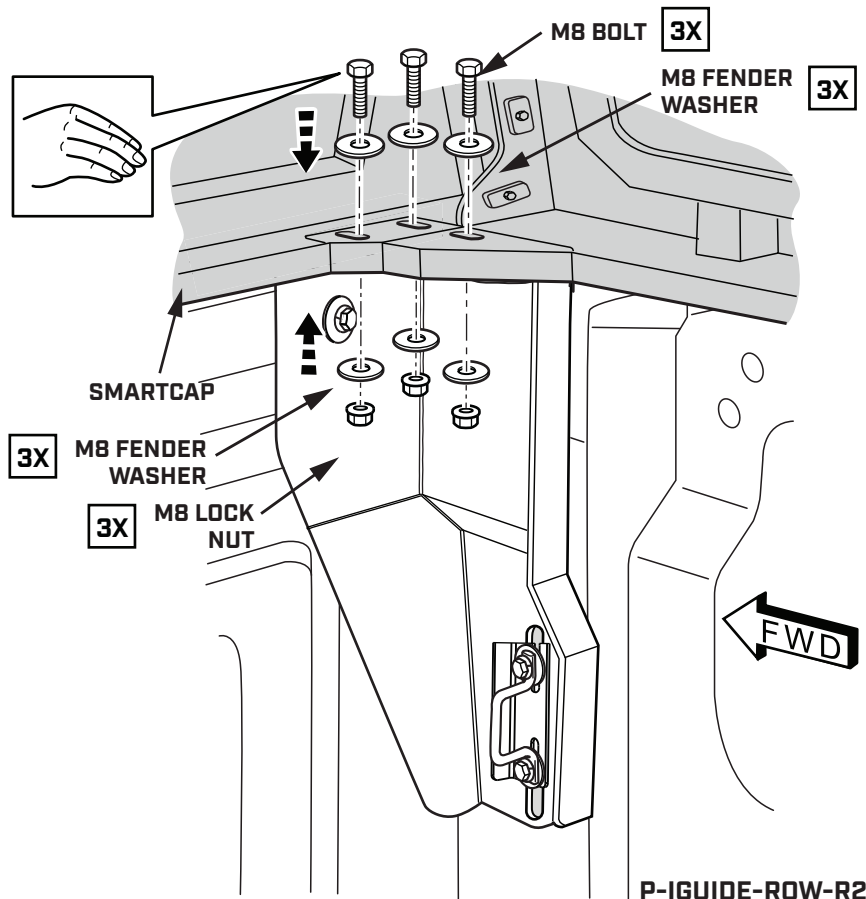

STEP 31

SECURE THE SMARTCAP TO THE RIGHT REAR MOUNTING BRACKET WITH THE FASTENERS AS INDICATED, HAND TIGHTEN ONLY.

REPEAT ON THE OPPOSITE SIDE OF THE VEHICLE WITH THE LEFT REAR MOUNTING BRACKET.

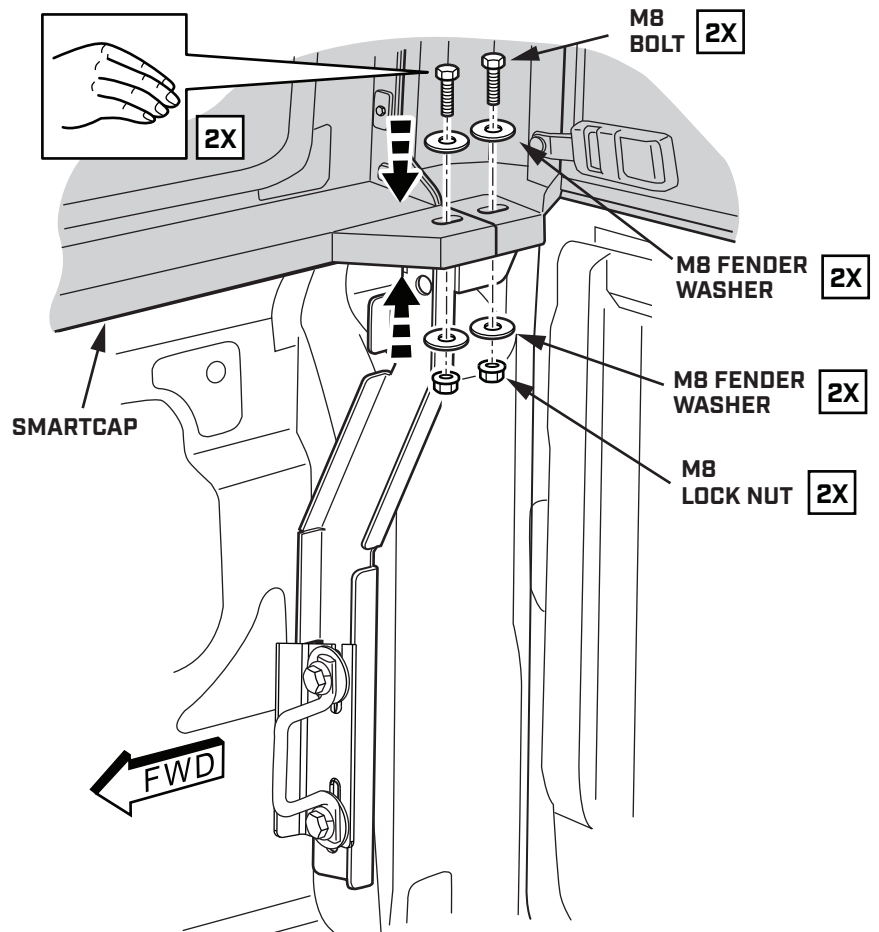

STEP 32

ONCE ALL THE FASTENERS ARE INSTALLED, PARTIALLY TIGHTEN WITH SOCKET WRENCH AS INDICATED.

PARTIALLY TIGHTEN FASTENERS ON ALL FOUR CORNERS OF THE VEHICLE.

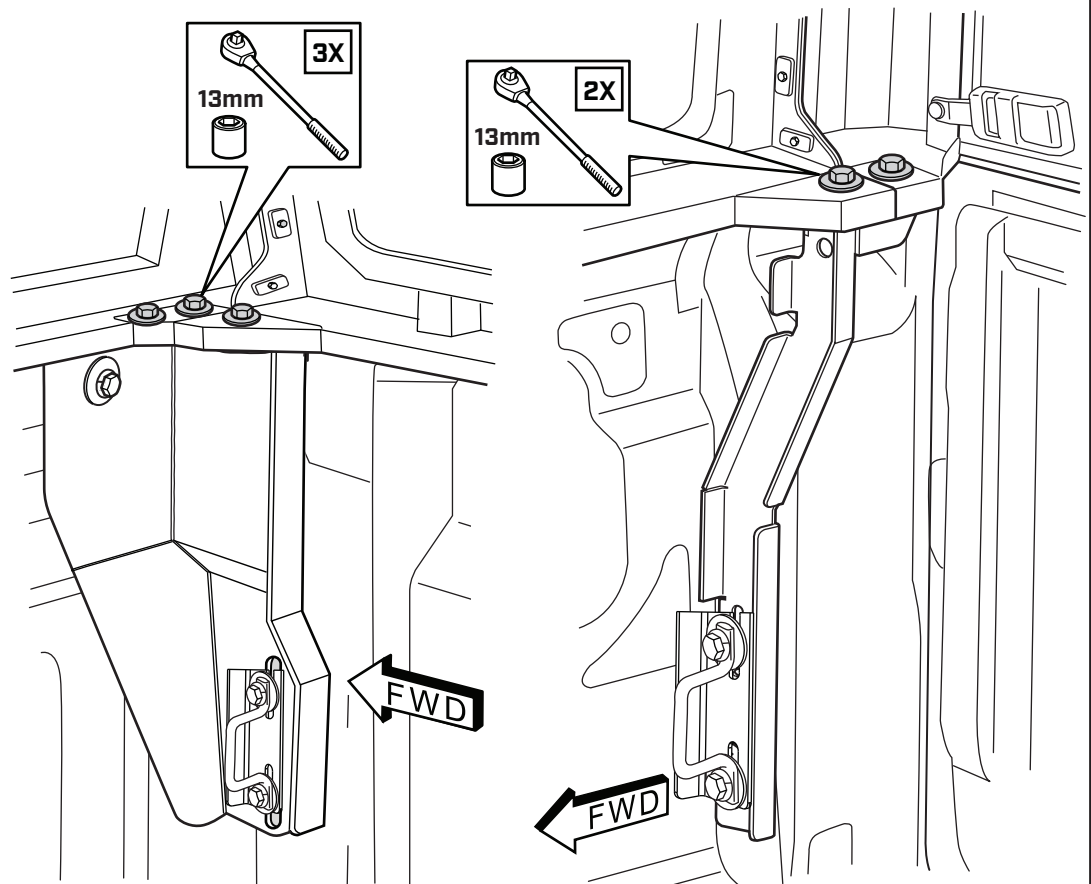

STEP 33

PRESS DOWN ON THE SMARTCAP TO ACHIEVE 2MM - 3MM COMPRESSION ON THE D-RUBBER AND CONTINUE TIGHTENING BRACKET FASTENERS WITH SOCKET WRENCH AS INDICATED.

CONTINUE TIGHTENING FASTENERS ON ALL FOUR CORNERS OF THE VEHICLE.

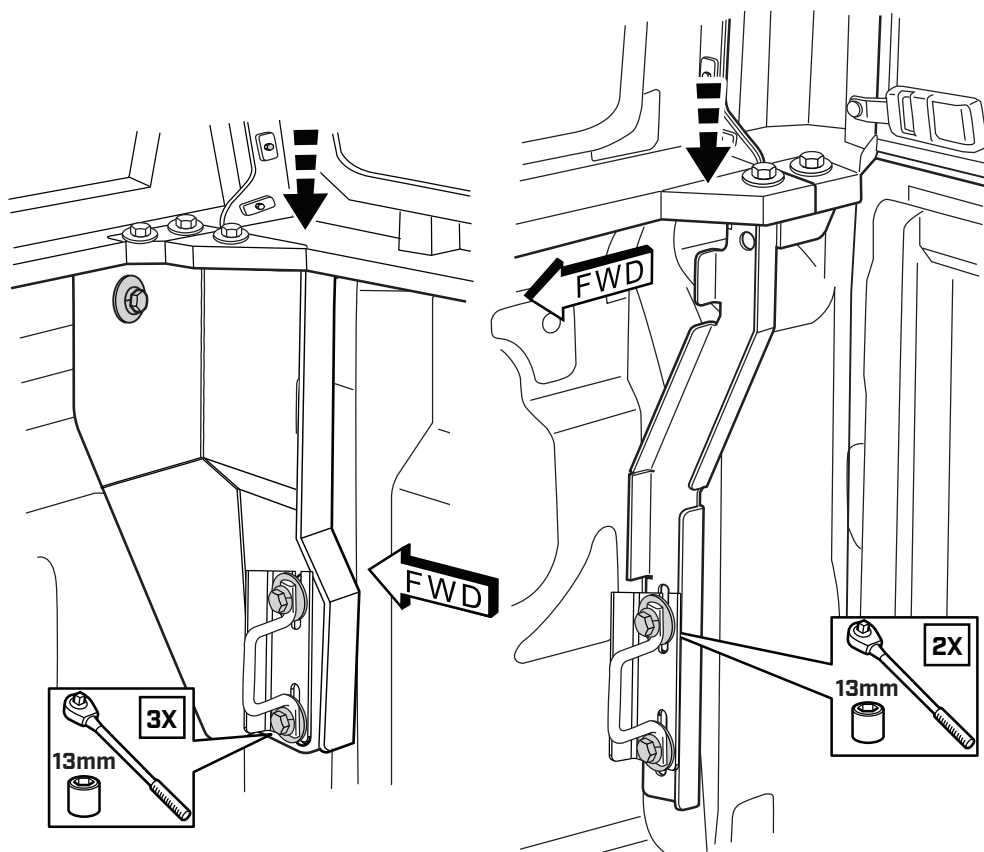
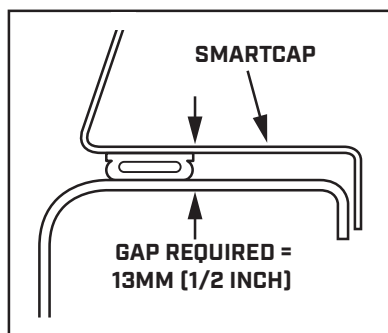

STEP 34

ONCE SMARTCAP IS POSITIONED CORRECTLY, FULLY TIGHTEN UPPER FASTENERS WITH TORQUE WRENCH AS INDICATED.

FULLY TIGHTEN UPPER FASTENERS ON ALL FOUR CORNERS OF THE VEHICLE.

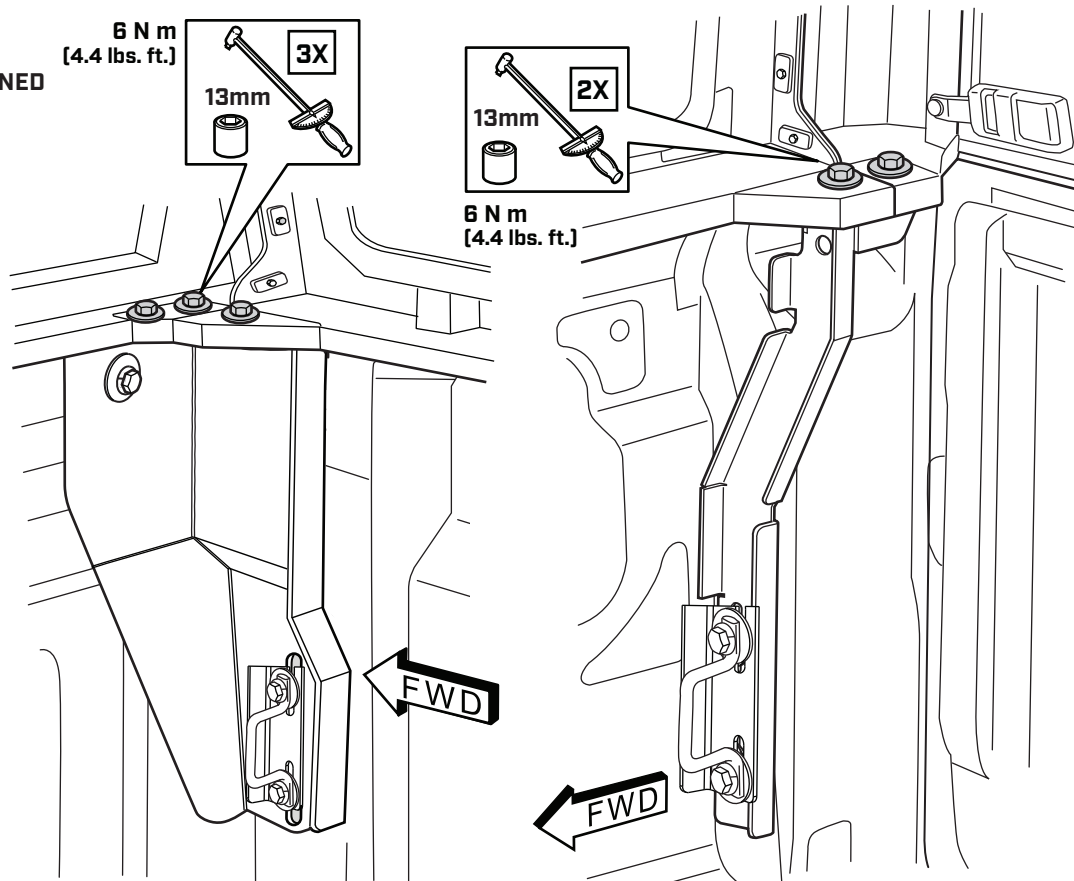

STEP 35

ONCE SMARTCAP IS POSITIONED CORRECTLY, FULLY TIGHTEN LOWER FASTENERS WITH TORQUE WRENCH AS INDICATED.

FULLY TIGHTEN LOWER FASTENERS ON ALL FOUR CORNERS OF THE VEHICLE.

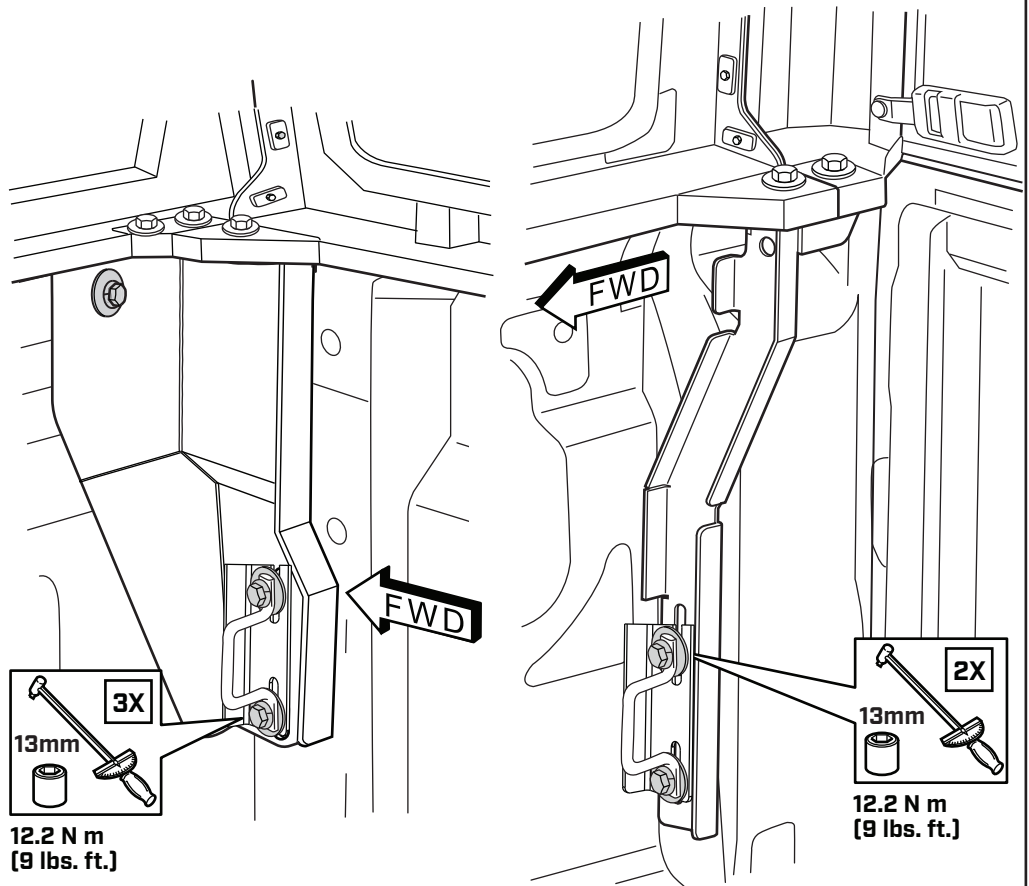

SMARTCAP[®]

THANKS FOR YOUR PURCHASE.
PLEASE LET US KNOW IF YOU HAVE ANY QUESTIONS.

SMARTCAP.COM - SUPPORT.SA@SMARTCAP.COM - SOUTH AFRICA

