

**SMARTCAP®**

EVO, EVOa, EVOc &amp; EVOd Series

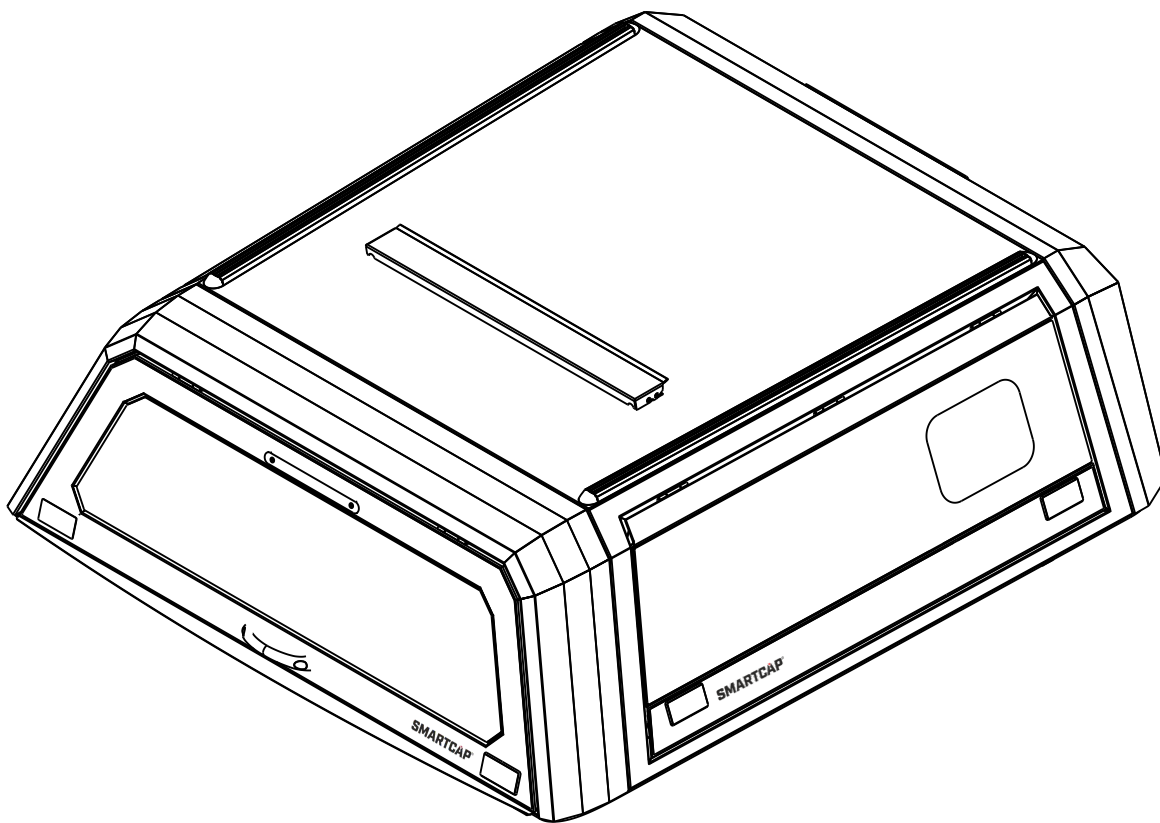

**TO ENSURE YOU ARE USING THE MOST RECENT VERSION, PLEASE DOWNLOAD THE INSTRUCTION GUIDE AT [WWW.SA.RSISMARTCAP.COM/ASSEMBLY-FITMENT](http://WWW.SA.RSISMARTCAP.COM/ASSEMBLY-FITMENT)**  
**FOLLOW INSTRUCTIONS CAREFULLY TO AVOID DAMAGE TO COMPONENTS OR THE VEHICLE**

**RSISMARTCAP.COM - SUPPORT.SA@RSISMARTCAP.COM - REST OF WORLD**



# TABLE OF CONTENTS

<b>REQUIRED TOOLS</b>	<b>2</b>
<b>ASSEMBLY INSTRUCTIONS</b>	<b>3</b>
Unboxing Instructions	3
Components & Assembly Hardware	4
Assembly of the SmartCap	6
<b>INSTALLATION INSTRUCTIONS</b>	<b>13</b>
Fitment Kit Contents	13
Installation of the SmartCap	14
Ford Ranger	15
Toyota Hilux	18
VW Amarok	21
Isuzu D-Max	22
Mitsubishi Triton	23
Toyota Land Cruiser	24
<b>THIRD BRAKE LIGHT WIRING HARNESS</b>	<b>25</b>
Ford Ranger, Toyota Hilux, VW Amarok, Isuzu D-Max	25
Wiring Reference Guide	26
Wiring Reference Guide	27
<b>NOTES</b>	<b>28</b>
<b>SUPPORT DETAILS</b>	<b>29</b>

## REQUIRED TOOLS

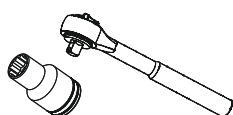

Socket Wrench  
10mm & 13mm Socket



Combination Wrench  
10mm & 13mm Flat

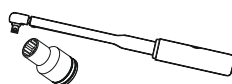

Torque Wrench  
10mm & 13mm Flat



Sharp Box Knife  
Or Scissors



Super Glue

## WARNING



- **USE ONLY THE TOOLS RECOMMENDED IN THIS GUIDE**
- **USE ONLY THE HARDWARE THAT HAS BEEN PROVIDED**
- **HANDLE ALL COMPONENTS WITH CARE**
- **IT IS RECOMMENDED THAT FOUR PEOPLE LIFT/LOWER THE SMARTCAP**
- **NEVER USE ACETONE ON THE PAINTWORK**
- **AVOID PINCHING/SQUASHING HANDS**

# UNBOXING INSTRUCTIONS

1. INSPECT THE ENTIRE PACKAGE FOR DAMAGE. IF ANY IS FOUND, CONTACT: [SUPPORT.SA@RSISMARTCAP.COM](mailto:SUPPORT.SA@RSISMARTCAP.COM)
2. ENSURE THE WORK AREA IS CLEAN BEFORE UNBOXING.
3. ENSURE THE REQUIRED TOOLS ARE PRESENT AND ALL HARDWARE CONTENTS ARE ACCOUNTED FOR.
4. WE RECOMMEND A MINIMUM OF 2 PEOPLE TO UNBOX THE PACKAGED CONTENT.
5. UNSTRAP THE BOXES.
6. ORIENT THE ROOF PANEL BOX WITH THE "THIS SIDE UP" LABEL FACING UPWARDS.

**NOTE: ENSURE ALL PANELS ARE CORRECTLY ORIENTATED (THIS SIDE UP). USE STRAPS TO HELP LIFT THE BOXES**

## UNBOXING EXPLODED VIEW

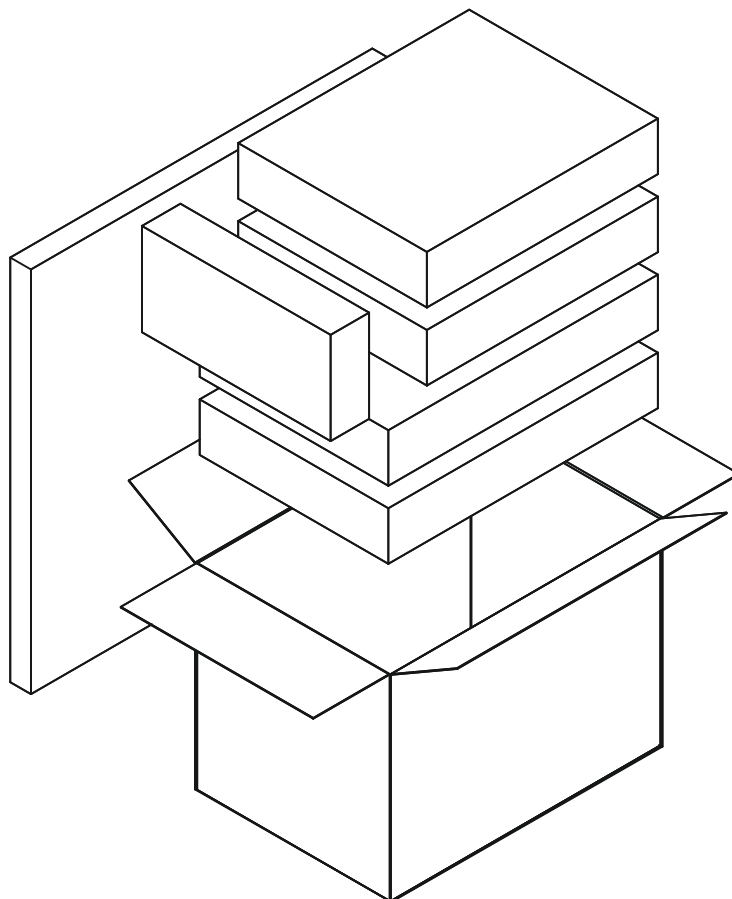

# COMPONENTS

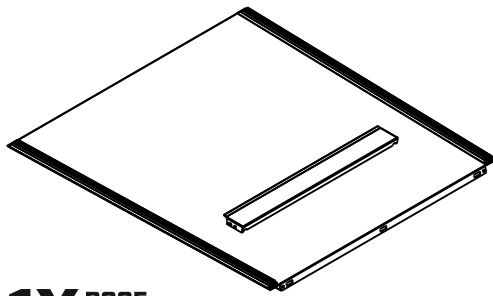

**1X** ROOF  
PANEL

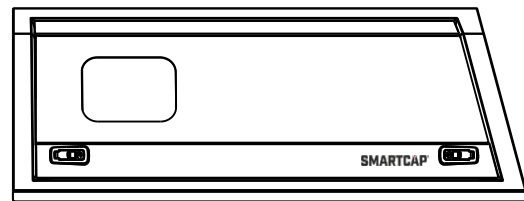

**2X** SIDE PANELS  
LEFT & RIGHT

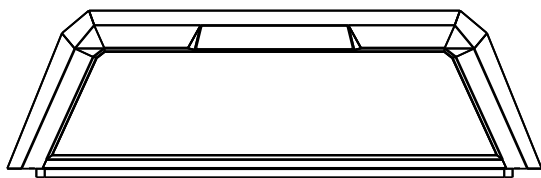

**1X** FRONT  
FLANGE

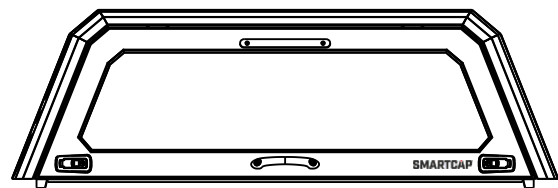

**1X** REAR  
FLANGE

# ASSEMBLY HARDWARE

**SMARTCAP ASSEMBLY HARDWARE THAT IS ALREADY  
HAND FASTENED TO THE FLANGES**

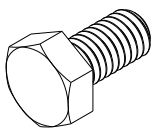

**28X** SET SCREW  
M6X10

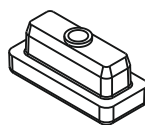

**28X** FASTENER  
BLOCKS

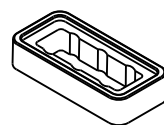

**28X** FASTENER BLOCK  
CLAMP

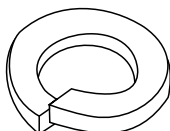

**28X** SPRING WASHER  
M6

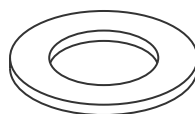

**28X** FLAT WASHER  
M6



# ASSEMBLY KIT CONTENTS

## KIT 1: ROOF PANEL FASTENING HARDWARE

**FOR ALL DC  
DOUBLE CAB**



**10X** M6  
NYLOC NUTS

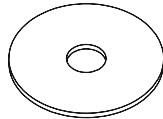

**10X** M6X25  
FENDER WASHERS

**FOR ALL EC  
EXTENDED CAB**



**12X** M6  
NYLOC NUTS

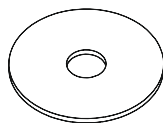

**12X** M6X25  
FENDER WASHERS

## KIT 2: SPARE PARTS

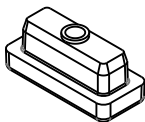

**1X** FASTENER  
BLOCKS

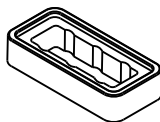

**1X** FASTENER BLOCK  
CLAMP

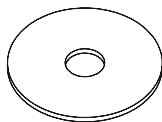

**1X** M6X25  
FENDER WASHERS

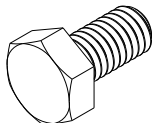

**1X** SET SCREW  
M6X10



**1X** M6  
NYLOC NUTS

## WEATHER SEAL



**1X** D-RUBBER  
WEATHER STRIP

# ASSEMBLY OF THE SMARTCAP

## ASSEMBLY EXPLODED VIEW

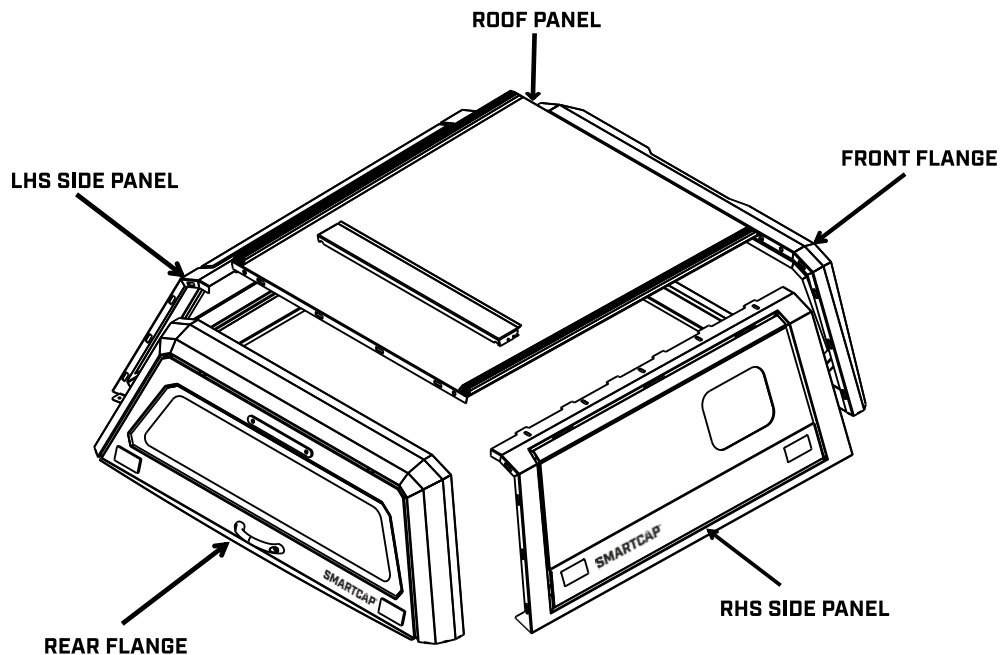

### STEP ONE

1. ORIENT THE ROOF PANEL BOX WITH "THIS SIDE UP" LABEL FACING UPWARDS, THEN OPEN.
2. UNFOLD THE PROTECTIVE PLASTIC SHEET, LEAVING IT ON THE BOTTOM OF THE ROOF PANEL.
3. USE THE OPEN BOX LID AS A PROTECTIVE SURFACE TO ASSEMBLE THE SMARTCAP UPON.  
[SEE FIGURE 1]
4. WORK WITH CAUTION TO PREVENT ANY DAMAGE.
5. REMOVE THE FOUR NUTS AND WASHERS ON THE INTERNAL SIDE OF THE ROOF THAT IS HOLDING THE TWO ROOF RAILS IN PLACE. THESE ARE IN PLACE TO AID TRANSPORTATION AND SHOULD BE REMOVED AND DISCARDED OF [SEE FIGURE 1]

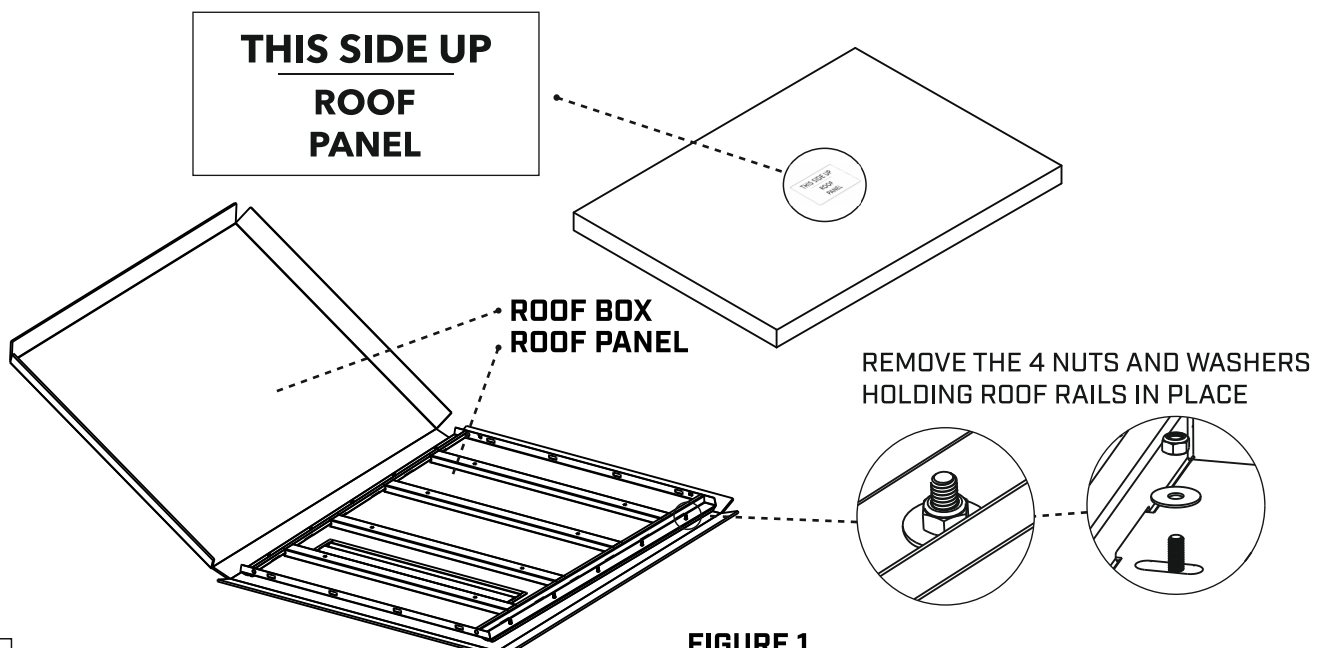

FIGURE 1

# ASSEMBLY OF THE SMARTCAP

## STEP TWO



1. REMOVE THE LEFT SIDE PANEL FROM ITS PACKAGING AND PROTECTIVE PLASTIC BAG.
2. YOU WILL NOTICE ONE END OF THE PANEL IS SLANTED. TO ENSURE IT'S CORRECTLY ORIENTATED, PLACE THE SLANTED END TOWARDS THE AIR-VENT ON THE ROOF PANEL.
3. ONCE ORIENTATED CORRECTLY, INSERT THE SIDE PANEL INTO THE ROOF. [SEE FIGURE 2]
4. TO ALLOW GREATER FLEXIBILITY FOR PANEL FITMENT, ONLY HAND TIGHTEN HARDWARE AT THIS STAGE. [SEE FIGURE 3]
5. WORK WITH CAUTION TO PREVENT ANY DAMAGE.

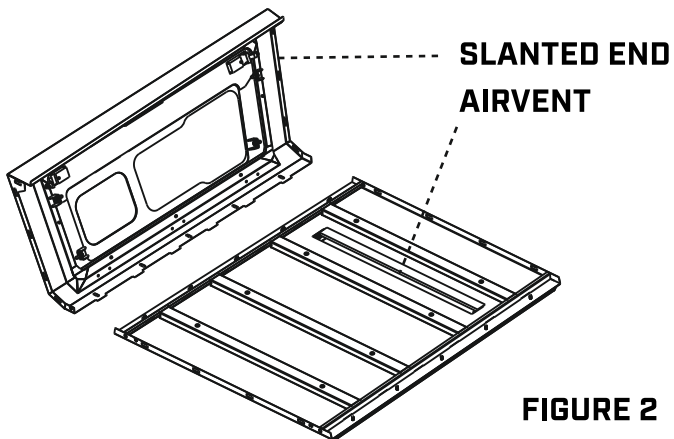

HOOKE THE SIDE PANEL INTO THE ROOF, CORRECTLY ORIENTATED, SLANTED END OF SIDE PANEL TO FACE THE DIRECTION OF THE ROOF AIR-VENT.

FIGURE 2

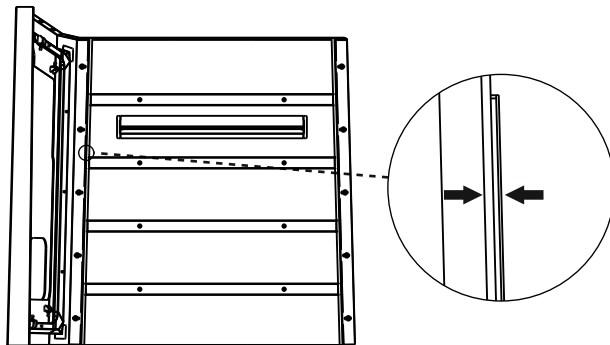

GENTLY TAP THE SIDE PANEL INTO PLACE, ENSURING THE GAP BETWEEN THE SIDE PANEL AND ROOF IS MINIMAL.

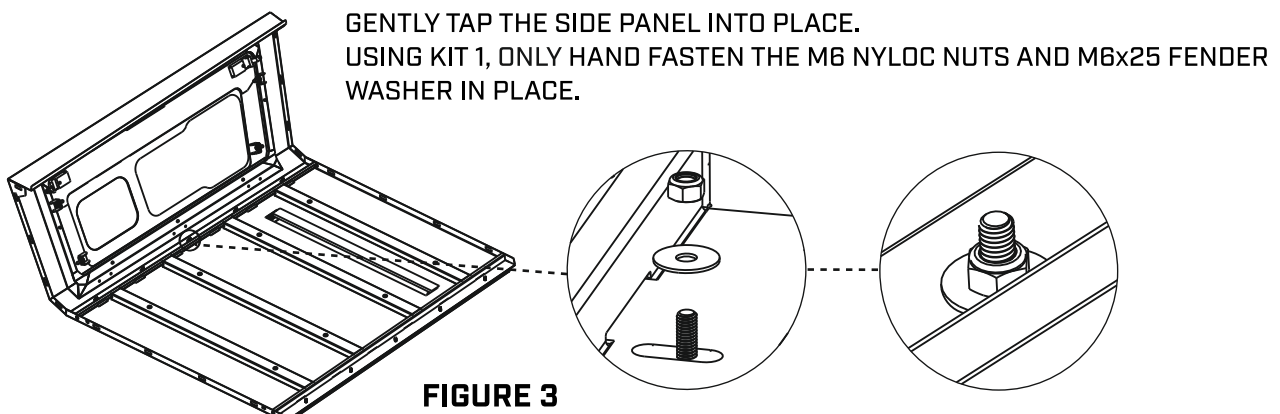

FIGURE 3

# ASSEMBLY OF THE SMARTCAP

## STEP THREE



1. REMOVE THE RIGHT HAND SIDE PANEL FROM ITS PACKAGING AND PROTECTIVE PLASTIC BAG.
2. HOOK THE SIDE PANEL INTO THE ROOF. [SEE FIGURE 4]
3. HAND FASTEN THE HARDWARE IN PLACE. [SEE FIGURE 5]
4. WORK WITH CAUTION TO PREVENT ANY DAMAGE.

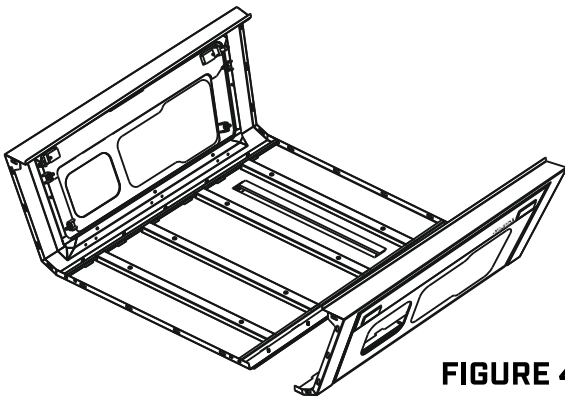
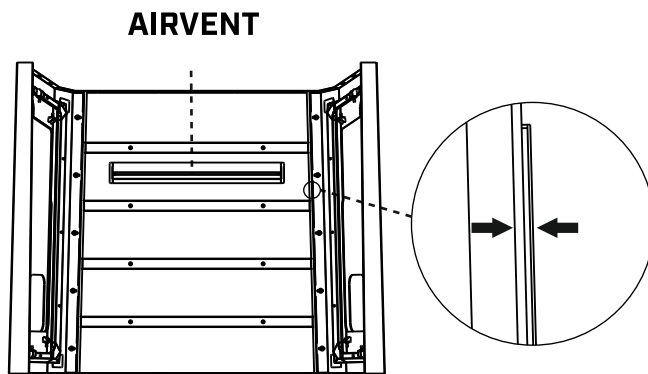
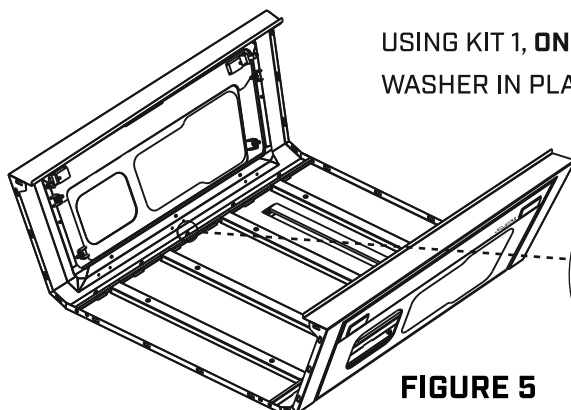

FIGURE 4

HOOK THE SIDE PANEL INTO THE ROOF, CORRECTLY ORIENTATED, SLANTED END OF THE SIDE PANEL TO FACE THE DIRECTION OF THE ROOF AIR-VENT.



GENTLY TAP THE SIDE PANEL INTO PLACE, ENSURING THE GAP BETWEEN THE SIDE PANEL AND ROOF IS MINIMAL.



USING KIT 1, **ONLY HAND FASTEN** THE M6 NYLOC NUTS AND M6x25 FENDER WASHER IN PLACE.

FIGURE 5

# ASSEMBLY OF THE SMARTCAP

## STEP FOUR

1. REMOVE HAND FASTENED CLIPS ON FRONT FLANGE TO RE-USE IN ASSEMBLY PROCESS.
2. START TO HAND FASTEN THE FRONT FLANGE IN THE CENTER AND ENSURE THE PANELS ARE FLUSH WITH ONE ANOTHER AT EACH POINT OF FASTENING.
3. FOLLOW THE FASTENING SEQUENCE BELOW. (SEE FIGURE 6)

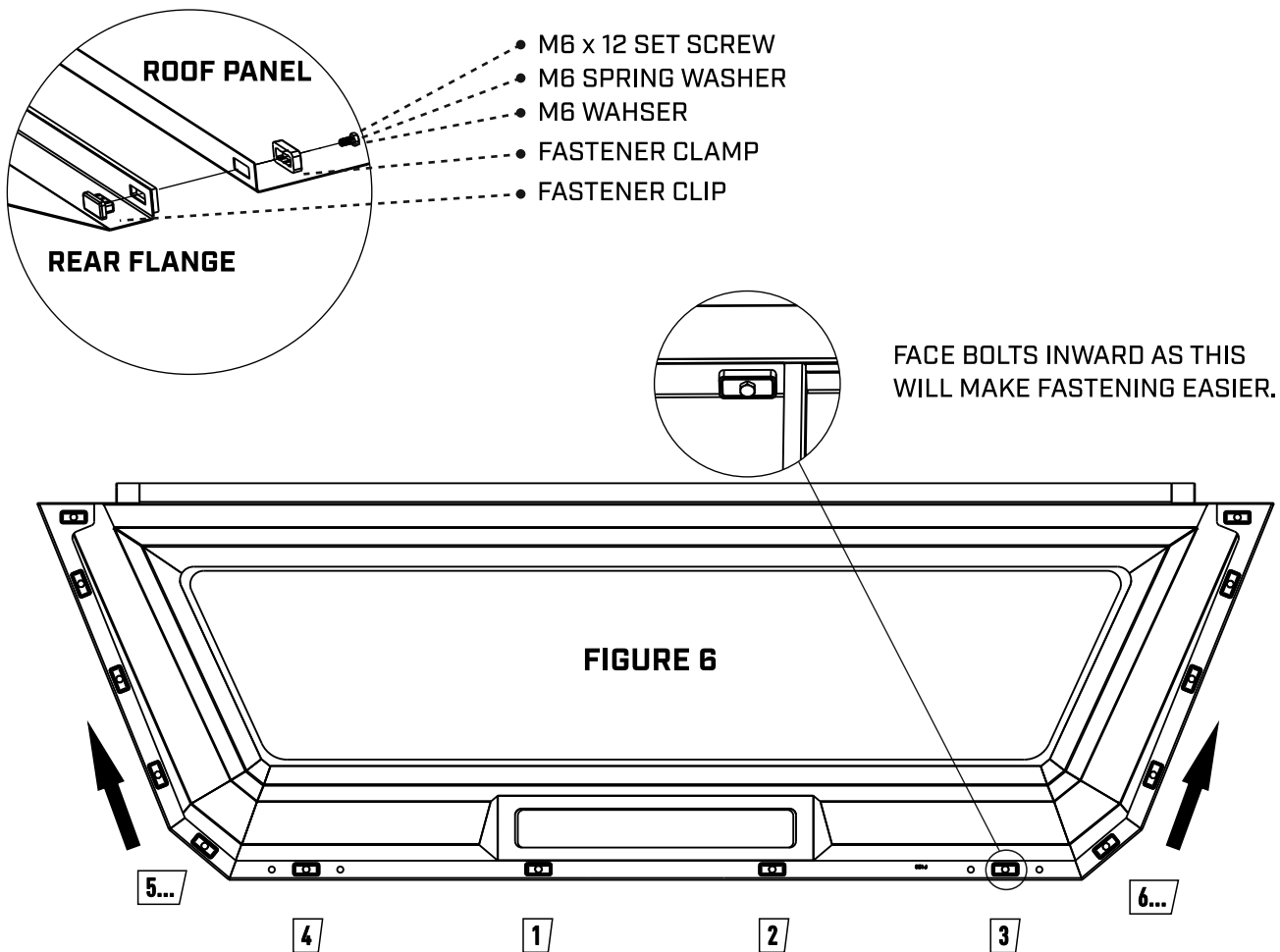

ENSURE THE FRONT FLANGE IS FLUSH WITH THE SIDE PANEL.

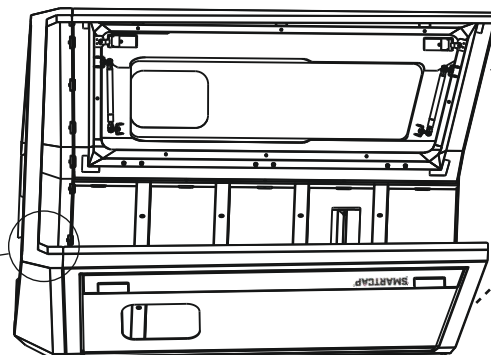
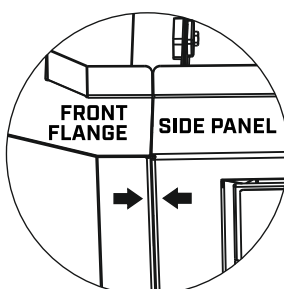

# ASSEMBLY OF THE SMARTCAP

## STEP FIVE

1. REMOVE HAND FASTENED CLIPS ON REAR FLANGE TO RE-USE IN ASSEMBLY PROCESS.
2. START TO HAND FASTEN THE REAR FLANGE IN THE CENTER AND ENSURE THE PANELS ARE FLUSH WITH ONE ANOTHER AT EACH POINT OF FASTENING.
3. FOLLOW THE FASTENING SEQUENCE BELOW. (SEE FIGURE 7)

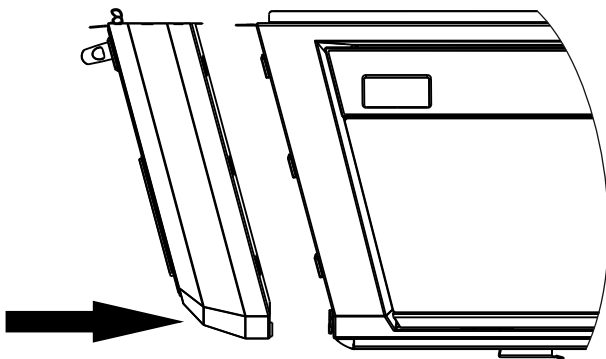
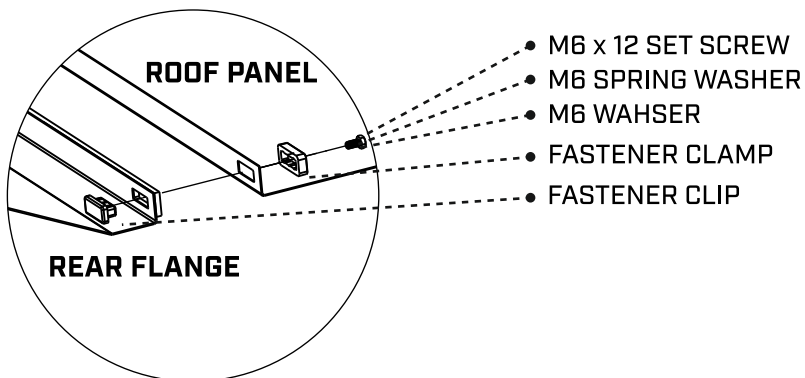

PUSH GENTLY WITH FOOT TO HELP STABILIZE THE FLANGE AND MAKE HAND TIGHTENING OF THE BOLTS EASIER.

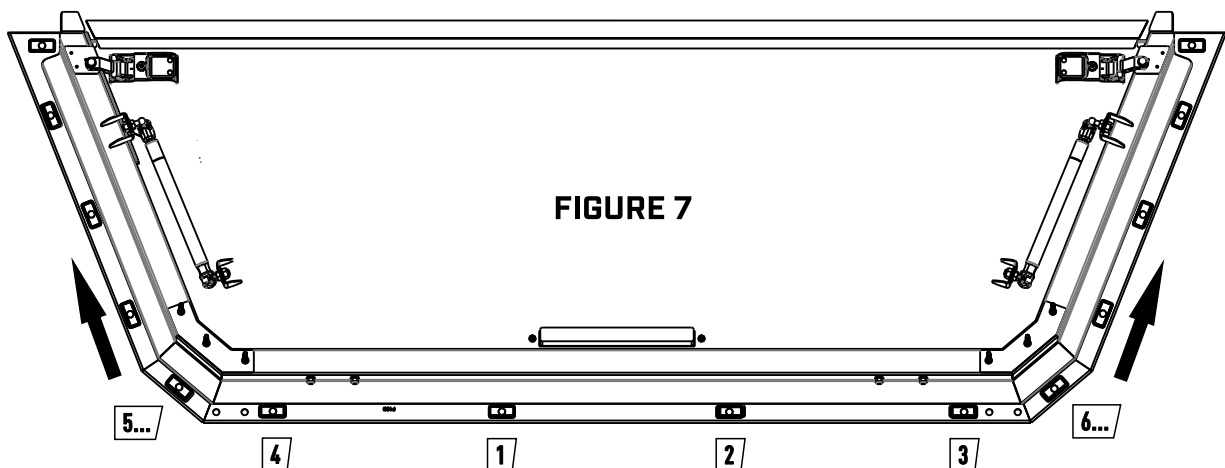

# ASSEMBLY OF THE SMARTCAP

## STEP SIX



1. ONCE THE SMARTCAP IS FULLY ASSEMBLED AND HAND TIGHTENED, PROCEED TO TORQUE THE FRONT AND REAR FLANGE FASTENERS 4.4.FT-LB, 53 IN-LB OR 6 NM.
2. PROCEED TO TORQUE THE M6 NYLOC NUTS WHICH WERE PREVIOUSLY HAND FASTENED TO THE ROOF, IN STEPS 2 & 3 [SEE FIGURE 8] 6.6 FT-LB, 79 IN-LB OR 9 NM.

FIGURE 8

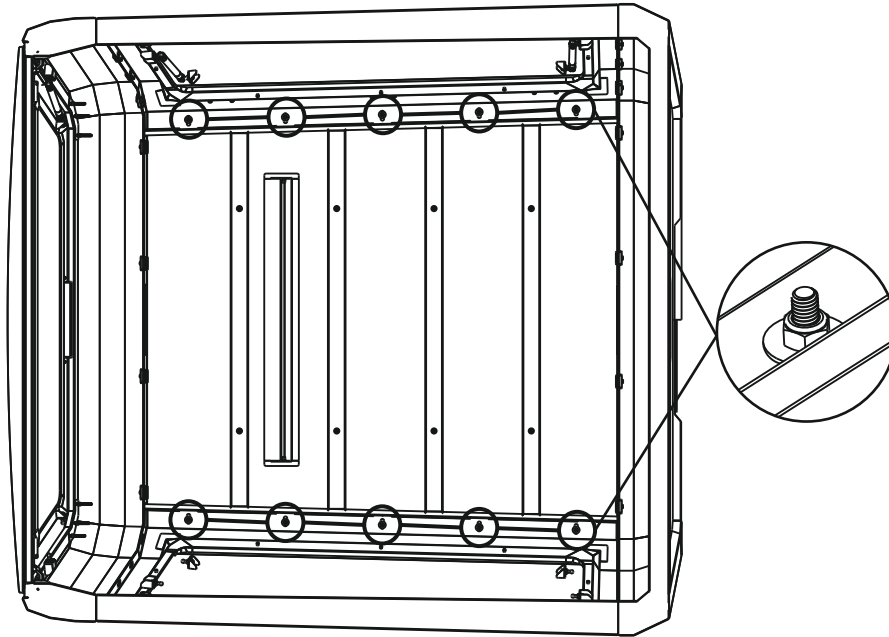

## STEP SEVEN



1. ONCE ALL HARDWARE IS TIGHTENED SUFFICIENTLY, PROCEED TO APPLY THE BOTTOM D - RUBBER / WEATHER STRIP.
2. REMOVE THE BACKING TAPE ON THE ADHESIVE STRIP SLOWLY AS YOU BOND THE RUBBER DOWN CAREFULLY.
3. APPLY THE D - RUBBER, STARTING ON THE RIGHT HAND SIDE OF THE REAR FLANGE. [SEE FIGURE 9, ON PAGE 12]

REMOVE GRADUALLY  
AS YOU CAREFULLY BOND  
DOWN THE WEATHER  
SEAL STRIP.

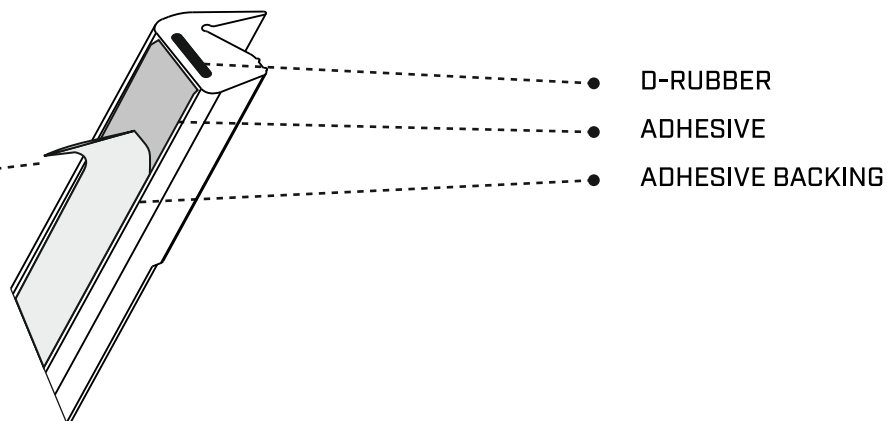

NOTE: MITSUBISHI TRITON AND LAND CRUISER CAPS CONTAIN 2 INDIVIDUAL PIECES  
[SEE PAGE 23 FOR MITSUBISHI TRITON]  
[SEE PAGE 24 FOR TOYOTA LAND CRUISER]

# ASSEMBLY OF THE SMARTCAP

FOLLOW BOTTOM EDGE OF SMARTCAP

FIGURE 9

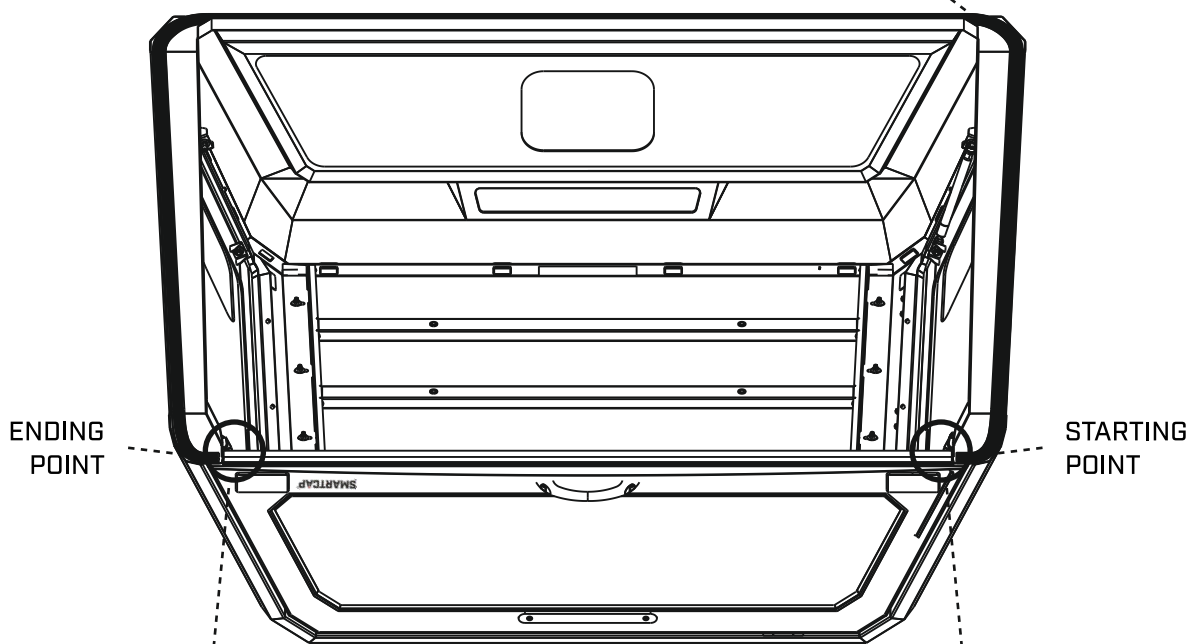

CUT STRAIGHT TO ENSURE IT IS  
LINING UP WITH THE REAR DOOR D-RUBBER.  
ENSURE IT IS A CLEAN STRAIGHT  
CUT WITH A SHARP  
BOX KNIFE OR SCISSORS.

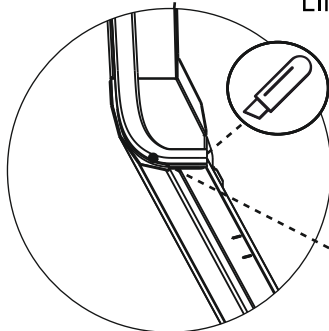

APPLY TO END OF  
FLANGE FOOT PLATE.

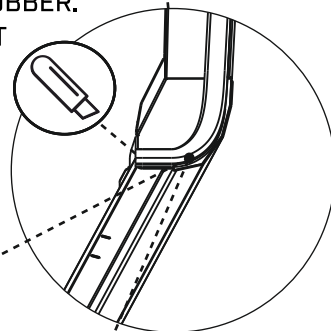

**PLEASE NOTE:**

APPLY D-RUBBER WEATHER STRIP  
AROUND BASE OF SMARTCAP.  
APPROXIMATELY 1/8" FROM THE EDGE.

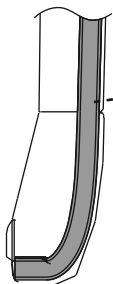

**PLEASE NOTE:**

FOR BEST RESULTS, BOND THE ENDS  
OF THE D RUBBER WEATHER STRIP DOWN  
WITH SUPER GLUE.

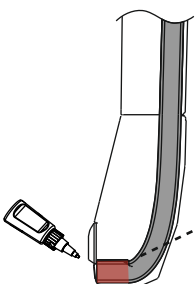

**ORIENTATION APPLICATION:**

D-RUBBER LIP TO FACE OUTWARDS

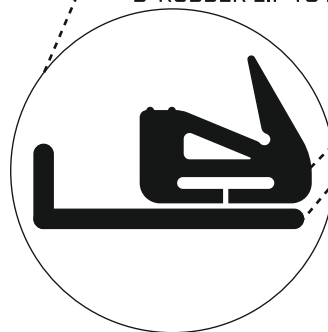

D-RUBBER  
CANOPY BOTTOM



# INSTALLATION COMPONENTS

## FITMENT KIT CONTENT [HARDWARE]

FORD RANGER

[PG.15]



TOYOTA HILUX

[PG.18]

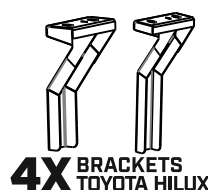

VW AMAROK

[PG.21]



ISUZU D-MAX

[PG.22]



MITSUBISHI  
TRITON

[PG.23]



TOYOTA  
LAND CRUISER

[PG.24]



# INSTALLATION OF THE SMARTCAP

## STEP ONE



1. SOME TRUCK BEDS MAY HAVE HEIGHT DIFFERENCES BETWEEN THE SIDES AND FRONT OF THE TRUCK BED. IF THAT IS THE CASE WITH YOUR TRUCK BED, APPLY A FOAM STRIP TO THE LIP OF THE FRONT PANEL.
2. REMOVE THE ADHESIVE BACKING TAPE FROM THE FOAM STRIP. (SEE FIGURE 1 & 2)
3. APPLY FOAM STRIP ON THE FRONT LIP OF THE PICK UP BOX TO ACCOUNT FOR ANY HEIGHT DIFFERENCES BETWEEN THE PICKUP BOX SIDES AND THE FRONT PICKUP BOX PANEL. (SEE FIGURE 2)
4. CUT TO LENGTH (SEE FIGURE 3)

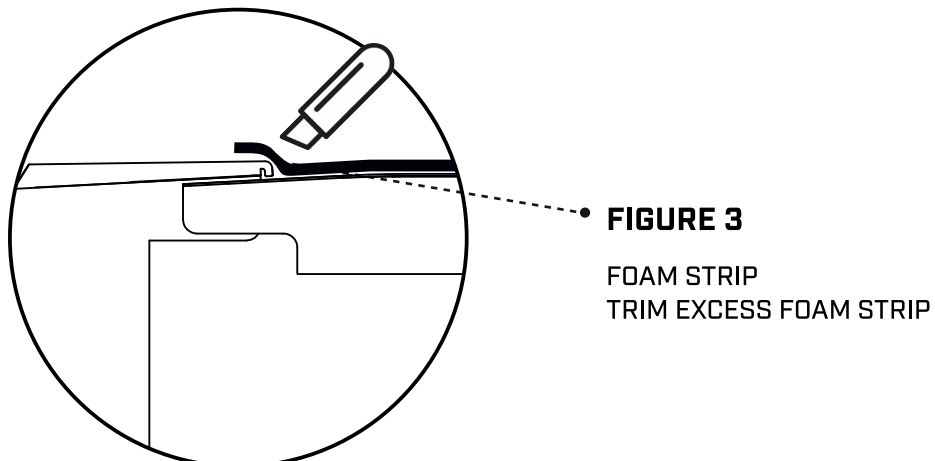
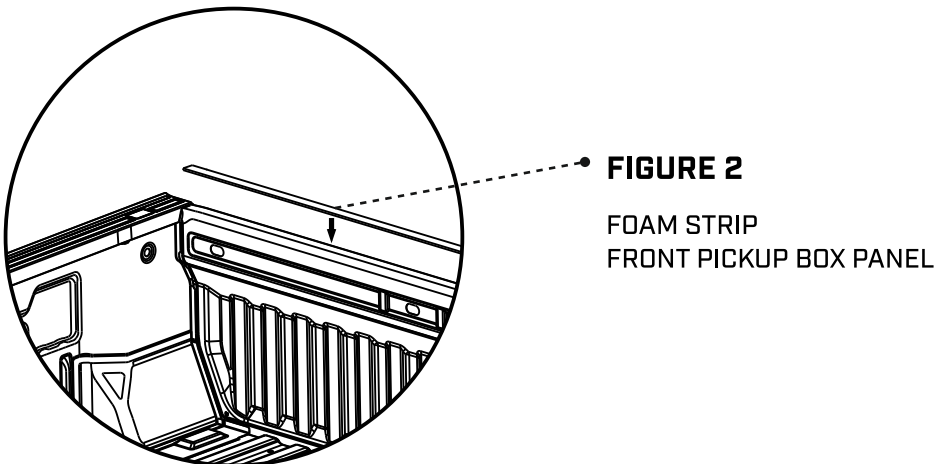
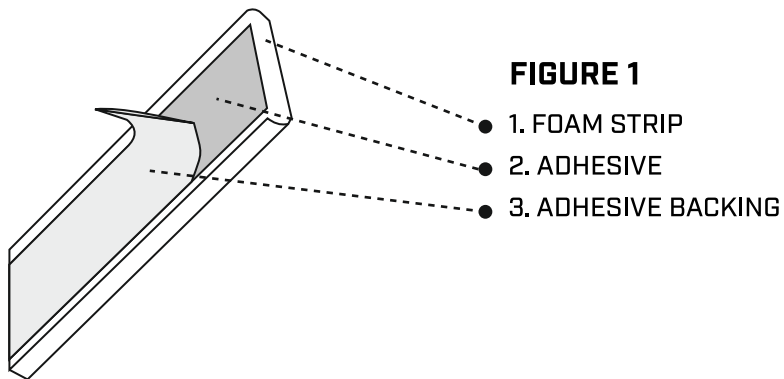

# INSTALLATION OF THE SMARTCAP

## FORD RANGER

### STEP ONE



1. SOME TRUCK BEDS MAY HAVE HEIGHT DIFFERENCES BETWEEN THE SIDES AND FRONT OF THE TRUCK BED. IF THAT IS THE CASE WITH YOUR TRUCK BED, APPLY A FOAM STRIP TO THE LIP OF THE FRONT PANEL.
2. REMOVE THE ADHESIVE BACKING TAPE FROM THE FOAM STRIP. [SEE FIGURE 1]
3. APPLY FOAM STRIP ON THE FRONT LIP OF THE PICK UP BOX TO ACCOUNT FOR ANY HEIGHT DIFFERENCES BETWEEN THE PICKUP BOX SIDES AND THE FRONT PICKUP BOX PANEL. [SEE FIGURE 2]
4. CUT TO LENGTH. [SEE FIGURE 3]

**FIGURE 1**

- 1. FOAM STRIP
- 2. ADHESIVE
- 3. ADHESIVE BACKING

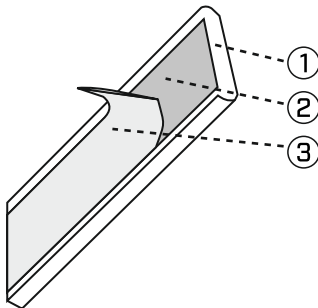

**FIGURE 2**

- FOAM STRIP FRONT PICKUP BOX PANEL

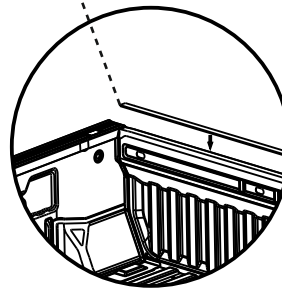

**FIGURE 3**

- FOAM STRIP TRIM EXCESS FOAM STRIP

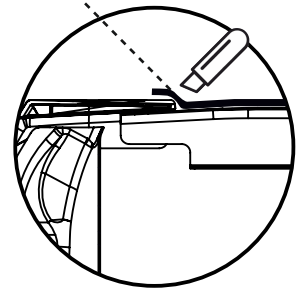

### STEP TWO



1. POSITION THE FRONT MOUNT BRACKET IN THE FRONT LEFT HAND CORNER OF THE LOAD BIN.
2. USE ONE M6 SET SCREW, WITH M6 SPRING WASHER AND M6 FENDER WASHER TO LOOSELY SCREW THE BRACKET TO THE FRONT OF THE LOAD BIN.
3. USE TWO M8 X 25 SET SCREWS WITH TWO M8 SPRING WASHERS AND M8 X 25 FENDER WASHERS TO FASTEN THE BRACKET TO THE SIDE OF THE LOAD BIN
4. REPEAT THIS PROCESS IN THE FRONT MOUNT BRACKET RIGHT HAND SIDE IN THE FRONT RIGHT HAND CORNER OF THE LOAD BIN.
5. TIGHTEN THE M8 HARDWARE TO 12NM AND M6 HARDWARE TO 9NM.

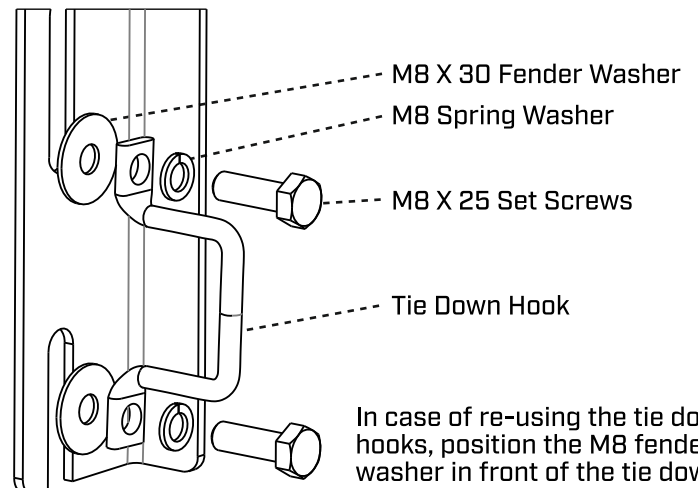
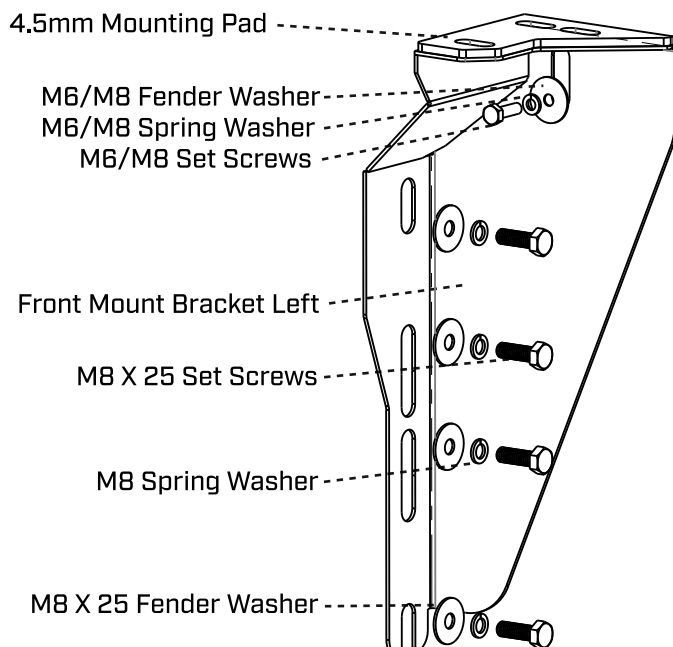

In case of re-using the tie down hooks, position the M8 fender washer in front of the tie down hook, then the M8 spring washer and lastly the M8 set screw.

# INSTALLATION OF THE SMARTCAP

## FORD RANGER

### STEP THREE



1. POSITION THE REAR MOUNT BRACKET LEFT HAND IN THE REAR LEFT HAND CORNER OF THE LOAD BIN.
2. USE TWO M8 X 25 SET SCREWS WITH M8 SPRING WASHERS AND M8 X 25 FENDER WASHERS TO LOOSELY SCREW THE BRACKET TO THE REAR OF THE LOAD BIN.
3. REPEAT THIS PROCESS IN THE REAR MOUNT BRACKET RIGHT HAND SIDE IN THE REAR RIGHT HAND CORNER OF THE LOAD BIN.
4. ONLY TIGHTEN THE M8 HARDWARE TO 12NM AFTER THE SMARTCAP HEIGHT HAS BEEN ADJUSTED AS STATED IN STEP FOUR.

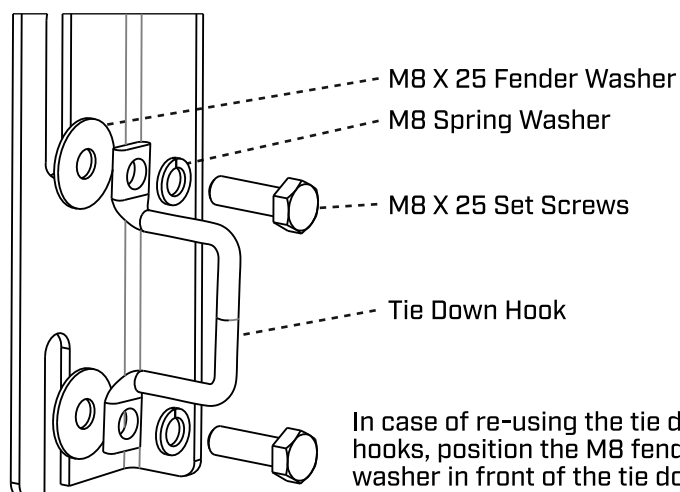
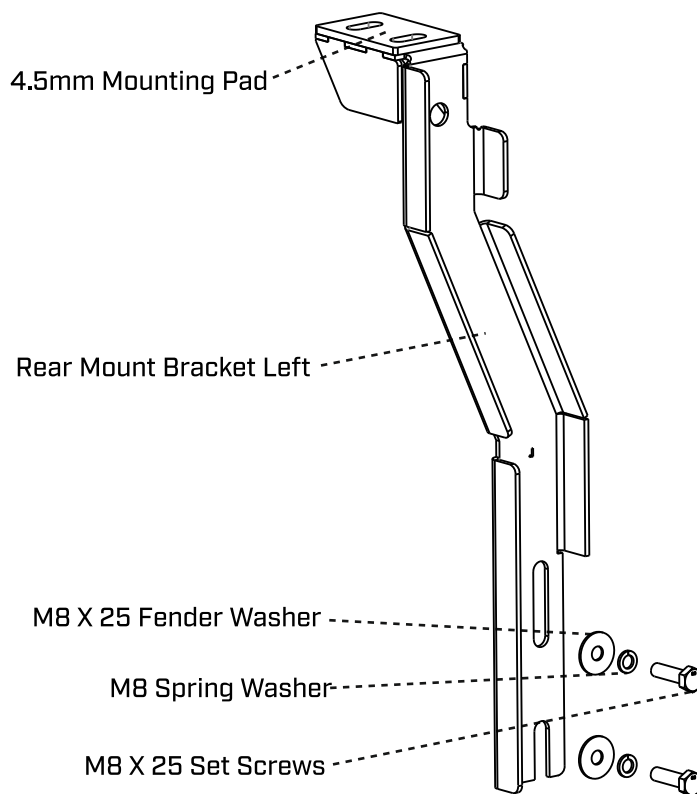

In case of re-using the tie down hooks, position the M8 fender washer in front of the tie down hook, then the M8 spring washer and lastly the M8 set screw.

# INSTALLATION OF THE SMARTCAP

## FORD RANGER

### STEP FOUR

1. PLACE THE SMARTCAP ONTO THE LOAD BIN.
2. PLEASE LIFT WITH CAUTION TO PREVENT POSSIBLE INJURY. IT IS RECOMMENDED THAT A MINIMUM OF FOUR PEOPLE ARE USED TO LIFT THE SMARTCAP.
3. MAKE SURE THE CAP IS IN ITS CORRECT POSITION BY LINING UP THE SLOTS ON THE SMARTCAP WITH THE SLOTS ON THE MOUNTING BRACKETS.
4. USE SIX M8 X 25 SET SCREWS WITH TWELVE M8 X 25 FENDER WASHERS AND SIX M8 NYLOC NUTS TO LOOSELY FASTEN THE SMARTCAP TO THE FRONT MOUNT BRACKETS.
5. USE FOUR M8 X 25 SET SCREWS WITH EIGHT M8 X 25 FENDER WASHERS AND FOUR M8 NYLOC NUTS TO LOOSELY FASTEN SMARTCAP TO THE REAR MOUNT BRACKETS.
6. ONCE ALL THE SET SCREWS ARE IN THEIR CORRECT POSITIONS, FASTEN TO 6NM.
7. ADJUST REAR BRACKETS TO ACHIEVE 2 - 3MM COMPRESSION OF THE D-RUBBER ON THE TAILGATE. TAILGATE SHOULD SLIGHTLY GRAZE THE D-RUBBER WHEN CLOSING. [SEE FIGURE 3.1]
8. CONTINUE TO TIGHTEN THE REAR BRACKETS HARDWARE TO 12NM TO THE LOAD BIN.
9. REPEAT PROCESS ON THE OPPOSITE SIDE OF SMARTCAP.

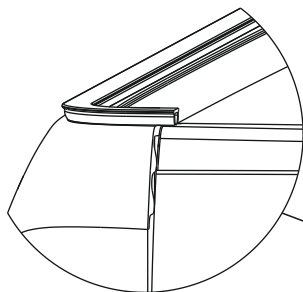

FIGURE 1

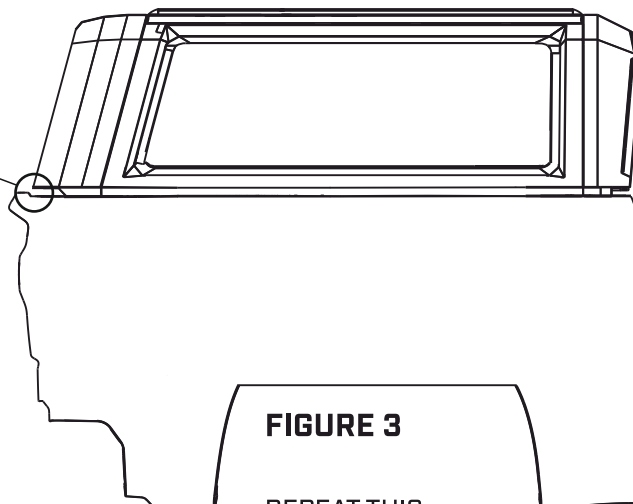
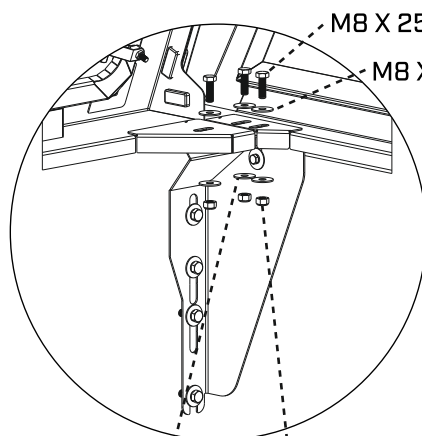
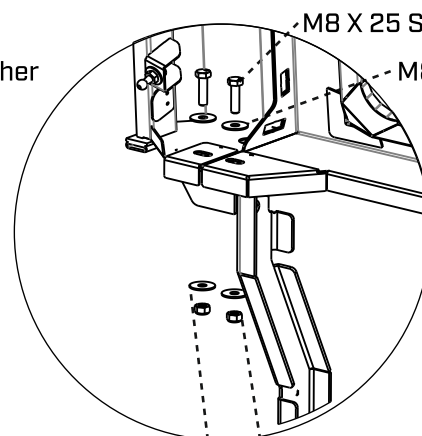

FIGURE 3

REPEAT THIS  
PROCEDURE ON THE  
OPPOSITE HAND SIDE  
OF THE VEHICLE.



M8 X 25 Fender Washer M8 Nyloc Nut



M8 X 25 Fender Washer M8 Nyloc Nut

# INSTALLATION OF THE SMARTCAP

TOYOTA HILUX

## STEP ONE



1. SOME TRUCK BEDS MAY HAVE HEIGHT DIFFERENCES BETWEEN THE SIDES AND FRONT OF THE TRUCK BED. IF THAT IS THE CASE WITH YOUR TRUCK BED, APPLY A FOAM STRIP TO THE LIP OF THE FRONT PANEL.
2. REMOVE THE ADHESIVE BACKING TAPE FROM THE FOAM STRIP. [SEE FIGURE 1]
3. APPLY FOAM STRIP ON THE FRONT LIP OF THE PICK UP BOX TO ACCOUNT FOR ANY HEIGHT DIFFERENCES BETWEEN THE PICKUP BOX SIDES AND THE FRONT PICKUP BOX PANEL. [SEE FIGURE 2]
4. CUT TO LENGTH. [SEE FIGURE 3]

**FIGURE 1**

- 1. FOAM STRIP
- 2. ADHESIVE
- 3. ADHESIVE BACKING

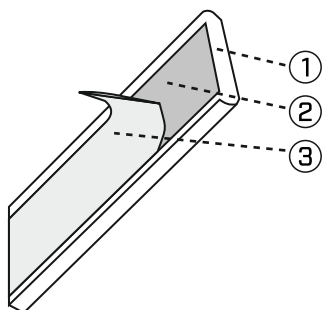

**FIGURE 2**

- FOAM STRIP FRONT PICKUP BOX PANEL

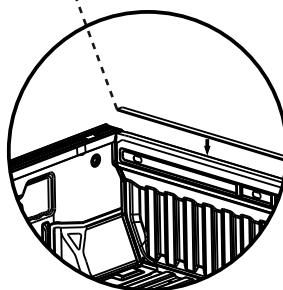

**FIGURE 3**

- FOAM STRIP TRIM EXCESS FOAM STRIP

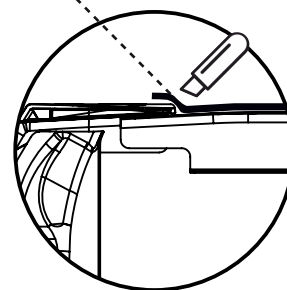

## STEP TWO



1. POSITION THE FRONT MOUNT BRACKET IN THE FRONT LEFT HAND CORNER OF THE LOAD BIN.
2. USE TWO M8 X 25 SET SCREWS WITH TWO M8 SPRING WASHERS AND M8 X 25 FENDER WASHERS TO FASTEN THE BRACKET TO THE SIDE OF THE LOAD BIN.
3. REPEAT THIS PROCESS IN THE FRONT MOUNT BRACKET RIGHT HAND SIDE IN THE FRONT RIGHT HAND CORNER OF THE LOAD BIN.

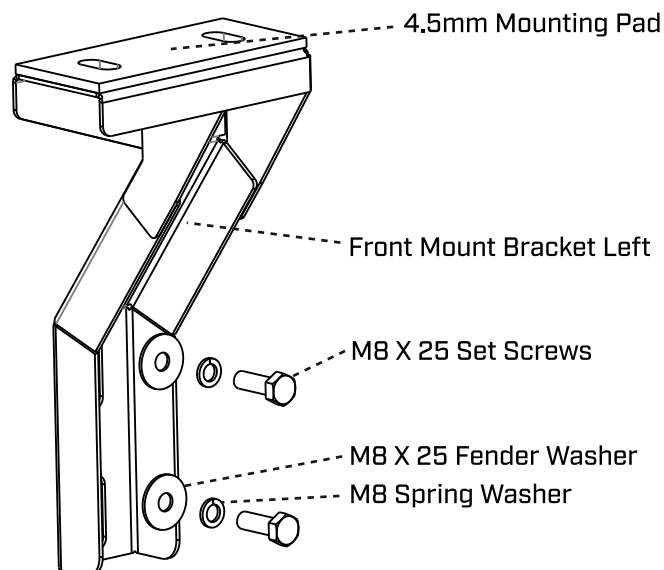
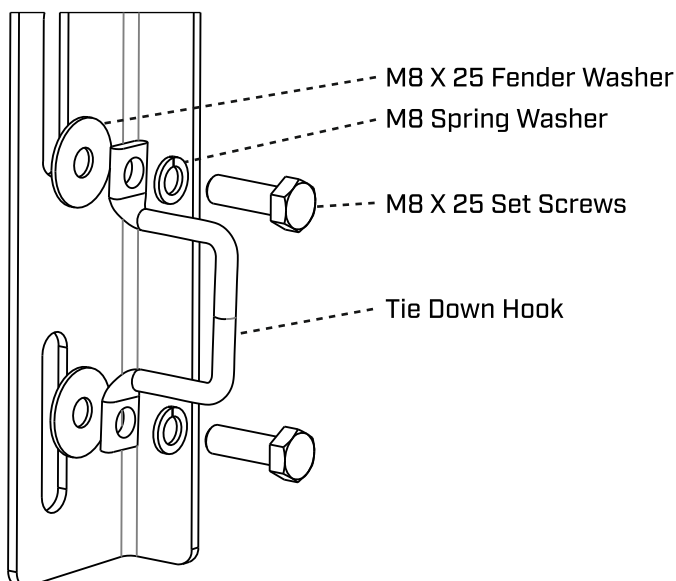

In case of re-using the tie down hooks, position the M8 fender washer in front of the tie down hook, then the M8 spring washer and lastly the M8 set screw.

# INSTALLATION OF THE SMARTCAP

TOYOTA HILUX

## STEP THREE



1. POSITION THE REAR MOUNT BRACKET LEFT HAND IN THE REAR LEFT HAND CORNER OF THE LOAD BIN.
2. USE TWO M8 X 25 SET SCREWS WITH TWO M8 SPRING WASHERS AND M8 X 25 FENDER WASHERS TO LOOSELY SCREW THE BRACKET TO THE REAR OF THE LOAD BIN.
3. REPEAT THIS PROCESS IN THE REAR MOUNT BRACKET RIGHT HAND SIDE IN THE REAR RIGHT HAND CORNER OF THE LOAD BIN.

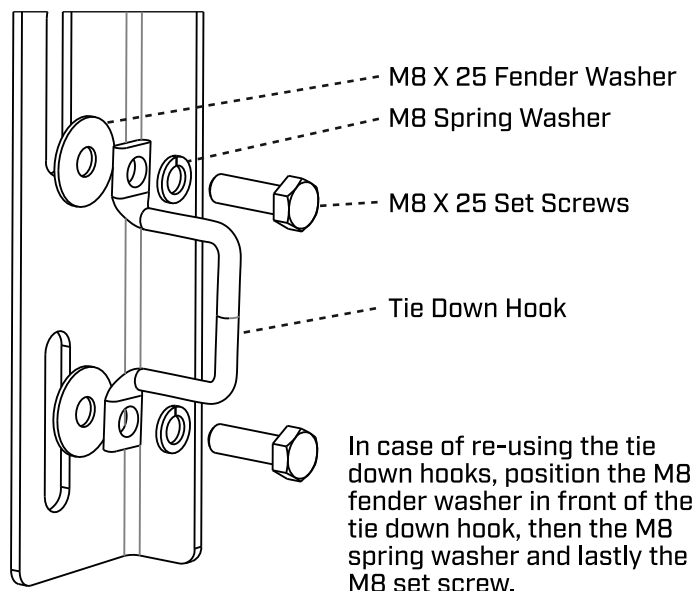
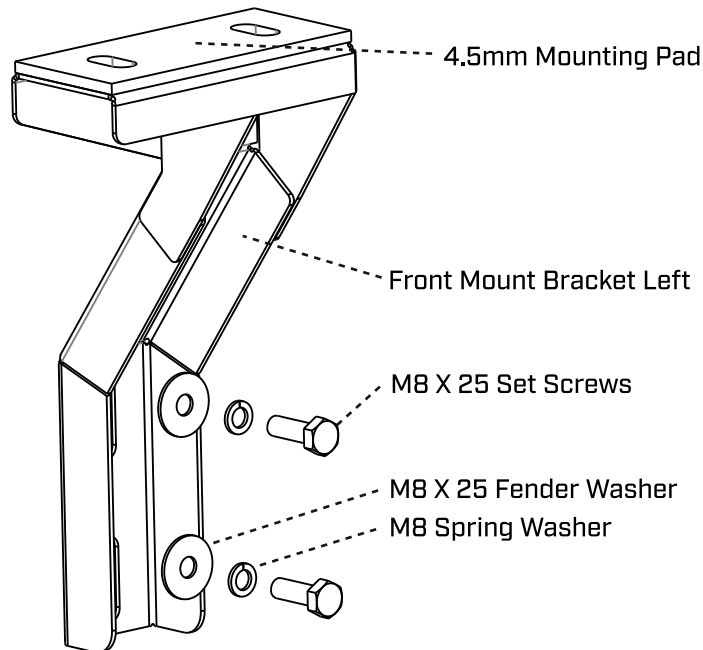

## STEP FOUR

1. PLACE THE SMARTCAP ONTO THE LOAD BIN.
2. PLEASE LIFT WITH CAUTION TO PREVENT POSSIBLE INJURY. IT IS RECOMMENDED THAT A MINIMUM OF FOUR PEOPLE ARE USED TO LIFT THE SMARTCAP.
3. MAKE SURE THE CAP IS IN ITS CORRECT POSITION BY LINING UP THE SLOTS ON THE SMARTCAP WITH THE SLOTS ON THE MOUNTING BRACKETS.

# INSTALLATION OF THE SMARTCAP

TOYOTA HILUX

## STEP FIVE



1. USE FOUR M8 X 25 SET SCREWS WITH EIGHT M8 X 25 FENDER WASHERS AND FOUR M8 NYLOC NUTS TO LOOSELY FASTEN THE SMARTCAP TO THE FRONT MOUNT BRACKETS.
2. USE FOUR M8 X 25 SET SCREWS WITH EIGHT M8 FLAT WASHERS AND FOUR M8 NYLOC NUTS TO LOOSELY FASTEN THE SMARTCAP TO THE REAR MOUNT BRACKETS.
3. ONCE ALL THE SET SCREWS ARE IN THEIR CORRECT POSITIONS, FASTEN TO 12NM OR 8.9 FT-LBS.
4. ADJUST REAR CLAMPS TO ACHIEVE 2 - 3MM COMPRESSION OF THE D-RUBBER ON THE TAILGATE. TAILGATE SHOULD SLIGHTLY GRAZE THE D-RUBBER WHEN CLOSING. (SEE FIGURE 1)

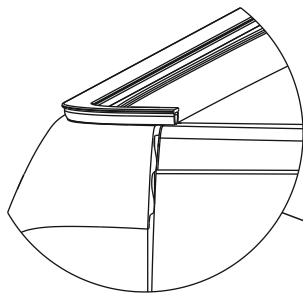

FIGURE 1

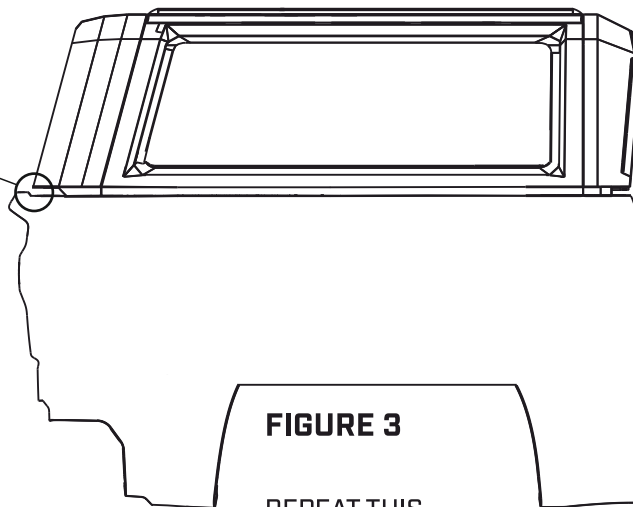
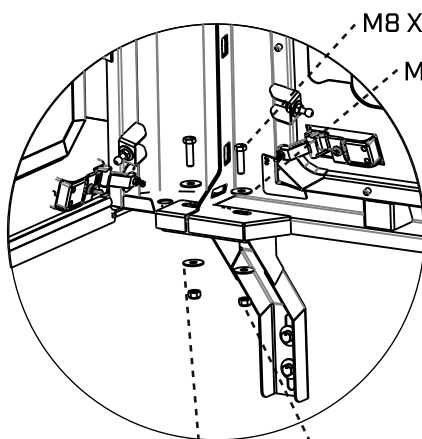

FIGURE 3

REPEAT THIS  
PROCEDURE ON THE  
OPPOSITE HAND SIDE  
OF THE VEHICLE.



M8 X 25 Fender Washer

M8 Nyloc Nut

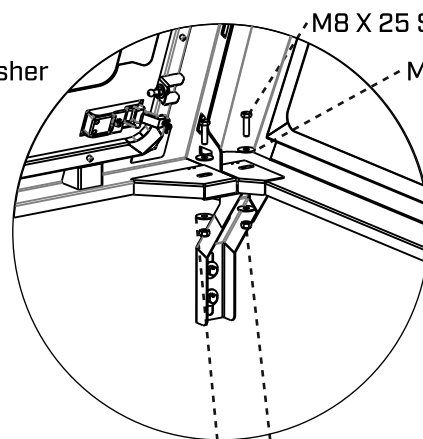

M8 X 25 Fender Washer

M8 Nyloc Nut



# INSTALLATION OF THE SMARTCAP

VW AMAROK

## STEP ONE

1. USING THE HARDWARE BELOW, POSITION THE LEFT HAND SIDE REAR BRACKET AND HAND FASTEN ALL HARDWARE IN PLACE.
2. PLEASE WORK WITH CAUTION TO PREVENT UNNECESSARY DAMAGE.
3. REPEAT THE PROCESS ON THE OPPOSITE SIDE.

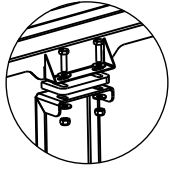

Thick Rubber Pad To Go In Between Canopy And Bracket. The Shorter Foot Mounted to the Cap.

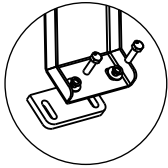

Thick Rubber Pad To Go In Between Bin And Bracket. The Longer Foot Mounted to the Base.

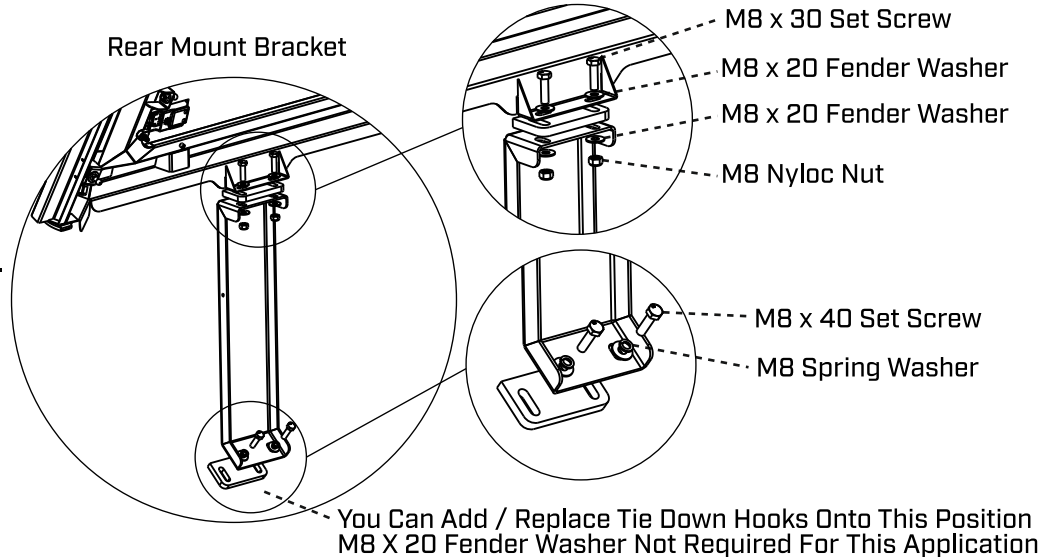

## STEP TWO

1. POSITION THE FRONT LEFT HAND SIDE BRACKET IN PLACE AND USE THE HARDWARE DEPICTED BELOW TO HAND FASTEN THE FRONT LEFT HAND SIDE MOUNTING BRACKET.
2. WORK WITH CAUTION TO PREVENT UNNECESSARY DAMAGE.
3. REPEAT THE PROCESS ON THE OPPOSITE SIDE.

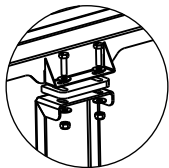

Thick Rubber Pad To Go In Between Canopy And Bracket. The Shorter Foot Mounted to the Cap.

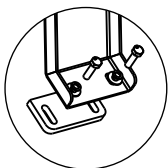

Thick Rubber Pad To Go In Between Bin And Bracket. The Longer Foot Mounted to the Base.

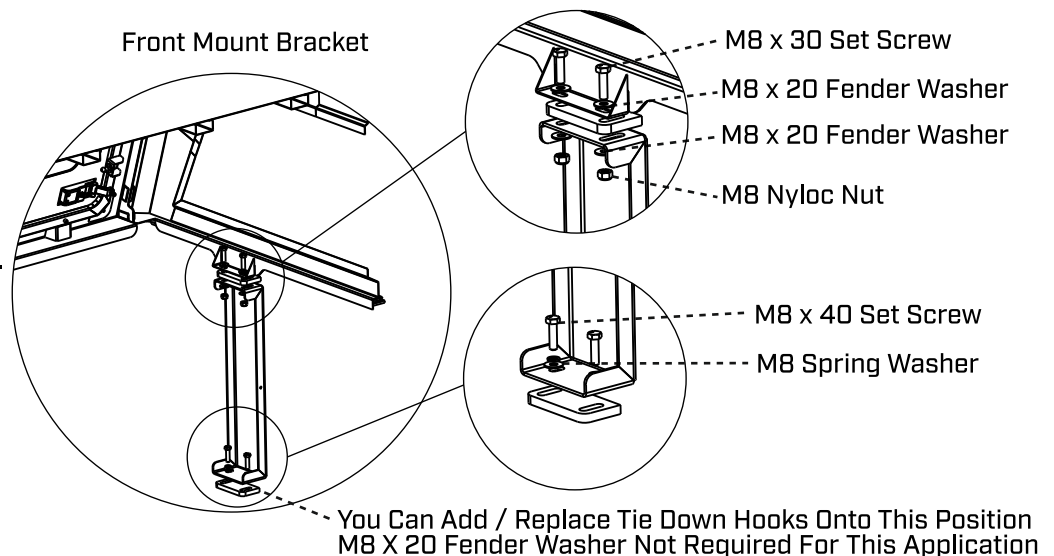

## STEP THREE

1. PLACE THE SMARTCAP ONTO THE LOAD BIN.
2. MAKE SURE THE RSI SMARTCAP IS IN ITS CORRECT POSITION BY LINING UP THE SLOTS ON THE RSI SMARTCAP WITH THE SLOTS ON THE MOUNTING BRACKET.
3. PLEASE LIFT WITH CAUTION TO PREVENT POSSIBLE INJURY. IT IS RECOMMENDED A MINIMUM OF FOUR PEOPLE ARE USED TO LIFT THE SMARTCAP.
4. ONCE ALL THE SET SCREWS ARE IN THEIR CORRECT POSITIONS, FASTEN TO 6NM OR 4.4 FT-LBS.

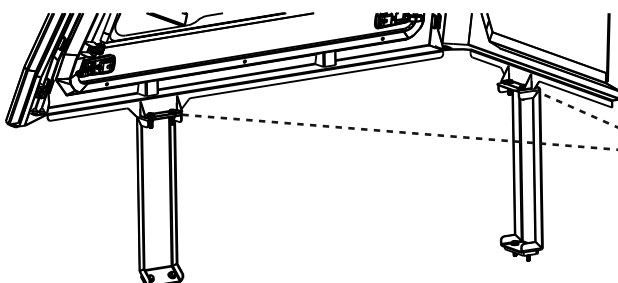

Mounting Brackets Bolted In Place Once The SmartCap is Centralised On The loadbin.

# INSTALLATION OF THE SMARTCAP

ISUZU D-MAX

## STEP ONE

1. REMOVE EXISTING BOLTS ON THE REAR TOP CORNERS OF THE LOAD BIN AS SHOWN AS FIGURE 2.
2. POSITION THE REAR MOUNT BRACKET RIGHT HAND IN THE REAR RIGHT HAND CORNER OF THE LOAD BIN.
3. USE TWO M6 X 25 SET SCREWS WITH TWO M6 SPRING WASHERS AND M6 FLAT WASHERS TO SCREW THE BRACKET TO THE REAR OF THE LOAD BIN.
4. REPEAT THIS PROCESS IN THE REAR MOUNT BRACKET LEFT HAND SIDE IN THE REAR LEFT HAND CORNER OF THE LOAD BIN.

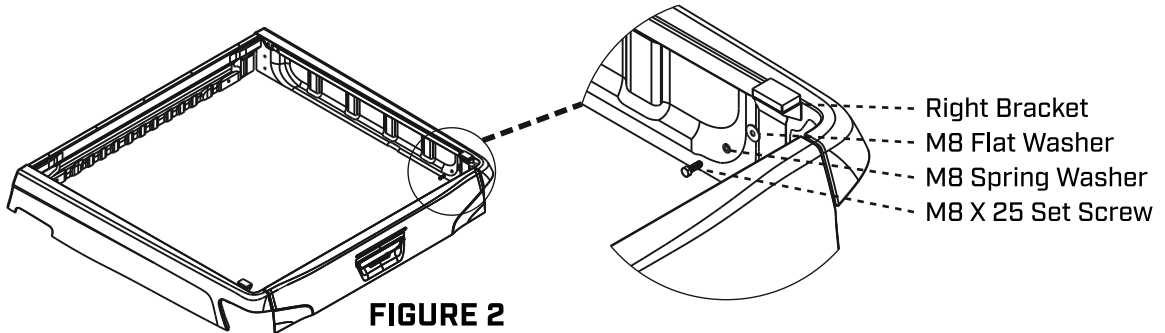

## STEP TWO



1. A MINIMUM OF FOUR PEOPLE ARE RECOMMENDED TO PICK UP AND PLACE THE SMARTCAP ONTO THE TRUCK.
2. TO KEEP FROM DAMAGING YOUR D-RUBBER DURING THE INSTALLATION PROCESS, IT IS IMPORTANT YOU LIFT THE SMARTCAP IN PLACE AND DO NOT DRAG IT ACROSS THE TRUCK BED RAILS.
3. ONCE THE SMARTCAP IS CENTERED, PLACE CLAMPS IN POSITION. (SEE FIGURE 3)
4. PLACE THE SUPPLIED THIN RUBBER PAD ON THE SIDE PANEL TO PREVENT CLAMP FROM SCRATCHING THE PAINT. (SEE FIGURE 4)
5. PROCEED TO SUFFICIENTLY TORQUE THE CLAMPS TO 9 FT-LB, 108 IN-LB OR 12.2 NM.

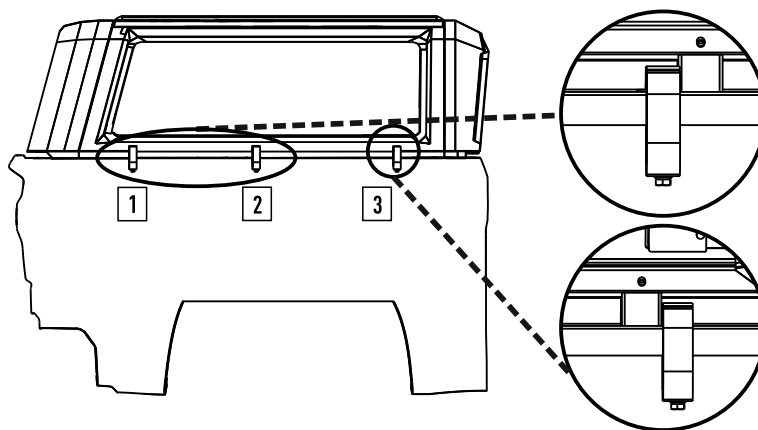

**FIGURE 3**

REPEAT THIS  
PROCEDURE ON THE  
OPPOSITE HAND SIDE  
OF THE VEHICLE.

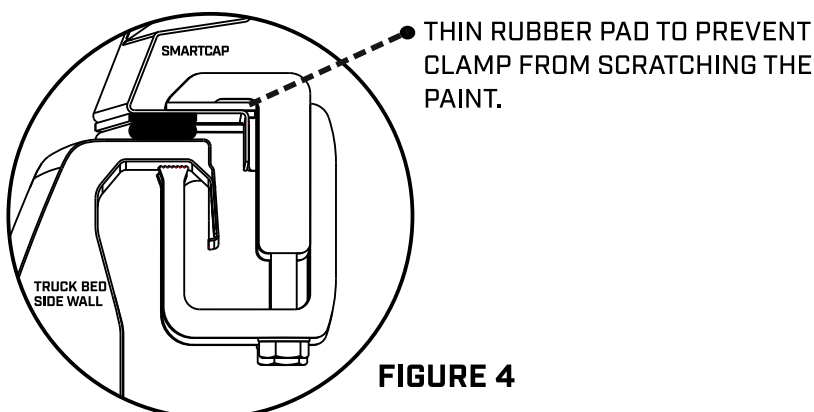

# INSTALLATION OF THE SMARTCAP

## MITSUBISHI TRITON

### STEP ONE

1. THE MITSUBISHI TRITON BED HAS A HEIGHT DIFFERENCE BETWEEN THE SIDES AND FRONT OF THE TRUCK BED. APPLY A FOAM STRIP TO THE LIP OF THE FRONT PANEL.
2. REMOVE THE ADHESIVE BACKING TAPE FROM THE FOAM STRIP. [SEE FIGURE 1]
3. APPLY FOAM STRIP ON THE FRONT LIP OF THE CAP FRONT FLANGE. [SEE FIGURE 2]
4. CUT TO THE CORNER. [SEE FIGURE 2]

**FIGURE 1**

- 1. FOAM STRIP
- 2. ADHESIVE
- 3. ADHESIVE BACKING

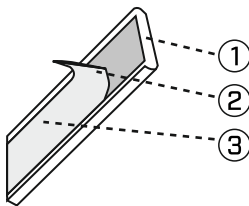

- APPLY 5X30 FOAM SEAL TAPE

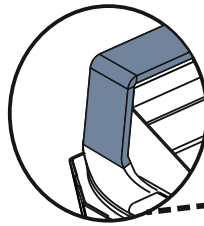

- APPLY 1 X 1700mm D-RUBBER

- APPLY 1 X 1700mm D-RUBBER

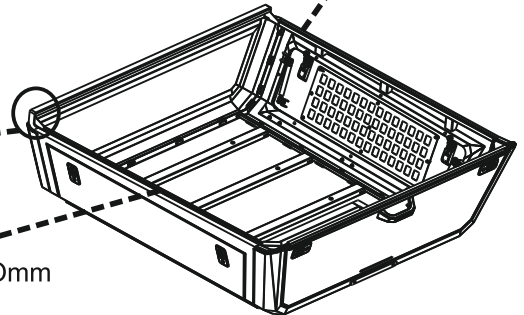

**FIGURE 2**

### STEP TWO

1. A MINIMUM OF FOUR PEOPLE ARE RECOMMENDED TO PICK UP AND PLACE THE SMARTCAP ONTO THE TRUCK.
2. TO KEEP FROM DAMAGING YOUR D-RUBBER DURING THE INSTALLATION PROCESS, IT IS IMPORTANT YOU LIFT THE SMARTCAP IN PLACE AND DO NOT DRAG IT ACROSS THE TRUCK BED RAILS.
3. ONCE THE SMARTCAP IS CENTERED, PLACE CLAMPS IN POSITION. [SEE FIGURE 3]
4. PLACE THE SUPPLIED THIN RUBBER PAD ON THE SIDE PANEL TO PREVENT CLAMP FROM SCRATCHING THE PAINT. [SEE FIGURE 4]
5. PROCEED TO SUFFICIENTLY TORQUE THE CLAMPS TO 9 FT-LB, 108 IN-LB OR 12.2 NM.



THIN RUBBER PAD TO PREVENT CLAMP FROM SCRATCHING THE PAINT.

13mm  
(1/2 INCH)

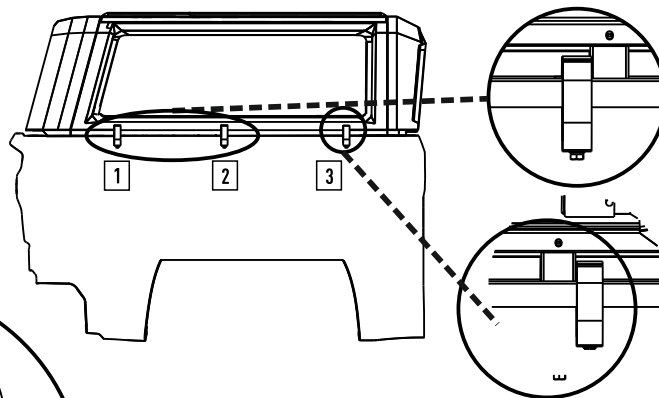
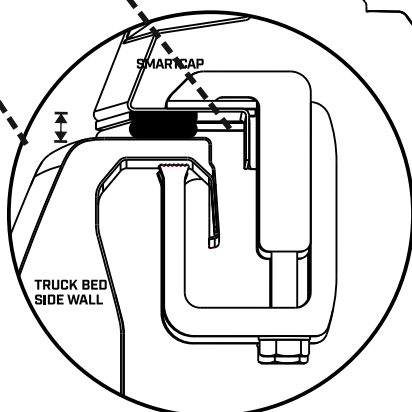

**FIGURE 3**

REPEAT THIS PROCEDURE ON THE OPPOSITE HAND SIDE OF THE VEHICLE.

**FIGURE 4**

# INSTALLATION OF THE SMARTCAP

## TOYOTA LAND CRUISER

### STEP ONE



1. A MINIMUM OF FOUR PEOPLE ARE RECOMMENDED TO PICK UP AND PLACE THE SMARTCAP ONTO THE TRUCK.
2. TO KEEP FROM DAMAGING YOUR D-RUBBER DURING THE INSTALLATION PROCESS, IT IS IMPORTANT YOU LIFT THE SMARTCAP IN PLACE AND DO NOT DRAG IT ACROSS THE TRUCK BED RAILS.
3. ALIGN DRILL JIG WITH VEHICLE BIN RAIL. (SEE FIGURE 3 & 4)
4. MARK HOLE POSITIONS OR DRILL HOLES WITH THE JIG IN PLACE.
5. ADD 4 OFF 30X10MM FOAM SEAL AS SHOWN IN THE BELOW IMAGE TO PREVENT DUST FROM ENTERING THE CAP FROM THE FRONT END OF THE CAB. (SEE FIGURE 4)
6. APPLY D-RUBBER AS PER BELOW IMAGE.
7. MOUNT CAP TO BIN USING 6 OFF M8X30MM S/S HEX BOLTS WITH NYLON LOCKNUTS AND 25MM S/S FENDER WASHERS. (SEE FIGURE 5)
8. INSERT 48MM PLASTIC END CAP TO THE ALLOCATED CUT OUTS.

FOAM SEAL 30X10MM AT 1595MM  
FITTED TO FRONT CHANNEL

FIGURE 4

FIGURE 3

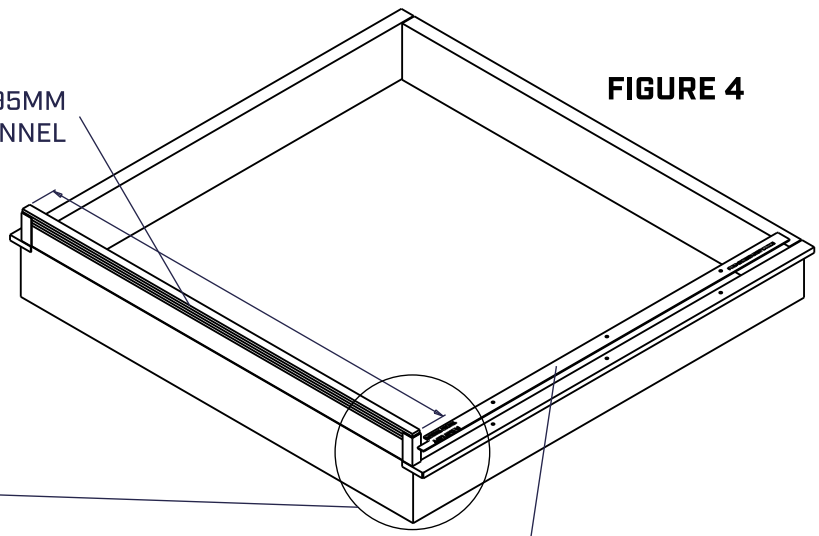
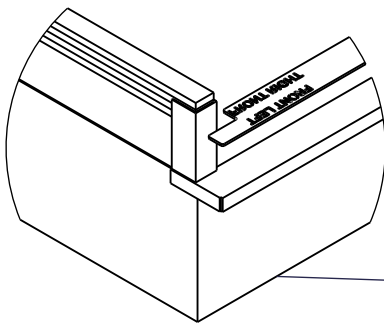

PLACE DRILL JIG FLUSH WITH  
SIDE EDGE AND FRONT EDGE  
FOR CORRECT DRILLING POSITION

FIGURE 5

48MM PLASTIC END CAP

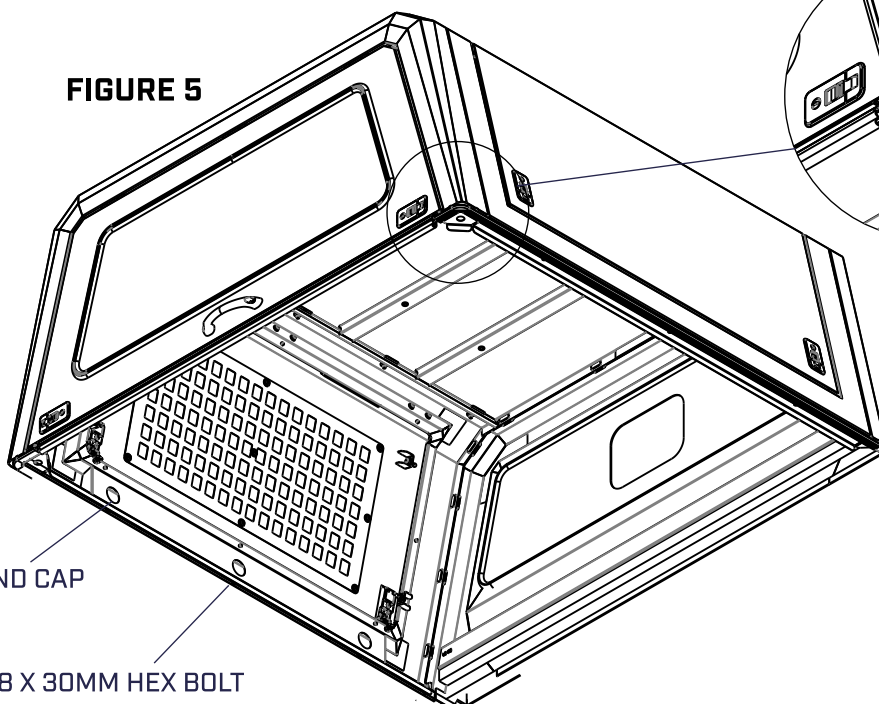

1 X M8 X 30MM HEX BOLT  
1 X M8 NYLOC NUT  
2 X M8 X 25MM FENDER WASHER

# THIRD BRAKE LIGHT WIRING

FORD RANGER - TOYOTA HILUX - VW AMAROK - ISUZU D-MAX



## WARNING

- VEHICLE SHOULD BE TURNED OFF WHEN INSTALLING THE T-HARNESS.
- ALL STEPS MUST BE FOLLOWED TO ENSURE THE CORRECT FUNCTION OF THE THIRD BRAKE LIGHT AND TRAILER PLUG.
- TO VERIFY PROPER INSTALLATION, TEST BY CONNECTING A TEST LIGHT OR PROPERLY WIRED TRAILER.

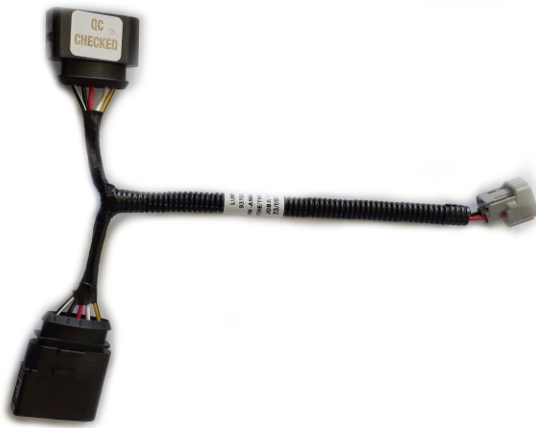

**1X** WIRE HARNESS  
VW AMAROK



**1X** WIRE HARNESS  
FORD RANGER DC



**1X** WIRE HARNESS  
TOYOTA HILUX



**1X** WIRE HARNESS  
ISUZU D-MAX



# WIRING REFERENCE GUIDE



# WIRING REFERENCE GUIDE

## STEP ONE

- REMOVE THE LEFT HAND SIDE TAILLIGHT ASSEMBLY, REVEALING THE CAVITY BEHIND THE TAILLIGHT. **REFER TO PICTURE (A)**

## STEP TWO

- LOCATE THIRD BRAKE LIGHT 2-PIN PLUG HANGING OFF THE SMARTCAP ON THE LEFT HAND SIDE NEAR THE TAILGATE AND CONNECT THE T-HARNESS TO IT. **REFER TO PICTURE (B)**

## STEP THREE

- INSERT THE SUPPLIED T-HARNESS BETWEEN THE FACTORY PLUG AND THE FACTORY 7-WAY CONNECTOR. BE SURE THAT BOTH ENDS OF THE T-HARNESS ARE FULLY INSERTED WITH THE LOCKING TABS IN PLACE. **REFER TO PICTURE (C1,2,3 & 4)**

## STEP FOUR

- DISCONNECT THE BRAKE LIGHT CABLE (MALE END) FROM THE TAILLIGHT ASSEMBLY AND CONNECT IT TO THE T-HARNESS (FEMALE CONNECTOR). THEN CONNECT THE T-HARNESS (MALE END) TO THE TAILLIGHT ASSEMBLY. **REFER TO PICTURE (D)**

## STEP FIVE

- TEST THE BRAKE LIGHTS AND TURN SIGNALS. CHECK TO MAKE SURE PROPER TURN SIGNAL FUNCTIONALITY WHEN THE BRAKE LIGHTS ARE ON.

## STEP SIX

- ONCE YOU ARE SURE EVERYTHING IS FUNCTIONING CORRECTLY, RE-INSTALL THE TAILLIGHT ASSEMBLY.

## STEP SEVEN

- THERE WILL BE EXCESS CABLE UNDER YOUR VEHICLE THAT YOU SHOULD SECURE USING A ZIP-TIE. **REFER TO PICTURE (E)**

## NOTES

[illegible]





Thank you for purchasing your SmartCap. Should you have any inquiries about the Assembly & Installation, please feel free to contact us.