

SMARTCAP®

INSTRUCTION GUIDE

FORD RANGER EDITION

2012-2022

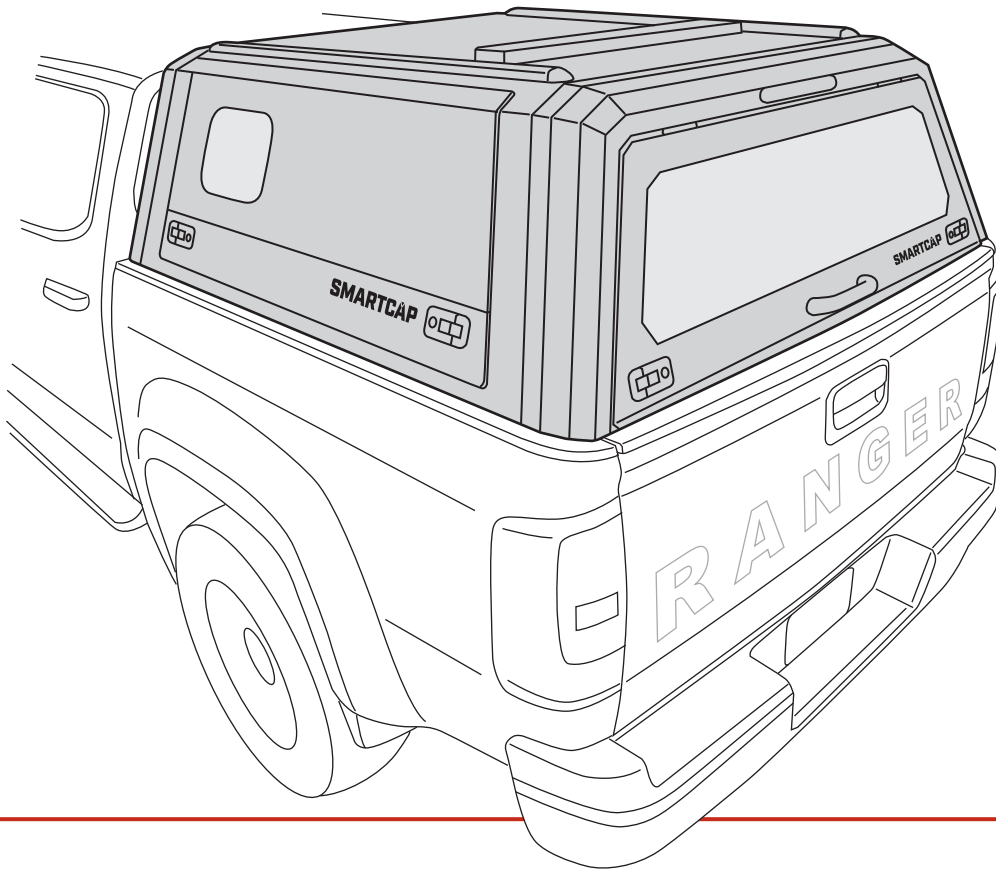

- ▼ **READ THROUGH THE ENTIRE INSTRUCTION GUIDE BEFORE STARTING THIS PROCEDURE AND FOLLOW THE STEPS CAREFULLY TO AVOID ANY DAMAGE TO THE COMPONENTS OR THE VEHICLE.**

SMARTCAP.COM

SUPPORT.SA@SMARTCAP.COM - REST OF WORLD

SUPPORT.NA@SMARTCAP.COM - NORTH AMERICA/CANADA



P-IGUIDE-ROW-R1

TOOLS REQUIRED

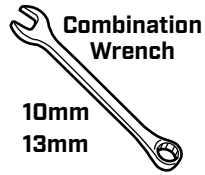
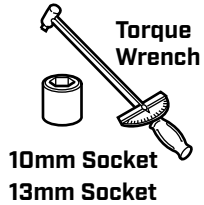
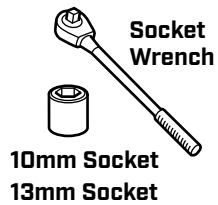

IMPORTANT

- ▼ USE ONLY THE TOOLS RECOMMENDED ABOVE.
- ▼ USE ONLY THE HARDWARE PROVIDED IN THIS KIT.
- ▼ ASSISTANCE WILL BE NEEDED FOR THIS INSTALLATION. FOUR PEOPLE ARE RECOMMENDED TO LIFT THE SMARTCAP ONTO THE VEHICLE.
- ▼ AVOID PINCHING OR CRUSHING HANDS AND FINGERS.
- ▼ INSPECT ALL KIT COMPONENTS FOR DAMAGE BEFORE ASSEMBLY.
- ▼ NEVER USE ACETONE OR THINNERS ON PAINTED PARTS.

COMPONENTS

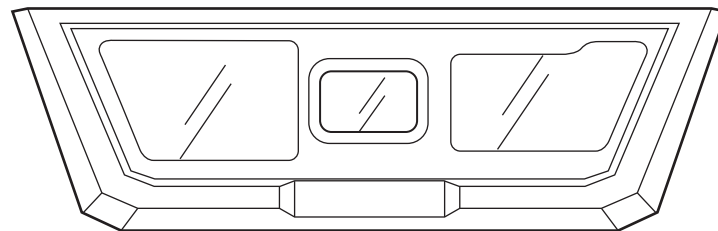

LEFT PANEL

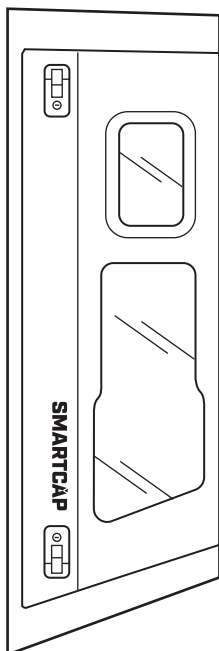

RIGHT PANEL

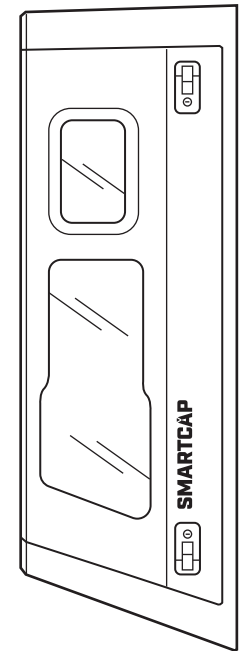

ROOF PANEL

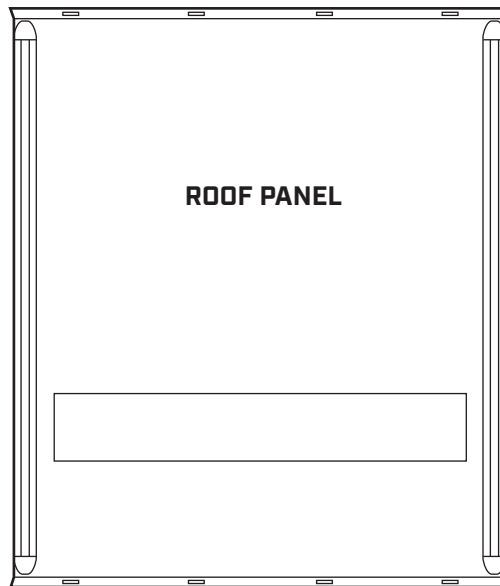

REAR FLANGE

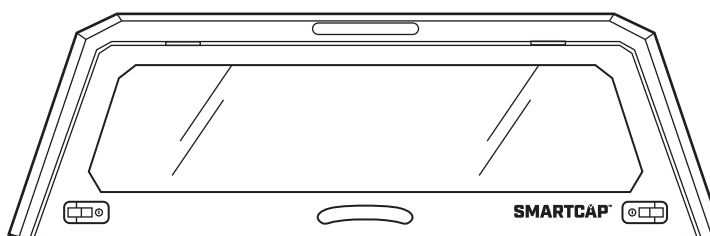

ASSEMBLY HARDWARE

[HAND FASTENED TO FLANGES]

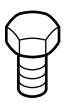

M6 BOLT
28X

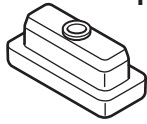

FASTENER BLOCK
28X

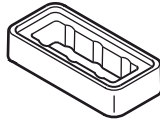

FASTENER BLOCK CLAMP
28X

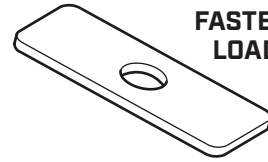

FASTENER BLOCK LOADSPREADER
28X



M6 LOCK WASHER
28X



M6 LOCK NUT

10X SHORT BED
12X STANDARD BED



M6 FENDER WASHER

10X SHORT BED
12X STANDARD BED

SPARE HARDWARE



M6 BOLT
1X



M6 FENDER WASHER
1X



NUT CAP
4X

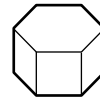

HEX CAP
4X

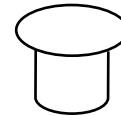

BARREL PLUG
4X

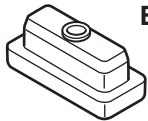

FASTENER BLOCK
1X

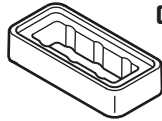

FASTENER BLOCK CLAMP
1X

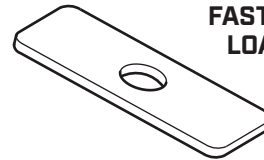

FASTENER BLOCK LOADSPREADER
1X

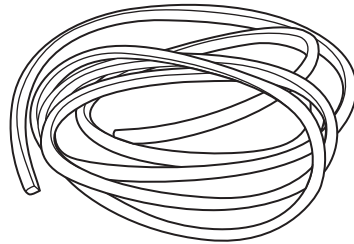

D - RUBBER
1X



STEP 1

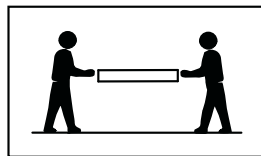

IMPORTANT

- BE SURE TO REMOVE ALL FIVE PANELS FROM THEIR PACKAGING AND INSPECT THE PAINTED SURFACES PRIOR TO ASSEMBLY, AS SMARTCAP WILL NOT ACCEPT PAINT DAMAGE WARRANTY CLAIMS AFTER ASSEMBLY IS COMPLETED. IF MANUFACTURING IMPERFECTIONS OR SHIPPING DAMAGES ARE FOUND DO NOT CONTINUE WITH THE ASSEMBLY PROCESS AND CONTACT

SUPPORT.SA@SMARTCAP.COM - REST OF WORLD
SUPPORT.NA@SMARTCAP.COM - NORTH AMERICA/CANADA

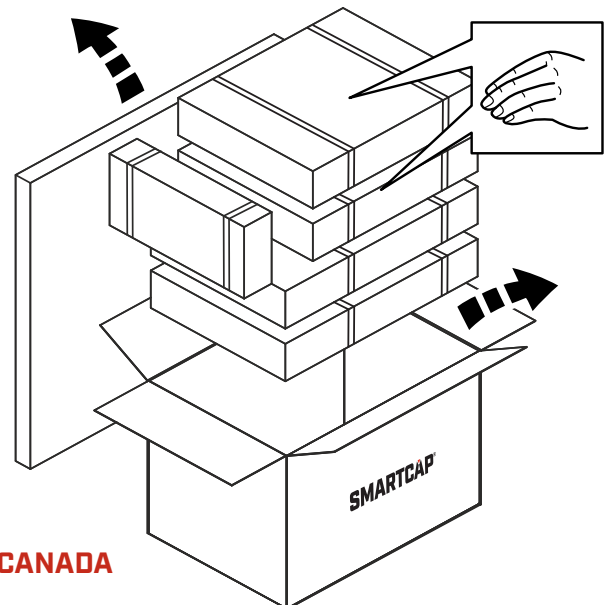

STEP 2

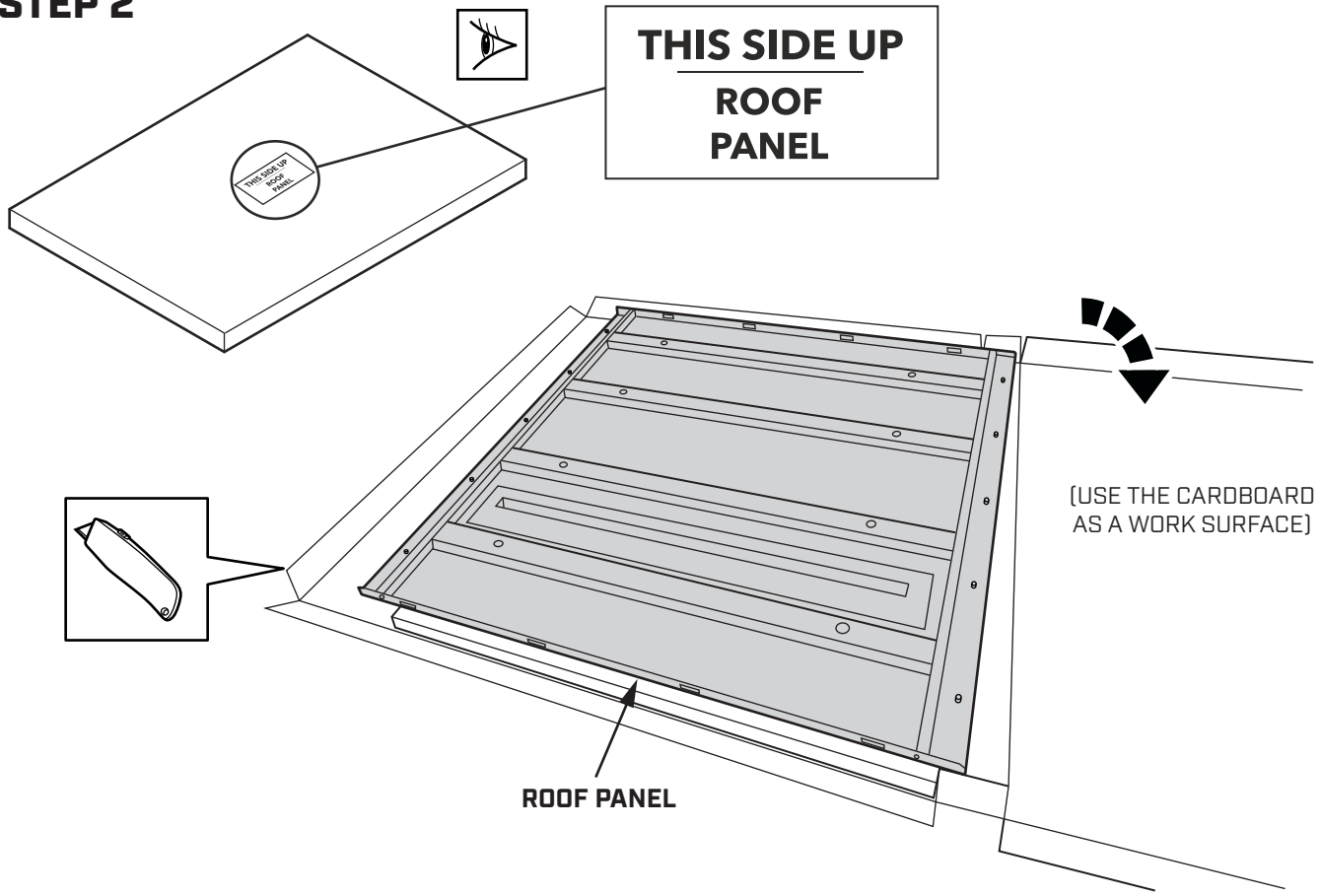

STEP 3

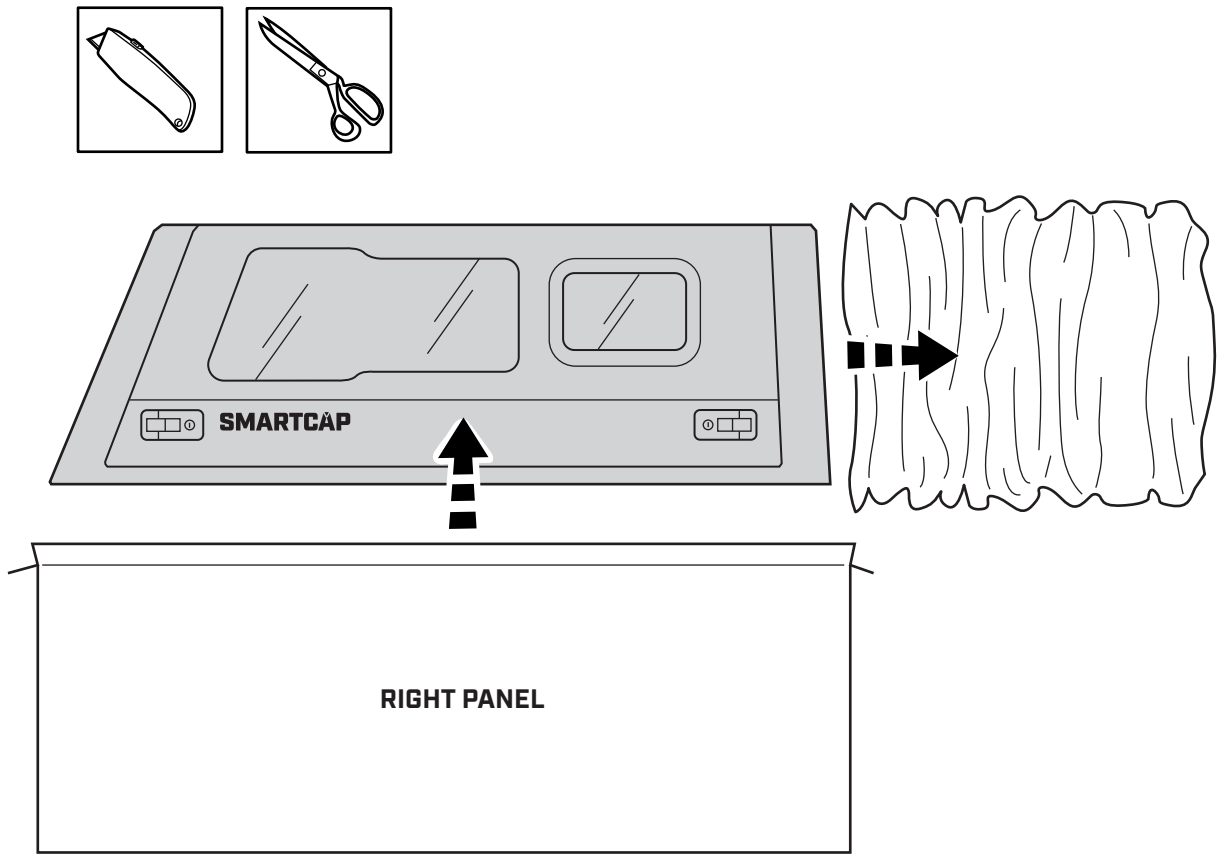

STEP 4

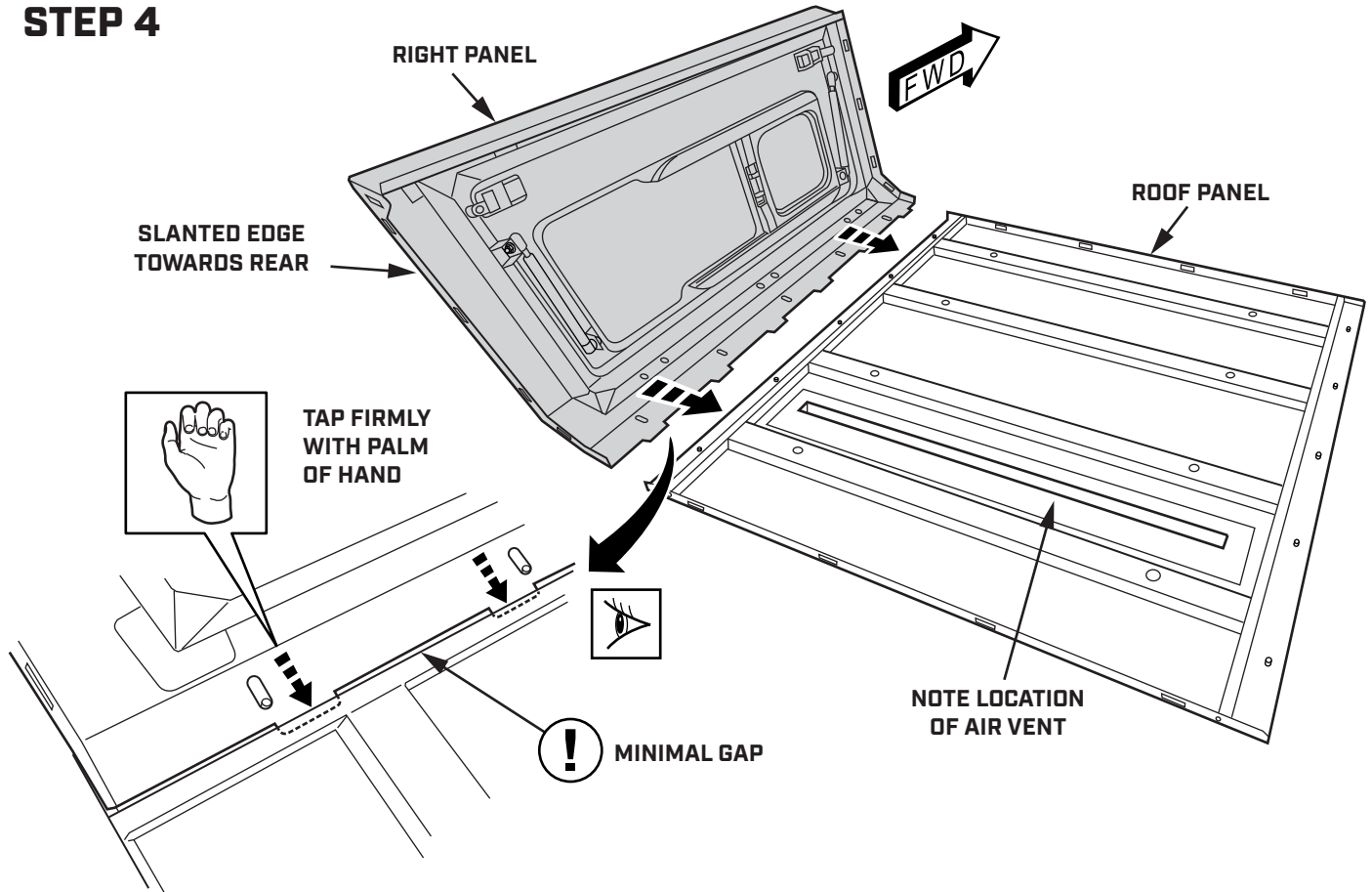

STEP 5

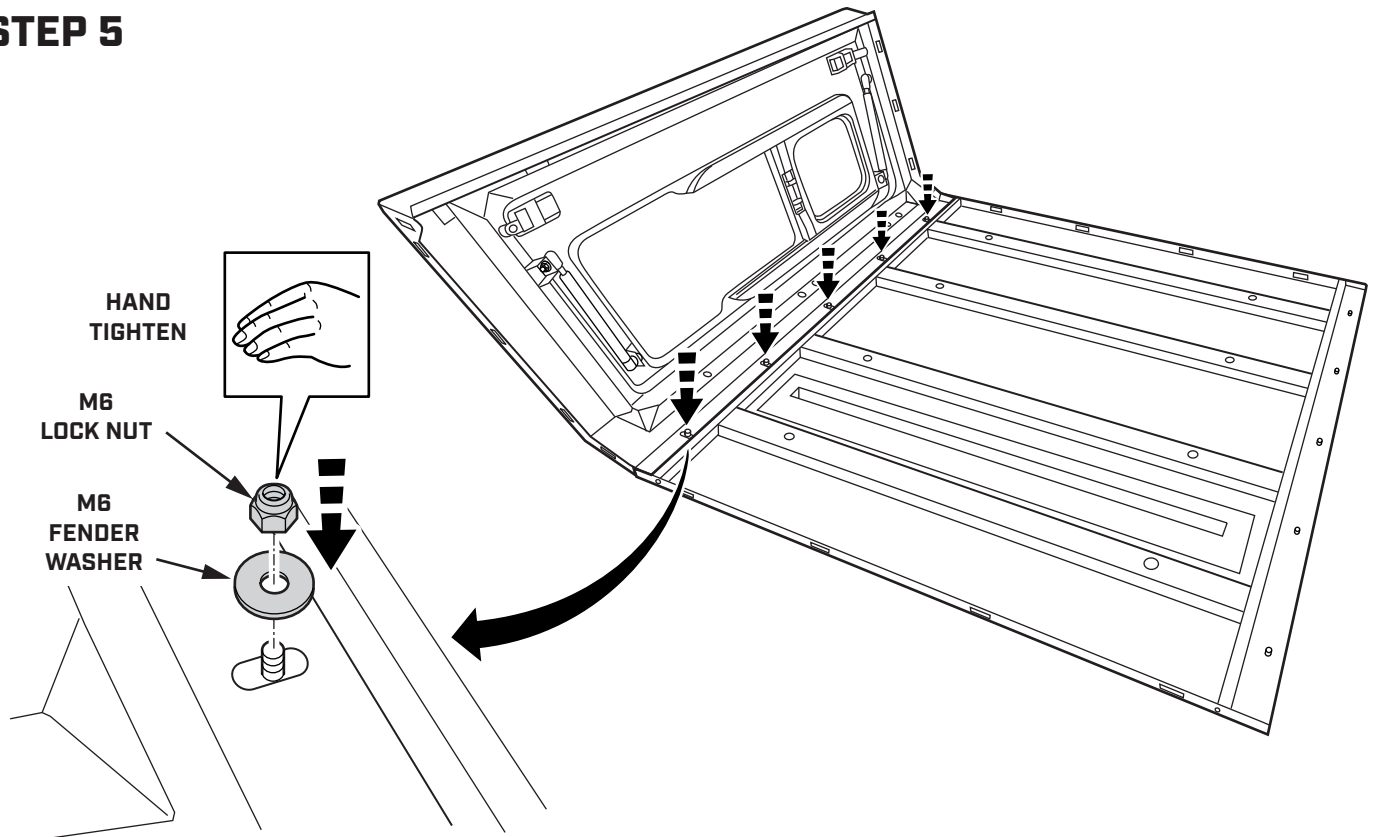

STEP 6

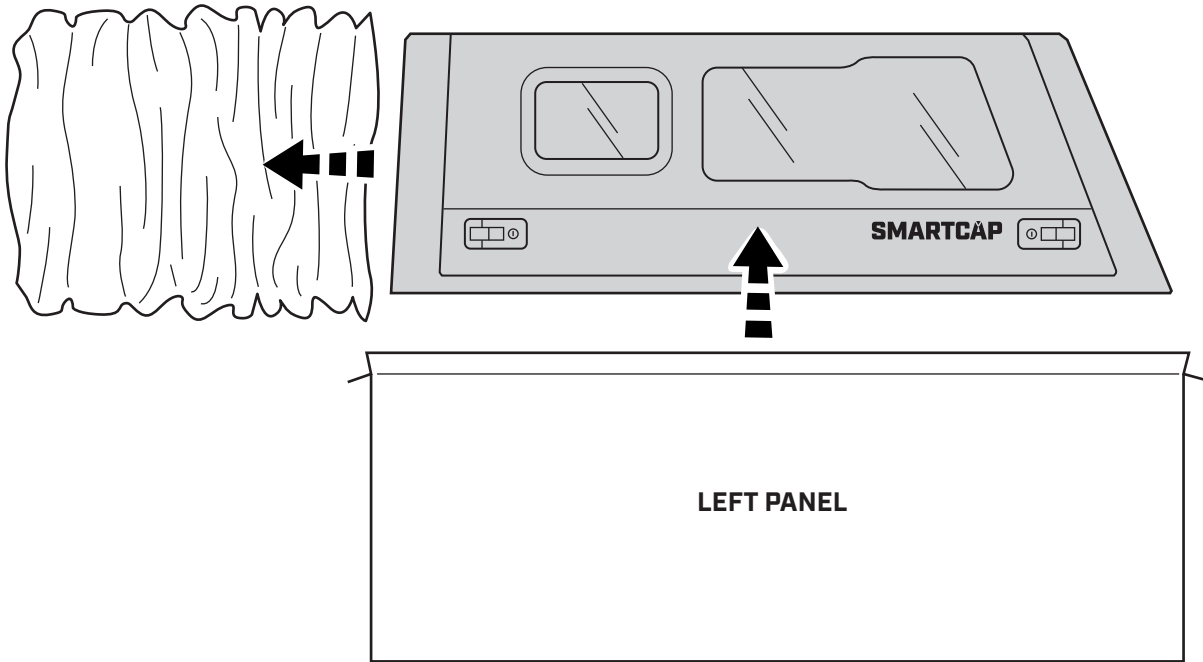
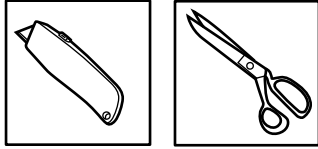

STEP 7

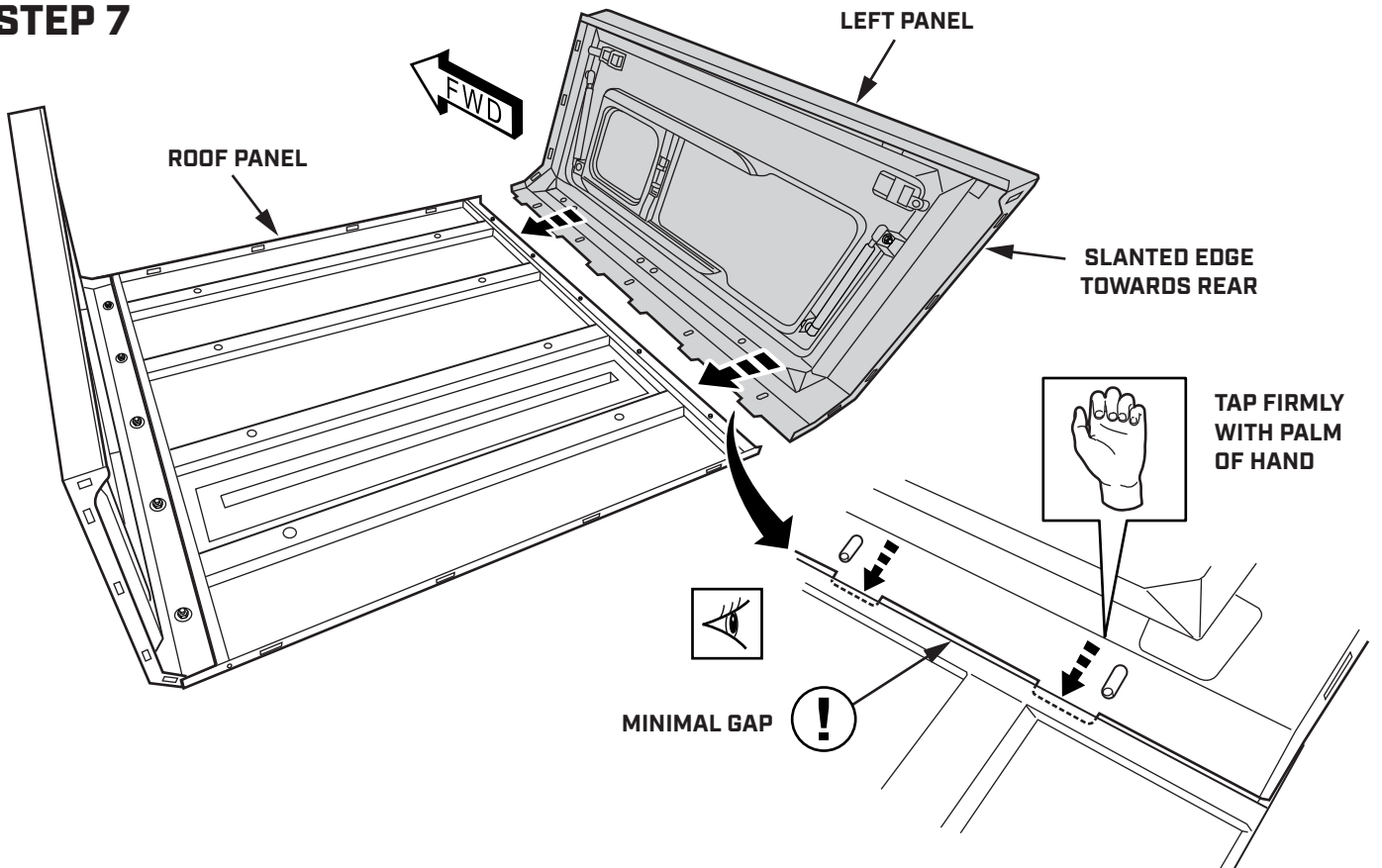

STEP 8

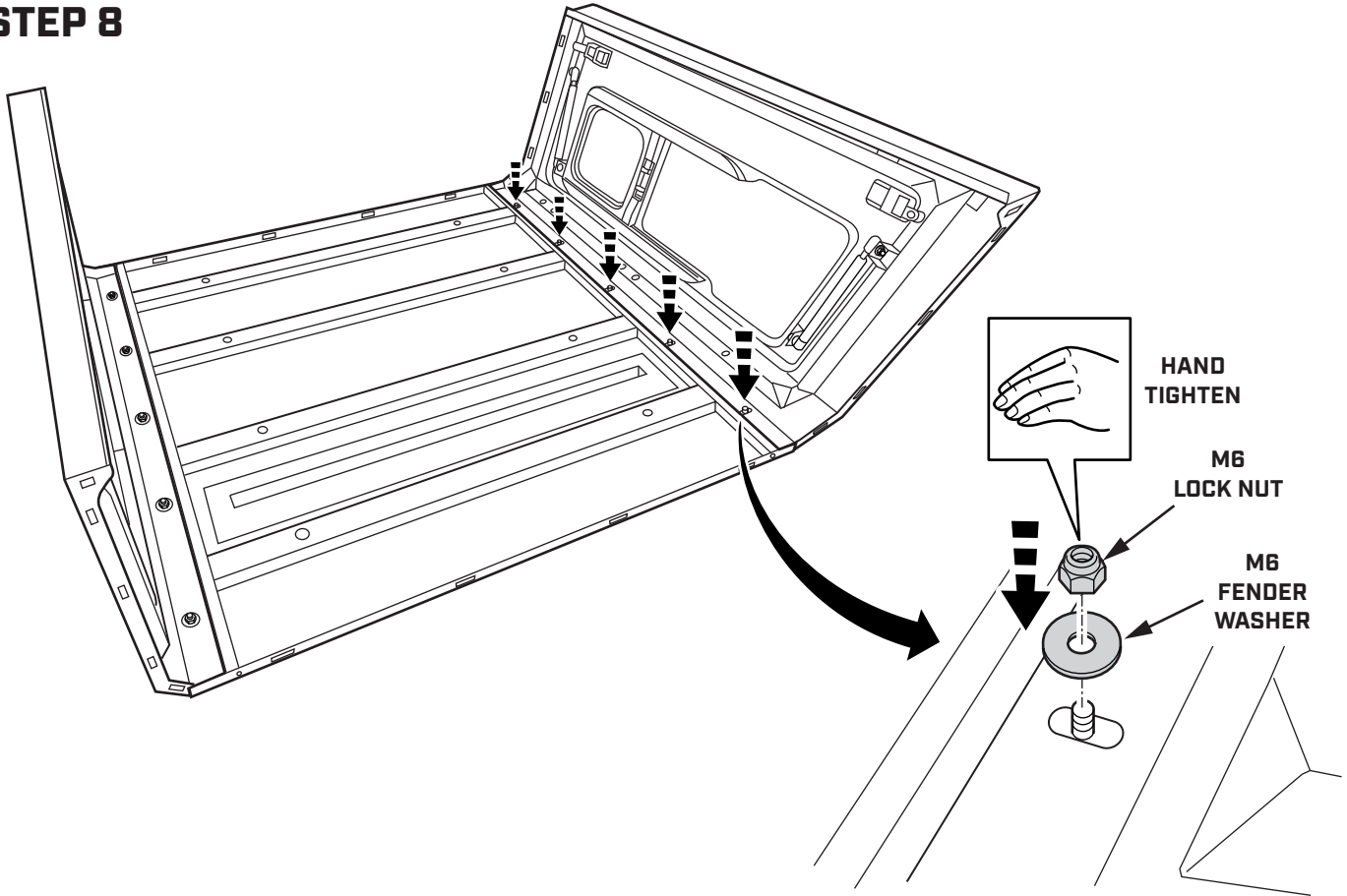

STEP 9

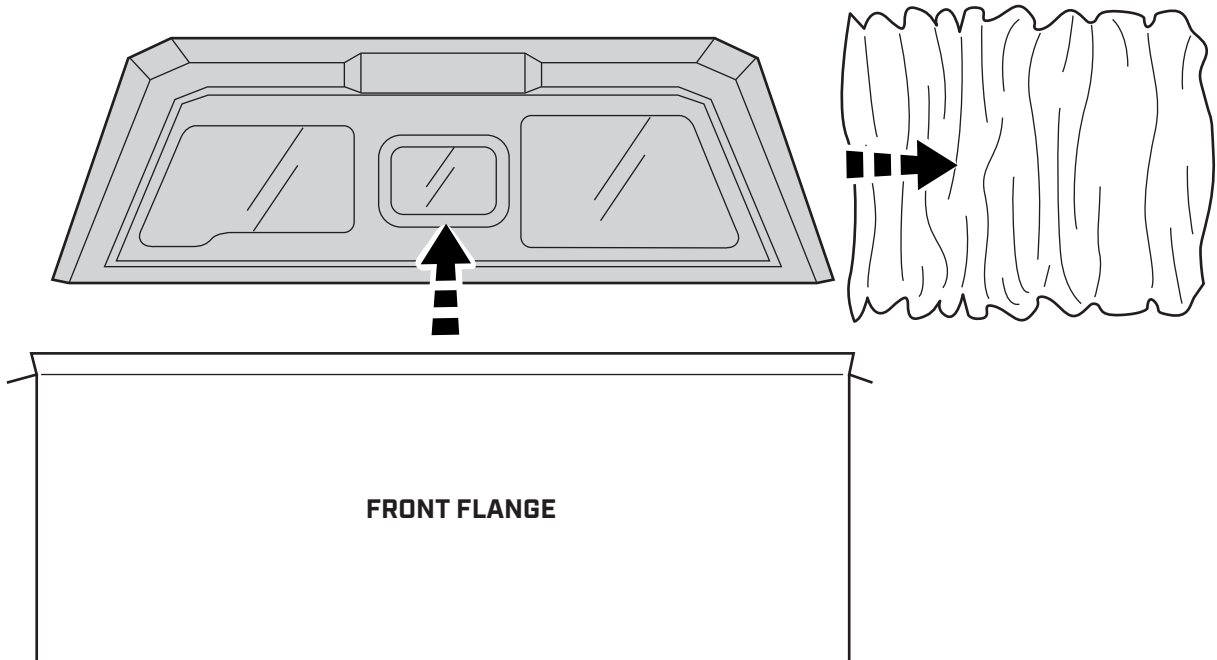
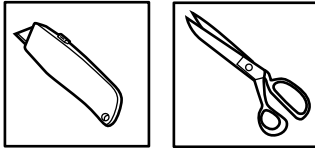

STEP 10

REMOVE ALL HARDWARE FROM FRONT FLANGE

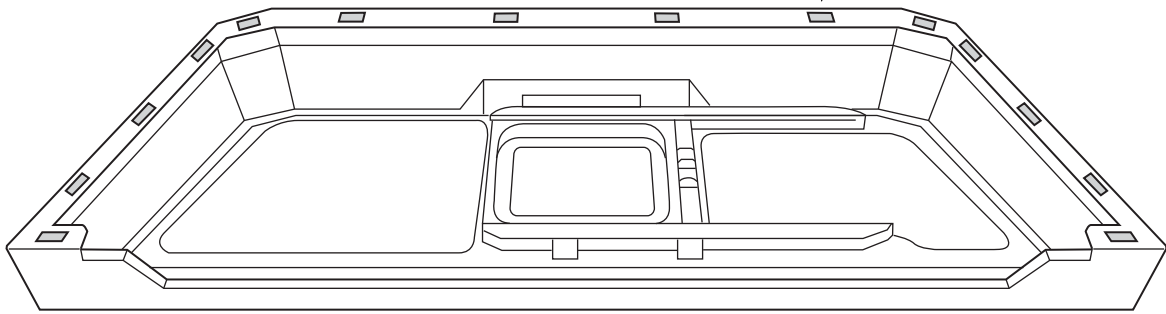
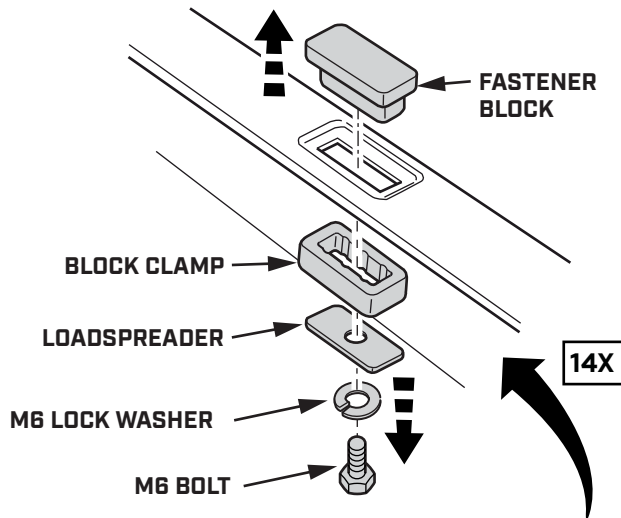
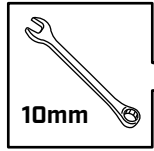

STEP 11

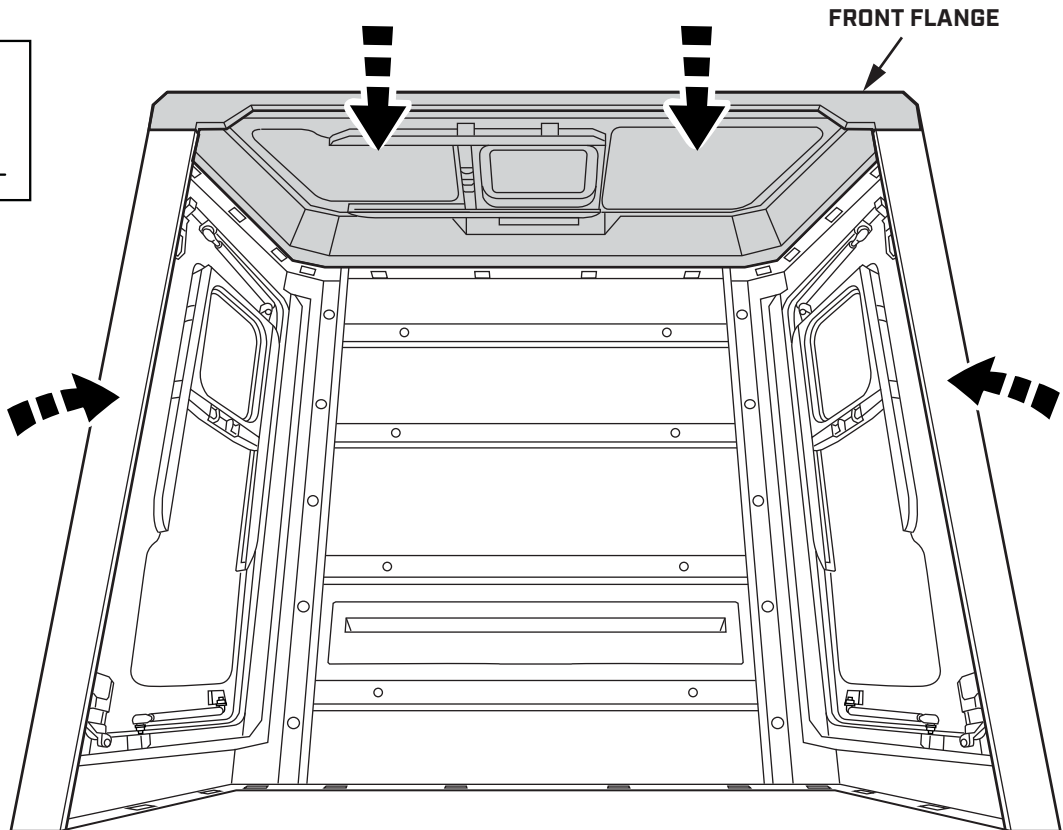
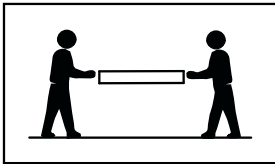

STEP 12

INSTALL HARDWARE
ALONG FRONT FLANGE
WITH BOLT ON INSIDE

HAND TIGHTEN IN THE
SEQUENCE SHOWN

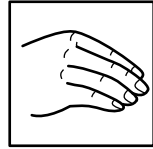

14X

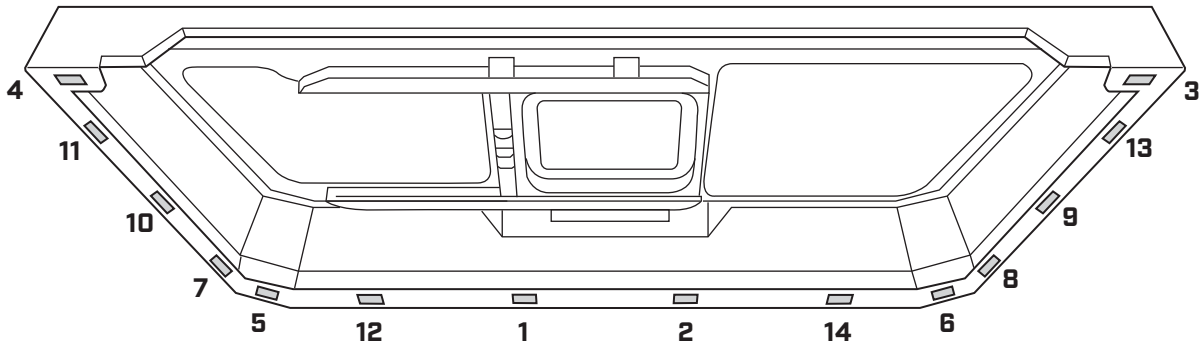
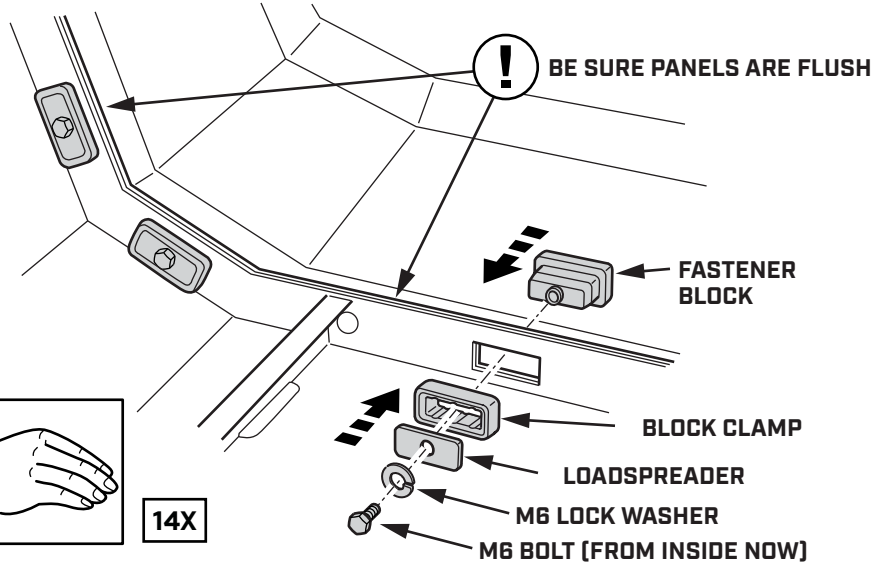

STEP 13

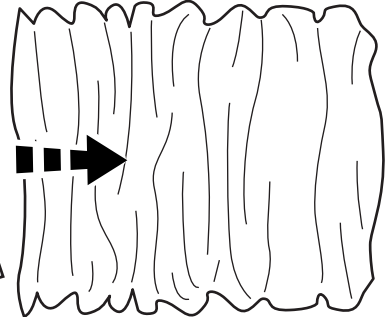
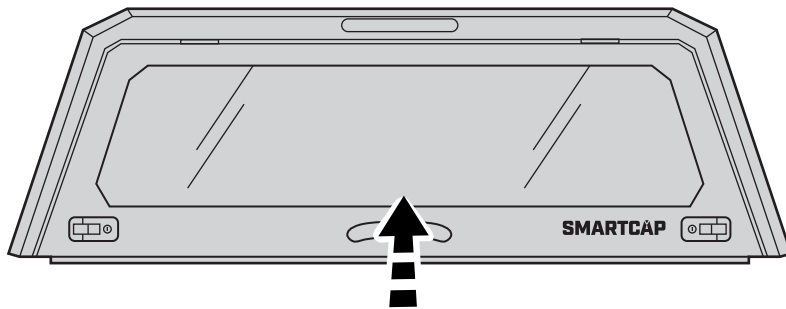
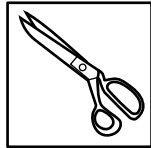
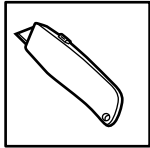

STEP 14

REMOVE ALL HARDWARE FROM REAR FLANGE

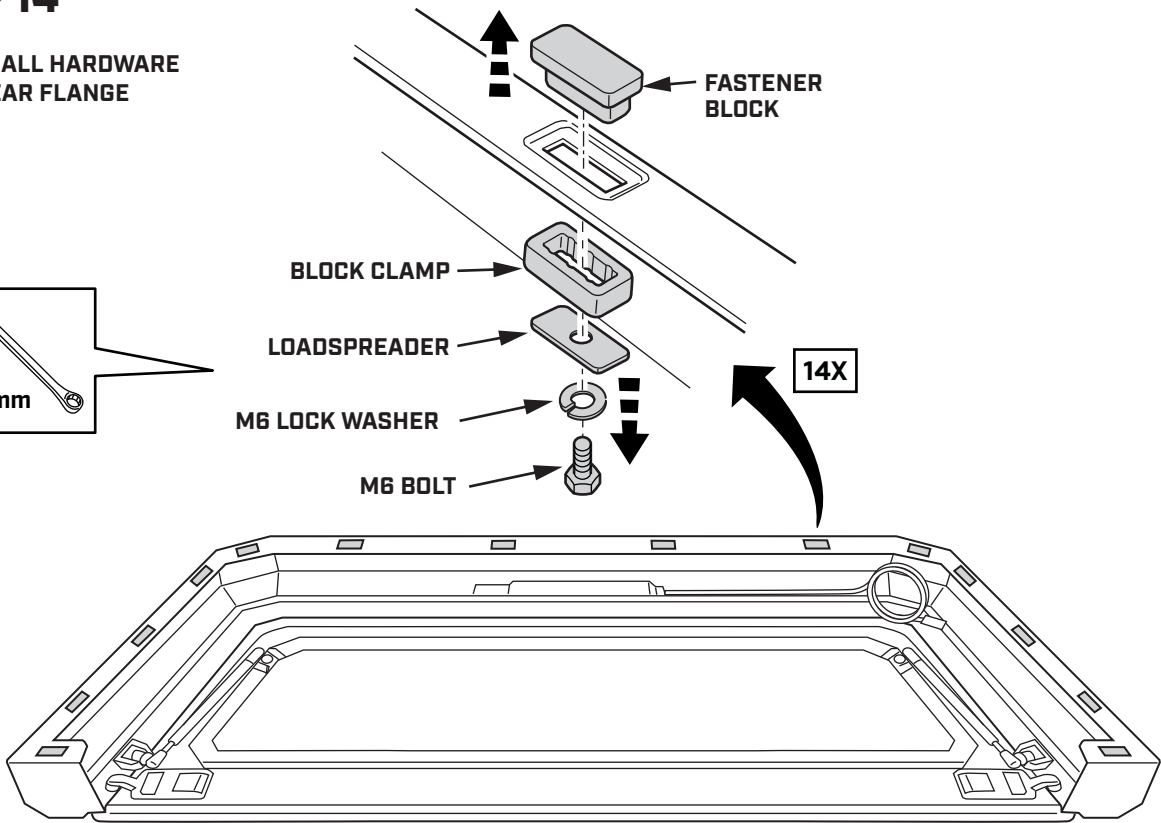
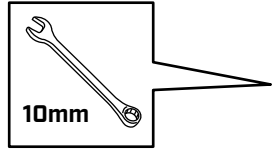

STEP 15

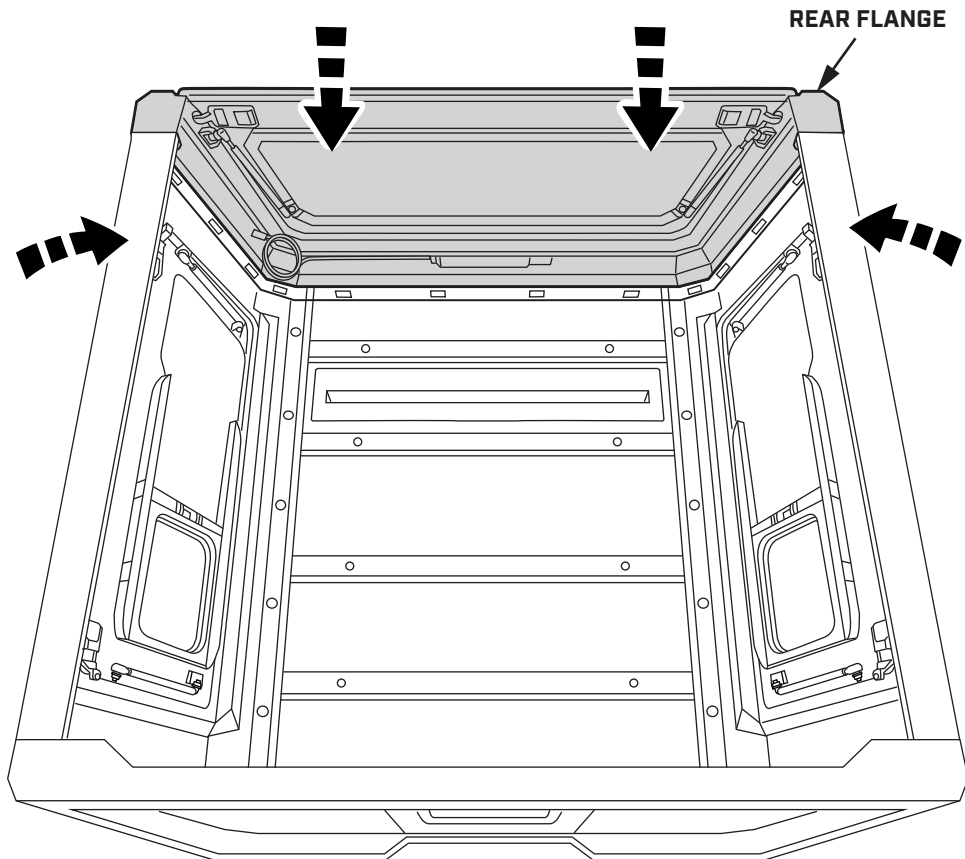
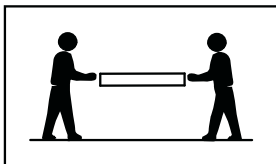

STEP 16

INSTALL HARDWARE
ALONG REAR FLANGE
WITH BOLT ON INSIDE

HAND TIGHTEN IN THE
SEQUENCE SHOWN

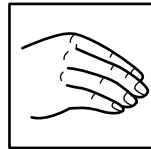

14X



BE SURE PANELS ARE FLUSH

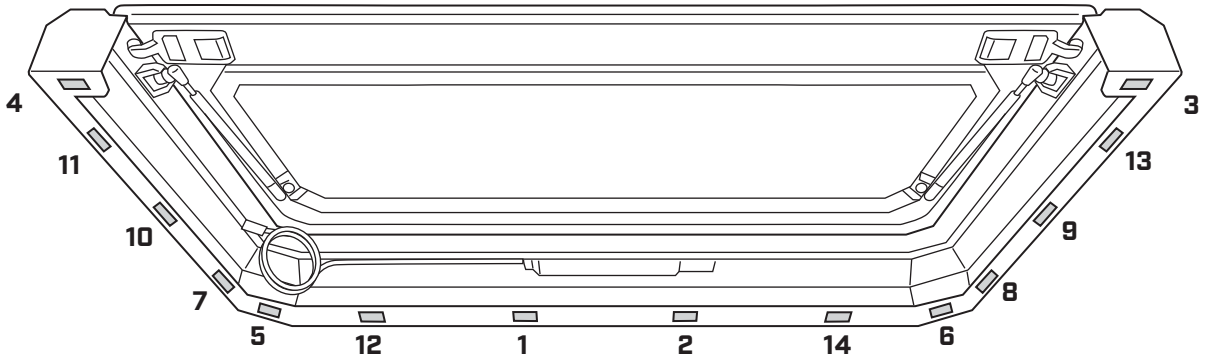
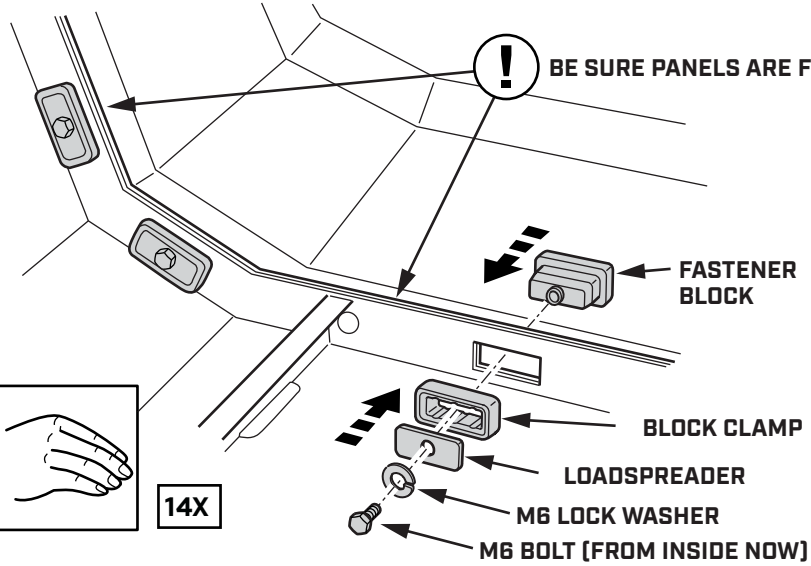

STEP 17

TIGHTEN ALL HARDWARE
WITH TORQUE WRENCH
AND 10mm SOCKET

14X

Min 6 N m
Max 12 N m
[4.4 lbs. ft.]

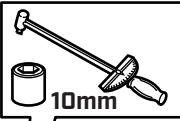

10mm

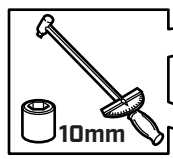

10mm

5X

Min 6 N m
Max 12 N m
[4.4 lbs. ft.]

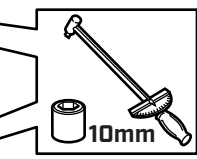

10mm

5X

Min 6 N m
Max 12 N m
[4.4 lbs. ft.]

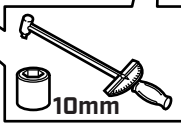
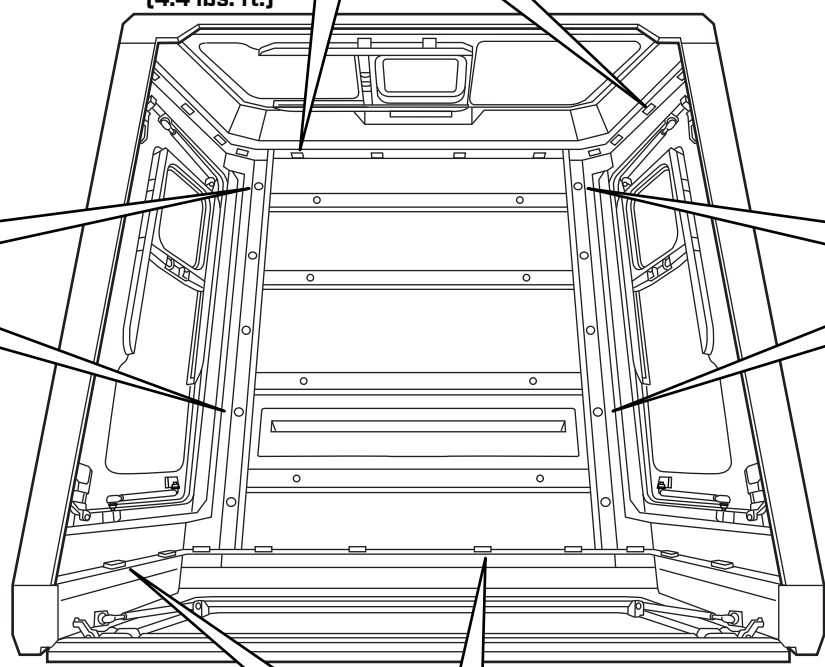

10mm

14X

Min 6 N m
Max 12 N m
[4.4 lbs. ft.]

STEP 18

APPLY D - RUBBER TO BOTTOM OF SMARTCAP TO BOTTOM OF SMARTCAP

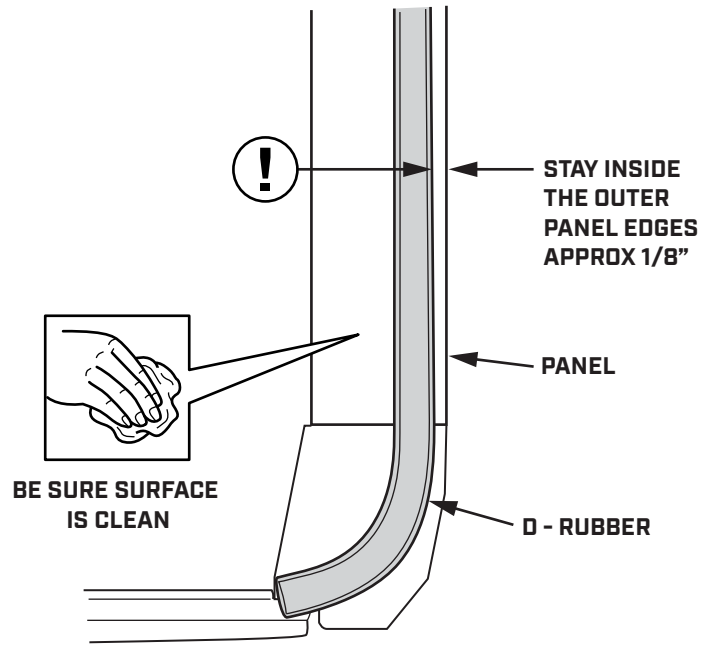
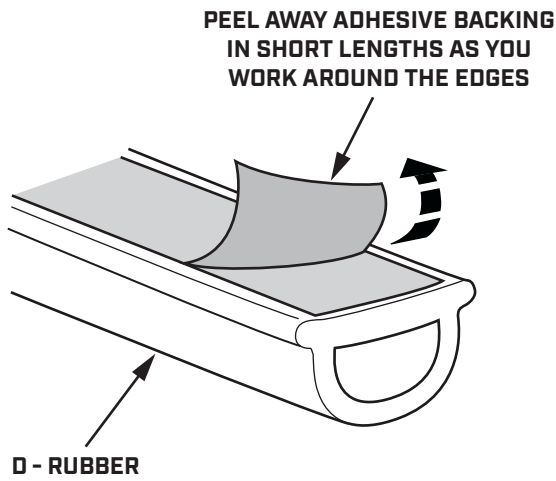

STEP 19

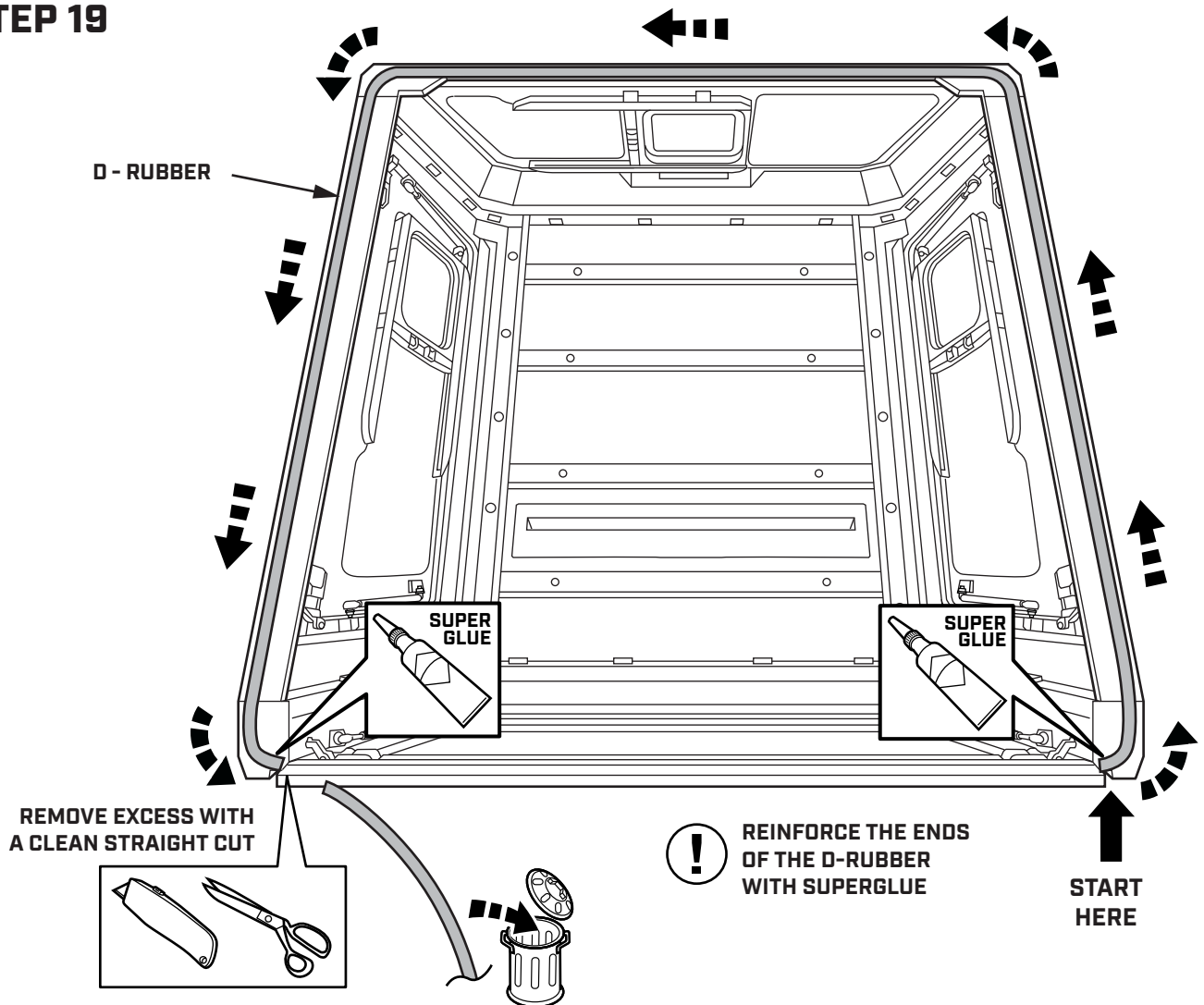

VEHICLE INSTALLATION

ASSEMBLY HARDWARE

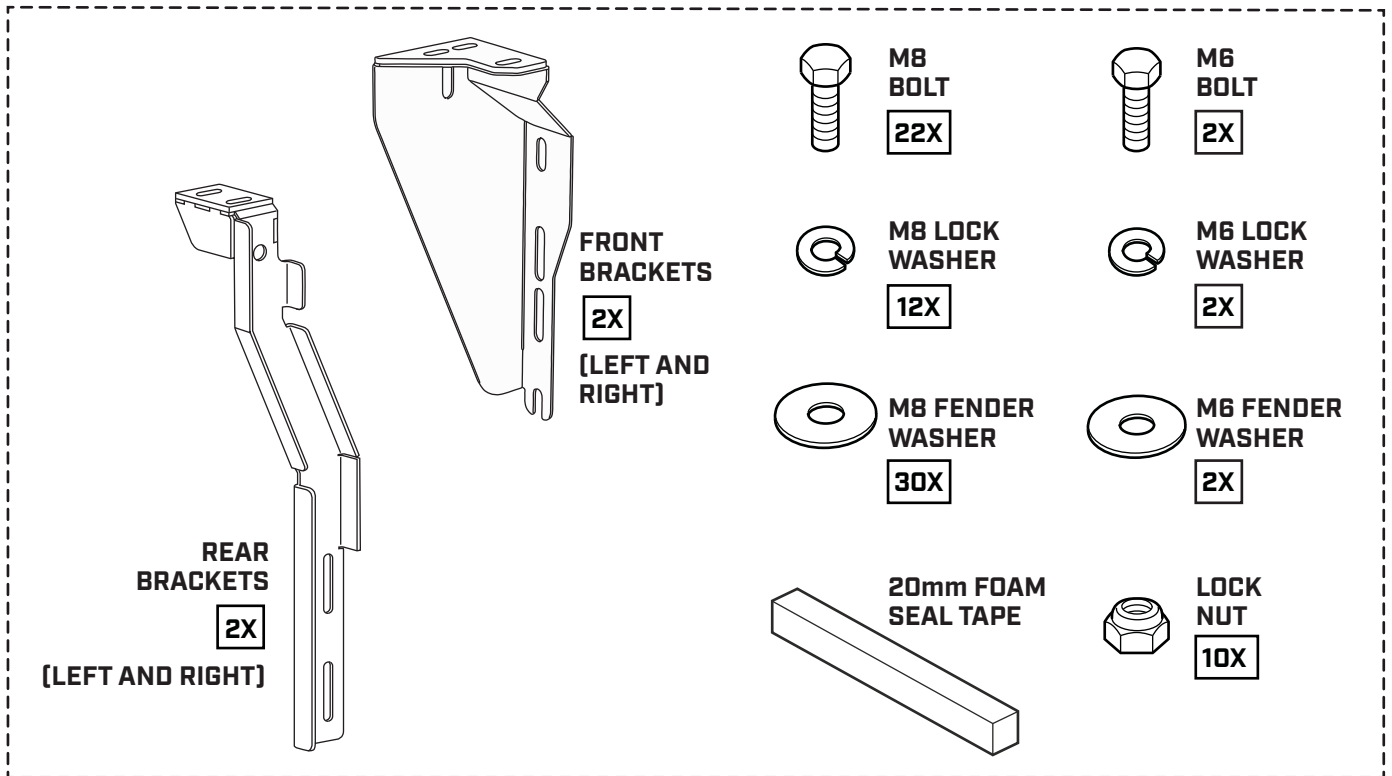

IMPORTANT

- ▼ ASSISTANCE WILL BE NEEDED FOR THIS INSTALLATION. FOUR PEOPLE ARE RECOMMENDED TO LIFT THE SMARTCAP ONTO THE VEHICLE.
- ▼ AVOID PINCHING OR CRUSHING HANDS AND FINGERS.

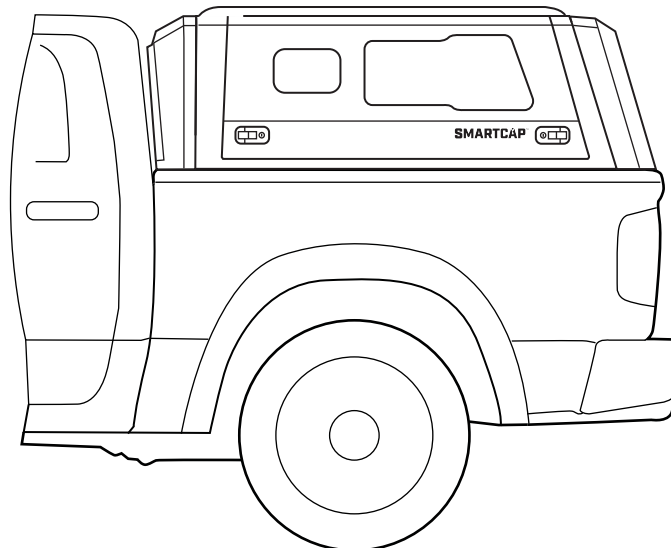

STEP 19

INSPECT THE TRUCK BED. IF FRONT EDGE IS LOWER THAN THE SIDES, ADD FOAM SEAL TAPE TO THE FRONT EDGE OF THE BED.

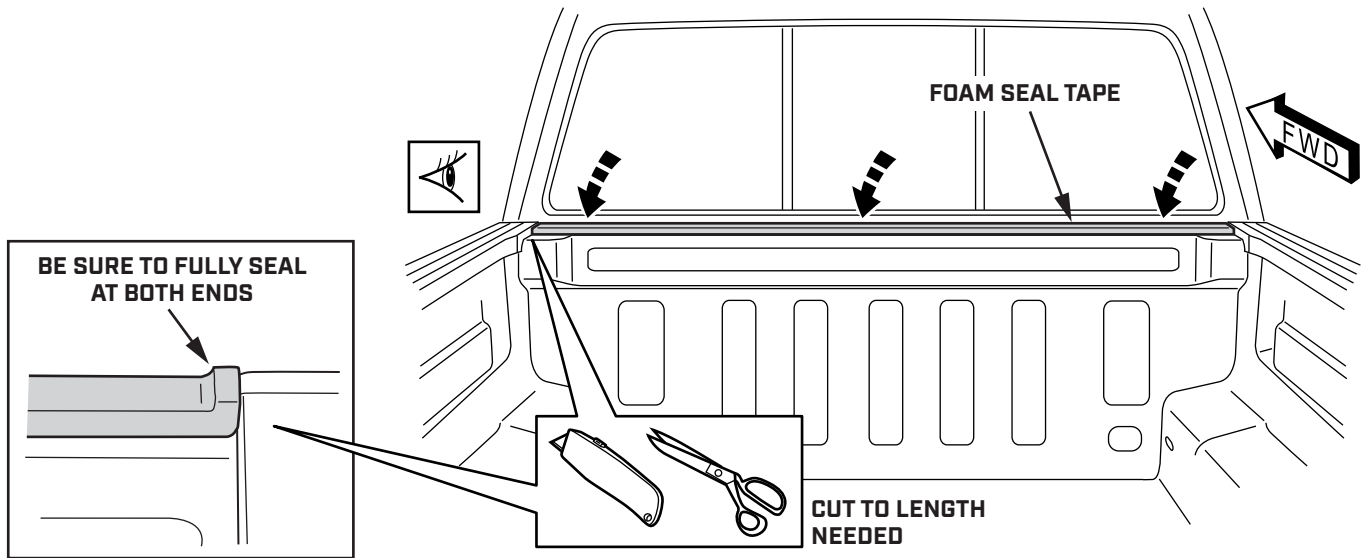
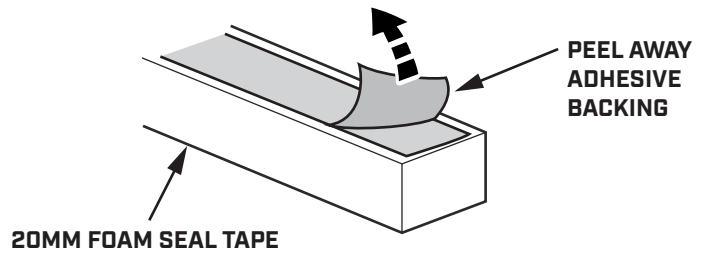

STEP 20

REMOVE THE FRONT TIE DOWN HOOK FROM THE INNER WALL OF THE TRUCK BED.

POSITION THE RIGHT SIDE FRONT MOUNTING BRACKET IN THE FRONT CORNER OF THE TRUCK BED AS SHOWN.

SECURE THE BRACKET WITH THE FASTENERS AS INDICATED, HAND TIGHTEN ONLY.

REPEAT ON THE OPPOSITE SIDE OF THE VEHICLE WITH THE LEFT FRONT MOUNTING BRACKET.

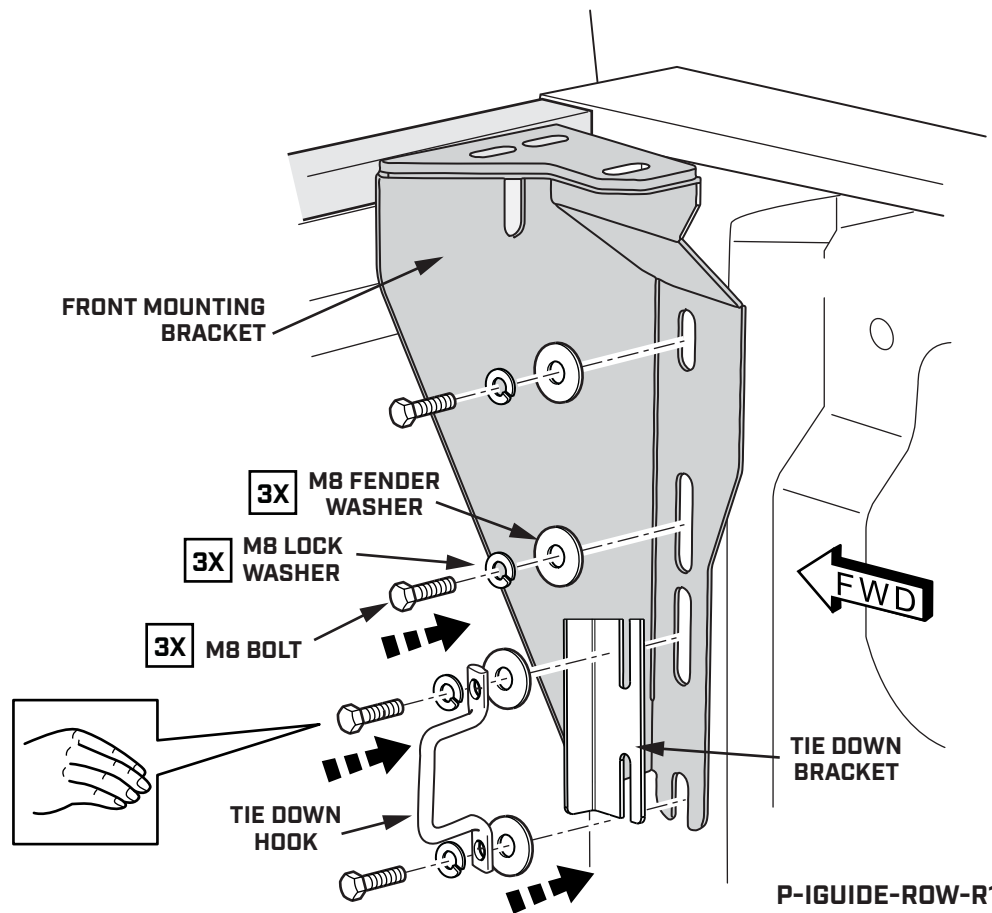

STEP 21

WITH THE REMAINING BOLT LOCATION, SECURE THE BRACKET WITH THE FASTENERS AS INDICATED, HAND TIGHTEN ONLY.

REPEAT ON THE OPPOSITE SIDE OF THE VEHICLE WITH THE LEFT FRONT MOUNTING BRACKET.

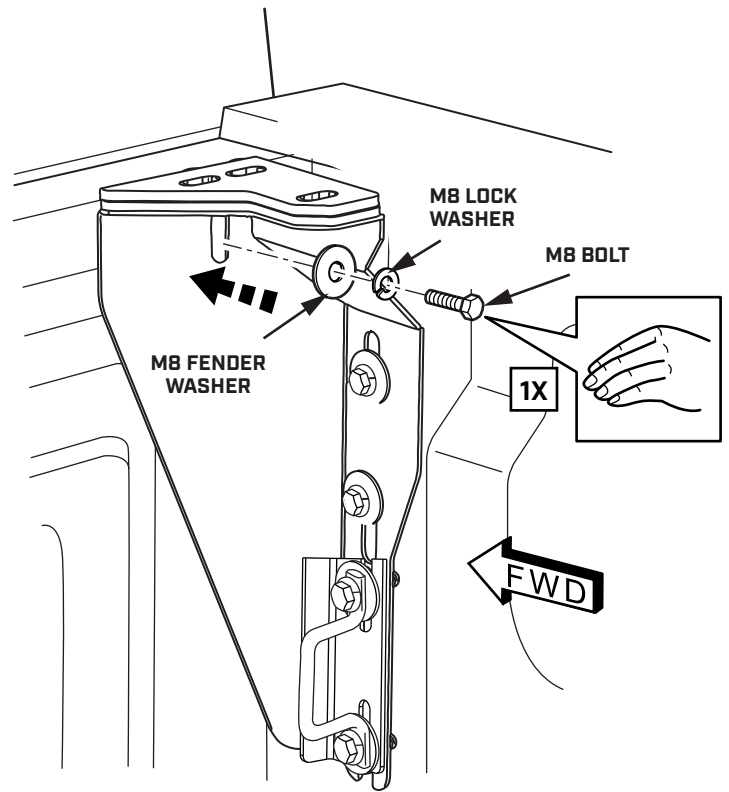

STEP 22

REMOVE THE REAR TIE DOWN HOOK FROM THE INNER WALL OF THE TRUCK BED.

POSITION THE RIGHT SIDE REAR MOUNTING BRACKET IN THE BACK CORNER OF THE TRUCK BED AS SHOWN.

SECURE THE BRACKET WITH THE FASTENERS AS INDICATED, HAND TIGHTEN ONLY.

REPEAT ON THE OPPOSITE SIDE OF THE VEHICLE WITH THE LEFT REAR MOUNTING BRACKET.

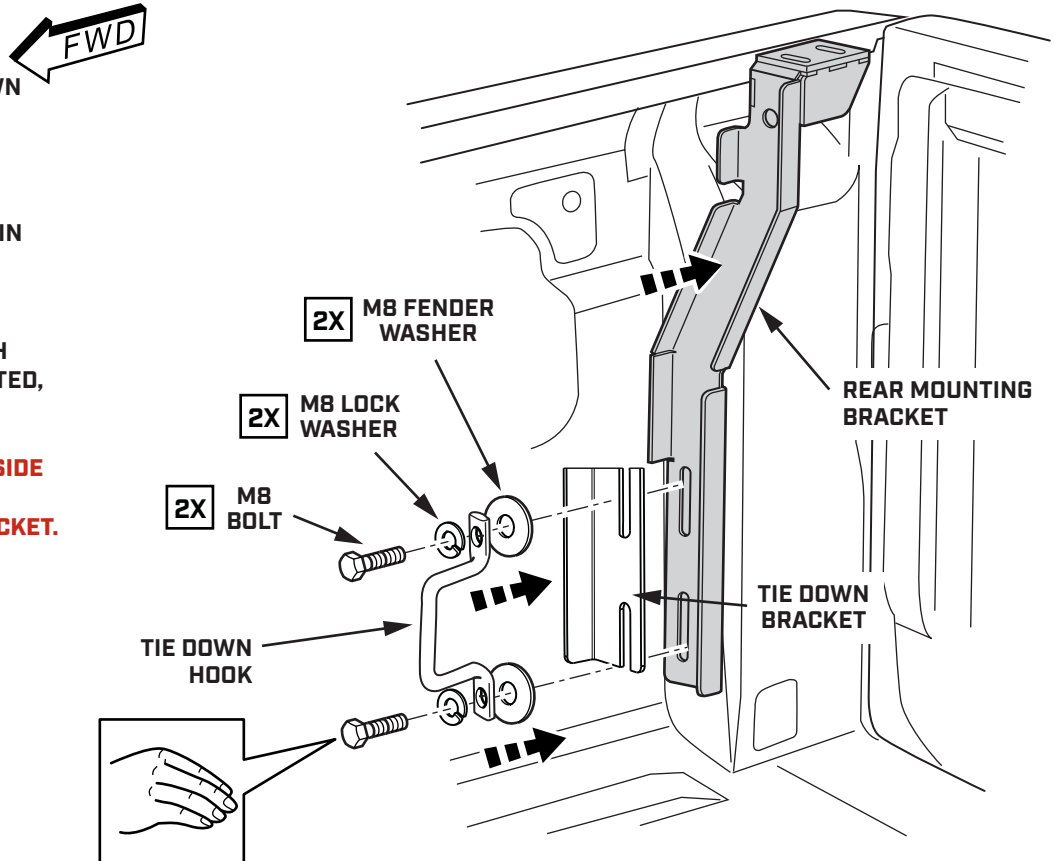

STEP 23

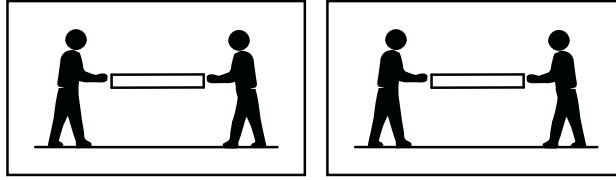

LIFT THE ASSEMBLED SMARTCAP ONTO THE TRUCK BED



**BE SURE NOT TO SCRAPE OR
DAMAGE THE D-RUBBER**

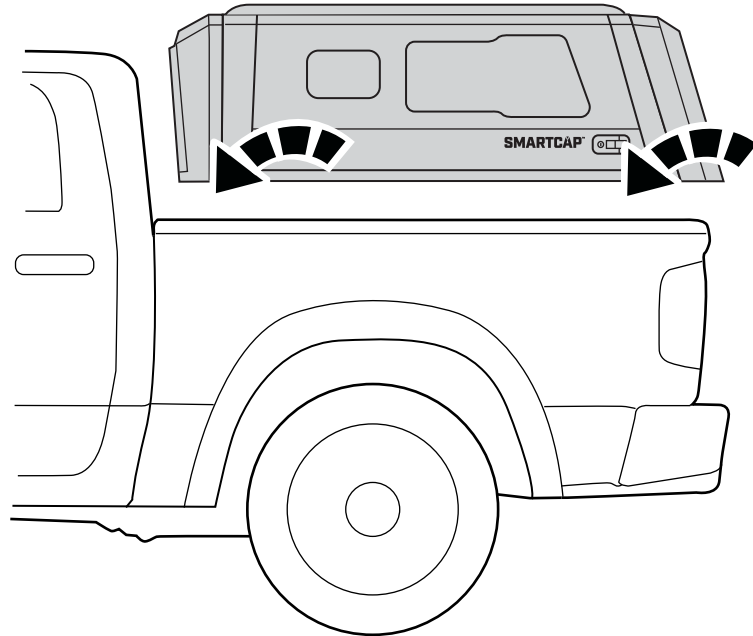

**CHECK THAT THE SMARTCAP IS
PROPERLY POSITIONED AND
CENTERED ON THE TRUCK BED**

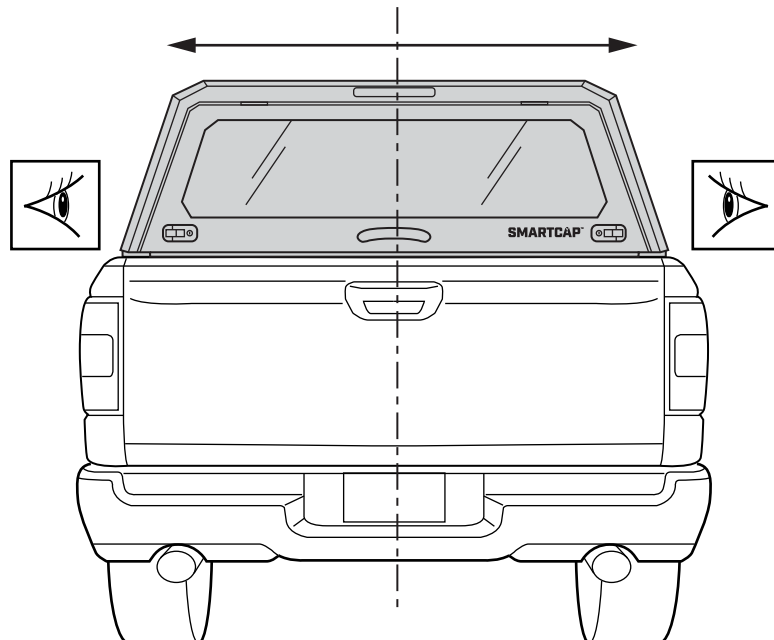

STEP 24

SECURE THE SMARTCAP TO THE RIGHT FRONT MOUNTING BRACKET WITH THE FASTENERS AS INDICATED, HAND TIGHTEN ONLY.

REPEAT ON THE OPPOSITE SIDE OF THE VEHICLE WITH THE LEFT FRONT MOUNTING BRACKET.

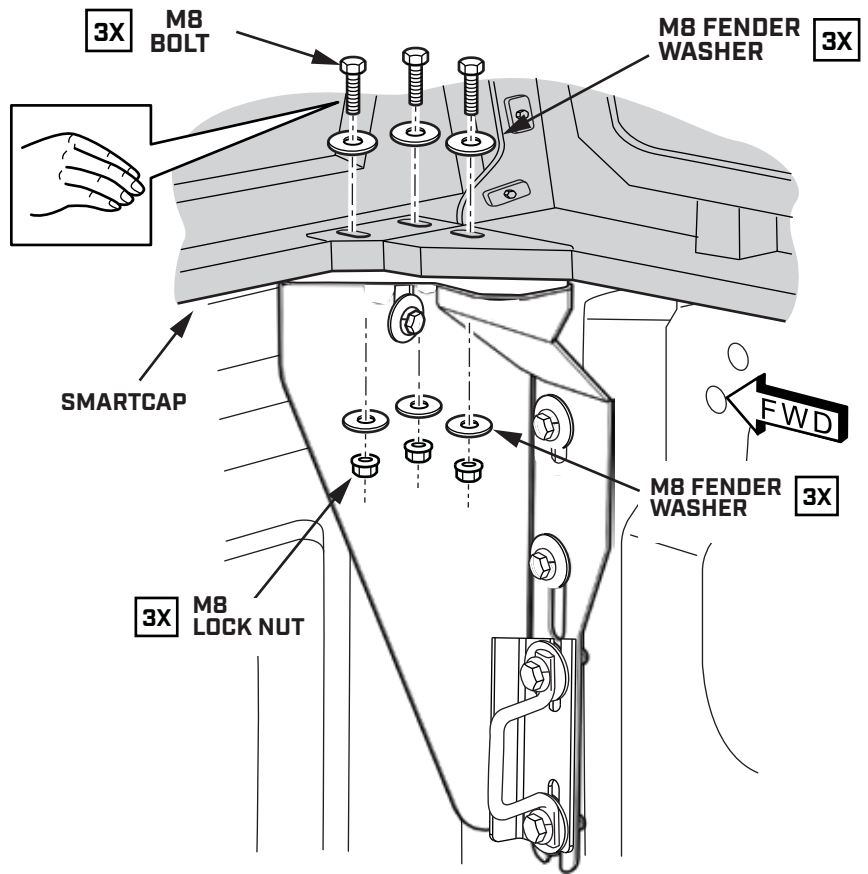

STEP 25

SECURE THE SMARTCAP TO THE RIGHT REAR MOUNTING BRACKET WITH THE FASTENERS AS INDICATED, HAND TIGHTEN ONLY.

REPEAT ON THE OPPOSITE SIDE OF THE VEHICLE WITH THE LEFT REAR MOUNTING BRACKET.

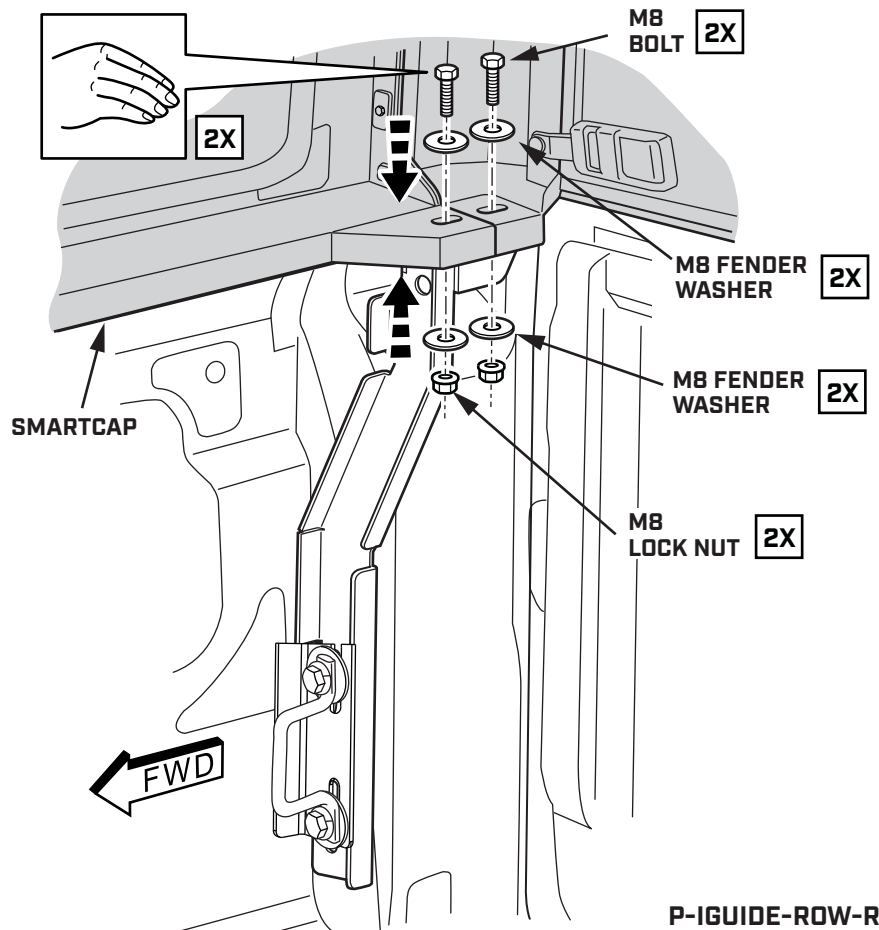

STEP 26

ONCE ALL THE FASTENERS ARE INSTALLED, PARTIALLY TIGHTEN WITH SOCKET WRENCH AS INDICATED.

PARTIALLY TIGHTEN FASTENERS ON ALL FOUR CORNERS OF THE VEHICLE.

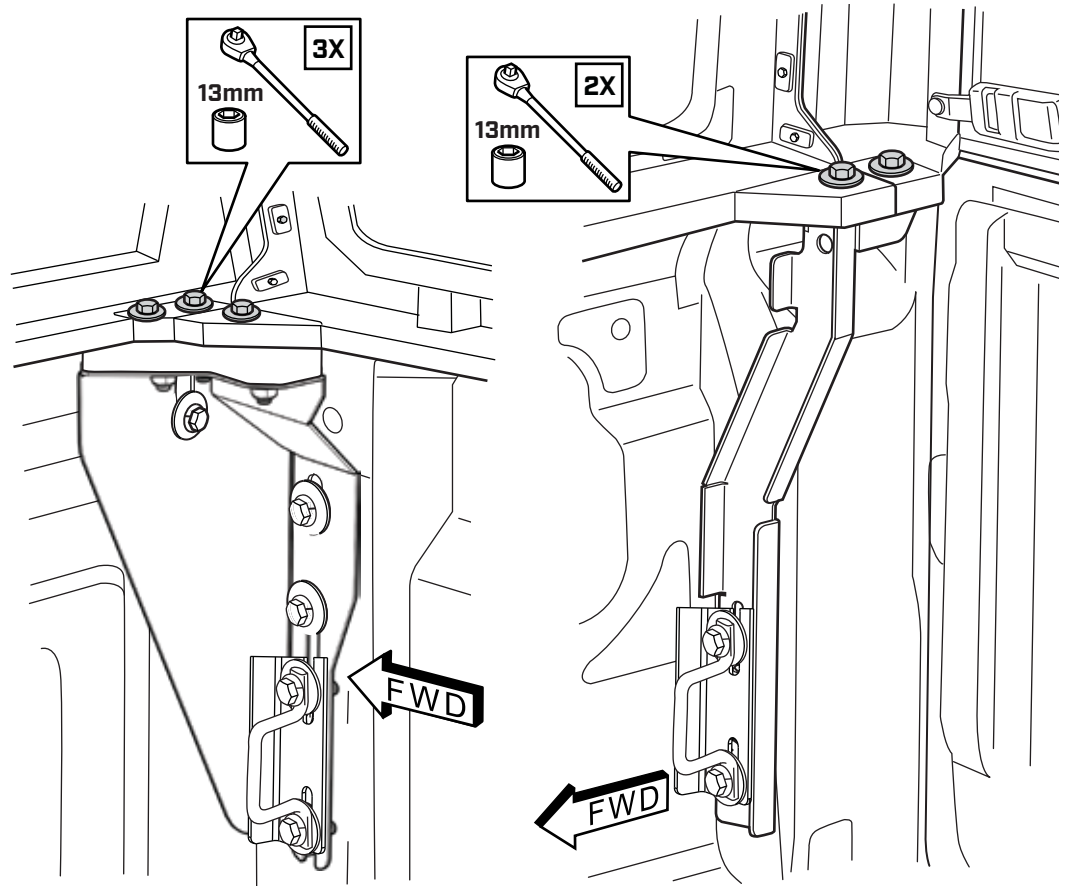

STEP 27

PRESS DOWN ON THE SMARTCAP TO ACHIEVE 2MM - 3MM COMPRESSION ON THE D-RUBBER AND CONTINUE TIGHTENING BRACKET FASTENERS WITH SOCKET WRENCH AS INDICATED.

CONTINUE TIGHTENING FASTENERS ON ALL FOUR CORNERS OF THE VEHICLE.

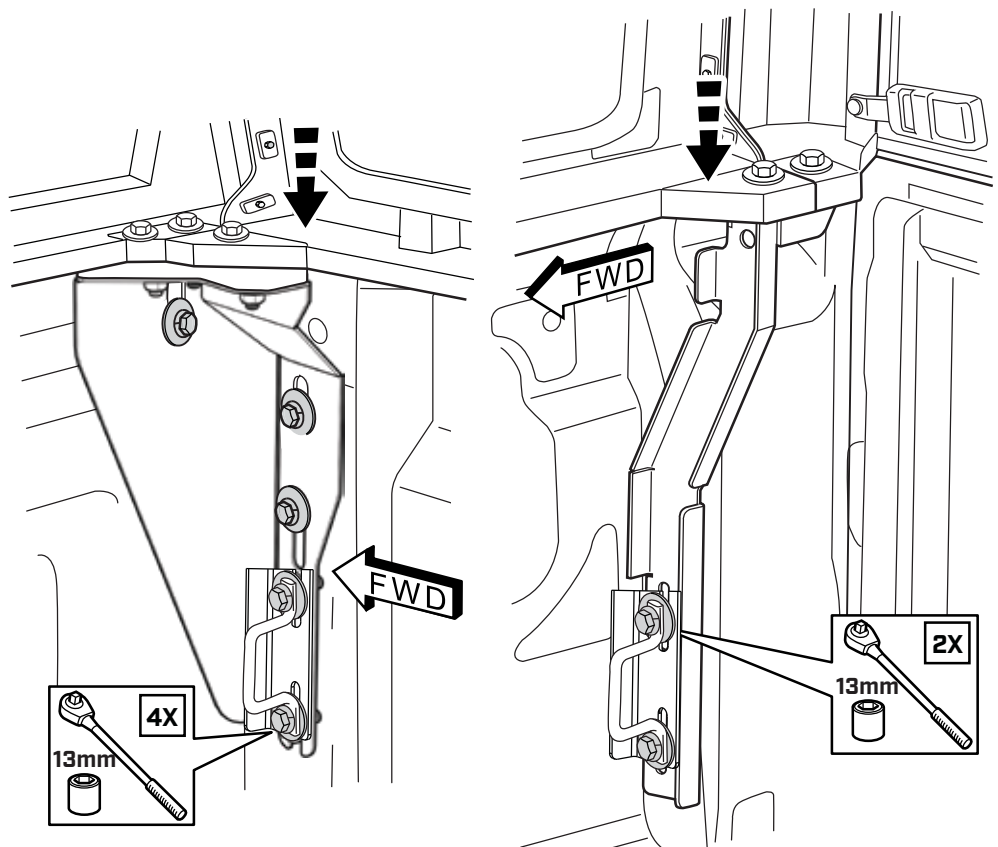
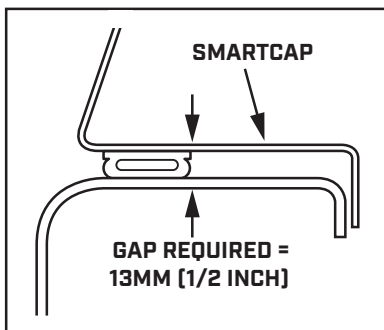

STEP 28

ONCE SMARTCAP IS POSITIONED CORRECTLY, FULLY TIGHTEN UPPER FASTENERS WITH TORQUE WRENCH AS INDICATED.

FULLY TIGHTEN UPPER FASTENERS ON ALL FOUR CORNERS OF THE VEHICLE.

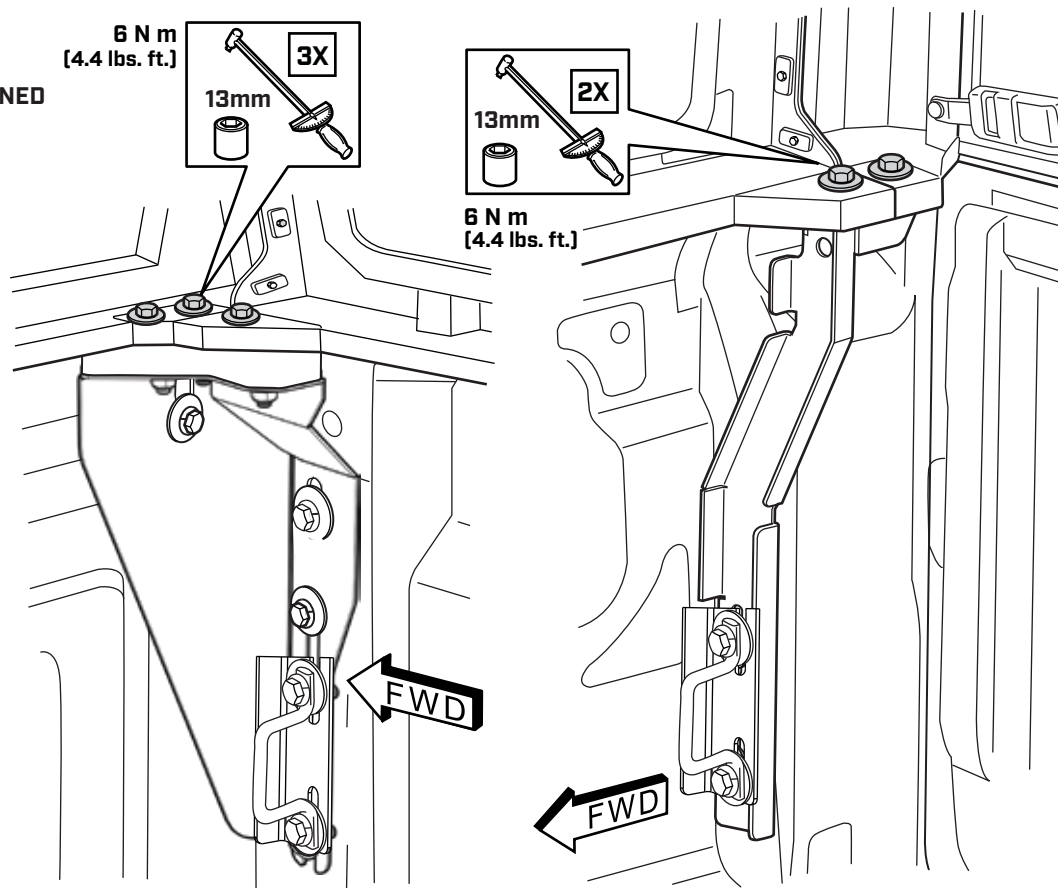

STEP 29

ONCE SMARTCAP IS POSITIONED CORRECTLY, FULLY TIGHTEN LOWER FASTENERS WITH TORQUE WRENCH AS INDICATED.

FULLY TIGHTEN LOWER FASTENERS ON ALL FOUR CORNERS OF THE VEHICLE.

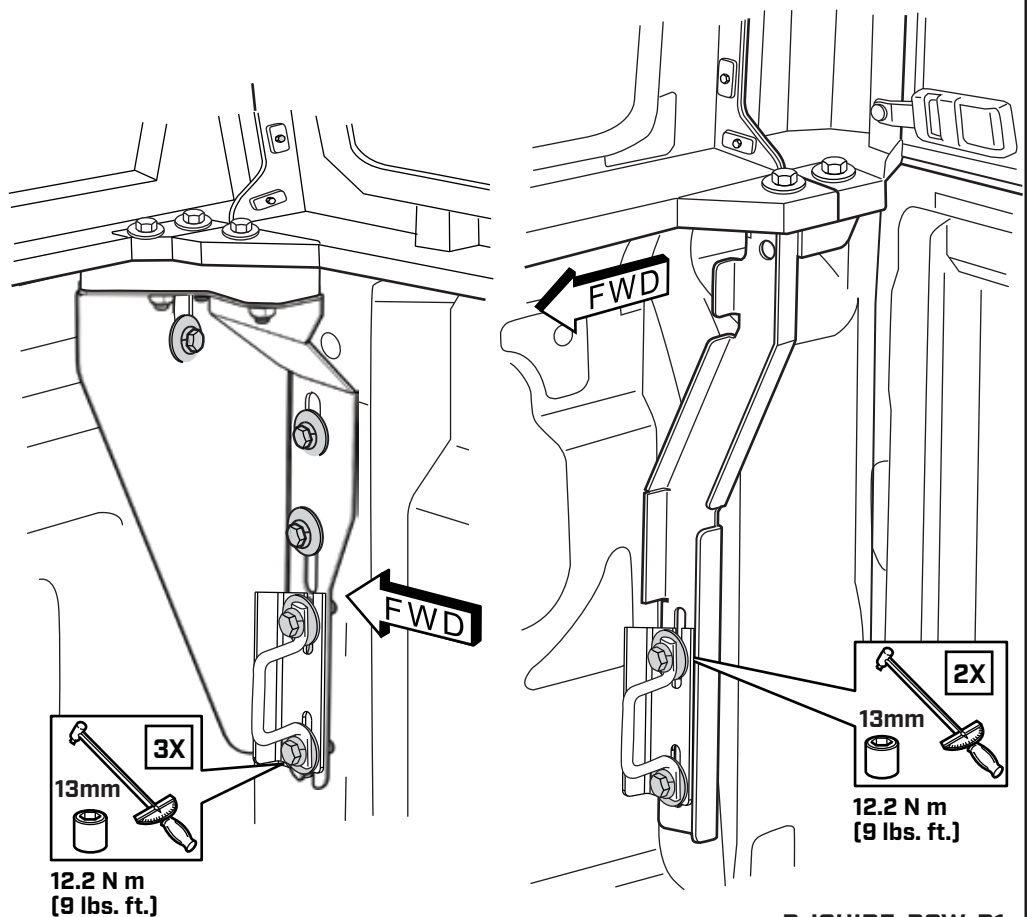

THIRD BRAKE LIGHT CONNECTOR INSTALLATION

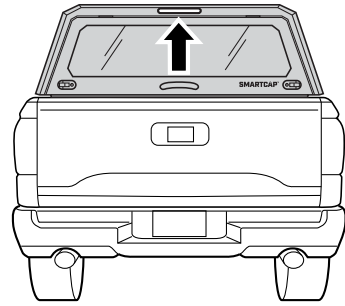
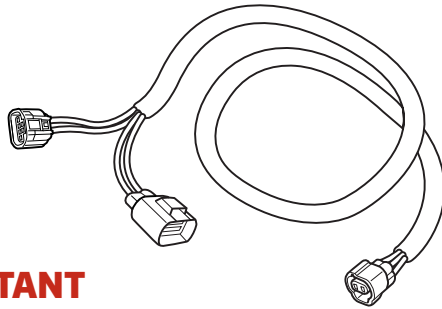

IMPORTANT

- ▼ BE SURE THE VEHICLE IS TURNED OFF FOR THIS INSTALLATION.
- ▼ READ THROUGH THE ENTIRE PROCEDURE BEFORE STARTING AND FOLLOW THE STEPS CAREFULLY TO ENSURE THE THIRD BRAKE LIGHT AND TRAILER PLUG WILL FUNCTION PROPERLY.
- ▼ USE A TEST LIGHT TO CHECK FOR SUCCESSFUL INSTALLATION.

STEP 1

REMOVE THE LEFT SIDE TAIL LIGHT ASSEMBLY.

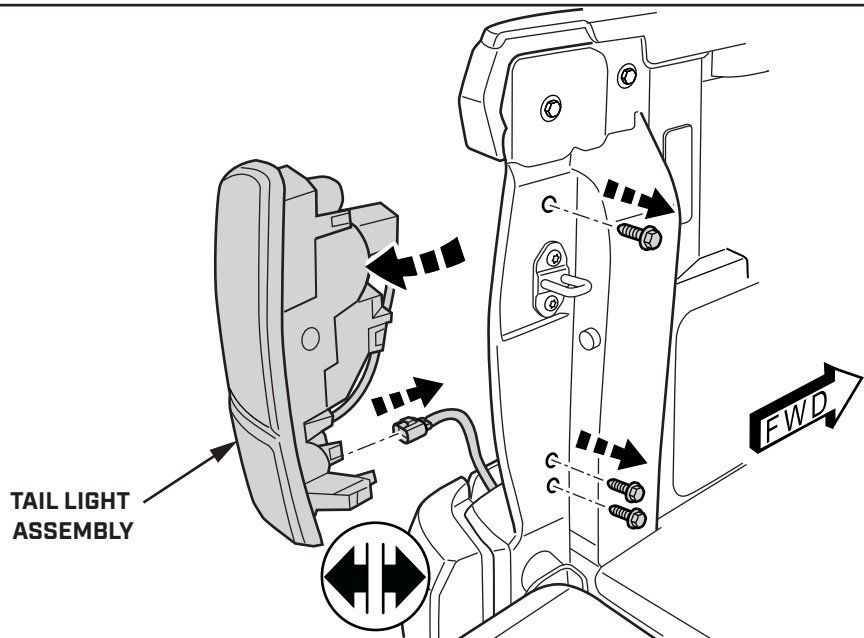

STEP 2

LOCATE THE THIRD BRAKE LIGHT 2-PIN PLUG INSIDE THE BACK LEFT CORNER OF THE SMARTCAP.

CONNECT THE NEW T-HARNESS TO THE 2-PIN PLUG.

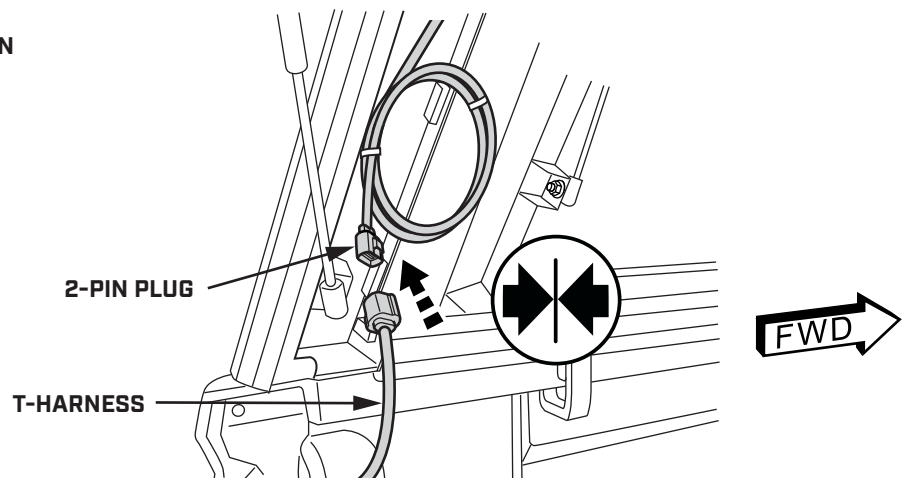

STEP 3

REMOVE THE GROMMET COVER AT THE TRUCK BED WALL.

ROUTE THE T-HARNESS IN THROUGH THE GROMMET PANEL OPENING AND OUT THROUGH THE TAIL LAMP OPENING.

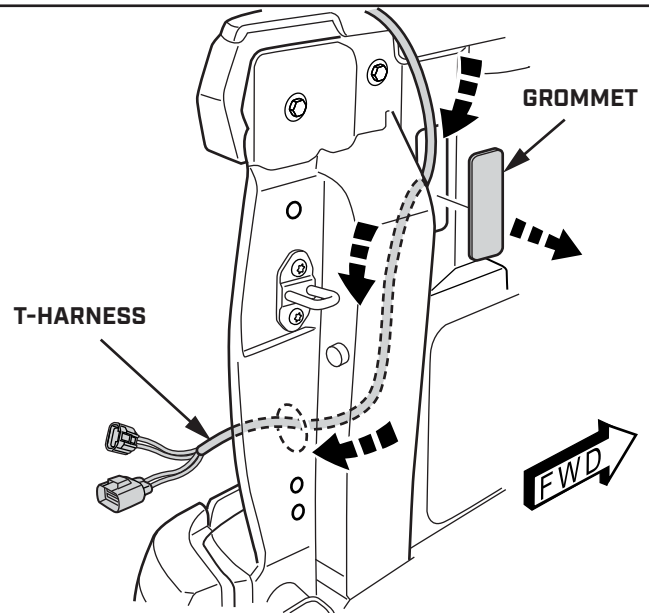

STEP 4

CONNECT THE BRAKE LIGHT PLUG INTO THE FEMALE PLUG FROM THE T-HARNESS.

CONNECT THE MALE PLUG FROM THE T-HARNESS INTO THE TAIL LIGHT BRAKE LIGHT SOCKET.

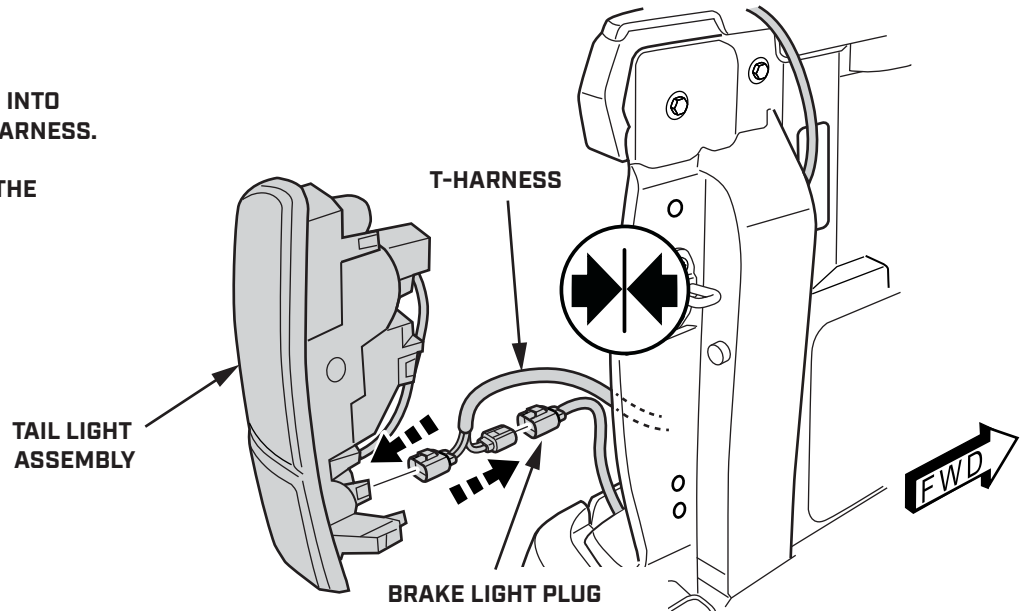

STEP 5

TEST THE BRAKE LIGHTS AND TURN SIGNALS TO BE SURE THEY ARE FUNCTIONING PROPERLY.

REINSTALL THE TAIL LIGHT ASSEMBLY.

REINSTALL THE TRUCK BED GROMMET.

BUNDLE EXTRA T-HARNESS CABLE LENGTH IN THE TAIL LIGHT CAVITY AND SECURE WITH A CABLE TIE.

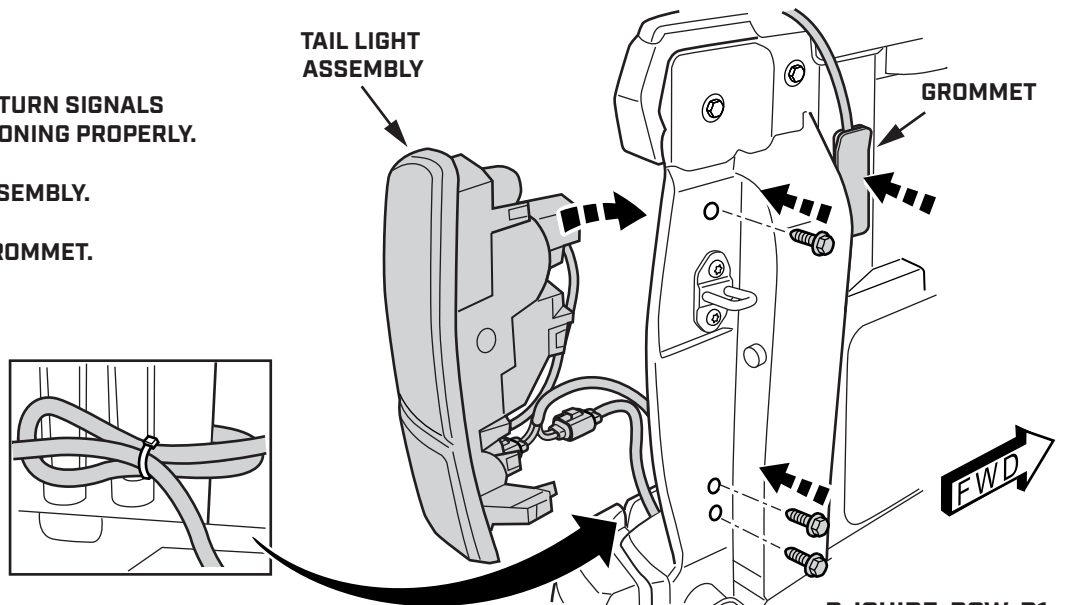

STEP 6

START THE TRUCK. NOTE THAT ON SOME MODELS, IT MAY TAKE UP TO 30 SECONDS FOR THE VEHICLE TO DETECT THE NEW CONNECTION. CHECK THE BRAKE LIGHTS AND TURN SIGNALS TO BE SURE THEY ARE FUNCTIONING PROPERLY.

ONCE YOU HAVE CONFIRMED THAT THE LIGHTS ARE WORKING CORRECTLY, SECURE THE HARNESS WITH CABLE TIES. **BE SURE NOT TO INTERFERE WITH ANY MOVING PARTS ON THE VEHICLE.**

SMARTCAP[®]

THANKS FOR YOUR PURCHASE.
PLEASE LET US KNOW IF YOU HAVE ANY QUESTIONS.

SMARTCAP.COM
SUPPORT.SA@SMARTCAP.COM - REST OF WORLD
SUPPORT.NA@SMARTCAP.COM - NORTH AMERICA/CANADA

