

SMARTCAP®

INSTRUCTION GUIDE

VW AMAROK EDITION

2023

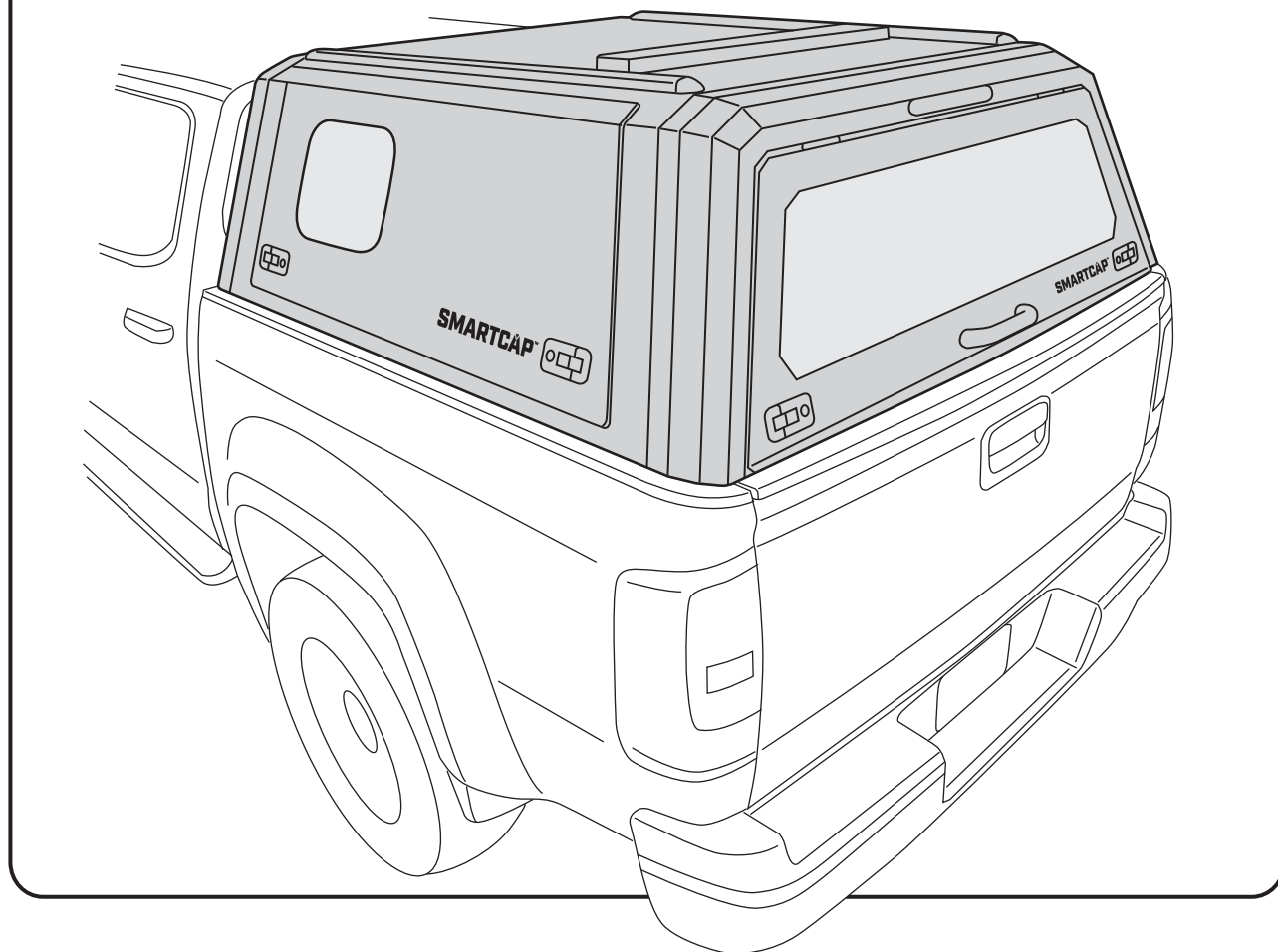

- ▼ **PREPARE A CLEAN WORK AREA.**
- ▼ **WE RECOMMEND A MINIMUM OF 2 PEOPLE FOR ASSEMBLY AND 4 PEOPLE FOR INSTALLATION**
- ▼ **ENSURE THE REQUIRED TOOLS ARE PRESENT AND ALL HARDWARE CONTENTS ARE ACCOUNTED FOR.**
- ▼ **NEVER USE ACETONE OR THINNERS ON PAINTED PARTS.**
- ▼ **READ THROUGH THE ENTIRE INSTRUCTION GUIDE BEFORE STARTING THIS PROCEDURE AND FOLLOW THE STEPS CAREFULLY TO AVOID ANY DAMAGE TO THE COMPONENTS OR THE VEHICLE.**

SMARTCAP.COM

SUPPORT.SA@SMARTCAP.COM - REST OF WORLD

SUPPORT.NA@SMARTCAP.COM - NORTH AMERICA/CANADA



TOOLS REQUIRED

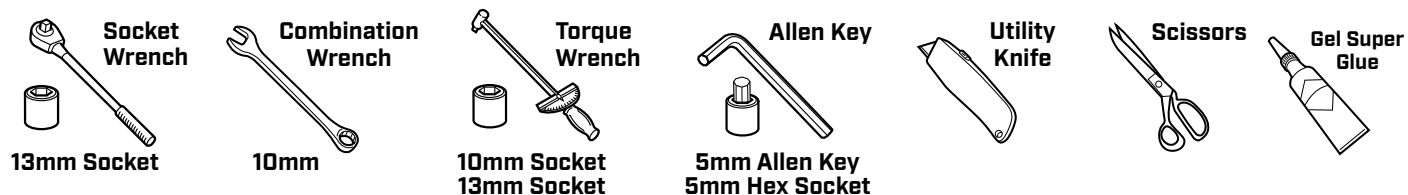

IMPORTANT

- ▼ USE ONLY THE TOOLS RECOMMENDED ABOVE.
- ▼ USE ONLY THE HARDWARE PROVIDED IN THIS KIT.
- ▼ ASSISTANCE WILL BE NEEDED FOR THIS INSTALLATION.
FOUR PEOPLE ARE RECOMMENDED TO LIFT THE SMARTCAP ONTO THE VEHICLE.
- ▼ AVOID PINCHING OR CRUSHING HANDS AND FINGERS.
- ▼ INSPECT ALL KIT COMPONENTS FOR DAMAGE BEFORE ASSEMBLY.
- ▼ NEVER USE ACETONE OR THINNERS ON PAINTED PARTS.

COMPONENTS

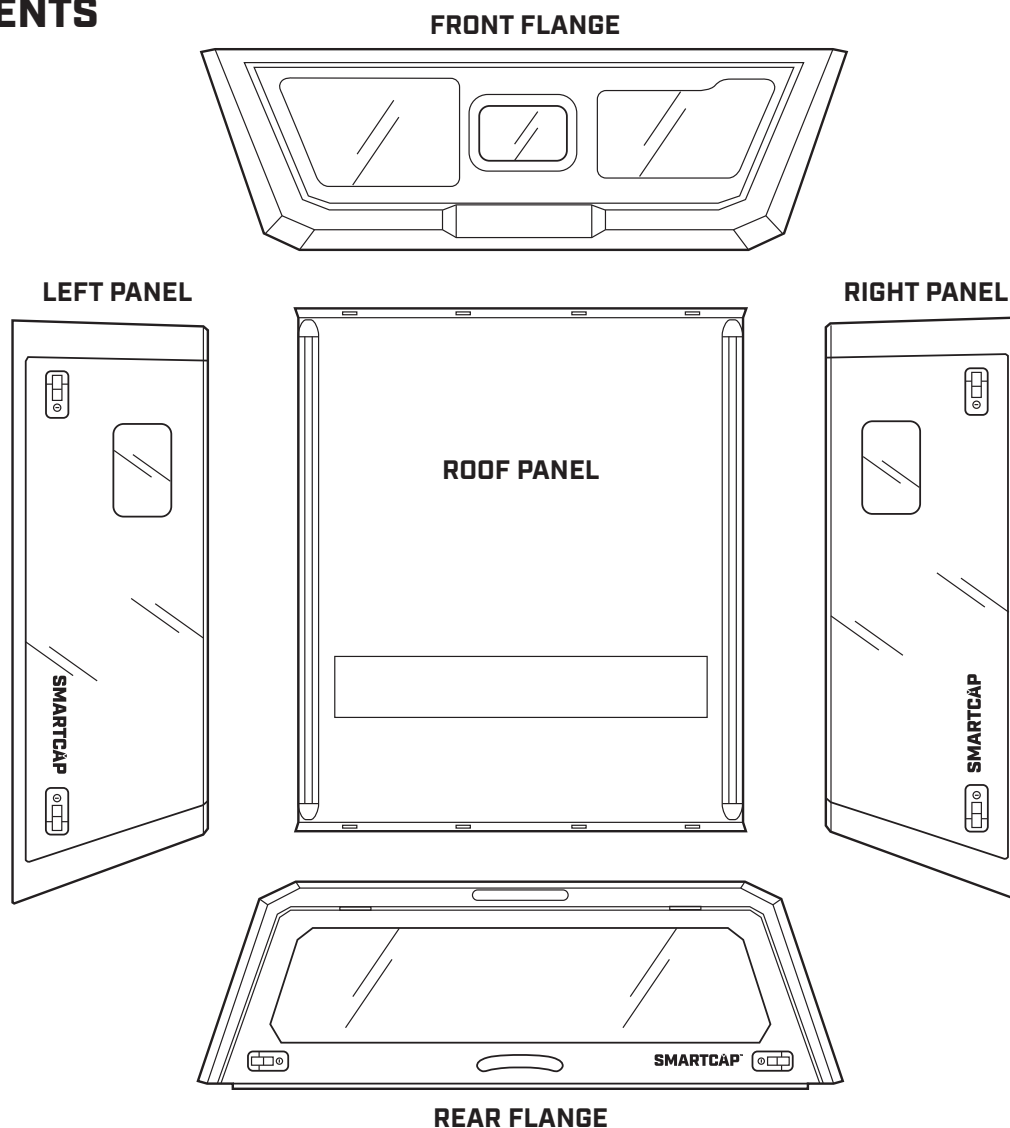

I-SHEET-ROW-A1

ASSEMBLY HARDWARE

FITMENT KIT

M6 x 10mm BOLT

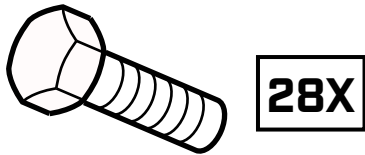

**FASTENER
BLOCK CLAMP**

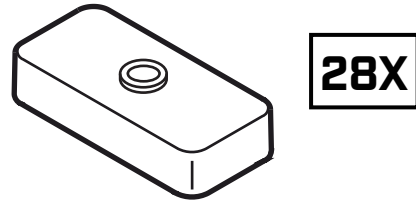

**M6 LOCK
WASHER**



**FASTENER
BLOCK**

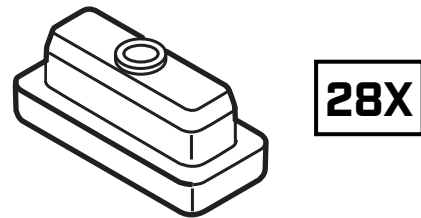

D - RUBBER



SPARE PARTS

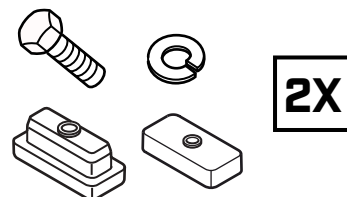

**M6 FENDER
WASHER**



**M6 LOCK
NUT**



STEP 1



IMPORTANT

- ▼ BE SURE TO REMOVE ALL FIVE PANELS FROM THEIR PACKAGING AND INSPECT THE PAINTED SURFACES PRIOR TO ASSEMBLY, AS SMARTCAP WILL NOT ACCEPT PAINT DAMAGE WARRANTY CLAIMS AFTER ASSEMBLY IS COMPLETED. IF MANUFACTURING IMPERFECTIONS OR SHIPPING DAMAGES ARE FOUND, DO NOT CONTINUE WITH THE ASSEMBLY PROCESS AND CONTACT SUPPORT AT SUPPORT.NA@SMARTCAP.COM SUPPORT.SA@SMARTCAP.COM.

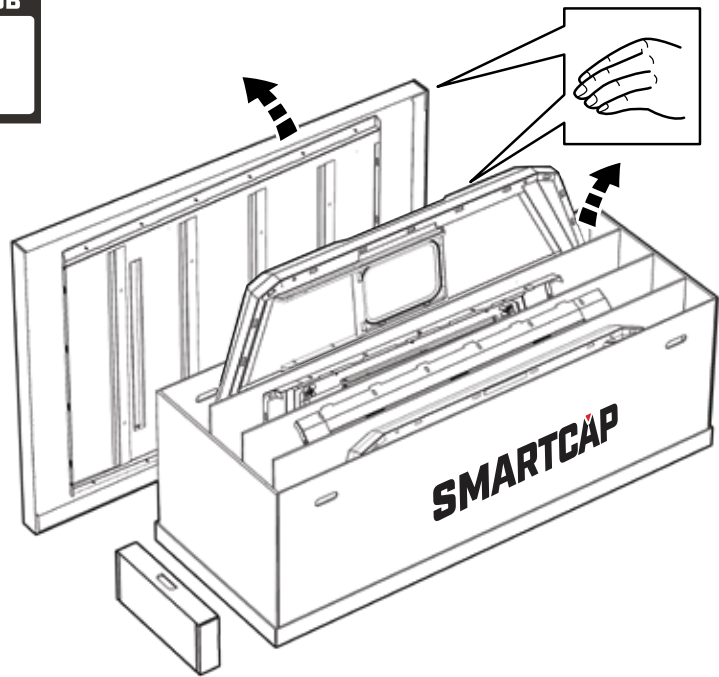

STEP 2

PLACE THE ROOF PANEL WHERE YOU PLAN TO ASSEMBLE THE CAP. REMOVE THE LID FROM THE PACKAGING AND PLACE IT NEXT TO THE ROOF PANEL.

LOGO SIDE UP

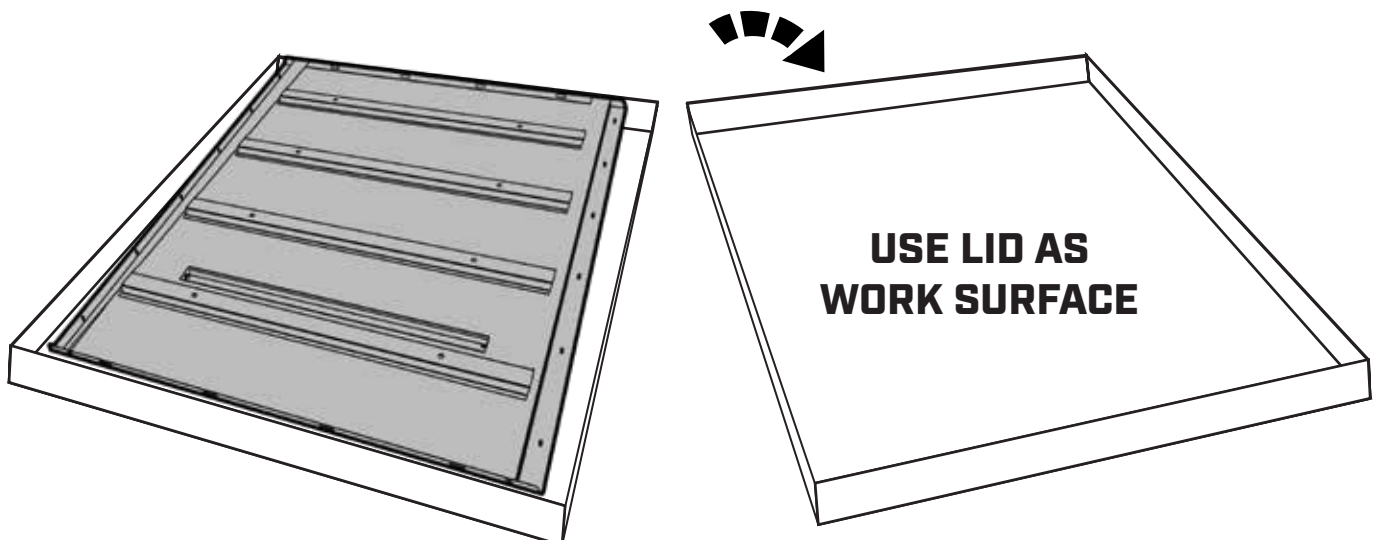
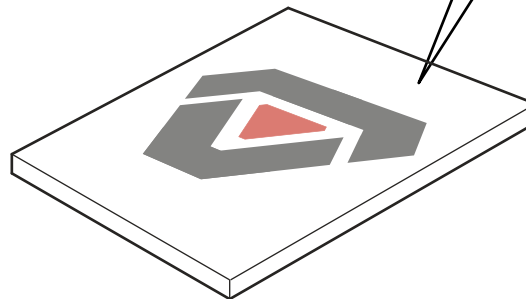

I-SHEET-ROW-A1

STEP 3

USE A 10MM COMBINATION WRENCH TO REMOVE ALL HARDWARE FROM THE ROOF PANEL.



AIR VENT INDICATES REAR

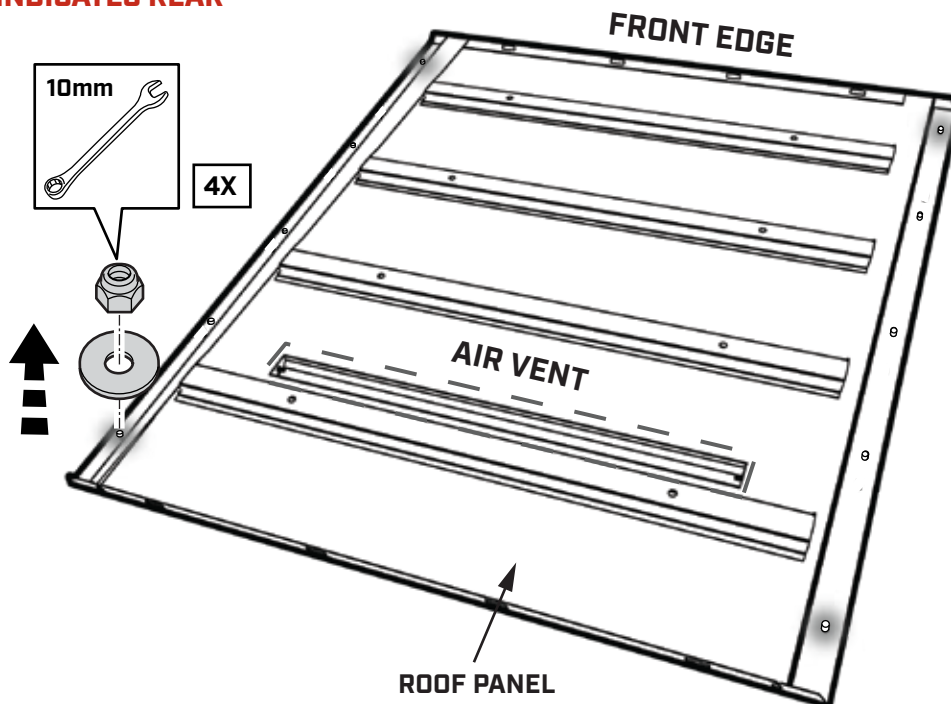

STEP 4

LOCATE THE RIGHT PANEL IN THE SMARTCAP PACKAGE AND BRING IT TO YOUR WORK AREA.

2 PERSON JOB



SLANTED EDGE INDICATES REAR

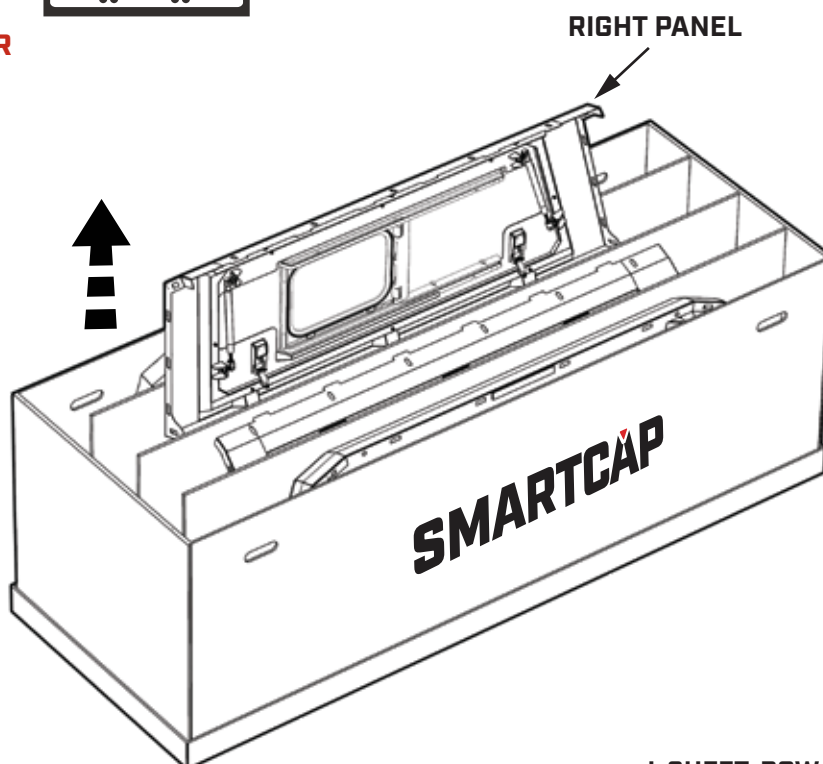

I-SHEET-ROW-A1

STEP 5

INSERT PANEL TABS INTO NARROW SLOTS JUST ABOVE FOAM PADDING ON ROOF PANEL.

TAP FIRMLY WITH PALM OF HAND UNTIL THERE IS A 2-3MM GAP.

2 PERSON JOB



SLANTED EDGE TOWARDS REAR

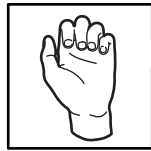

RIGHT PANEL

ROOF PANEL

PANEL TABS

FRONT EDGE

AIR VENT

REAR EDGE

STEP 6

HAND TIGHTEN M6 LOCK NUT WITH M6 FENDER WASHER TO ALL ROOF STUDS.

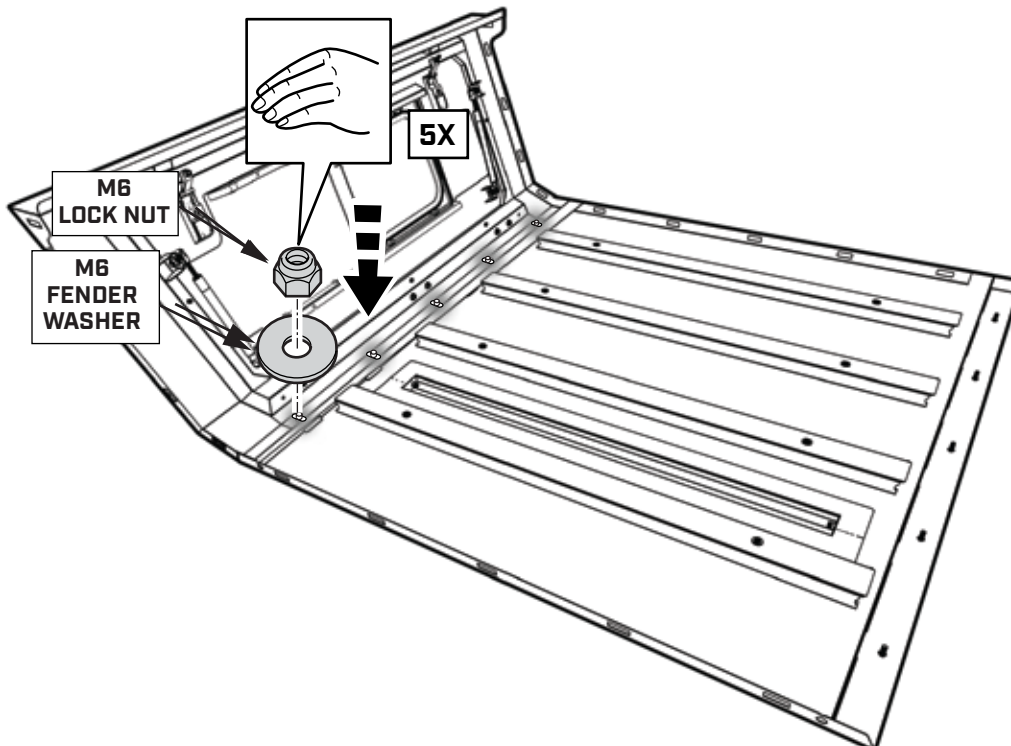

I-SHEET-ROW-A1

STEP 7

LOCATE THE LEFT PANEL IN THE SMARTCAP PACKAGE AND BRING IT TO YOUR WORK AREA.



SLANTED EDGE INDICATES REAR



2 PERSON JOB

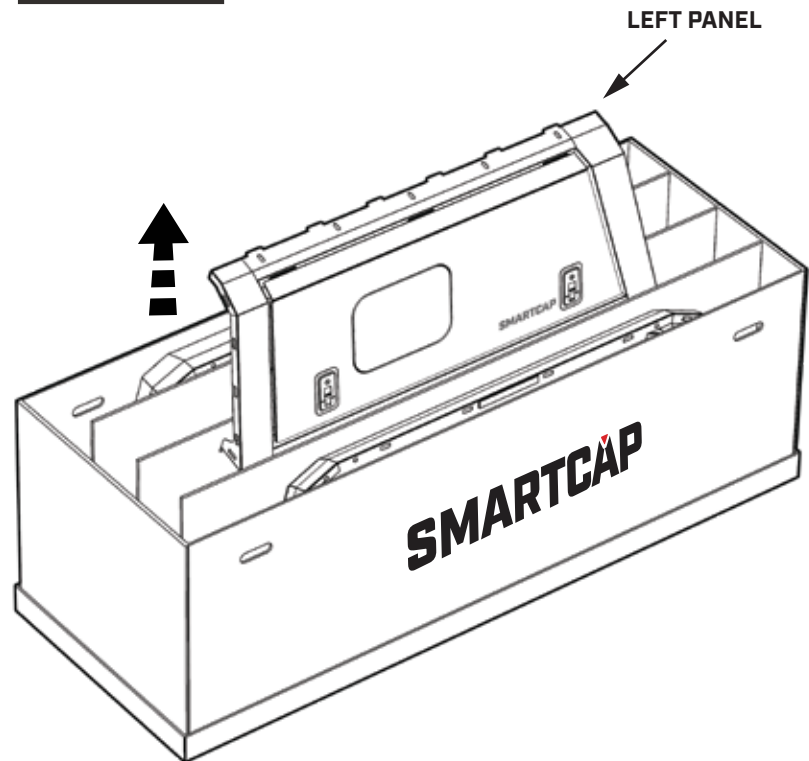

STEP 8

INSERT PANEL TABS INTO NARROW SLOTS JUST ABOVE FOAM PADDING ON ROOF PANEL.

TAP FIRMLY WITH PALM OF HAND UNTIL THERE IS A 2-3MM GAP.

2 PERSON JOB

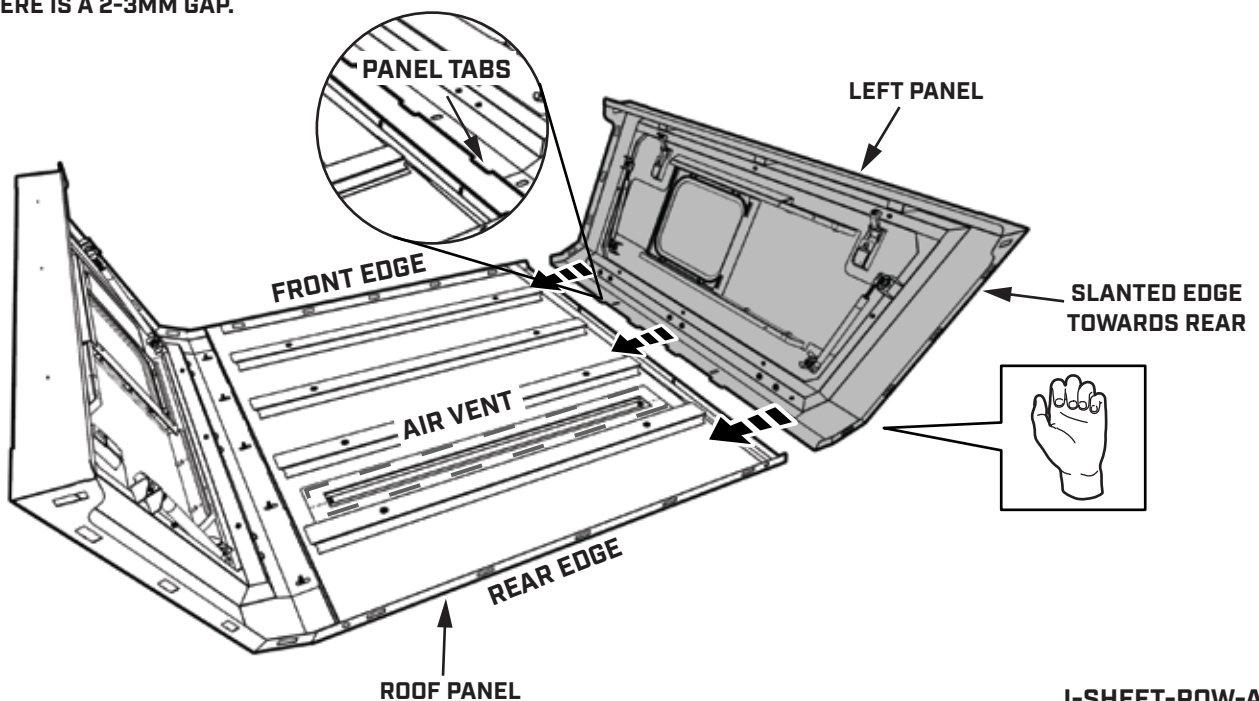

I-SHEET-ROW-A1

STEP 9

HAND TIGHTEN M6 LOCK NUT WITH
M6 FENDER WASHER TO ALL ROOF STUDS .

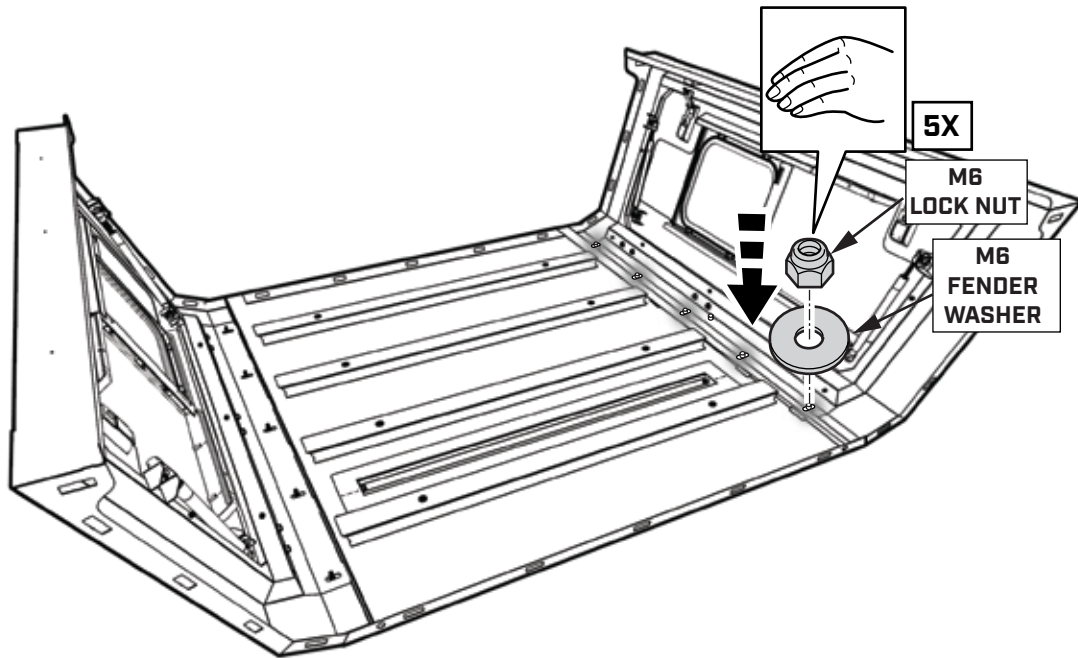

STEP 10

PUSH THE SMARTCAP TO EXPOSE A FEW INCHES OF
STYROFOAM UNDERNEATH THE ROOF PANEL TO
PROVIDE SUPPORT FOR THE FRONT FLANGE.

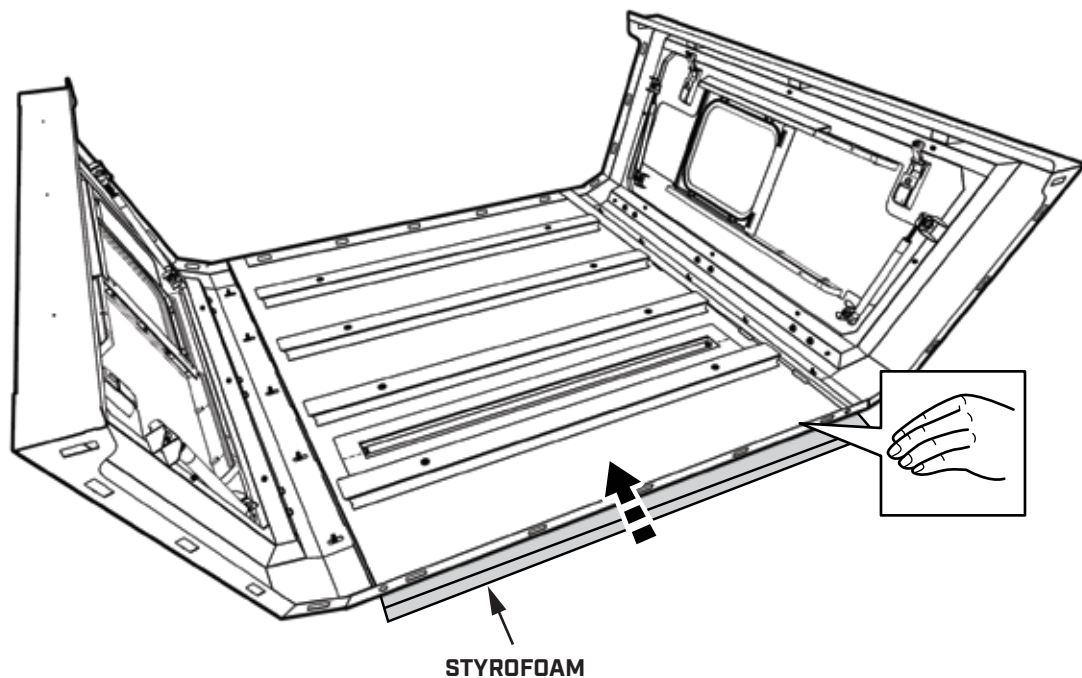

I-SHEET-ROW-A1

STEP 11

RETRIEVE THE NECESSARY HARDWARE FROM THE FITMENT KIT.

LOCATE THE FRONT FLANGE IN THE SMARTCAP PACKAGE AND BRING IT TO YOUR WORK AREA.

2 PERSON JOB

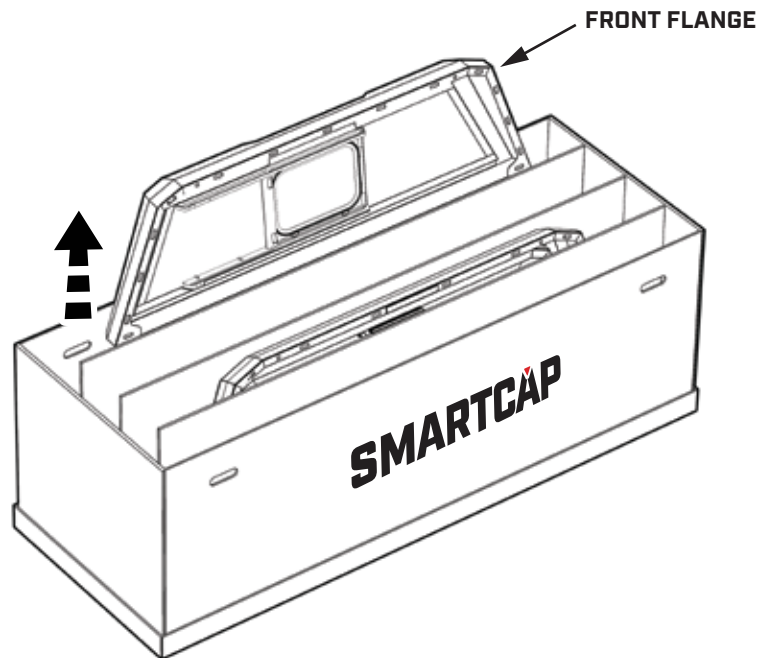

STEP 12

PLACE FRONT FLANGE AS SHOWN BELOW.

2 PERSON JOB

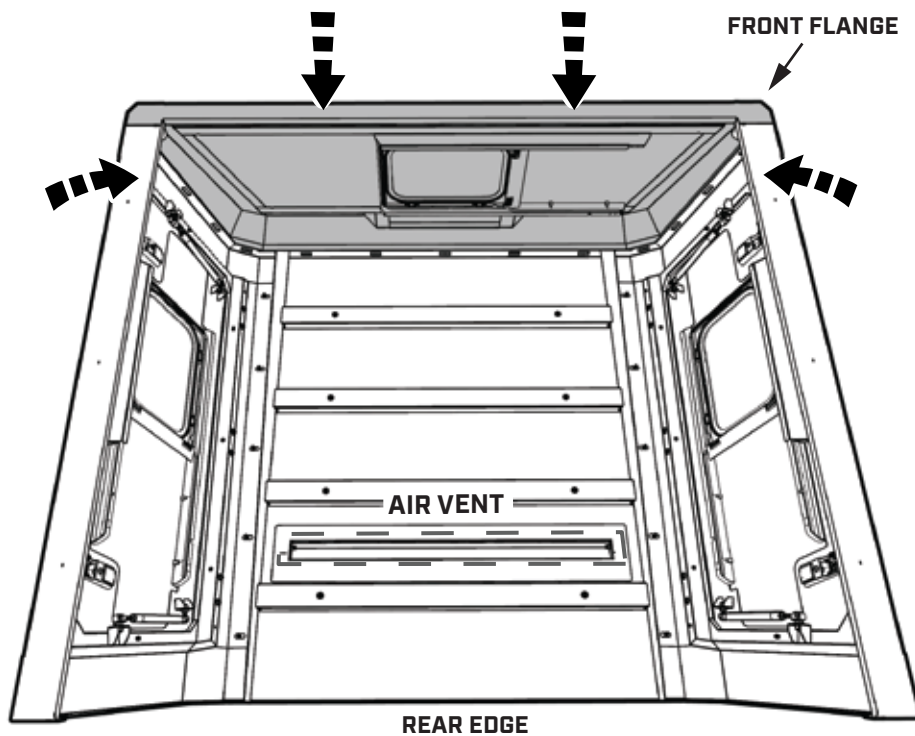

I-SHEET-ROW-A1

STEP 13

INSTALL HARDWARE ALONG FRONT FLANGE WITH M6 BOLT ON INSIDE.

START WITH ASSEMBLING FASTENER BLOCKS 1-5.

ADJUST LEFT AND RIGHT PANELS TO ALIGN FASTENER BLOCKS 6-15 FOR ASSEMBLY.

HAND TIGHTEN IN THE SEQUENCE SHOWN.

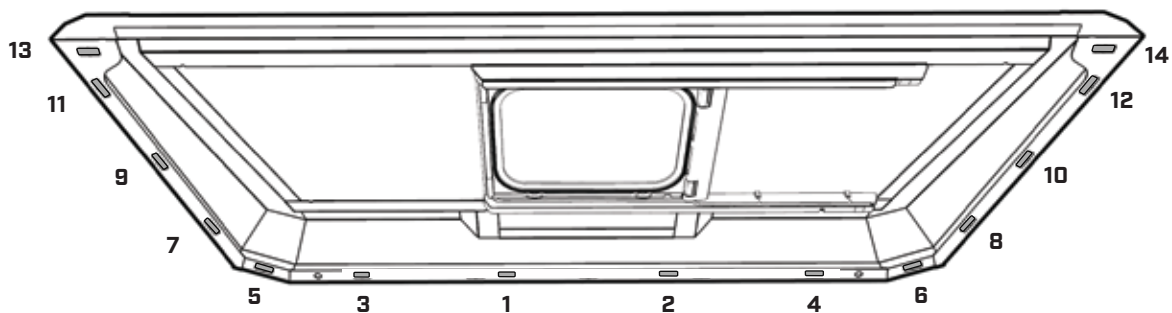
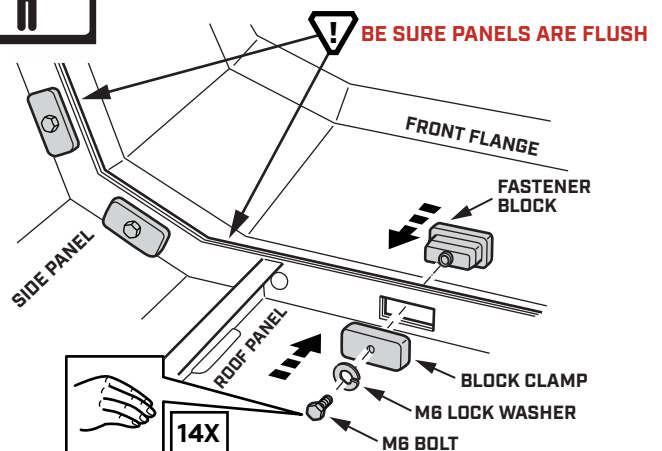

STEP 14

PUSH THE SMARTCAP TO EXPOSE A FEW INCHES OF STYROFOAM UNDERNEATH THE ROOF PANEL TO PROVIDE SUPPORT FOR THE REAR FLANGE.

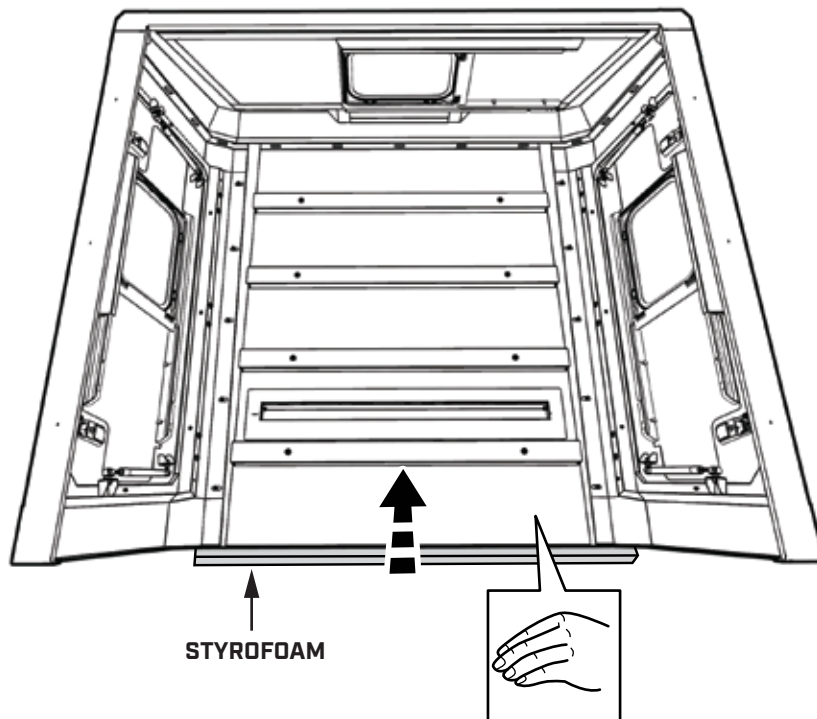

I-SHEET-ROW-A1

STEP 15

RETRIEVE THE NECESSARY HARDWARE FROM THE FITMENT KIT.

LOCATE THE REAR FLANGE IN THE SMARTCAP PACKAGE AND BRING IT TO YOUR WORK AREA.

2 PERSON JOB

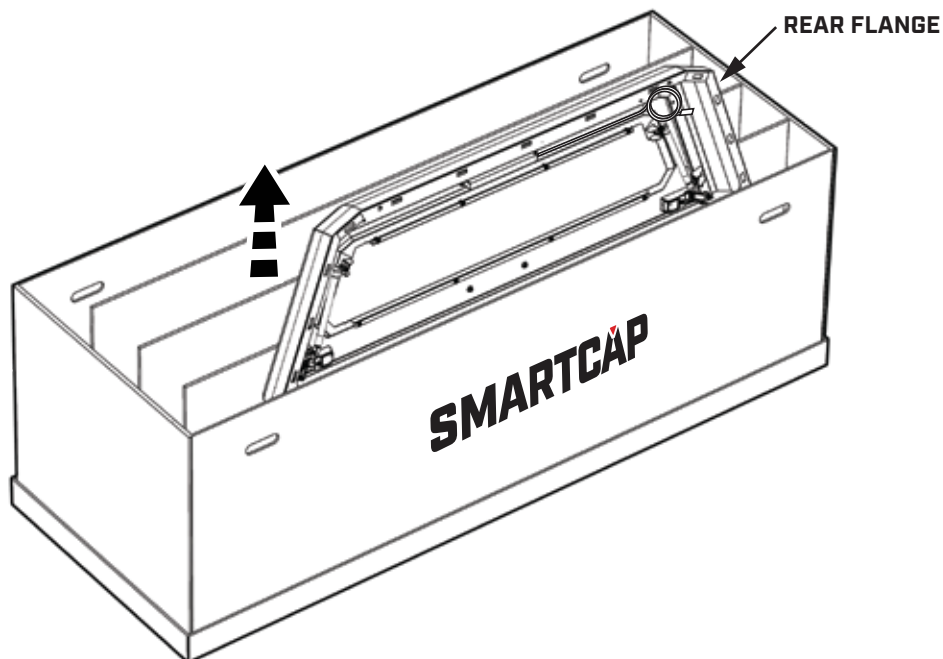

STEP 16

PLACE REAR FLANGE AS SHOWN BELOW.

2 PERSON JOB

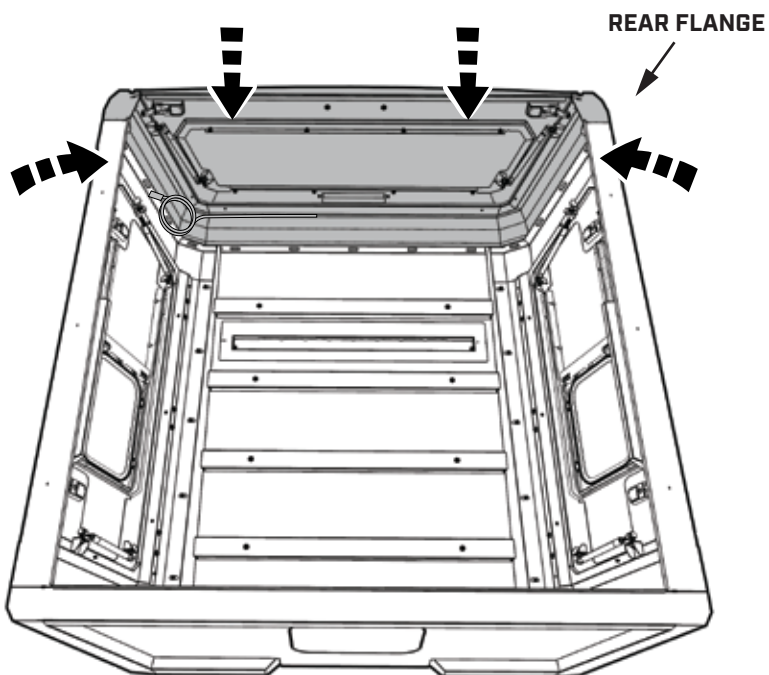

I-SHEET-ROW-A1

STEP 17

INSTALL HARDWARE ALONG REAR FLANGE WITH BOLT ON INSIDE.

START WITH ASSEMBLING FASTENER BLOCKS 1-5.

ADJUST LEFT AND RIGHT PANELS TO ALIGN FASTENER BLOCKS 6-15 FOR ASSEMBLY.

HAND TIGHTEN IN THE SEQUENCE SHOWN.

2 PERSON JOB

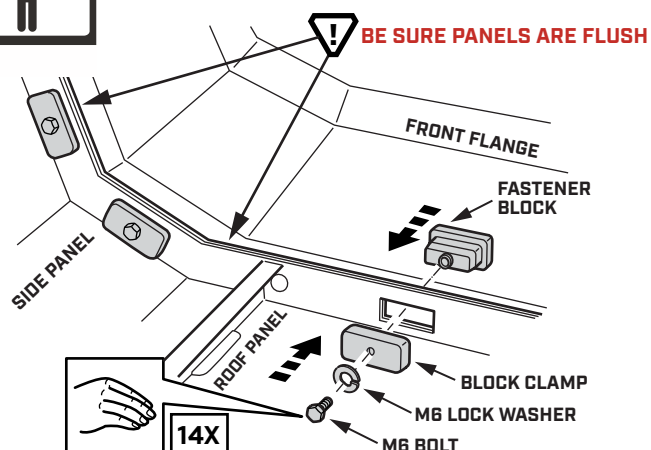

STEP 18

TIGHTEN ALL HARDWARE WITH TORQUE WRENCH AND 10MM SOCKET TO 3.7 FT. LBS. [5 NEWTON METERS]

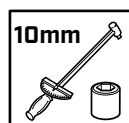

[3.7 ft. lbs]/[5 Nm]

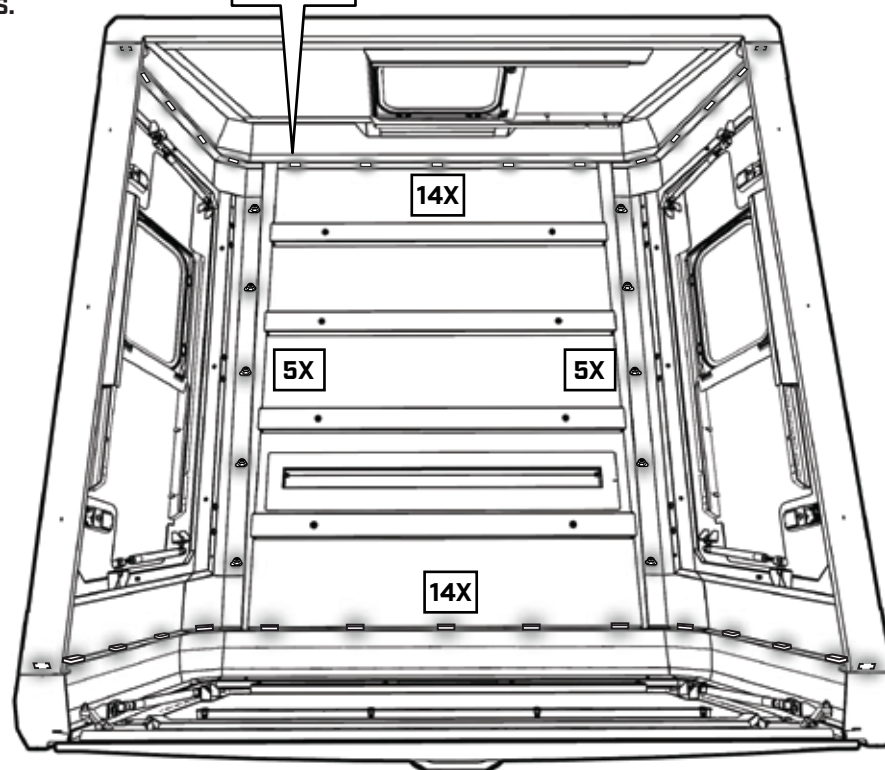

I-SHEET-ROW-A1

STEP 19

ENSURE THE ENTIRE BOTTOM EDGE OF THE SMARTCAP IS CLEAN.

LOCATE BOTH RETENTION TABS ON THE REAR FLANGE AND BEND EACH TO A 45-DEGREE ANGLE FOR D-RUBBER FITMENT.

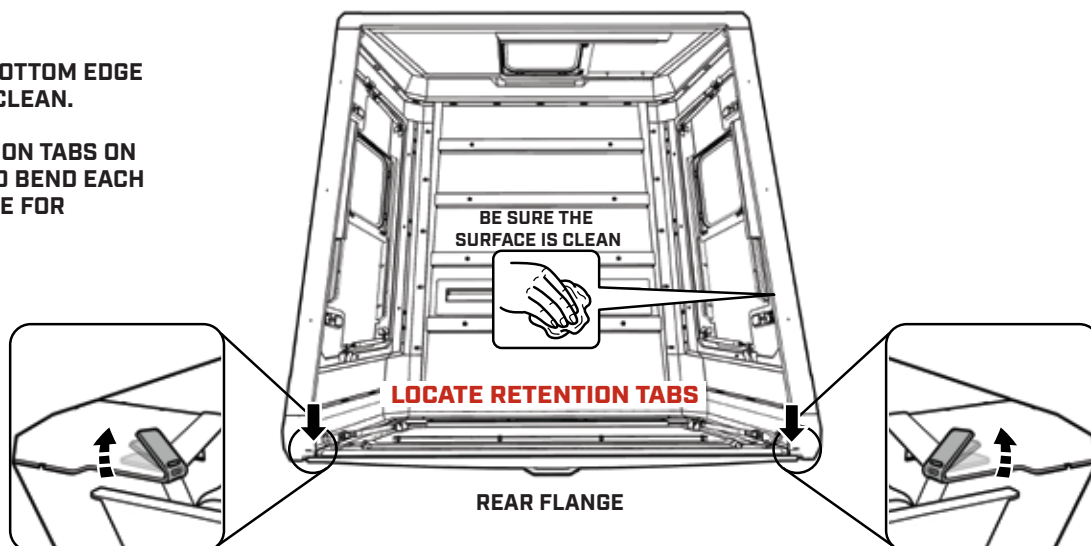

STEP 20

TRIM THE D-RUBBER WITH A CLEAN, STRAIGHT CUT.

APPLY 2-3 INCHES OF GEL SUPER GLUE NEAR THE RETENTION TABS, ALONG THE BOTTOM EDGE OF THE REAR FLANGE

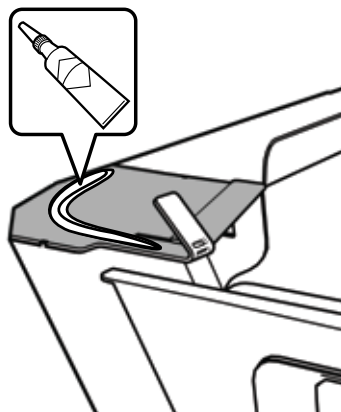
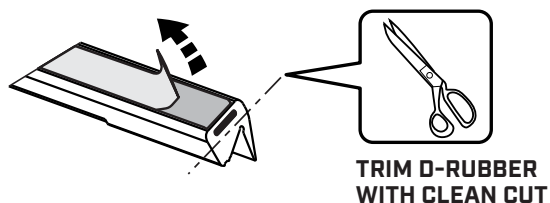

STEP 21

FULLY INSERT THE RETENTION TAB INTO THE SLOT ON THE D-RUBBER. ENSURE THE D-RUBBER IS ORIENTED CORRECTLY WITH ITS PROFILE MATCHING THE CONTOUR OF THE REAR FLANGE.

PRESS DOWN FIRMLY ON THE TAB AND THE D-RUBBER TO BOND IT TO THE REAR FLANGE, CREATING A TIGHT SEAL.

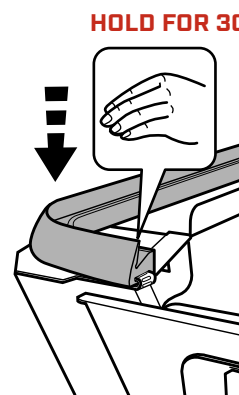
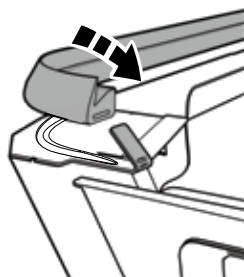

CORRECT D-RUBBER ORIENTATION

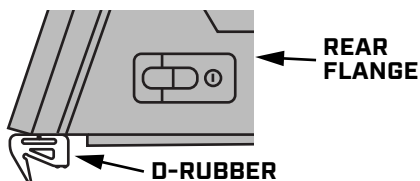

INCORRECT D-RUBBER ORIENTATION

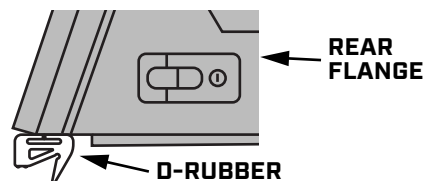

I-SHEET-ROW-A1

STEP 22

APPLY 3 INCH LONG STRANDS OF GEL SUPER GLUE ALONG THE BOTTOM EDGE OF THE SMARTCAP, LEAVING 3 INCH GAPS BETWEEN EACH STRAND OF GLUE.

ENSURE THAT GLUE IS APPLIED TO THE CORNERS OF THE SMARTCAP.

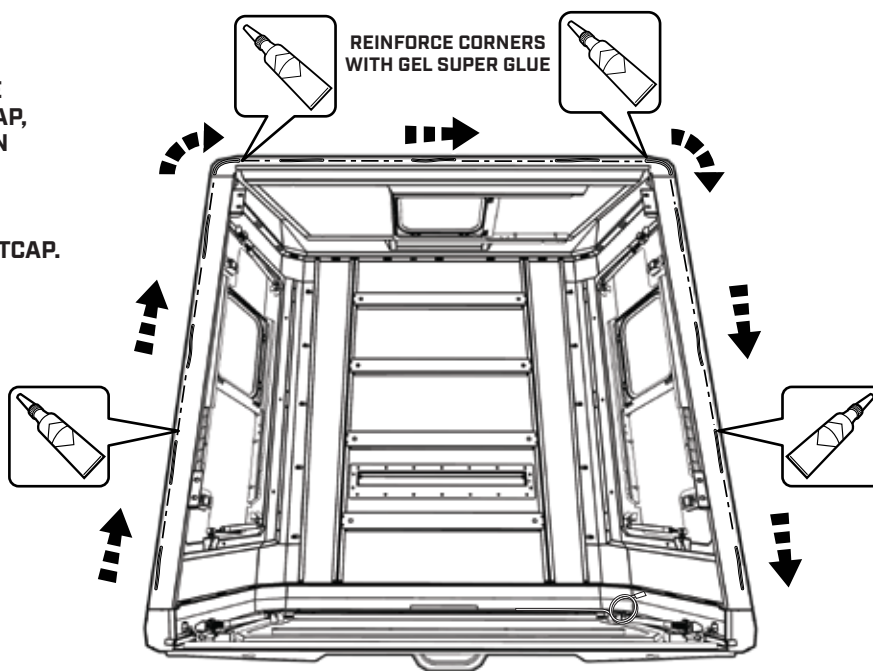

ALIGN THE D-RUBBER ALONG THE SMARTCAP'S EDGE, MAINTAINING A CONSISTENT 1/8 INCH GAP FROM THE EDGE.

APPLY PRESSURE FOR AT LEAST 30 SECONDS ON THE AREAS WHERE SUPER GLUE WAS APPLIED.

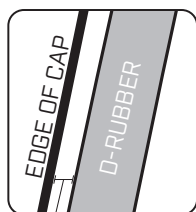

1/8 INCH
FROM EDGE

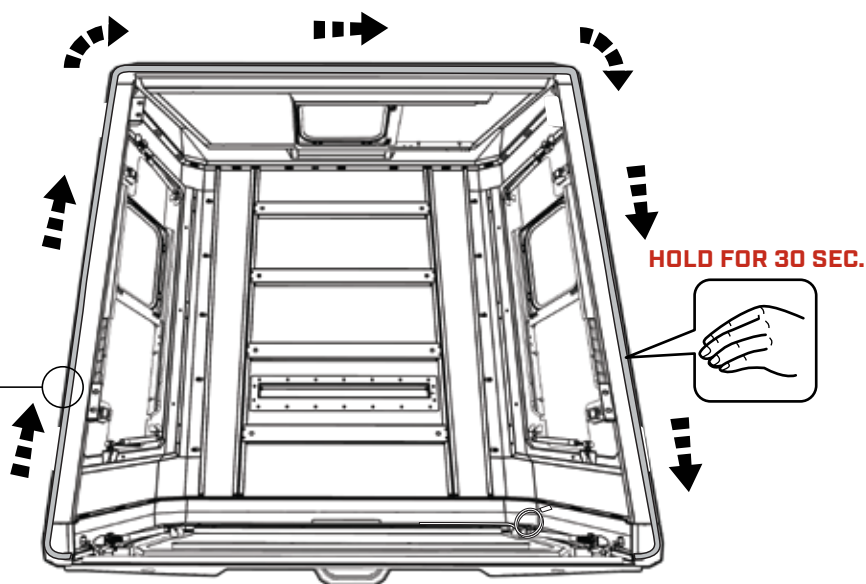

STEP 23

TRIM ANY EXCESS D-RUBBER BEYOND THE EDGE FOR A NEAT FINISH.

APPLY 2-3 INCHES OF GEL SUPER GLUE NEAR THE RETENTION TAB, ALONG THE BOTTOM EDGE OF THE REAR FLANGE. FULLY INSERT THE RETENTION TAB INTO THE SLOT ON THE D-RUBBER.

PRESS DOWN FIRMLY ON THE TAB AND THE D-RUBBER TO BOND IT TO THE REAR FLANGE, CREATING A TIGHT SEAL.

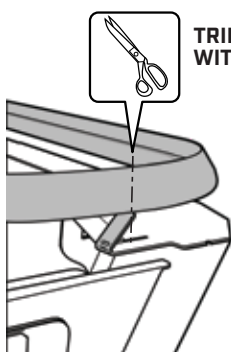

TRIM D-RUBBER
WITH CLEAN CUT

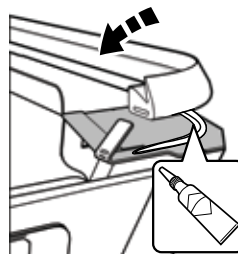

HOLD FOR 30 SEC.

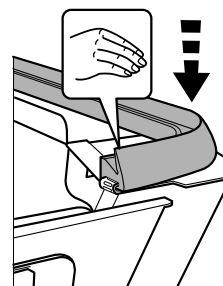

I-SHEET-ROW-A1

INSTALLATION HARDWARE

MOUNTING BRACKETS

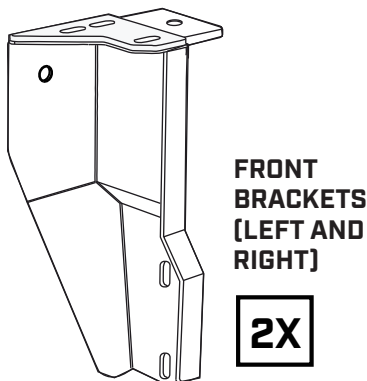
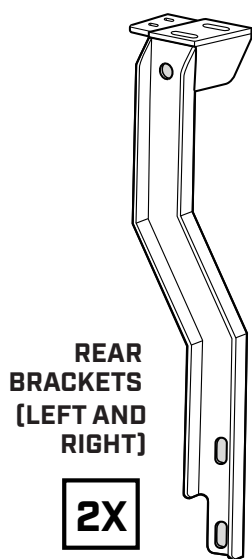

30mm x 55mm FOAM SEAL TAPE

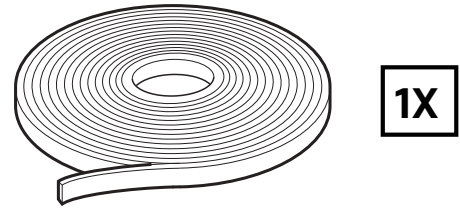
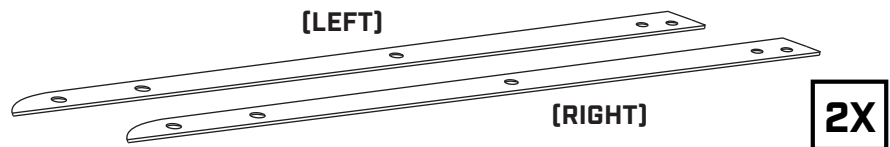

PLATE STRIPS



M8 x 30mm BOLT



M8 LOCK WASHER



M8 FENDER WASHER



M8 x 40mm BUTTON BOLT



M8 LOCK NUT



LOAD SPREADER

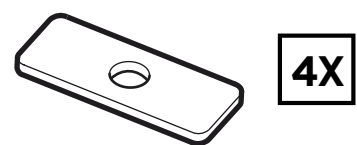

VEHICLE INSTALLATION



IMPORTANT

- ▼ ASSISTANCE WILL BE NEEDED FOR THIS INSTALLATION. FOUR PEOPLE ARE RECOMMENDED TO LIFT THE SMARTCAP ONTO THE VEHICLE.
- ▼ AVOID PINCHING OR CRUSHING HANDS AND FINGERS.
- ▼ READ THROUGH THE ENTIRE PROCEDURE BEFORE STARTING.

I-SHEET-ROW-A1

STEP 24

REMOVE THE PLASTIC BED-RAIL CAP INSERTS AND BED-RAIL CAPS.

REPEAT ON THE OPPOSITE SIDE OF THE VEHICLE.

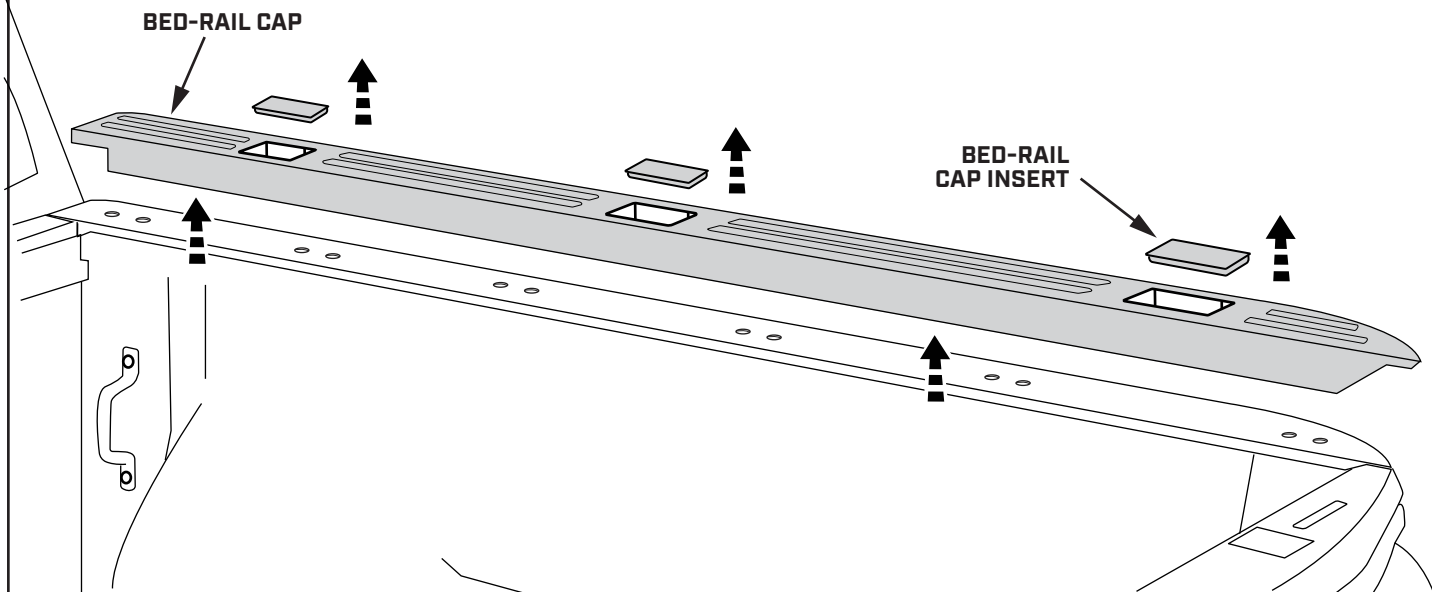

STEP 25

REMOVE THE ADHESIVE BACKING FROM THE PLATE STRIP AND APPLY TO THE BIN RAIL, ALIGNING THE FRONT OF THE PLATE STRIP TO THE FRONT OF THE BIN.

REPEAT ON THE OPPOSITE SIDE OF THE VEHICLE.

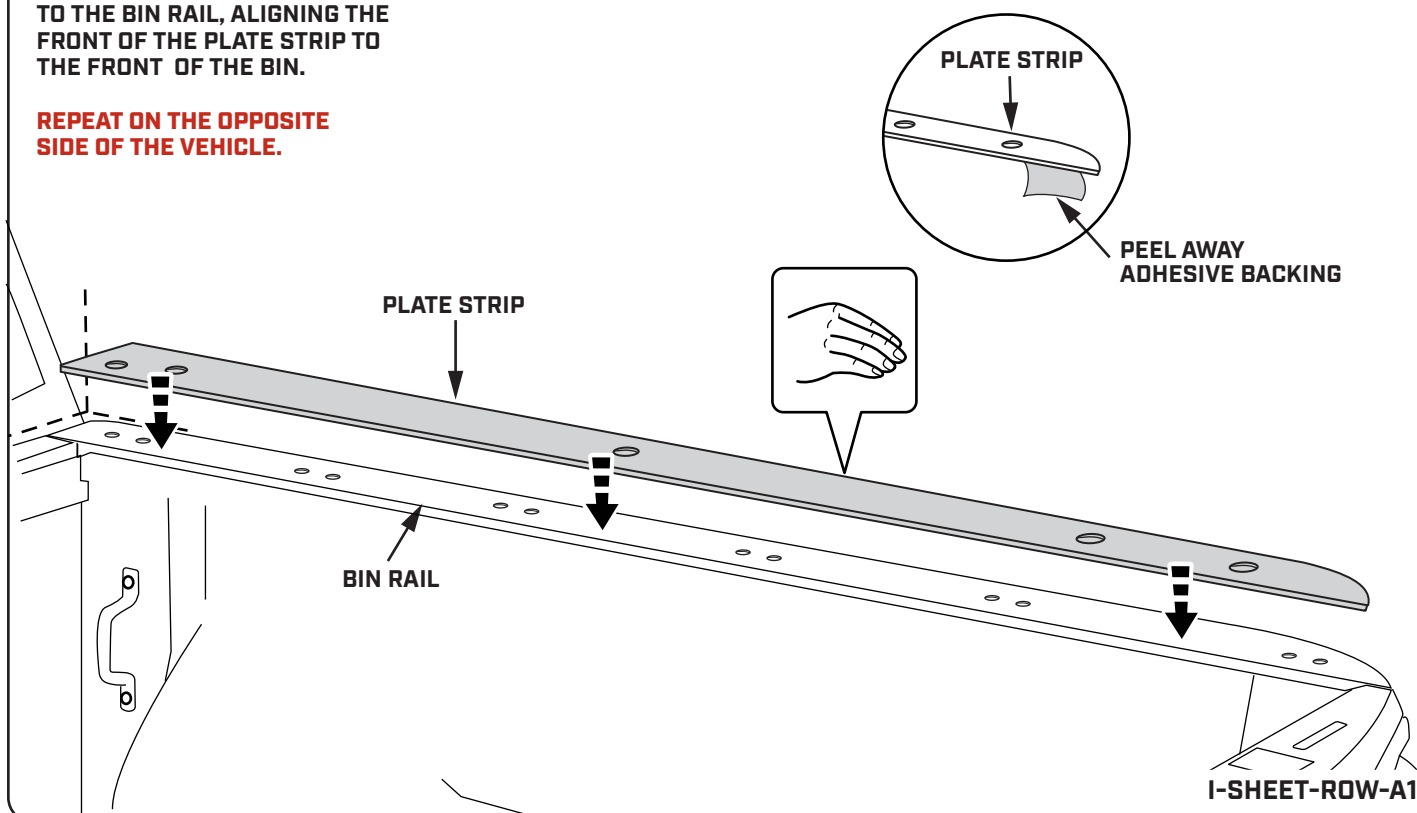

I-SHEET-ROW-A1

INSPECT THE TRUCK BED. IF FRONT EDGE IS LOWER THAN THE SIDES, ADD FOAM SEAL TAPE TO THE FRONT EDGE OF THE BED.

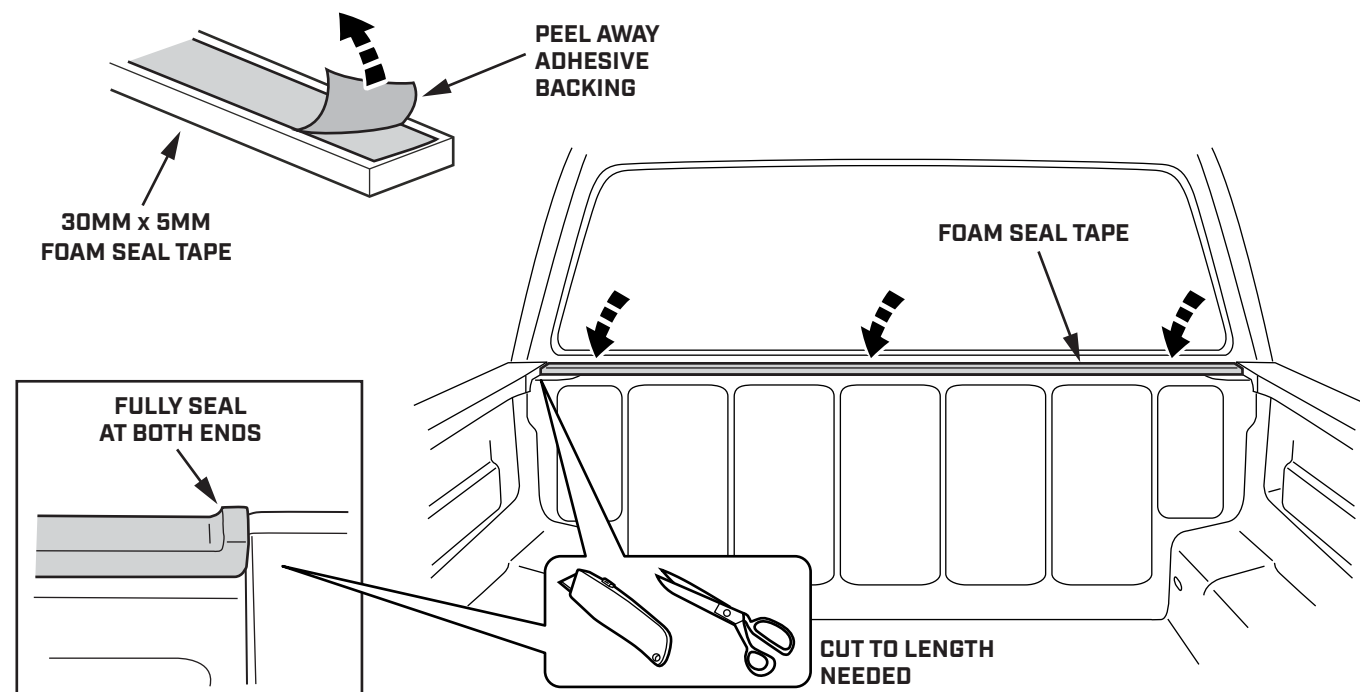

REMOVE THE FRONT TIE DOWN HOOK FROM THE INNER WALL OF THE TRUCK BED.

POSITION THE RIGHT SIDE FRONT MOUNTING BRACKET IN THE FRONT CORNER OF THE TRUCK BED AS SHOWN.

SECURE THE BRACKET WITH THE FASTENERS AS INDICATED, HAND TIGHTEN ONLY.

REPEAT ON THE OPPOSITE SIDE OF THE VEHICLE WITH THE LEFT FRONT MOUNTING BRACKET.

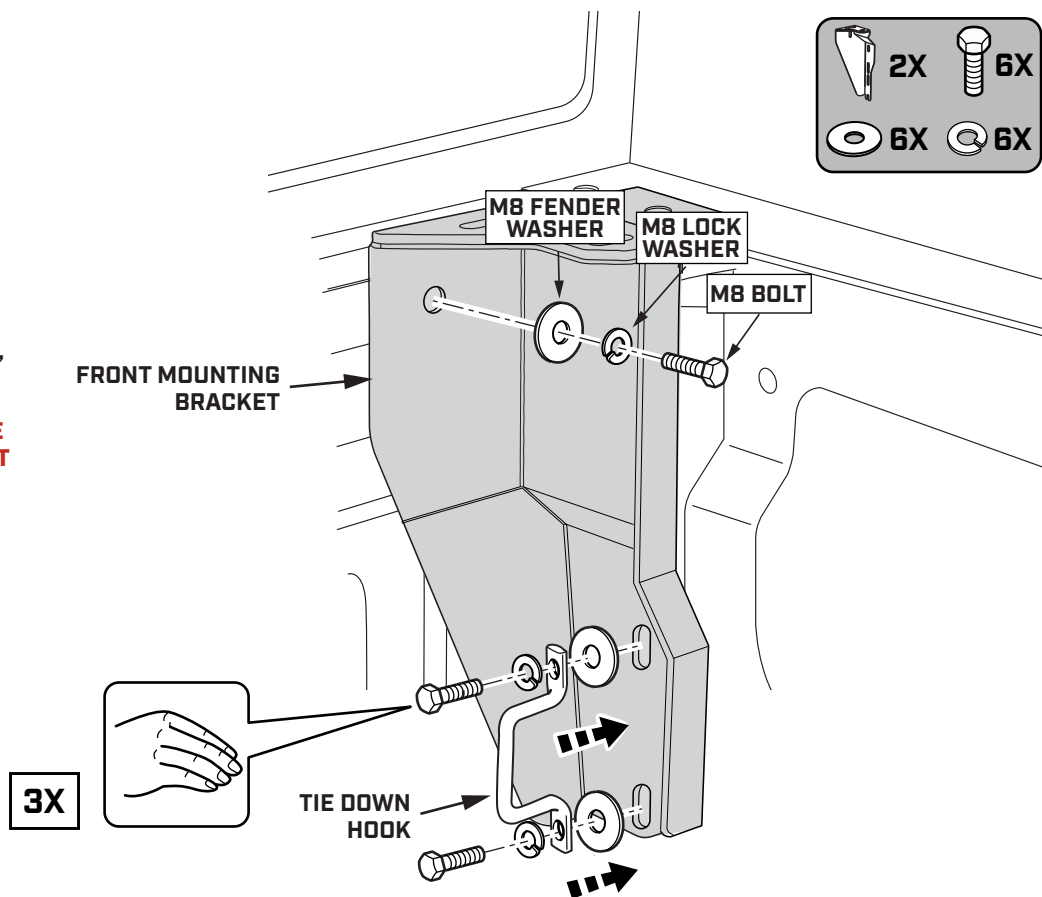

PG. 17

STEP 28

USE A 5MM ALLEN KEY TO FASTEN THE FRONT RIGHT MOUNTING BRACKET TO THE TOP OF THE TRUCK BED.

SECURE THE BRACKET WITH THE FASTENERS AS INDICATED.

REPEAT ON THE OPPOSITE SIDE OF THE VEHICLE WITH THE LEFT FRONT MOUNTING BRACKET.

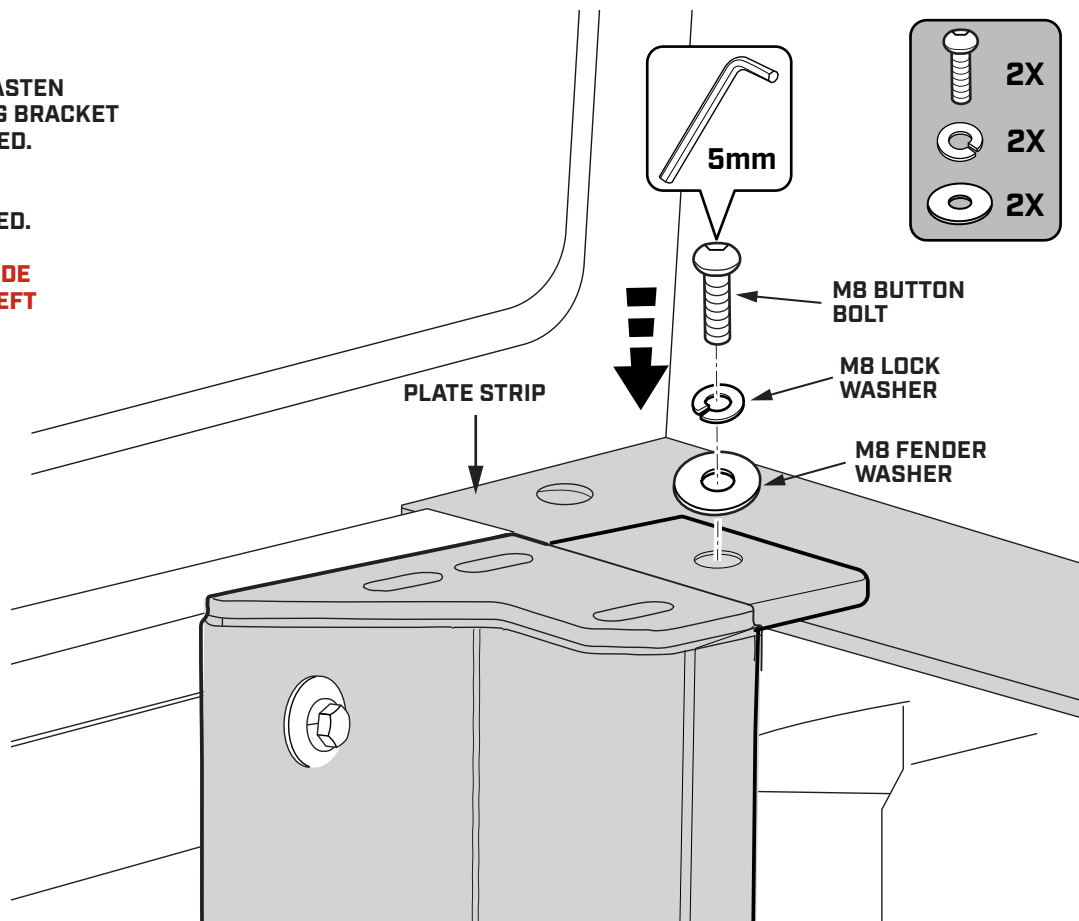

STEP 29

REMOVE THE REAR TIE DOWN HOOK FROM THE INNER WALL OF THE TRUCK BED.

POSITION THE RIGHT SIDE REAR MOUNTING BRACKET IN THE BACK CORNER OF THE TRUCK BED AS SHOWN.

SECURE THE BRACKET WITH THE FASTENERS AS INDICATED, HAND TIGHTEN ONLY.

REPEAT ON THE OPPOSITE SIDE OF THE VEHICLE WITH THE LEFT REAR MOUNTING BRACKET.

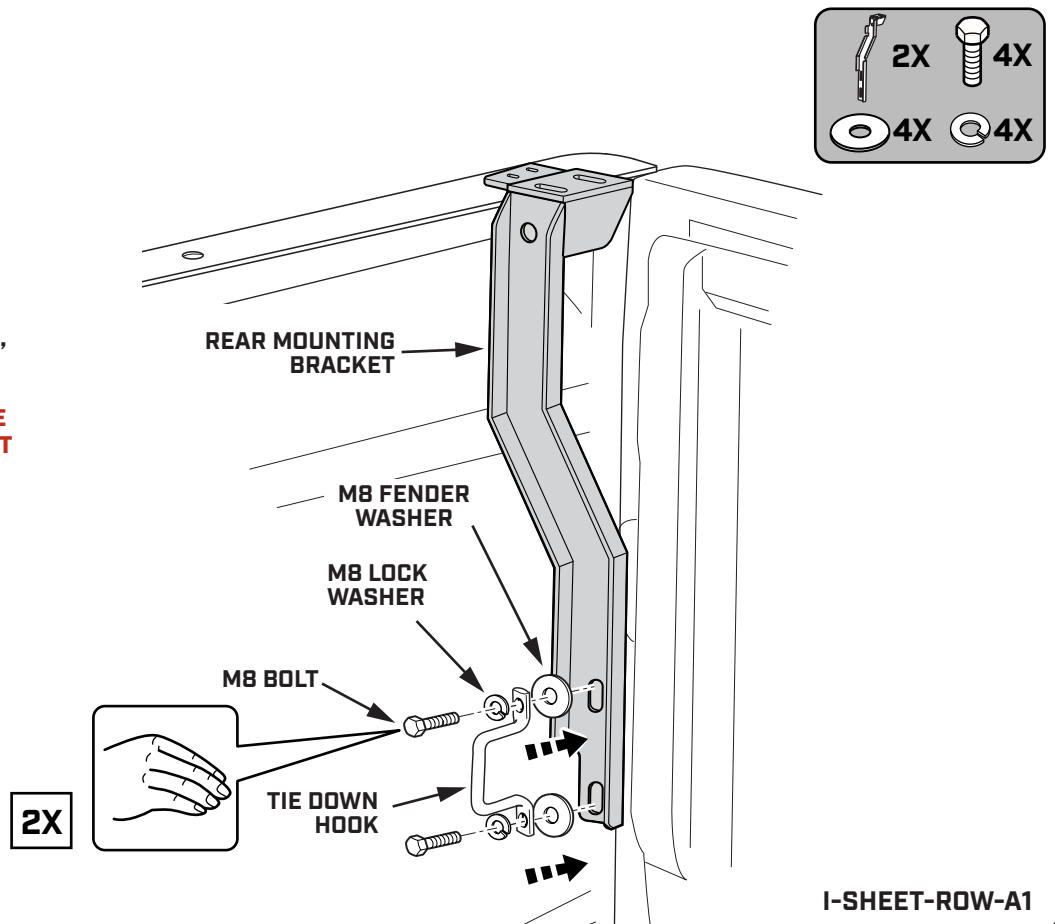

STEP 30

USE A 5MM ALLEN KEY TO FASTEN THE REAR RIGHT MOUNTING BRACKET TO THE TOP OF THE TRUCK BED.

SECURE THE BRACKET WITH THE FASTENERS AS INDICATED.

REPEAT ON THE OPPOSITE SIDE OF THE VEHICLE WITH THE LEFT FRONT MOUNTING BRACKET.

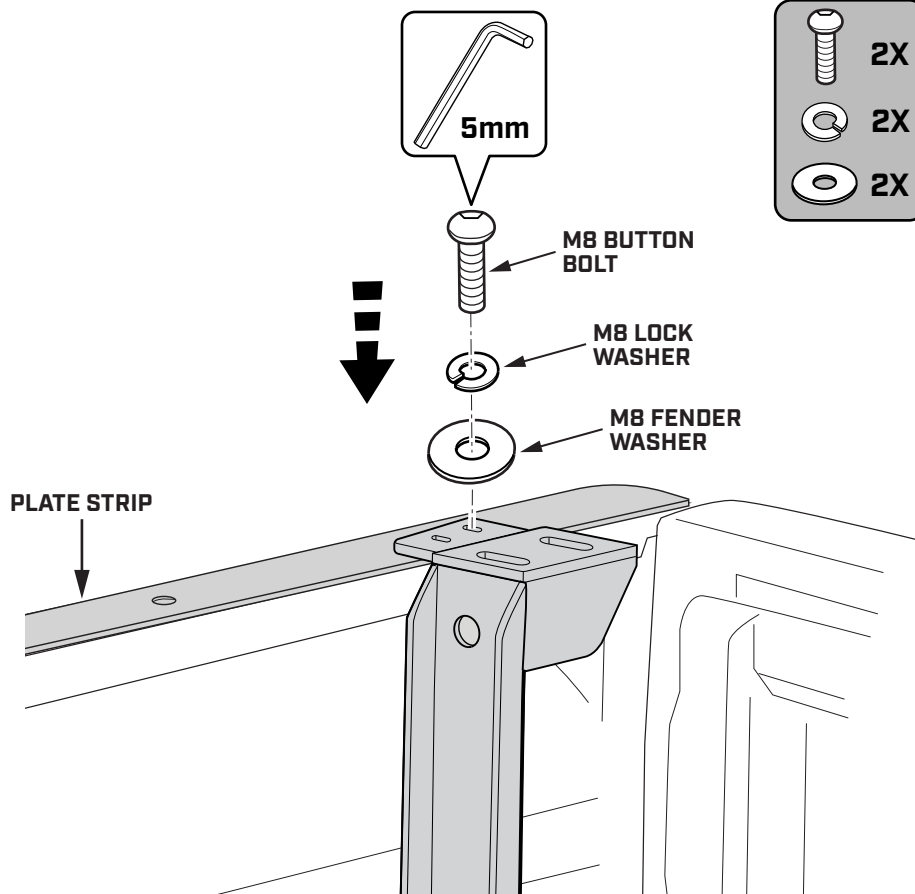

STEP 31

REMOVE THE ADHESIVE BACKING FROM LOAD SPREADER.

APPLY LOAD SPREADERS TO THE TOP OF PLATE STRIP. USE THE SLOTS TO ALIGN.

REPEAT ON THE OPPOSITE SIDE OF THE VEHICLE.

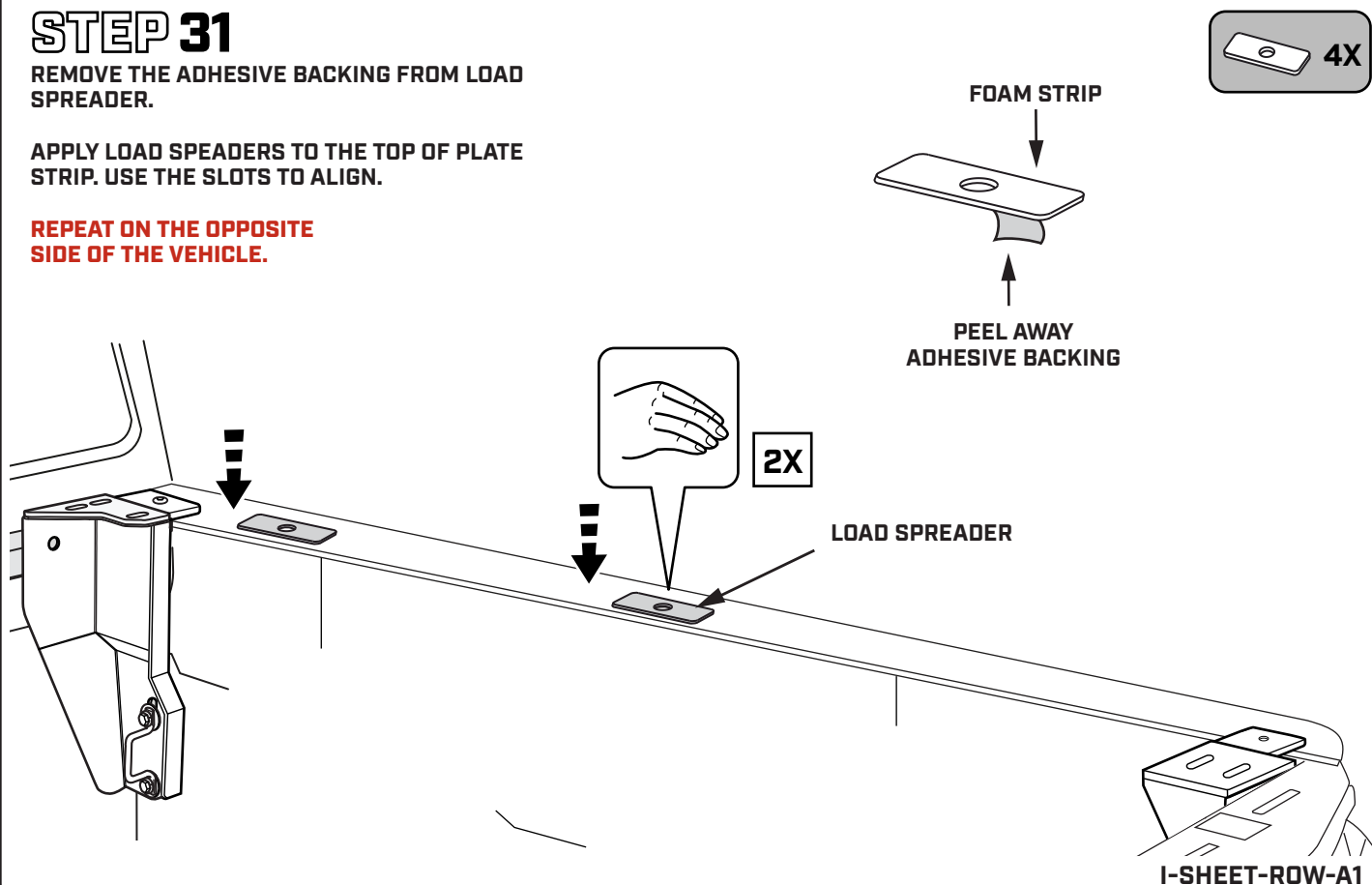

STEP 32

USE 4 PEOPLE TO LIFT THE ASSEMBLED SMARTCAP ONTO THE TRUCK BED.

TO AVOID DAMAGE TO THE D-RUBBER, DO NOT SLIDE THE SMARTCAP INTO PLACE.

4 PERSON JOB

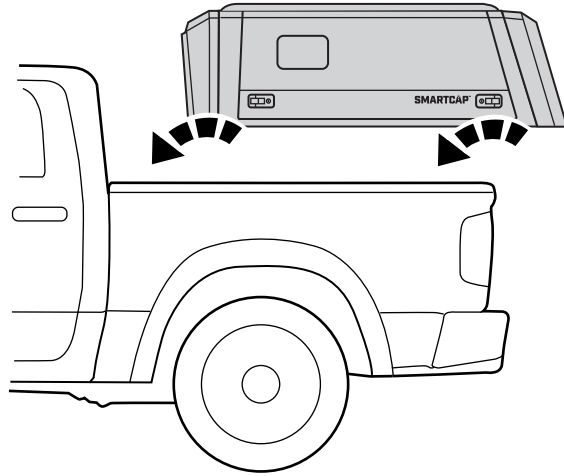

STEP 33

CHECK THAT THE SMARTCAP IS PROPERLY POSITIONED AND CENTERED ON THE TRUCK BED.

IT'S IMPORTANT THAT THE SMARTCAP IS NOT PUSHED TOO FAR FORWARD, LEAVING A GAP BETWEEN THE SMARTCAP AND THE CAB.

4 PERSON JOB

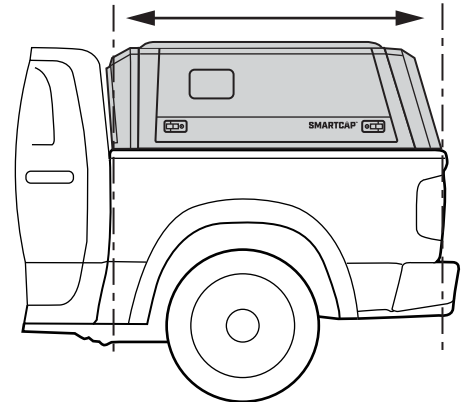
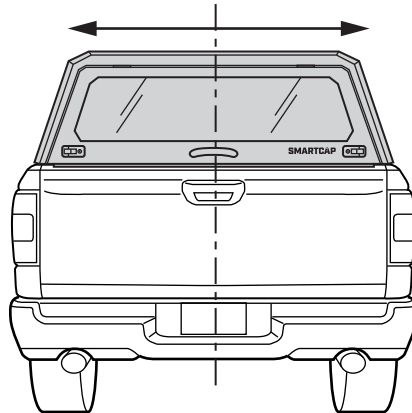

STEP 34

WALK AROUND THE TRUCK BED TO MAKE SURE THE D-RUBBER FITMENT IS CORRECT AND THAT THE RUBBER LIP IS FLUSH WITH THE EXTERIOR OF THE TRUCK BED.

CORRECT D-RUBBER ORIENTATION



D-RUBBER

REAR FLANGE

TAILGATE

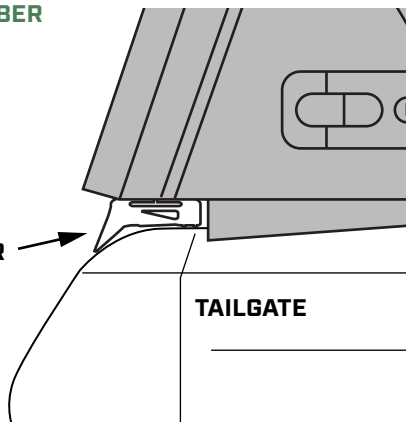

INCORRECT D-RUBBER ORIENTATION



D-RUBBER

REAR FLANGE

TAILGATE

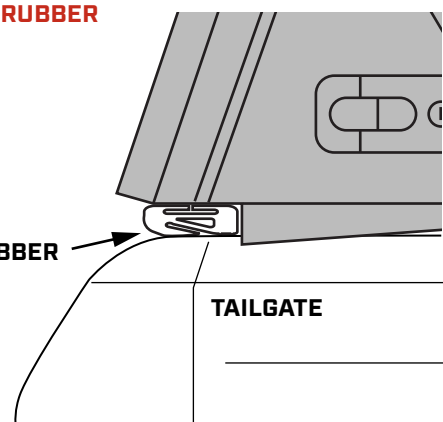

I-SHEET-ROW-A1

STEP 35

WITH A 5MM ALLEN KEY, LOOSELY TIGHTEN THE SMARTCAP RIGHT SIDE PANEL TO THE TOP OF THE TRUCK BED USING M8 BUTTON HEAD BOLT, M8 LOCK WASHER, AND M8 FENDER WASHER AS SHOWN BELOW.

REPEAT ON THE OPPOSITE SIDE OF THE VEHICLE.

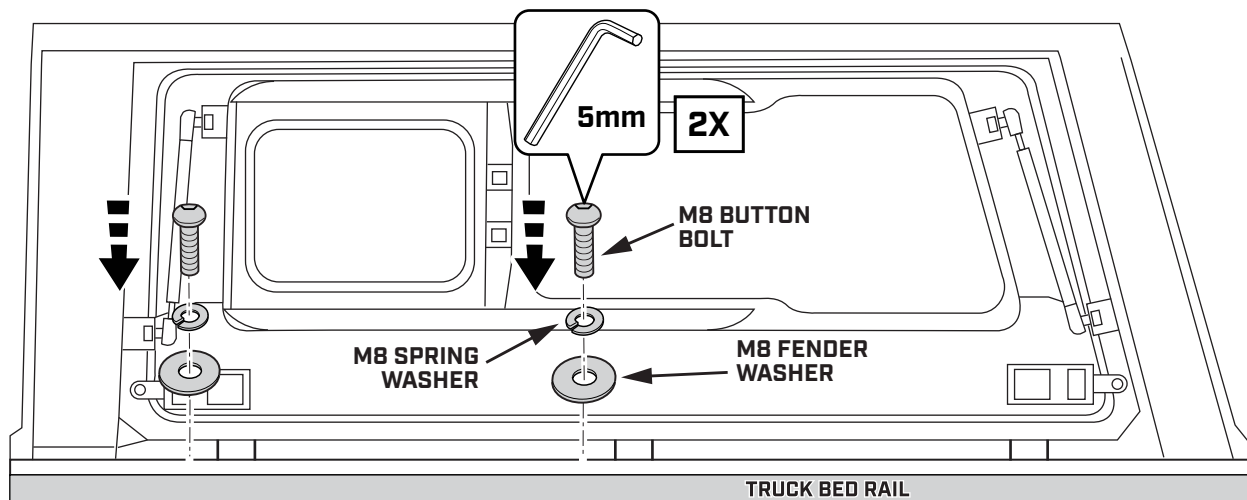
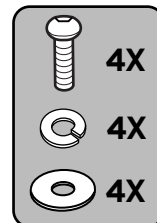

STEP 36

SECURE THE SMARTCAP TO THE RIGHT FRONT MOUNTING BRACKET WITH THE FASTENERS AS INDICATED, HAND TIGHTEN ONLY.

REPEAT ON THE OPPOSITE SIDE OF THE VEHICLE WITH THE LEFT FRONT MOUNTING BRACKET.

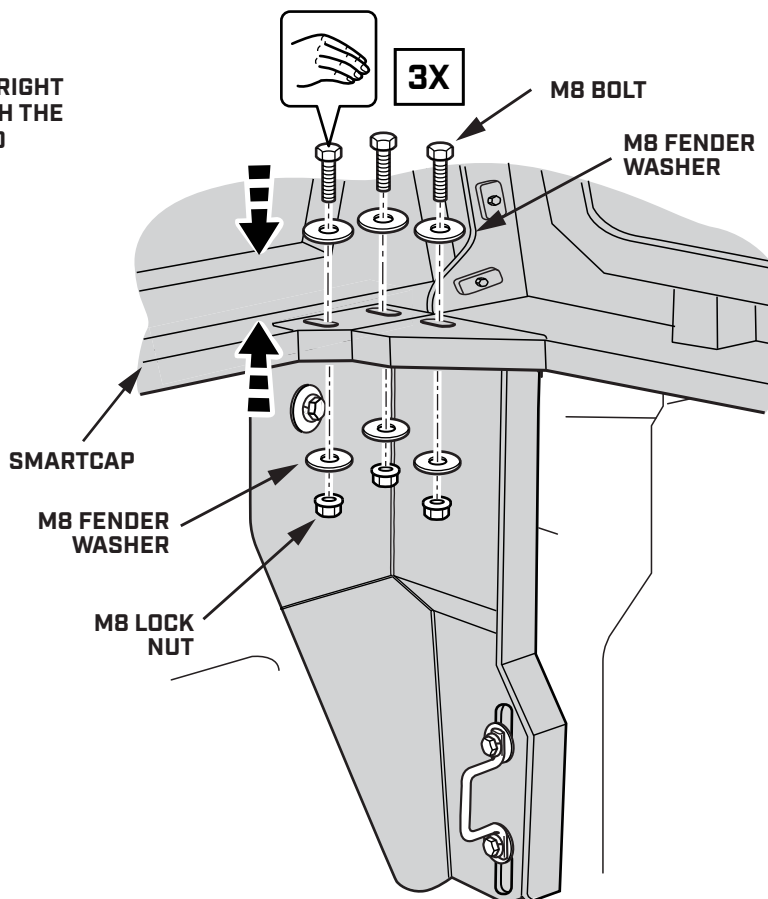
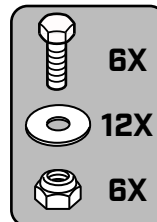

I-SHEET-ROW-A1

STEP 37

SECURE THE SMARTCAP TO THE RIGHT REAR MOUNTING BRACKET WITH THE FASTENERS AS INDICATED, HAND TIGHTEN ONLY.

REPEAT ON THE OPPOSITE SIDE OF THE VEHICLE WITH THE LEFT REAR MOUNTING BRACKET.

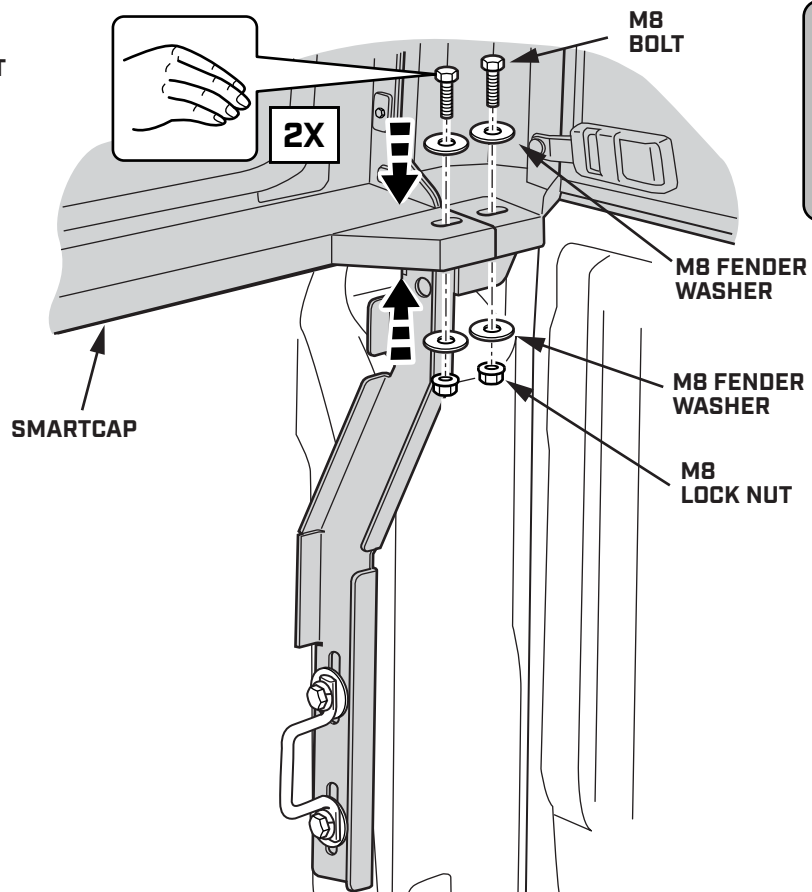

STEP 38

ONCE ALL THE FASTENERS ARE INSTALLED, PARTIALLY TIGHTEN WITH 13MM SOCKET WRENCH AS INDICATED.

PARTIALLY TIGHTEN FASTENERS ON ALL FOUR CORNERS OF THE VEHICLE.

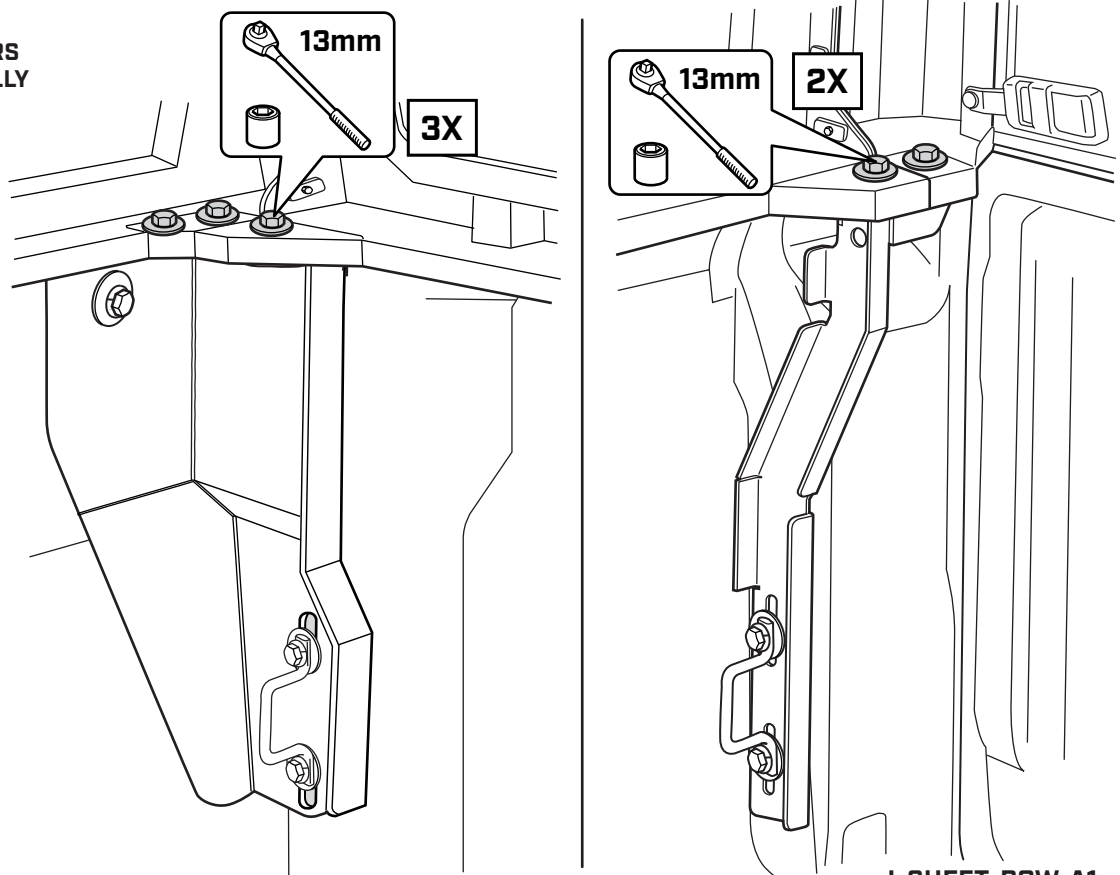

I-SHEET-ROW-A1

STEP 39

PRESS DOWN ON THE SMARTCAP TO ACHIEVE 2MM - 3MM COMPRESSION ON THE D-RUBBER AND CONTINUE TIGHTENING BRACKET FASTENERS WITH SOCKET WRENCH AS INDICATED.

CONTINUE TIGHTENING FASTENERS ON ALL FOUR CORNERS OF THE VEHICLE.

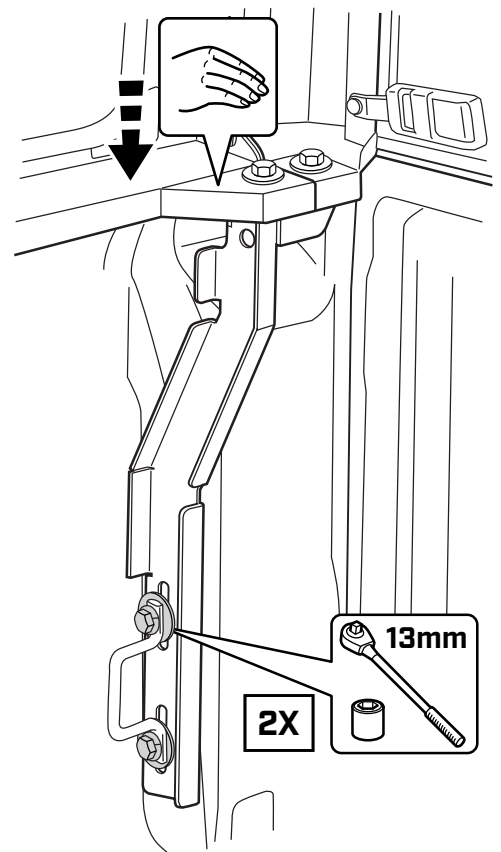
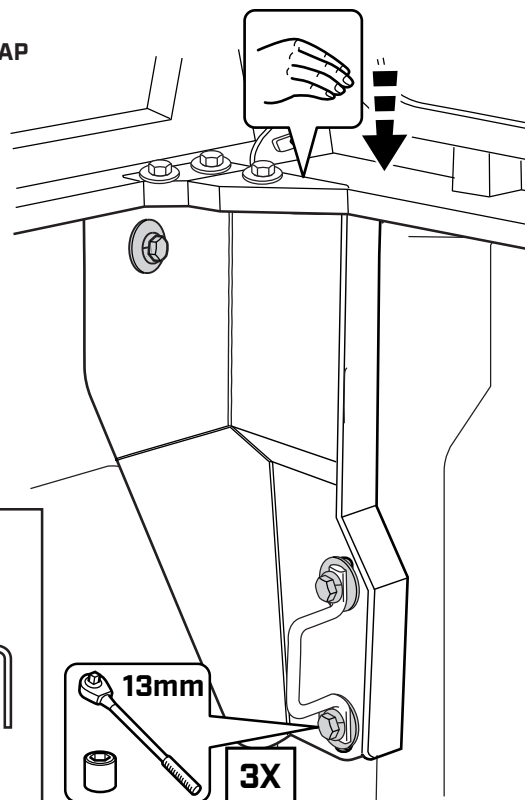
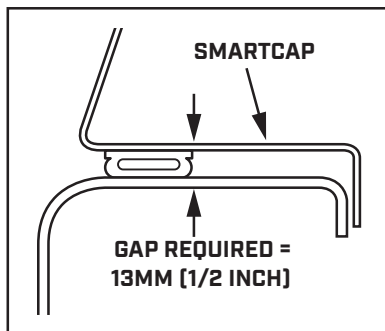

STEP 40

ONCE SMARTCAP IS POSITIONED CORRECTLY, FULLY TIGHTEN UPPER FASTENERS USING A TORQUE WRENCH AND 13MM SOCKET TO 4.4 FT. LBS (6 NEWTON METERS)

FULLY TIGHTEN UPPER FASTENERS ON ALL FOUR CORNERS OF THE VEHICLE.

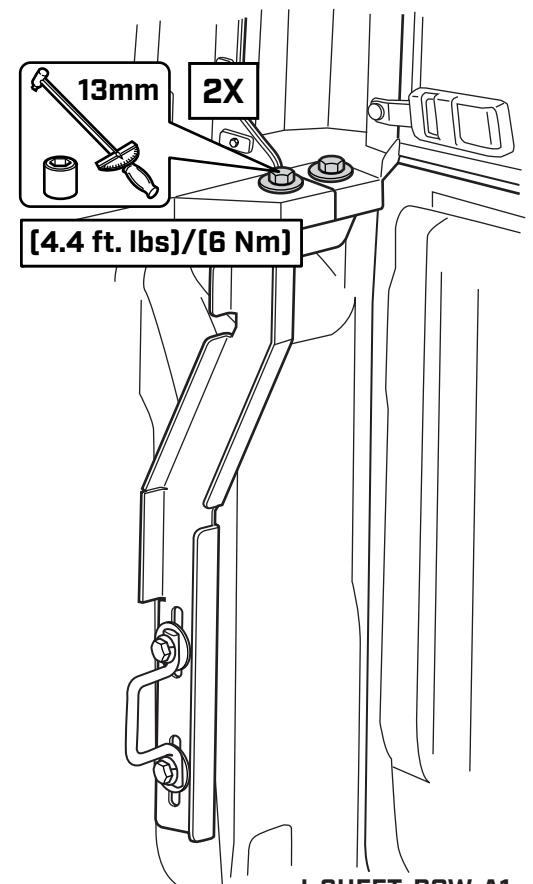
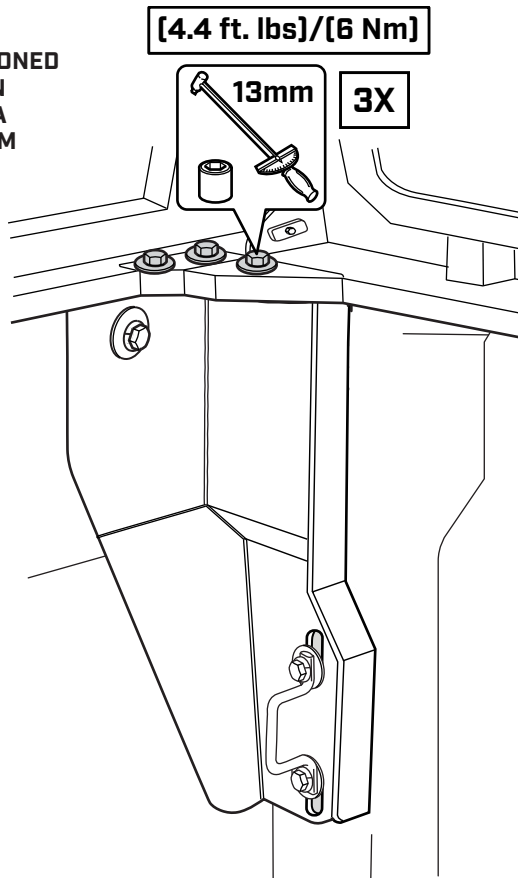

I-SHEET-ROW-A1

STEP 41

ONCE SMARTCAP IS POSITIONED CORRECTLY, FULLY TIGHTEN LOWER FASTENERS USING A TORQUE WRENCH AND 13MM SOCKET TO 9 FT. LBS [12.2 NEWTON METERS]

FULLY TIGHTEN LOWER FASTENERS ON ALL FOUR CORNERS OF THE VEHICLE.

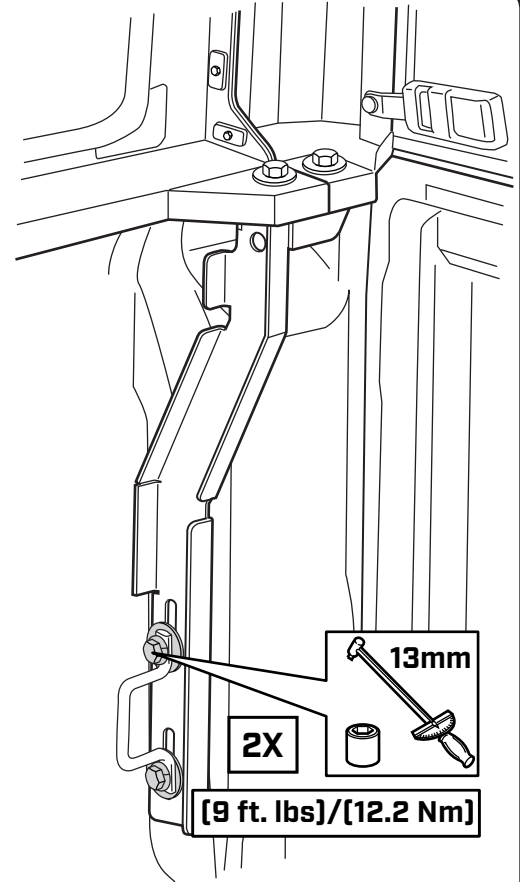
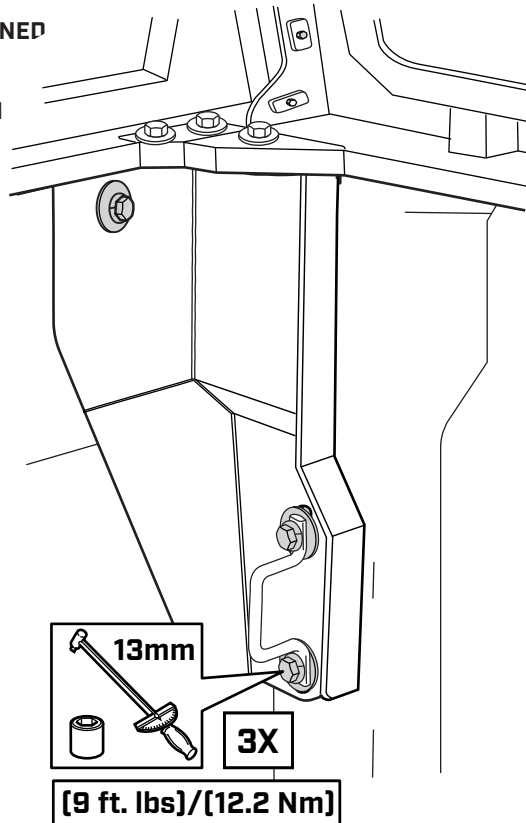

STEP 42

FULLY TIGHTEN THE M8 BUTTON HEAD BOLTS ALONG THE SIDE RAIL ATTACHMENT POINTS OF THE CAP USING A TORQUE WRENCH AND A 5MM HEX KEY BIT TO 4.4 FT. LBS. [6 NEWTON METERS].

REPEAT ON THE OPPOSITE SIDE OF THE VEHICLE.

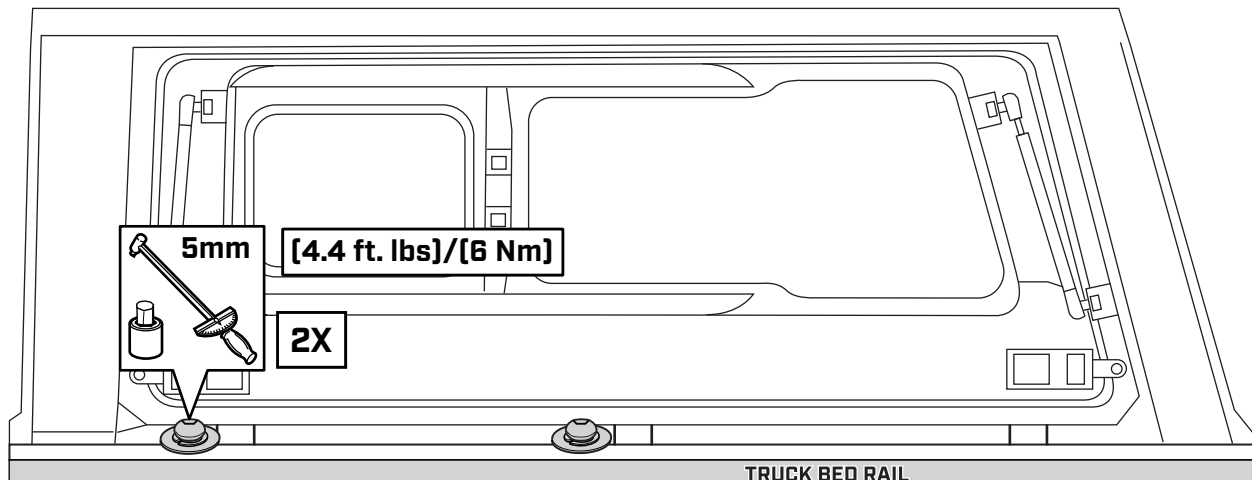

I-SHEET-ROW-A1



**THANKS FOR YOUR PURCHASE.
PLEASE LET US KNOW IF YOU HAVE ANY QUESTIONS.**

SMARTCAP.COM
SUPPORT.SA@SMARTCAP.COM - REST OF WORLD
SUPPORT.NA@SMARTCAP.COM - NORTH AMERICA/CANADA

